

PERMIT

SEWAGE DISPOSAL SYSTEM

MARYLAND STATE DEPARTMENT OF HEALTH

HOWARD COUNTY

ELLICOTT CITY

DISTRICT 3rd

DATE 7/15/75

*9/15/75
Ready for
transfer copy*

INDEXED

David Bullock _____ IS PERMITTED TO INSTALL ALTER _____

ADDRESS Westminster, Maryland PHONE _____

A SEWAGE DISPOSAL SYSTEM LOCATED AT _____

SUBDIVISION _____ ROAD 1406 Driver Road LOT _____

PROPERTY OWNER Phillip Dorsey

ADDRESS 2575 Frederick Avenue, Baltimore, Md. 947-7446

SPECIFICATIONS 4 bedrooms

DRAIN FIELD _____ DEPTH _____ FEET. BOTTOM AREA _____ SQ. FT.

SEEPAGE PITS _____ ABSORBENT SIDE-WALL AREA _____ SQ. FT.

SEPTIC TANK CAPACITY 1250 GALLONS

FOR GARBAGE GRINDER, INCREASE DISPOSAL AREA 22% & TANK CAPACITY 50%.

OTHER DRY WELL - 120 sq. ft. effective absorbent sidewall area per bedroom below the first 5 ft. of non-absorbent soil at original grade. Inlet may come into the dry well at 2 to 3 ft. Maximum depth of dry well to be 12 ft. Locate dry well 100 ft. from front lot line and 25 ft. from right side line as seen when facing lot from Driver Road. If you wish to use a trench with a dry well call this office for permission and recommendation.

7/30/79 - extend DW 22' in front of center of house change in sum
NOTE: ALL PIPE FROM HOUSE TO DISPOSAL (AREA MUST) BE CAST IRON.

PERMIT VOID AFTER THREE YEARS. NOTE: INSTALL STAND PIPES ON SEPTIC TANK AND DRY WELL. STAND PIPES MUST BE 6 INCHES IN DIAMETER. CAST IRON, CONCRETE OR TERRA COTTA ACCEPTED.

PLANS APPROVED BY William W. Zepp DATE 1/31/75

FILL SEPTIC TANK AND DISTRIBUTION BOX WITH WATER BEFORE CALLING FOR AN INSPECTION. COVER NO WORK UNTIL INSPECTED AND APPROVED.

NEITHER THE HOWARD COUNTY COMMISSIONERS NOR THE HEALTH DEPARTMENT IS RESPONSIBLE FOR THE SUCCESSFUL OPERATION OF ANY SYSTEM.

BLDG. PERMIT SIGNED
AND RETURNED 2/13/90
Serial # 31564
family room
addition

BLDG. PERMIT SIGNED
AND RETURNED 6/14/83
Serial # 54377
61803 signed for 11/12/84 for deck

A 21013

21013

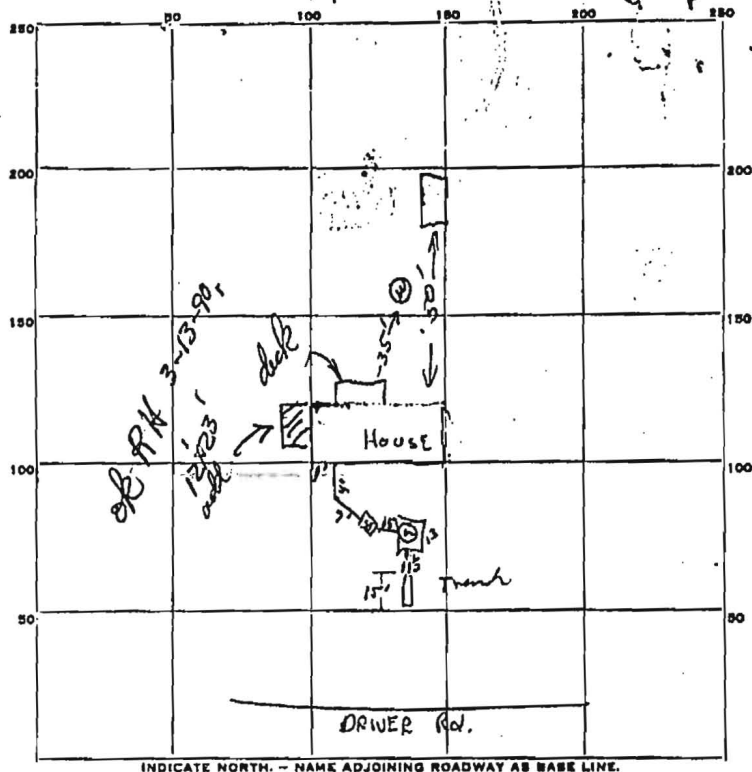

PERMIT CARD _____

SEPTIC TANK, LEVEL OK CLEANOUTS OK

DISTRIBUTION BOX, LEVEL _____

TILE FIELD, DEPTH 12 FT. TRENCH WIDTH 30"

GRAVEL DEPTH 4" TOTAL LENGTH 75 FT.

NUMBER OF TRENCHES 1 TOTAL BOTTOM AREA 105

SEEPAGE PITS, ^{outside perimeter} INSIDE DIAMETER 11 1/2 x 13 FT. DEPTH BELOW INLET 10 (8 ft of effective) FT. ^{soil}

ABSORBENT AREA 392 SQ. FT. + 105 = 497

REMARKS 9/5/75 Sept note stating that dry well was 88 sq. ft short.

Sept instructions to dig 12 ft trench - 12 ft long with 8 ft of gravel

9/9/75 Bullard called - explained what was needed and ^{R.T.}

he agreed to install system & should be done immediately

DATE SYSTEM APPROVED 9/15/75 INSPECTOR R. W. onefield