

LAYOUT _____ INSP 4 _____

INSP 2 _____ INSP 5 _____

INSP 3 _____ INSP 6 _____

ISSUE DATE: 12/07/09

P 525674

APPROVAL DATE: 12/15/06

A _____

PERMIT

TAX ID # _____

ON-SITE SEWAGE DISPOSAL SYSTEM HOWARD COUNTY HEALTH DEPARTMENT BUREAU OF ENVIRONMENTAL HEALTH

Repair

Hatfield's Equipment IS PERMITTED TO INSTALL ALTER

ADDRESS: P.O. Box 519 Annapolis Junction PHONE NUMBER: 301.854.6172

SUBDIVISION: _____ LOT NUMBER: _____

ADDRESS: 7343 Flamewood Drive PROPERTY OWNER: Diana Cavey

SEPTIC TANK CAPACITY (GALLONS): _____ OUTLET BAFFLE FILTER REQUIRED

PUMP CHAMBER CAPACITY (GALLONS): n/a COMPARTMENTED TANK REQUIRED

NUMBER OF BEDROOMS: 4

SQUARE FEET PER BEDROOM: 180

LINEAR FEET OF TRENCH REQUIRED: 112

TRENCHES:	Trench to be 2.0 feet wide. Inlet 5.0 feet below original grade. Bottom maximum depth 11.0 feet below original grade. Effective area begins at 5.0 feet below original grade. 6.0 feet of stone below distribution pipe.
LOCATION:	
NOTES:	

PLANS APPROVED: B. Baker DATE: _____

NOTE: PERMIT VOID AFTER 2 YEARS

NOTE: CONTRACTOR RESPONSIBLE FOR SCHEDULING A PRE-CONSTRUCTION INSPECTION FOR ALL INSTALLATIONS

NOTE: WATERTIGHT SEPTIC TANKS REQUIRED

NOTE: ALL PARTS OF SEPTIC SYSTEM SHALL BE 100 FEET FROM ANY WATER WELL

NOTE: MANHOLE RISERS REQUIRED ON ALL SEPTIC TANKS AND PUMP CHAMBERS UNLESS SPECIFICALLY AUTHORIZED

**NEITHER THE HOWARD COUNTY COUNCIL NOR THE HEALTH DEPARTMENT IS
RESPONSIBLE FOR THE SUCCESSFUL OPERATION OF ANY SYSTEM
PERMITTEE RESPONSIBLE FOR OBTAINING FINAL APPROVAL ON THIS PERMIT
CALL 410-313-1771 FOR INSPECTION OF SEPTIC SYSTEM**

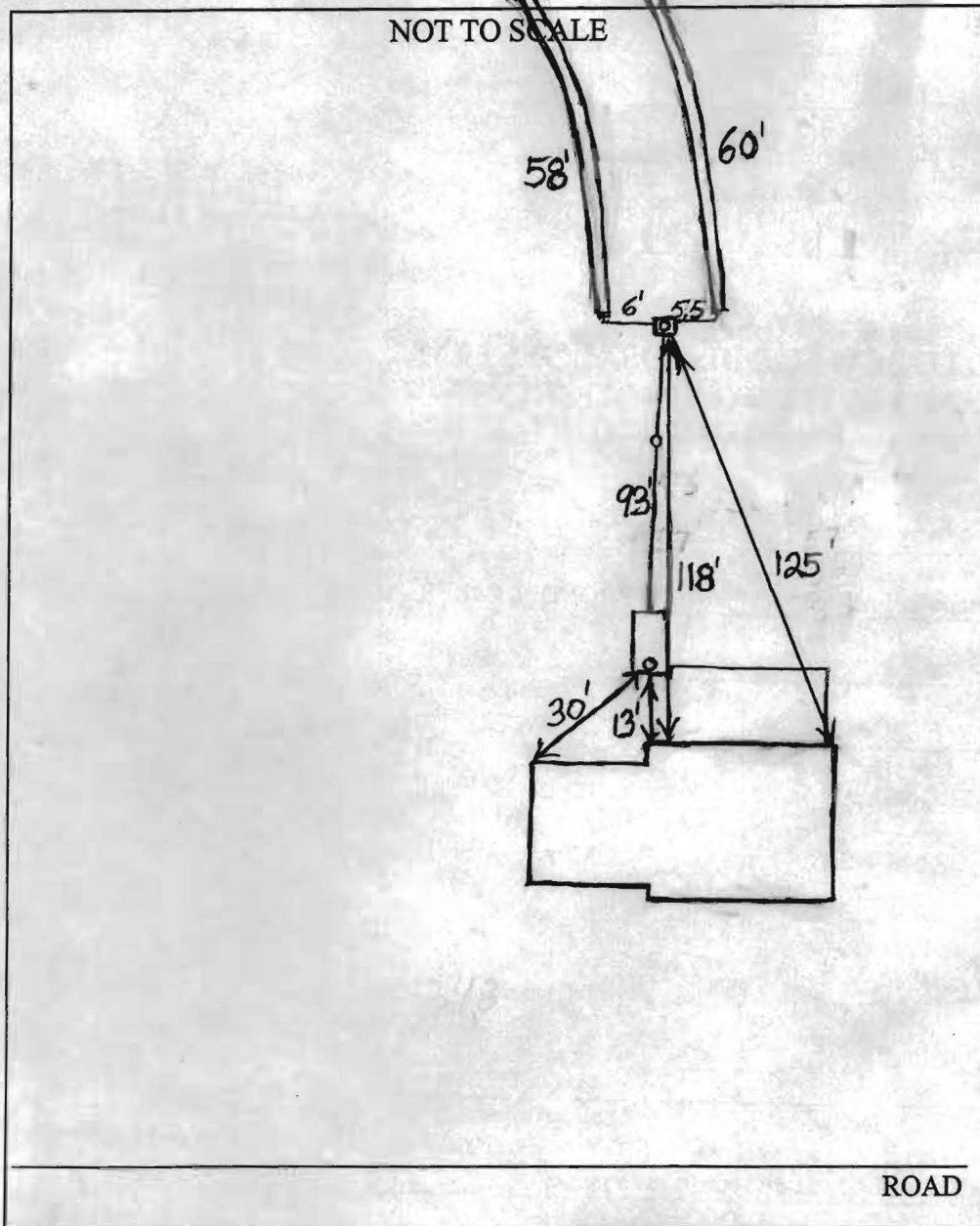

TRENCH/DRAINFIELD DATA		
WIDTH	INLET	BOTTOM
2'	5'-5.5'	11'
NUMBER OF TRENCHES		2
TOTAL LENGTH		118'
ABSORPTION AREA		678
DISTRIBUTION BOX LEVEL		Yes
DISTRIBUTION BOX BAFFLE		Yes
DISTRIBUTION BOX PORT		Yes

SEPTIC TANK DATA	
SEPTIC TANK 1 LEVEL	
CAPACITY	Existing GAL
SEAM LOC	Midseam
TANK LID DEPTH	0.5'-1'
BAFFLES	Yes
BAFFLE FILTER	No
MANHOLE LOC	None
6" PORT LOC	Front
WATERTIGHT TEST	No
SEPTIC TANK 2 LEVEL N/A	
CAPACITY	_____ GAL
SEAM LOC	_____
TANK LID DEPTH	_____
BAFFLES	_____
BAFFLE FILTER	_____
MANHOLE LOC	_____
6" PORT LOC	_____
WATERTIGHT TEST	_____

PRE-CONSTRUCTION _____

INSTALLATION 12/15/06 The 58' trench had a 5' inlet. The 60' trench had a 5.5' inlet. O.K. to backfill. Drywell pumped out and filled with dirt per Hatfields. (BB)

FINAL INSPECTOR B. Baker

DATE OF APPROVAL 12/15/06