

PUB. SEWER STATUS VERIFIED BY _____

ISSUE DATE: _____

P 536035-A

APPROVAL DATE: 12/19/2011

A REPAIR

PERMIT

Septic Repair

**ON-SITE SEWAGE DISPOSAL SYSTEM
HOWARD COUNTY HEALTH DEPARTMENT
BUREAU OF ENVIRONMENTAL HEALTH**

William Hopkins IS PERMITTED TO INSTALL ALTER

ADDRESS: 17540 Old Frederick Road PHONE NUMBER: 301-829-1166

SUBDIVISION: _____ LOT NUMBER: _____

ADDRESS: 2780 Florence Road PROPERTY OWNER: Violet Hopkins

SEPTIC TANK CAPACITY (GALLONS): N/A 1000 3' Wide
PUMP CHAMBER CAPACITY (GALLONS): _____ Inlet 4.5'
NUMBER OF BEDROOMS: _____ Bottom 5.5'
SQUARE FEET OF HOUSE: _____ Upper 88' Trench and
LINEAR FEET OF TRENCH REQUIRED: 188' Lower 100' Trench

TRENCHES:	
LOCATION:	
PURPOSE:	

PLANS APPROVED: B. Baker DATE: 12/9/2011

- NOTE: PERMIT VOID AFTER 2 YEARS
- NOTE: CONTRACTOR RESPONSIBLE FOR SCHEDULING A PRE-CONSTRUCTION INSPECTION FOR ALL INSTALLATIONS
- NOTE: WATERTIGHT SEPTIC TANKS REQUIRED
- NOTE: ALL PARTS OF SEPTIC SYSTEM SHALL BE 100 FEET FROM ANY WATER WELL
- NOTE: MANHOLE RISERS REQUIRED ON ALL SEPTIC TANKS AND PUMP CHAMBERS

NEITHER THE HOWARD COUNTY COUNCIL OR THE HEALTH DEPARTMENT IS RESPONSIBLE FOR THE SUCCESSFUL OPERATION OF ANY SYSTEM PERMITTEE RESPONSIBLE FOR OBTAINING FINAL APPROVAL ON THIS PERMIT CALL 410-313-1771 FOR INSPECTION OF SEPTIC SYSTEM

NOT TO SCALE

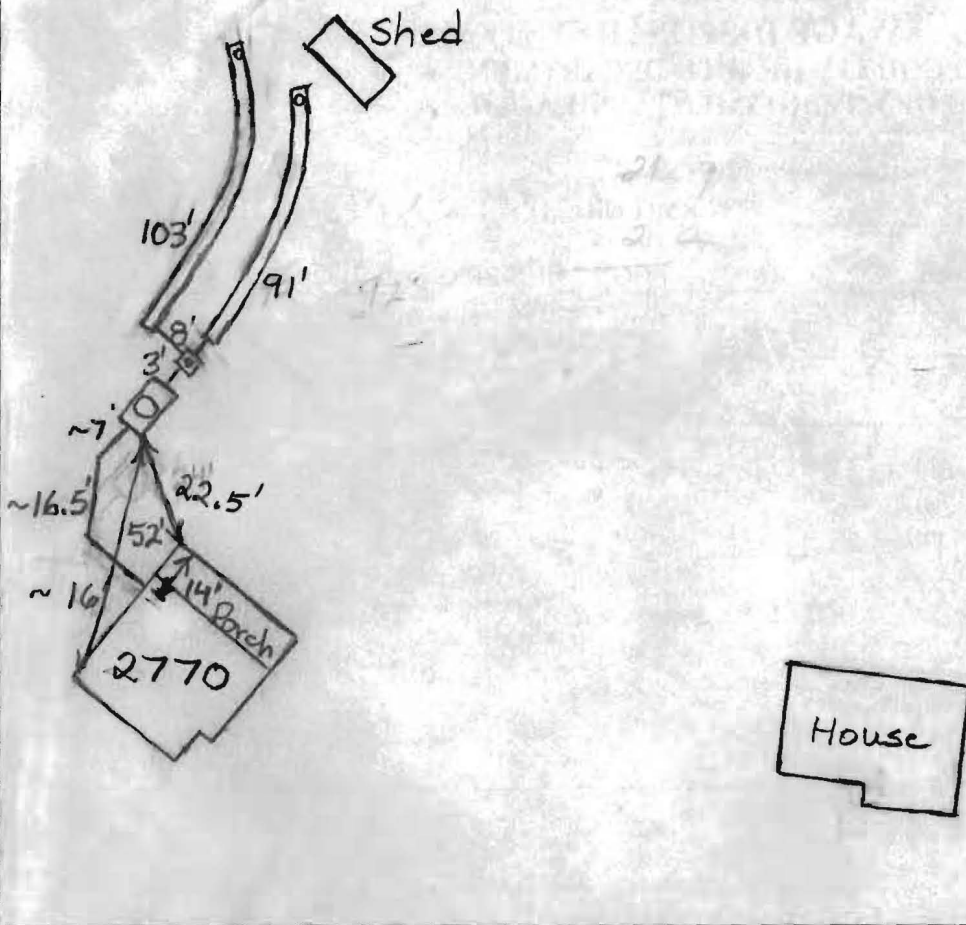

TRENCH/DRAINFIELD DATA

WIDTH	INLET	BOTTOM
3'	4.5'	5.5'
NUMBER OF TRENCHES		2
TOTAL LENGTH		194'
ABSORPTION AREA		582
DISTRIBUTION BOX LEVEL		Levelers
DISTRIBUTION BOX BAFFLE		Yes
DISTRIBUTION BOX PORT		Yes

SEPTIC TANK DATA

SEPTIC TANK 1 LEVEL	Yes
MANUFACTURER	Babylon
CAPACITY	1000 GAL
SEAM LOC	Top
TANK LID DEPTH	1-1.5'
BAFFLES	Yes
BAFFLE FILTER	No
MANHOLE LOC	Middle
6" PORT LOC	None
WATERTIGHT TEST	No
SLOTTED	No

DATE ON LID 10/2/2011

PUMP/SEPTIC TANK LEVEL N/A

MANUFACTURER	
CAPACITY	GAL
SEAM LOC	
TANK LID DEPTH	
BAFFLES	
BAFFLE FILTER	
MANHOLE LOC	
6" PORT LOC	
WATERTIGHT TEST	
SLOTTED	
DATE ON LID	

ROAD NAME

PRE-CONSTRUCTION:

12/9/2011 I install an upper 98' trench on contour towards the shed and a lower 100' trench on contour beneath it. Replace the collapsed septic tank with a 1000 gallon tank. Pump out and fill in the small drywell. (BB)

INSTALLATION: 12/19/2011 No follow-ups called in. System finished. O.K. to backfill. Old system filled in per installer. (BB)

FINAL INSPECTOR B. Baker

DATE OF APPROVAL 12/19/2011