

LAYOUT _____ INSP 4 _____
INSP 2 _____ INSP 5 _____
INSP 3 _____ INSP 6 _____

ISSUE DATE: _____

PERMIT - Repair

P 533977

APPROVAL DATE: 9/1/10

Tax ID # 05407052

A Repair

ON-SITE SEWAGE DISPOSAL SYSTEM HOWARD COUNTY HEALTH DEPARTMENT BUREAU OF ENVIRONMENTAL HEALTH

Fogles' Septic Clean IS PERMITTED TO INSTALL ALTER

ADDRESS: _____ PHONE NUMBER: 410-795-5670

SUBDIVISION: VILLA MONTICELLO LOT NUMBER: 13

ADDRESS: 14101 BARBARA CIRCLE PROPERTY OWNER: TOM & CHRISTY SHUMAKER

SEPTIC TANK CAPACITY (GALLONS): Ex. OUTLET Baffle ~~REQUIRED~~

PUMP CHAMBER CAPACITY (GALLONS): Will be needed for Repair Future COMPARTMENTED TANK REQUIRED

NUMBER OF BEDROOMS: 4 APPLICATION RATE: 0.6

SQUARE FOOTAGE OF HOUSE: —

LINEAR FEET OF TRENCH REQUIRED: 220 LF

~183 ton stone

TRENCHES:	Trenches to be <u>2</u> feet wide. Inlet <u>5</u> feet below original grade. Bottom maximum depth <u>12</u> feet below grade. Effective area begins at <u>2</u> feet below original grade. <u>7</u> feet of stone below distribution pipe.
LOCATION:	A Layout inspection is required for correct placement and verification of trench locations.
NOTES:	Manhole access needs to be installed on the tank. Install observation pipes at trench ends. Pump and collapse ex. dry well. <u>Install trenches close to 220' as possible.</u>

PLANS APPROVED: K. M. Wolf DATE: 8/26/10

- NOTE: PERMIT VOID AFTER 2 YEARS
- NOTE: CONTRACTOR RESPONSIBLE FOR SCHEDULING A PRE-CONSTRUCTION INSPECTION FOR ALL INSTALLATIONS
- NOTE: WATERTIGHT SEPTIC TANKS REQUIRED
- NOTE: ALL PARTS OF SEPTIC SYSTEM SHALL BE 100 FEET FROM ANY WATER WELL
- NOTE: MANHOLE RISERS REQUIRED ON ALL SEPTIC TANKS AND PUMP CHAMBERS

NEITHER THE HOWARD COUNTY COUNCIL OR THE HEALTH DEPARTMENT IS RESPONSIBLE FOR THE SUCCESSFUL OPERATION OF ANY SYSTEM PERMITTEE RESPONSIBLE FOR OBTAINING FINAL APPROVAL ON THIS PERMIT CALL 410-313-1771 FOR INSPECTION OF SEPTIC SYSTEM

NOT TO SCALE

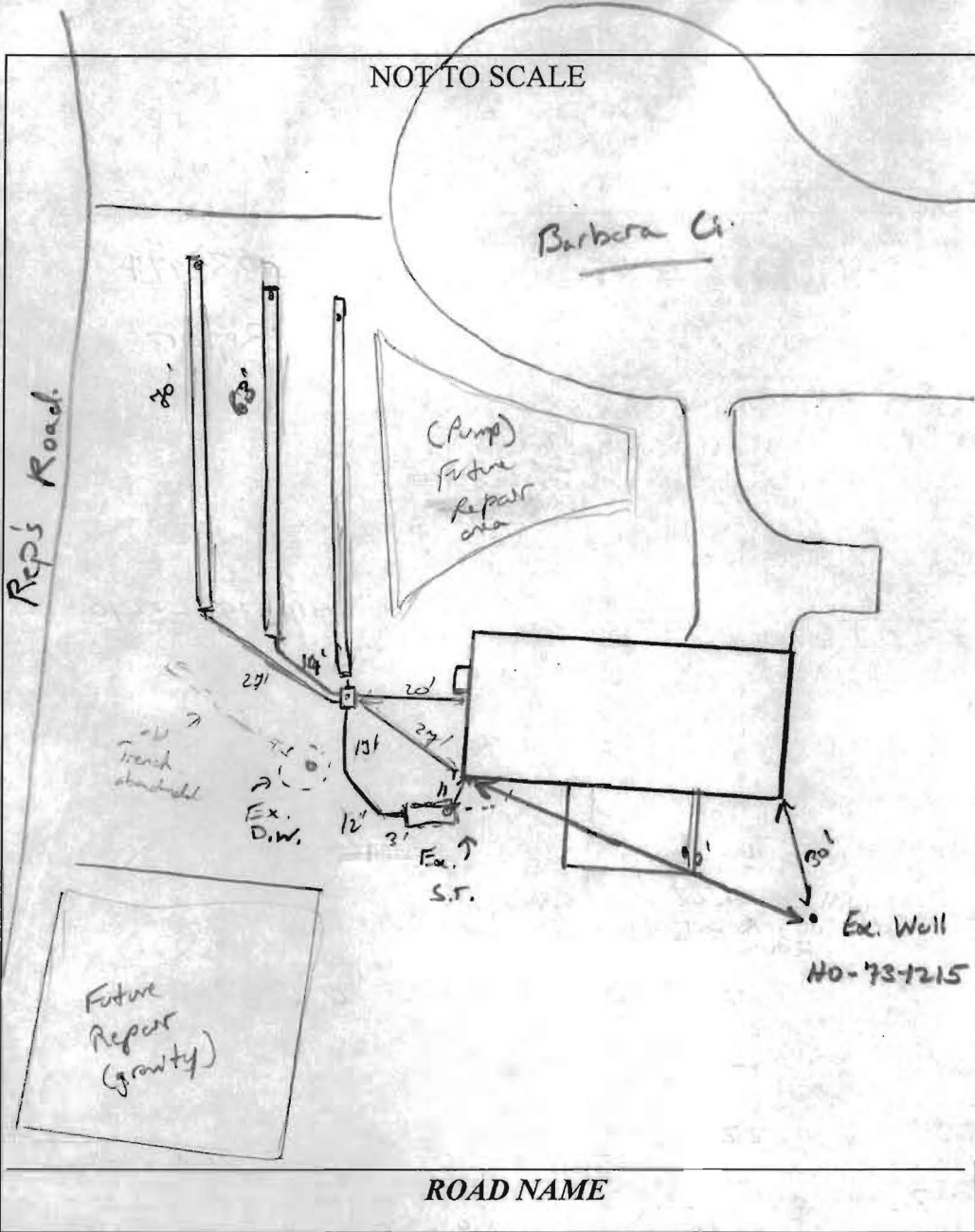

ROAD NAME

TRENCH/DRAINFIELD DATA		
WIDTH	INLET	BOTTOM
2		12'-13'
NUMBER OF TRENCHES		3
TOTAL LENGTH		
ABSORPTION AREA		
DISTRIBUTION BOX LEVEL		Yes
DISTRIBUTION BOX BAFFLE		Yes
DISTRIBUTION BOX PORT		Yes

SEPTIC TANK DATA	
SEPTIC TANK 1 LEVEL	Yes
MANUFACTURER	?
CAPACITY	1250 GAL
SEAM LOC	mid
TANK LID DEPTH	1'
BAFFLES	Yes
BAFFLE FILTER	
MANHOLE LOC	Rear
6" PORT LOC	Front
WATERTIGHT TEST	
SLOTTED	no
DATE ON LID	

PUMP/SEPTIC TANK LEVEL	
MANUFACTURER	
CAPACITY	GAL
SEAM LOC	
TANK LID DEPTH	
BAFFLES	
BAFFLE FILTER	
MANHOLE LOC	
6" PORT LOC	
WATERTIGHT TEST	
SLOTTED	
DATE ON LID	

PRE-CONSTRUCTION:

8/26/10 OK to bring new plumbing out of Ex. S.T. and set new D box. Top trench laid out in field at time of perc test. OK to start top trench. Need layout of other 2 trenches (120)

8/30/10 met contractor on site to adjust trench locations. Worked area cleared away to layout bottom trench.

INSTALLATION: 8/31/10 Bottom trench being dug. Rock encountered throughout trench ~ 7-10'. Stone used from road front every. Looks good. OK to continue. (120) 9/1/10 (12pm) middle tank complete. Top trench started. Had contractor dig trench 12' deep. Fill was @ 3.5'

Told contractor that transit was needed for this trench (120)

9/1/10 (3pm) Trenches complete OK to backfill all work (120)

FINAL INSPECTOR

J. Wolf

DATE OF APPROVAL

9/1/10