

PUB. SEWER STATUS VERIFIED BY MLB/Ramba

1:30
10/17

ISSUE DATE: 10/17/2003

P 519626-A

APPROVAL DATE: 10/20/03

A REPAIR

PERMIT INDEXED

ON-SITE SEWAGE DISPOSAL SYSTEM HOWARD COUNTY HEALTH DEPARTMENT BUREAU OF ENVIRONMENTAL HEALTH

04-337506

Jenkins Brothers IS PERMITTED TO INSTALL ALTER

ADDRESS: 7670 Smiths Private Road PHONE NUMBER: 410-461-9282

SUBDIVISION: Brantly LOT NUMBER: 8

ADDRESS: 3338 Brantly Road PROPERTY OWNER: David Smith

SEPTIC TANK CAPACITY (GALLONS): New 1250 gallon

PUMP CHAMBER CAPACITY (GALLONS): N/A

NUMBER OF BEDROOMS: 4

SQUARE FEET PER BEDROOM: 180

LINEAR FEET OF TRENCH REQUIRED: Ex 45' + 55' new trench (slightly oversized)

$$\frac{180 \times 4}{3} \times .36 = 86 \text{ req.}$$

| | |
|-----------|--|
| TRENCHES: | Trench to be 3 feet wide. Inlet 5 feet below original grade. Bottom maximum depth 10 feet below original grade. Effective area begins at 5 feet below original grade. 5 feet of stone below distribution pipe. |
| LOCATION: | Relocate S.T. & cave-in dry well; future location for shed. Run ex 45' long trench & 55' long new trench off d. bed. |
| PURPOSE: | Septic system is failing. Call for inspection when the ground has been opened so sanitarian can recommend repair. |

PLANS APPROVED: KN DATE: 10/17/03

- NOTE: PERMIT VOID AFTER 2 YEARS
- NOTE: CONTRACTOR RESPONSIBLE FOR SCHEDULING A PRE-CONSTRUCTION INSPECTION FOR ALL INSTALLATIONS
- NOTE: WATERTIGHT SEPTIC TANKS REQUIRED
- NOTE: ALL PARTS OF SEPTIC SYSTEM SHALL BE 100 FEET FROM ANY WATER WELL
- NOTE: MANHOLE RISERS REQUIRED ON ALL SEPTIC TANKS AND PUMP CHAMBERS

NEITHER THE HOWARD COUNTY COUNCIL NOR THE HEALTH DEPARTMENT IS RESPONSIBLE FOR THE SUCCESSFUL OPERATION OF ANY SYSTEM PERMITTEE RESPONSIBLE FOR OBTAINING FINAL APPROVAL ON THIS PERMIT CALL 410-313-2640 FOR INSPECTION OF SEPTIC SYSTEM

519626-A

NOT TO SCALE

INDEXED

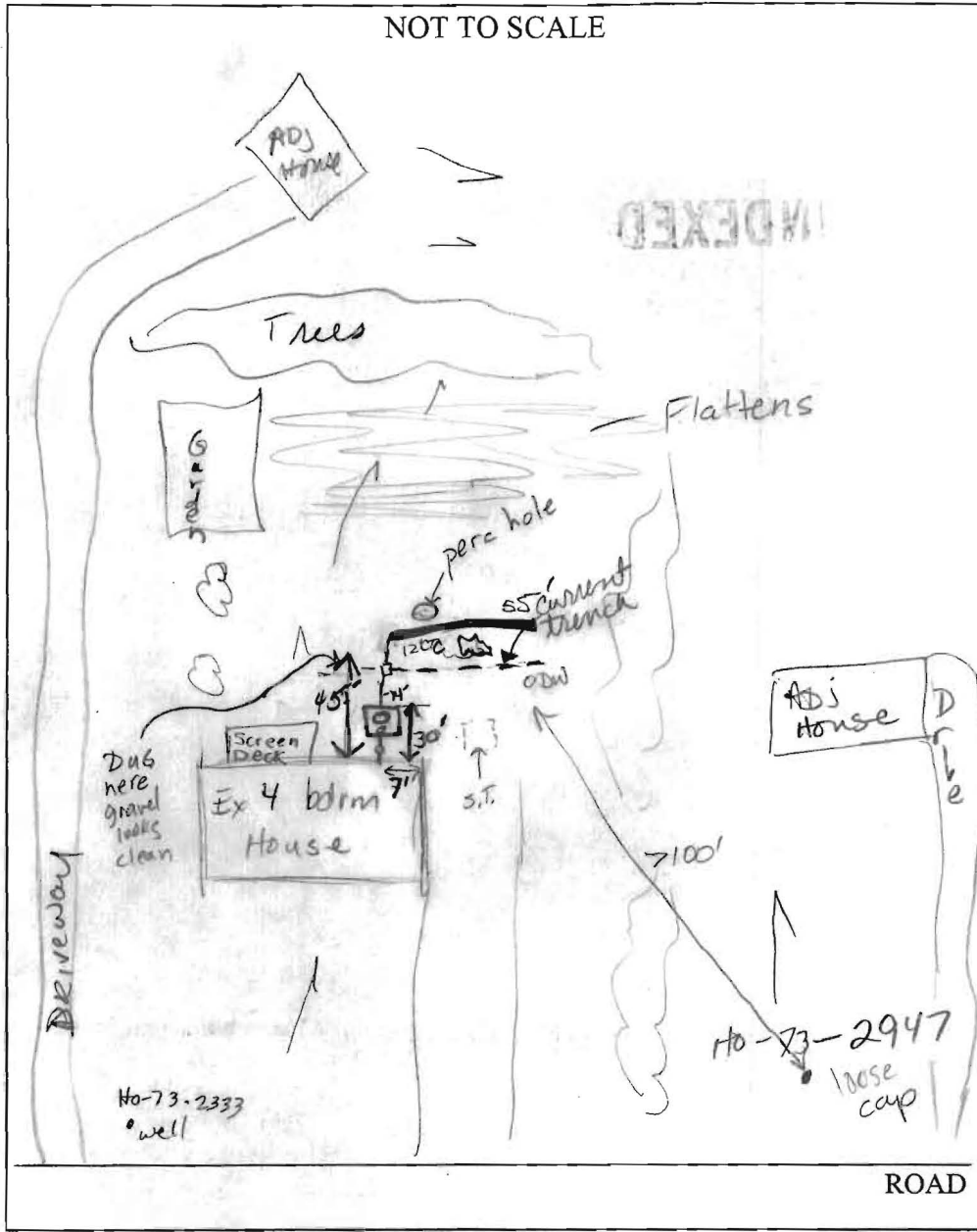

| TRENCH/DRAINFIELD DATA | | |
|-------------------------|-----------|-----------|
| WIDTH | INLET | BOTTOM |
| OLD | OLD / NEW | OLD / NEW |
| 2/3 | 4/5 | 10/10 |
| NUMBER OF TRENCHES | | 2 |
| TOTAL LENGTH | | 100' |
| ABSORPTION AREA | | |
| DISTRIBUTION BOX LEVEL | | yes |
| DISTRIBUTION BOX BAFFLE | | yes |
| DISTRIBUTION BOX PORT | | N/A |

| SEPTIC TANK DATA | |
|---------------------|----------|
| SEPTIC TANK 1 LEVEL | yes |
| CAPACITY | 1250 GAL |
| SEAM LOC | TOP |
| TANK LID DEPTH | 12" |
| BAFFLES | yes |
| BAFFLE FILTER | No |
| MANHOLE LOC | back |
| 6" PORT LOC | front |
| WATERTIGHT TEST | N/A |
| SEPTIC TANK 2 LEVEL | N/A |
| CAPACITY | GAL |
| SEAM LOC | |
| TANK LID DEPTH | |
| BAFFLES | |
| BAFFLE FILTER | |
| MANHOLE LOC | |
| 6" PORT LOC | |
| WATERTIGHT TEST | |

PRE-CONSTRUCTION 10/17/03 collapse septic tank and fall dry well for future placement of shed. Current trench looks new.

INSTALLATION Place 1250 septic tank downhill of screendeck. inlet at 5' bottom at 10'. Jenkins will place S.T. in discussed location. Monday he will set dbx & run ext trench & new trench from it. (KN)

10/20/03 Dry well caved in. Owner took pictures during installation for own purpose (educational). OK to cover all work (KN)

FINAL INSPECTOR Kacie Noonan DATE OF APPROVAL 10/20/03

app 12-7-78
20

P.C.O. 12/5/78
C.H.

~~10/01/78~~

PERMIT

P 29284

A 29212

90

SEWAGE DISPOSAL SYSTEM

MARYLAND STATE DEPARTMENT OF HEALTH*

HOWARD COUNTY

ELLICOTT CITY

12/5/78

DISTRICT 4th

INDEXED

DATE 11/28/78

Mitchell-Wiley

IS PERMITTED TO INSTALL ALTER

ADDRESS _____ PHONE _____

SUBDIVISION Brantly ROAD 3338 Brantly Road LOT 8

PROPERTY OWNER Brantly Associates David Smith + DIANE DEKING

ADDRESS _____

SPECIFICATIONS 4 bedrooms

SEPTIC TANK CAPACITY 1250 GALLONS

DRAIN FIELD _____ DEPTH _____ FEET, BOTTOM AREA _____ SQ. FT.

DEEP TRENCH _____ DEPTH _____ FEET, BOTTOM AREA _____ SQ. FT.

SEEPAGE PITS _____ ABSORBENT SIDE-WALL AREA 140 SQ. FT. per bedroom in system.

INLET PIPE 4 FT. BELOW ORIGINAL GRADE. MAXIMUM DEPTH 10 FT. BELOW ORIGINAL GRADE

EFFECTIVE DEPTH AT _____ FT. BELOW ORIGINAL GRADE.

LOCATE DISPOSAL AREA 110 FT. FROM front LOT LINE AND 10 FT. FROM right LOT LINE AS SEEN WHEN FACING LOT FROM road.

560
288
333
117

Begin the trench 5 ft. from the edge of the dry well and follow the contour of the

land. The trench will be 2 ft. wide, 10 ft. deep, and contain 6 ft. of stone.

PLANS APPROVED BY R. Moorefield DATE 8/22/77

COVER NO WORK UNTIL INSPECTED AND APPROVED.

NEITHER THE HOWARD COUNTY COUNCIL NOR THE HEALTH DEPARTMENT IS RESPONSIBLE FOR THE SUCCESSFUL OPERATION OF ANY SYSTEM.

NOTE: IF TRENCH IS USED CALL FOR INSPECTION BEFORE PLACING GRAVEL IN TRENCH.

NOTE: NO DRY WELL SHALL EXCEED 15 FOOT IN DIAMETER.

NOTE: ALL PIPE FROM HOUSE TO DISPOSAL AREA MUST BE CAST IRON.

PERMIT VOID AFTER THREE YEARS.

NOTE: INSTALL STAND PIPE ON SEPTIC TANK AND DRY WELL. STAND PIPES MUST BE 6 INCHES IN DIAMETER. CAST IRON, CONCRETE OR TERRA COTTA ACCEPTED.

BLDG. PERMIT SIGNED
AND RETURNED 4/6/95

Serial # 58828
Deck + Sewer

A 29212

*INSTALLER IS RESPONSIBLE FOR OBTAINING FINAL APPROVAL ON THIS PERMIT.

15

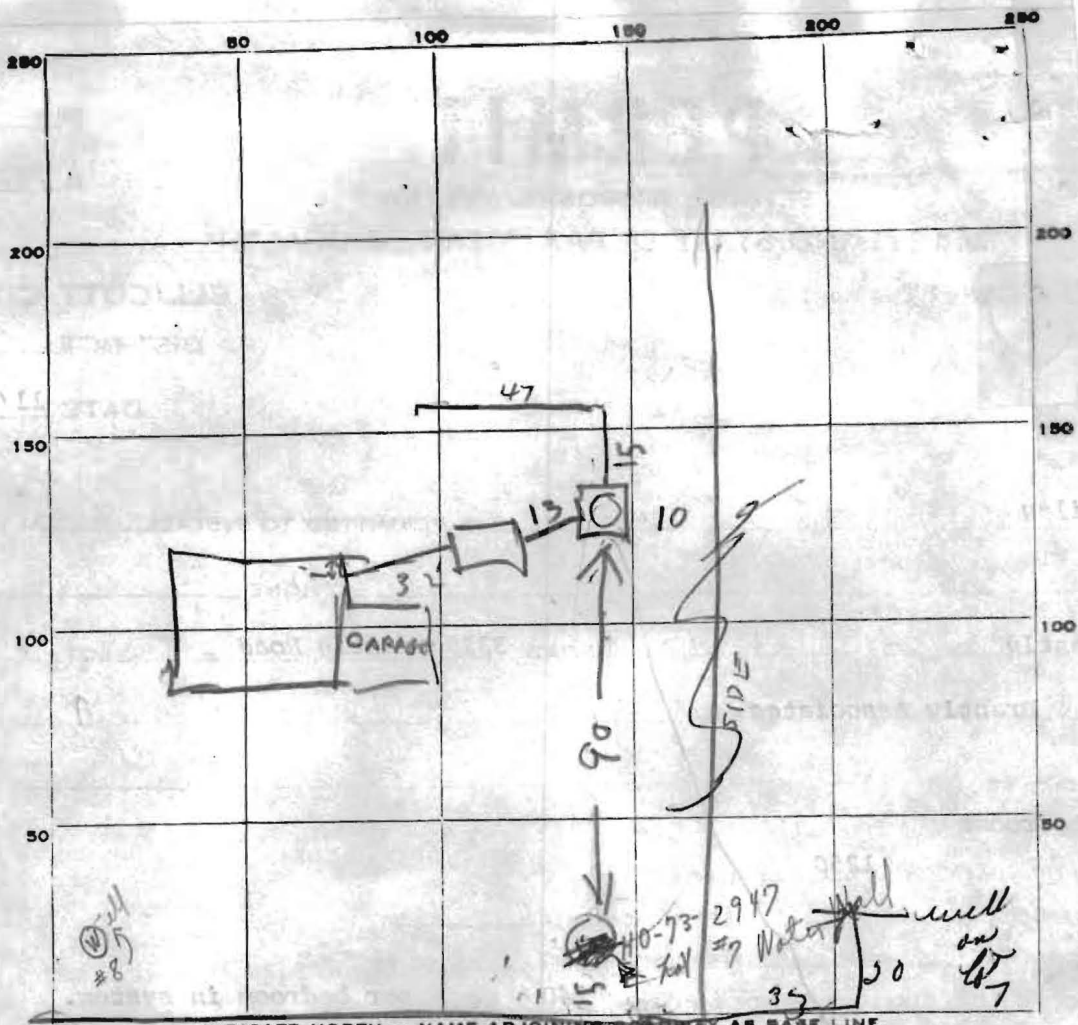

PERMIT CARD (Yes on pile of dirt on #7) stop work till Lot. den ST | DIN
 SEPTIC TANK, LEVEL OK 1300 CLEANOUTS NO | 140
 DISTRIBUTION BOX, LEVEL yes 12/5/78

DITCH
 TILE FIELD, DEPTH 10 FT. TRENCH WIDTH 2 FT.
 GRAVEL DEPTH 6¹⁴ IN. TOTAL LENGTH 48 FT. (1)
 NUMBER OF TRENCHES 1 TOTAL BOTTOM AREA _____
 SEEPAGE PITS, INSIDE DIAMETER 50.5 FT. DEPTH BELOW INLET 6 1/2 FT. (2)

ABSORBENT AREA 32.8 SQ. FT. } 610 sq ft
 REMARKS 12/1/78 DN INLET 4 FT BELOW GRADE

INLET TO DITCH 4 FT BELOW GRADE
ADD STONE TO DITCH & DRY WELL INSTALL CLEANOUTS
ON TANK & DRY WELL CEMENT PIPES & CALL RIT.
12/5/78 Checked - notes - stop work - system appears to be on lot #7.
(Hold for supervisor) + not where called for on spec

DATE SYSTEM APPROVED 12/5/78 INSPECTOR DW Moroz

