



APPLICATION

FOR PERCOLATION TESTING AND SITE EVALUATION

TEST DATE(S) _____ TEST TIME _____ @P 524080

AGENCY REVIEW: _____ DATE 2/14/06

DO NOT WRITE ABOVE THIS LINE

I HEREBY APPLY FOR THE NECESSARY TESTING/EVALUATION PRIOR TO ISSUANCE OF SEWAGE DISPOSAL SYSTEM PERMIT(S) TO:

CHECK AS NEEDED:

- CONSTRUCT NEW SEPTIC SYSTEM(S)
- REPAIR/ADD TO AN EXISTING SEPTIC SYSTEM
- REPLACE AN EXISTING SEPTIC SYSTEM

CHECK AS NEEDED:

- NEW STRUCTURE(S)
- ADDITION TO AN EXISTING STRUCTURE
- REPLACE AN EXISTING STRUCTURE

CHECK ONE:

- CREATE NEW LOT(S)
- BUILD ON AN EXISTING LOT IN A SUBDIVISION
- BUILD ON AN EXISTING PARCEL OF RECORD

IS THE PROPERTY WITHIN 2500' OF ANY RESERVOIR?

- YES
- NO

THE TYPE OF STRUCTURE IS:

- RESIDENTIAL WITH _____ PROPOSED BEDROOMS IN THE COMPLETED STRUCTURE (NOTE **UNKNOWN** IF APPROPRIATE)
- COMMERCIAL (PROVIDE DETAIL OF NUMBERS AND TYPES OF EMPLOYEES/ CUSTOMERS ON ACCOMPANYING PLAN)
- INSTITUTIONAL/GOVERNMENT (PROVIDE DETAIL OF NUMBERS AND TYPES OF EMPLOYEES/USERS ON ACCOMPANYING PLAN)

PROPERTY OWNER(S) William Scheufele

DAYTIME PHONE _____ CELL _____ FAX _____

MAILING ADDRESS 11926 Fredrick Rd Ellicott City Md 21042
STREET CITY/TOWN STATE ZIP

APPLICANT Huffelds Sephe Jeff Reiter

DAYTIME PHONE 301-854-6172 CELL 40 984-0047 FAX 301-490-5794

MAILING ADDRESS PO Box 519 Annapolis Junction Md 20701-0519 MD
STREET CITY/TOWN STATE ZIP

APPLICANT'S ROLE: DEVELOPER BUILDER BUYER RELATIVE/FRIEND REALTOR CONSULTANT

PROPERTY LOCATION
SUBDIVISION/PROPERTY NAME 11926 Fredrick Rd LOT NO. _____

PROPERTY ADDRESS _____
STREET TOWN/POST OFFICE

TAX MAP PAGE(S) _____ GRID _____ PARCEL(S) _____ PROPOSED LOT SIZE _____

AS APPLICANT, I UNDERSTAND THE FOLLOWING: THE SYSTEM INSTALLED SUBSEQUENT TO THIS APPLICATION IS ACCEPTABLE ONLY UNTIL PUBLIC SEWERAGE IS AVAILABLE. THIS APPLICATION IS COMPLETE WHEN ALL APPLICABLE FEES AND A SUITABLE SITE PLAN HAVE BEEN RECEIVED. I ACCEPT THE RESPONSIBILITY FOR COMPLIANCE WITH ALL M.O.S.H.A. AND "MISS UTILITY" REQUIREMENTS. APPROVAL IS BASED UPON SATISFACTORY REVIEW OF A PERC CERTIFICATION PLAN.

TEST RESULTS WILL BE MAILED TO APPLICANT.

Jeff Reiter
SIGNATURE OF APPLICANT

HOWARD COUNTY HEALTH DEPARTMENT, BUREAU OF ENVIRONMENTAL HEALTH, WELL AND SEPTIC PROGRAM
3525-H ELLICOTT MILLS DRIVE, ELLICOTT CITY, MARYLAND 21043-4544 (410) 313-1771 FAX (410) 313-2648
TDD (410) 313-2323 TOLL FREE 1-877-4MD-DHMH

AP 524080

(A)
 Str rd
 SiCL 3 1/2'
 SiLw/
 SiCL
 (transition
 layer) 6'
 v.f brn
 SL
 well drained
 Rock < 10%
 Bottom 14'

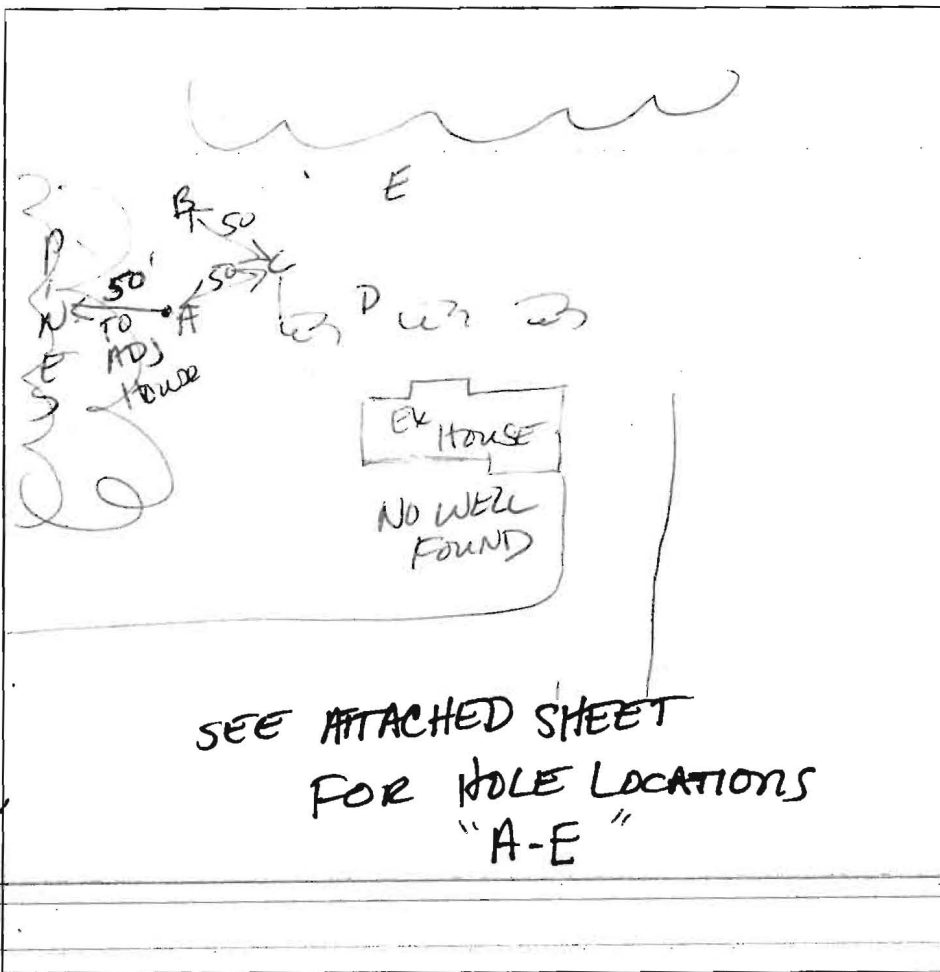

(D)
 West wall
 Str rd
 SiCL
 otherwise
 hvyl
 3'
 It brn
 L
 10'
 stopped
 digging
 due to
 (E) time
 Rdbrn
 CL
 6'
 SL gritty
 SiCL
 frag
 @ 7'
 & 25%
 12'
 Bottom

(B)
 Str brn
 CL 6 1/2'
 brn
 v.f.
 SL / L
 13' Bottom

SEE ATTACHED SHEET
 FOR HOLE LOCATIONS
 "A-E"

DATE	TEST #	DEPTH	START	BREAK 1" DROP	STOP 2" DROP	TIME OF 2nd INCH	P/F/H
2/28/06	A	6 1/2'	2:52	2:57	3:02	5	P
	B	6'	3:00	3:06	3:15	7	P
	C	7 1/2'	poured H2O in rock / SL / S		5 gallons → 20		P
	D	BEST HOLE - VISUAL					P
	E	7 1/2'	3:50	3:51	3:54	3	HP
				DENSE CLAY THEN GRITTY (L green)		LS.	

(C)
 Str brn
 L 2'
 moist
 str brn
 S-LS
 5' (w/ky
 balls)
 14" WIDE
 14" thru middle

REMARKS 160' of Trench
 SANITARIAN Knee BACKHOE Todd OTHERS _____
 TEST HOLES USED IN SDA _____ AVG. PERC TIME 8.5 SQ. FT/BR _____
 TRENCH WIDTH 2 INLET DEPTH 4 MAX. BOT DEPTH 8 EFFECTIVE S/W 2

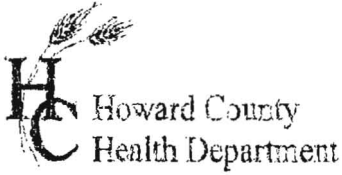

APPLICATION

FOR PERCOLATION TESTING AND SITE EVALUATION

TEST DATE(S) _____ TEST TIME _____ A/P _____

AGENCY REVIEW: _____ DATE _____

(NO PERC NEEDED)

DO NOT WRITE ABOVE THIS LINE

I HEREBY APPLY FOR THE NECESSARY TESTING/EVALUATION PRIOR TO ISSUANCE OF SEWAGE DISPOSAL SYSTEM PERMIT(S) TO:

CHECK AS NEEDED:

- CONSTRUCT NEW SEPTIC SYSTEM(S)
- REPAIR/ADD TO AN EXISTING SEPTIC SYSTEM
- REPLACE AN EXISTING SEPTIC SYSTEM

CHECK AS NEEDED:

- NEW STRUCTURE(S)
- ADDITION TO AN EXISTING STRUCTURE
- REPLACE AN EXISTING STRUCTURE

CHECK ONE:

- CREATE NEW LOT(S)
- BUILD ON AN EXISTING LOT IN A SUBDIVISION
- BUILD ON AN EXISTING PARCEL OF RECORD

IS THE PROPERTY WITHIN 2500' OF ANY RESERVOIR?

- YES
- NO

THE TYPE OF STRUCTURE IS:

- RESIDENTIAL WITH 3 PROPOSED BEDROOMS IN THE COMPLETED STRUCTURE (NOTE UNKNOWN IF APPROPRIATE)
- COMMERCIAL (PROVIDE DETAIL OF NUMBERS AND TYPES OF EMPLOYEES/ CUSTOMERS ON ACCOMPANYING PLAN)
- INSTITUTIONAL/GOVERNMENT (PROVIDE DETAIL OF NUMBERS AND TYPES OF EMPLOYEES/USERS ON ACCOMPANYING PLAN)

PROPERTY OWNER(S) Keum S. Hong, Kyu P. Honey

DAYTIME PHONE 410-746-5806 CELL _____ FAX _____

MAILING ADDRESS 11926 Frederick Rd Ellicott City MD 21042
STREET CITY/TOWN STATE ZIP

APPLICANT Don-Rite Septic Tank Service

DAYTIME PHONE 443-790-0470 CELL 443-790-0470 FAX 410-374-1240

MAILING ADDRESS 3084 Shamer Ln Hampstead MD 21074
STREET CITY/TOWN STATE ZIP

APPLICANT'S ROLE: DEVELOPER BUILDER BUYER RELATIVE/FRIEND REALTOR CONSULTANT

PROPERTY LOCATION
SUBDIVISION/PROPERTY NAME _____ LOT NO. _____

PROPERTY ADDRESS _____
STREET TOWN/POST OFFICE

TAX MAP PAGE(S) _____ GRID _____ PARCEL(S) _____ PROPOSED LOT SIZE _____

AS APPLICANT, I UNDERSTAND THE FOLLOWING: THE SYSTEM INSTALLED SUBSEQUENT TO THIS APPLICATION IS ACCEPTABLE ONLY UNTIL PUBLIC SEWERAGE IS AVAILABLE. THIS APPLICATION IS COMPLETE WHEN ALL APPLICABLE FEES AND A SUITABLE SITE PLAN HAVE BEEN RECEIVED. I ACCEPT THE RESPONSIBILITY FOR COMPLIANCE WITH ALL M.O.S.H.A. AND "MISS UTILITY" REQUIREMENTS. APPROVAL IS BASED UPON SATISFACTORY REVIEW OF A PERC CERTIFICATION PLAN. TEST RESULTS WILL BE MAILED TO APPLICANT.

Jessica Harlow
SIGNATURE OF APPLICANT

HOWARD COUNTY HEALTH DEPARTMENT, BUREAU OF ENVIRONMENTAL HEALTH, WELL AND SEPTIC PROGRAM
 7178 COLUMBIA GATEWAY DRIVE COLUMBIA, MARYLAND 21046 (410) 313-1771 FAX (410) 313-2648
 TDD (410) 313-2325 TOLL FREE 1-877-4MD-DHMH

562.5

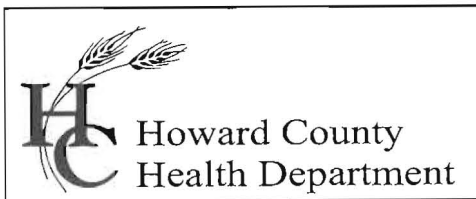

Bureau of Environmental Health
7178 Columbia Gateway Drive, Columbia, MD 21046
(410) 313-2640 Fax (410) 313-2648
TDD (410) 313-2323 Toll Free 1-866-313-6300
website: www.hchealth.org

Penny E. Borenstein, M.D., M.P.H., Health Officer

March 2, 2006

Mr. William Scheufele
11926 Frederick Road
Ellicott City, MD 21042

RE: **Percolation Test Results**
Application: A524080

Proposal: Establish septic area for home improvement/ new houses
Property ID: 11926 Frederick Road
Tax Map: 16 Parcel: 149

Dear Mr. Scheufele

Percolation testing was conducted on February 28, 2006 for the above referenced property. Soils indicate restrictive soils to approximately 6' with well drained loam and sandy loam to 12'. A quartz rock vein was encountered within hole C, however, appears to be a anomaly compared to the surrounding holes. Review of the percolation test notes supports a four bedroom home on this lot of record. Copies of the percolation test results are enclosed.

A **licensed surveyor** should submit a Percolation Certification Plan showing the following information to this office for Health Officer signature and prior to any future permit signatures:

- Field-located actual locations of all excavated test holes and label holes as done on sanitarian perc notes
- Identify any surrounding wells and also label which homes are on public water (both exists in nearby vicinity of parcel 149)
- show the existing house site as well as the new house site (footprint usually 55 feet by 70 feet)
- **locations of all existing wells and septic systems on the property**
- locations and intent of all existing structures on the property
- locations of streams/ponds/swales/springs and any other features on the property
- field matched contour lines at 2-foot intervals
- location of all existing wells and septic systems within 200 feet of all property boundaries
- source of topography with areas of excessive slope clearly indicated
- include all applicable 'General Notes' as well as a statement to abandon existing wells not in use(2 of them, one on existing property and one on proposed lot 4) prior to building permit issuance.

This plan should be submitted within sixty (60) days to allow field verification if necessary.

If you have any questions regarding this matter, please contact me at the address below or by calling (410) 313-1771. Thank you in advance for your time and cooperation.

Sincerely,

Kacie Noonan, R.S.
Well and Septic Program

Enclosures
Cc: Hatfields