

LAYOUT 11/27/12 INSP 4 _____
 INSP 2 11/28/12 INSP 5 _____
 INSP 3 _____ INSP 6 _____

ISSUE DATE: 11/2/12
 APPROVAL DATE: 11/28/12

PERMIT

P 538122
 A 518964

Tax ID # 04-372492

**ON-SITE SEWAGE DISPOSAL SYSTEM
 HOWARD COUNTY HEALTH DEPARTMENT
 BUREAU OF ENVIRONMENTAL HEALTH**

Fogles IS PERMITTED TO INSTALL ALTER

ADDRESS: _____ PHONE NUMBER: 410-795-5670

SUBDIVISION: 14537 Edgewood Farm LOT NUMBER: 23

ADDRESS: 14537 Edgewoods Way PROPERTY OWNER: Toll MD V LP

SEPTIC TANK CAPACITY (GALLONS): 2000 OUTLET BAFFLE FILTER REQUIRED

PUMP CHAMBER CAPACITY (GALLONS): _____ COMPARTMENTED TANK REQUIRED

NUMBER OF BEDROOMS: 4 APPLICATION RATE: 1.2

SQUARE FOOTAGE OF HOUSE: 3,798

LINEAR FEET OF TRENCH REQUIRED: 103' 150' 3.5'-5.5' 3x50' (KWD)

TRENCHES:	Trenches to be 3.0 feet wide. Inlet is at 3.0 feet below original grade with 2.0 feet of stone below the distribution pipe. Bottom maximum depth is 6.0 feet below original grade. Effective sidewall begins at 4.0 feet below original grade. Maintain at least 9.0 feet of spacing between trenches.
LOCATION:	Set septic tank per layout inspection. Set distribution box at the highest point of the easement per layout inspection. Install 103 feet of trench on contour per layout inspection.
NOTES:	Do not order the septic tank until after layout inspection and Sanitarian approval. Stake easement corners. Call for layout inspection. Mark utilities. Gravel tickets must be available for Environmental Sanitarians. Stone must be approved by the Howard County Health Department. A written variance request is required for tanks deeper than 3 feet. A traffic bearing lid is required for tanks deeper than 4 feet.

PLANS APPROVED: Dana Bernard DATE: 8/6/12

- NOTE: PERMIT VOID AFTER 2 YEARS
- NOTE: CONTRACTOR RESPONSIBLE FOR SCHEDULING A PRE-CONSTRUCTION INSPECTION FOR ALL INSTALLATIONS
- NOTE: WATERTIGHT SEPTIC TANKS REQUIRED
- NOTE: ALL PARTS OF SEPTIC SYSTEM SHALL BE 100 FEET FROM ANY WATER WELL
- NOTE: MANHOLE RISERS REQUIRED ON ALL SEPTIC TANKS AND PUMP CHAMBERS

**NEITHER THE HOWARD COUNTY COUNCIL OR THE HEALTH DEPARTMENT IS RESPONSIBLE FOR
 THE SUCCESSFUL OPERATION OF ANY SYSTEM
 PERMITTEE RESPONSIBLE FOR OBTAINING FINAL APPROVAL ON THIS PERMIT
 CALL 410-313-1771 FOR INSPECTION OF SEPTIC SYSTEM**

NOT TO SCALE

* See Separate Sheet
For As-Built

ROAD NAME

TRENCH/DRAINFIELD DATA

WIDTH	INLET	BOTTOM
<u>3</u>	<u>3 1/2</u>	<u>5 1/2</u>
NUMBER OF TRENCHES		<u>3</u>
TOTAL LENGTH		<u>155'</u>
ABSORPTION AREA		<u>465'±SW</u>
DISTRIBUTION BOX LEVEL		<u>Levelers</u>
DISTRIBUTION BOX BAFFLE		<u>Yes</u>
DISTRIBUTION BOX PORT		<u>Yes</u>

SEPTIC TANK DATA

SEPTIC TANK I LEVEL	<u>Yes</u>
MANUFACTURER	<u>Babylon</u>
CAPACITY	<u>2000</u> GAL
SEAM LOC	<u>Top</u>
TANK LID DEPTH	<u>3'</u>
BAFFLES	<u>Yes</u>
BAFFLE FILTER	<u>—</u>
MANHOLE LOC	<u>Front/Rear</u>
6" PORT LOC	<u>none</u>
WATERTIGHT TEST	<u>—</u>
SLOTTED	<u>Yes</u>
DATE ON LID	<u>10-19-12</u>

PUMP/SEPTIC TANK LEVEL N/A

MANUFACTURER	_____
CAPACITY	_____ GAL
SEAM LOC	_____
TANK LID DEPTH	_____
BAFFLES	_____
BAFFLE FILTER	_____
MANHOLE LOC	_____
6" PORT LOC	_____
WATERTIGHT TEST	_____
SLOTTED	_____
DATE ON LID	_____

PRE-CONSTRUCTION:

11/27/12 Set S.T. per approved 3P plan. Install 3x50' trenches running on contour across Septic area towards lot 22. Trench spec's adjusted slightly. (Handwritten note)

INSTALLATION:

11/29/12 (am) S.T. set, STC installed. Trenches started. (pm) 11/29/12 Trenches complete. D box knocked. OK to cover all work

FINAL INSPECTOR

R. Wang

DATE OF APPROVAL

11/29/12

NOT TO SCALE

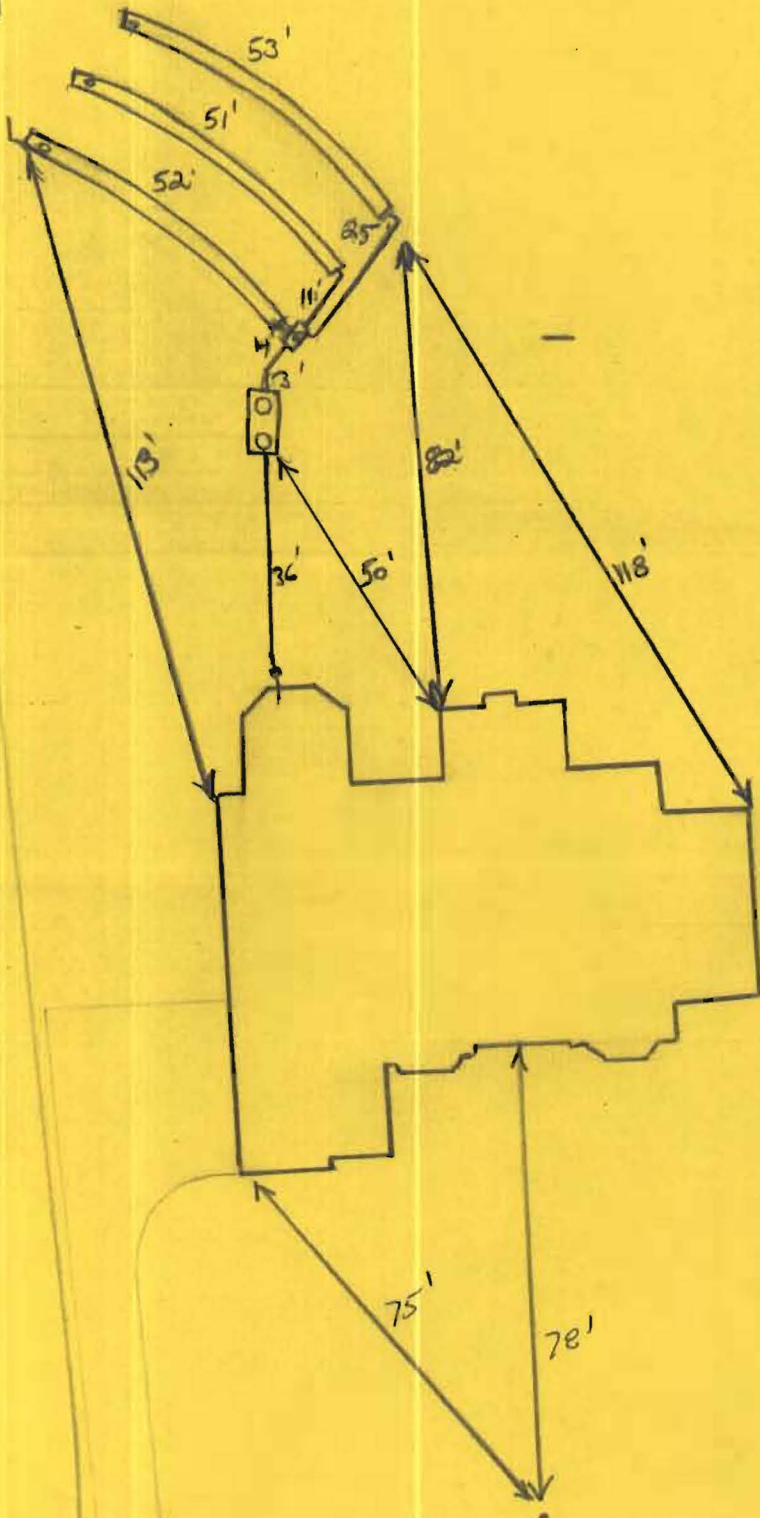

HO-95-0553

