

C1 3367

SEQUENCE NO. (MDE USE ONLY)

STATE OF MARYLAND WELL COMPLETION REPORT

THIS REPORT MUST BE SUBMITTED WITHIN 45 DAYS AFTER WELL IS COMPLETED.

(THIS NUMBER IS TO BE PUNCHED IN COLS. 3-6 ON ALL CARDS)

COUNTY NUMBER

ST/CO USE ONLY DATE Received

DATE WELL COMPLETED

Depth of Well

PERMIT NO. FROM "PERMIT TO DRILL WELL" HO-95-1593

OWNER CASEY MARIA & MARTIN STREET OR RFD 14301 FOX CREEK CT TOWN COOKSVILLE SUBDIVISION MONTICELLO SECTION LOT

WELL LOG

Not required for driven wells

STATE THE KIND OF FORMATIONS PENETRATED, THEIR COLOR, DEPTH, THICKNESS AND IF WATER BEARING

Table with columns: DESCRIPTION, FEET (FROM, TO), check if water bearing. Rows: Top Soil (0-2), Brown mica (2-30), Grey mica (30-700).

GROUTING RECORD

WELL HAS BEEN GROUTED (Y) NO (N) TYPE OF GROUTING MATERIAL (C) BENTONITE CLAY (BC) NO. OF BAGS 20 NO. OF POUNDS 2000 GALLONS OF WATER 120 DEPTH OF GROUT SEAL (to nearest foot) from 0 ft. to 48 ft.

CASING RECORD

MAIN CASING TYPE (ST) Nominal diameter top (main) casing (nearest inch)! 6 Total depth of main casing (nearest foot) 60

OTHER CASING (if used) diameter inch depth (feet) from to

SCREEN RECORD

screen type or open hole (ST) (BR) (HO) (PL) (OT) DEPTH (nearest ft.) 140 58 700

C2

GRAVEL PACK IF WELL DRILLED WAS FLOWING WELL INSERT F IN BOX 68 MDE USE ONLY (NOT TO BE FILLED IN BY DRILLER) TELESCOPE CASING LOG INDICATOR OTHER DATA

C3

PUMPING TEST

HOURS PUMPED (nearest hour) 3 PUMPING RATE (gal. per min.) 12 METHOD USED TO MEASURE PUMPING RATE Bucket WATER LEVEL (distance from land surface) BEFORE PUMPING 50 ft. WHEN PUMPING 700 ft. TYPE OF PUMP USED (for test) (A) air (P) piston (T) turbine (C) centrifugal (R) rotary (O) other (J) jet (S) submersible

PUMP INSTALLED

DRILLER INSTALLED PUMP (YES) (NO) IF DRILLER INSTALLS PUMP, THIS SECTION MUST BE COMPLETED FOR ALL WELLS. TYPE OF PUMP INSTALLED PLACE (A,C,J,P,R,S,T,O) IN BOX 29. CAPACITY: GALLONS PER MINUTE (to nearest gallon) 31 35 PUMP HORSE POWER 37 41 PUMP COLUMN LENGTH (nearest ft.) 43 47 CASING HEIGHT (circle appropriate box and enter casing height) (A) above (B) below LAND SURFACE 2 (nearest) foot

LOCATION OF WELL ON LOT

SHOW PERMANENT STRUCTURE SUCH AS BUILDING, SEPTIC TANKS, AND /OR LANDMARKS AND INDICATE NOT LESS THAN TWO DISTANCES (MEASUREMENTS TO WELL)

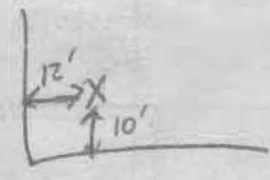

B 1 1890

SEQUENCE NO. (MDE USE ONLY)

STATE OF MARYLAND APPLICATION FOR PERMIT TO DRILL WELL 52 8857 please type

STATE PERMIT NUMBER

HD-95-1593

fill in this form completely

Date Received (APA) 10789

OWNER INFORMATION

8 MM DD YY 13

CASEY MARIA Last Name Owner First Name 34 14301 FOX CREEK COURT Street or RFD 55 57 Town 70 State 72 Zip 76

B 3

LOCATION OF WELL

Howard 21 8 COUNTY 21 Monticello 42 23 SUBDIVISION 44 SECTION 44 46 LOT 48 50 52 NEAREST TOWN Cooksville MILES FROM TOWN (enter 0 if in town) 1 M I 73 76 77 78

DRILLER INFORMATION

George F. Easterday M VD 040 76 License No. 81 L. Franklin Easterday, Inc. 9265 Brown Church Rd., MT. Airy, Md. 21771 Address George F. Easterday 3/19/2008 Signature Date

B 4

DIRECTION OF WELL FROM TOWN (CIRCLE BOX)

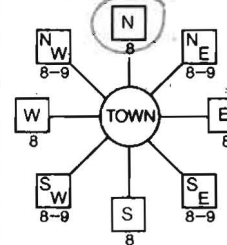

14301 Fox Creek Court 11 NEAR WHAT ROAD 30 ON WHICH SIDE OF ROAD (CIRCLE APPROPRIATE BOX) NORTH WEST EAST SOUTH 34 50 37 DISTANCE FROM ROAD ENTER FT OR MI 38 39 TAX MAP: 8 BLK: 18 PARCEL 110

WELL INFORMATION

APPROX. PUMPING RATE (GAL. PER MIN.) 5 8 12 AVERAGE DAILY QUANTITY NEEDED (GAL. PER DAY) 14 500 20

USE FOR WATER (CIRCLE APPROPRIATE BOX)

- [D] DOMESTIC POTABLE SUPPLY & RESIDENTIAL IRRIGATION [F] FARMING (LIVESTOCK WATERING & AGRICULTURAL IRRIGATION) [I] INDUSTRIAL, COMMERCIAL, DEWATERING [P] PUBLIC WATER SUPPLY WELL [T] TEST, OBSERVATION, MONITORING [G] GEO-THERMAL

NOT TO BE FILLED IN BY DRILLER HEALTH DEPARTMENT APPROVAL

Howard A59914-7 COUNTY NAME COUNTY NO. STATE SIGNATURE INSERT S DATE ISSUED 3/16/08 3/16/08 43 MM DD YY 48 CO SIGNATURE EXP. DATE NORTH GRID 544 000 EAST GRID 797 000 50 55 57 63

APPROXIMATE DEPTH OF WELL 300 24 28 FEET

APPROXIMATE DIAMETER OF WELL 6 NEAREST INCH

METHOD OF DRILLING (circle one)

BORED (or Augered) JETTED Jetted & DRIVEN AIR-ROTary AIR-PERCussion ROTARY (Hydraulic Rotary) CABLE REVerse-ROTary Drive-POINT other

REPLACEMENT OR DEEPEMED WELLS (CIRCLE APPROPRIATE BOX)

- [N] THIS WELL WILL NOT REPLACE AN EXISTING WELL [Y] THIS WELL WILL REPLACE A WELL THAT WILL BE ABANDONED AND SEALED [S] THIS WELL WILL REPLACE A WELL THAT WILL BE USED AS A STANDBY-CONTACT LOCAL APPROVING AUTHORITY FOR POLICY ON STANDBY WELLS [D] THIS WELL WILL DEEPEM AN EXISTING WELL PERMIT NUMBER OF WELL TO BE REPLACED OR DEEPEMED (IF AVAILABLE) 41 52

Not to be filled in by driller (MDE OR COUNTY USE ONLY)

APPROX. PERMIT NUMBER G PERMIT No. HD-95-1593 70 71 72 73 74 75 76 77 78 79

SHOW MAJOR FEATURES OF BOX & LOCATE WELL WITH AN X

- SOURCES OF DRILLING WATER 1. wells 2. 3.

WRITE THE BOX NUMBER FROM THE MAP HERE

E 797 7 797 7 797 7 N 450 544 000 000

DRAW A SKETCH BELOW SHOWING LOCATION OF WELL IN RELATION TO NEARBY TOWNS AND ROADS AND GIVE DISTANCE FROM WELL TO NEAREST ROAD JUNCTION 4E11

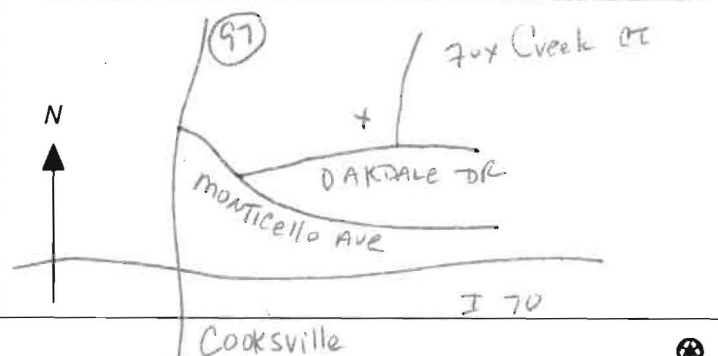

SPECIAL CONDITIONS

NOTE - APPROVING AUTHORITIES SHOULD USE SEPARATE SHEET IF NEEDED

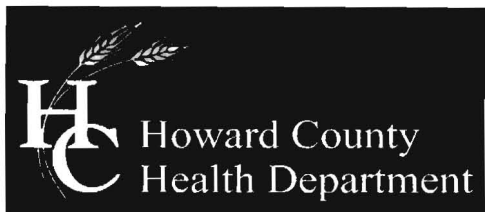

Bureau of Environmental Health
7178 Columbia Gateway Drive, Columbia, MD 21046-2147
(410) 313-2640 Fax (410) 313-2648
TDD (410) 313-2323 Toll Free 1-866-313-6300
website: www.hchealth.org

Peter L. Beilenson, M.D., M.P.H., Health Officer

September 15, 2009

Martin Casey
14301 Fox Creek Ct.
Cooksville, Maryland 21723

RE: **Replacement Well**
14301 Fox Creek Ct.
Permit #: HO-95-1593

Dear Mr. Casey:

Our records indicate a replacement well was completed on your property on 4/7/08. Maryland Regulations (COMAR 26.04.04) require that all new wells that are drilled for potable water use be sampled twice as a form of protection for Maryland residents. Please call the Community Hygiene Program at **(410) 313-1773** to schedule the collection of the initial water sample. **Currently there is no charge for the sampling.**

It is preferred that the sample be collected from an indoor faucet. If this is not possible, the sample may be taken from an outside hose bib. However, the potential for the collection of a failing water sample increases when samples are taken from sources exposed to the outside environment.

Respectfully,

Sara Sappington, R.S.
Well & Septic Program

cc: Community Services Program
File

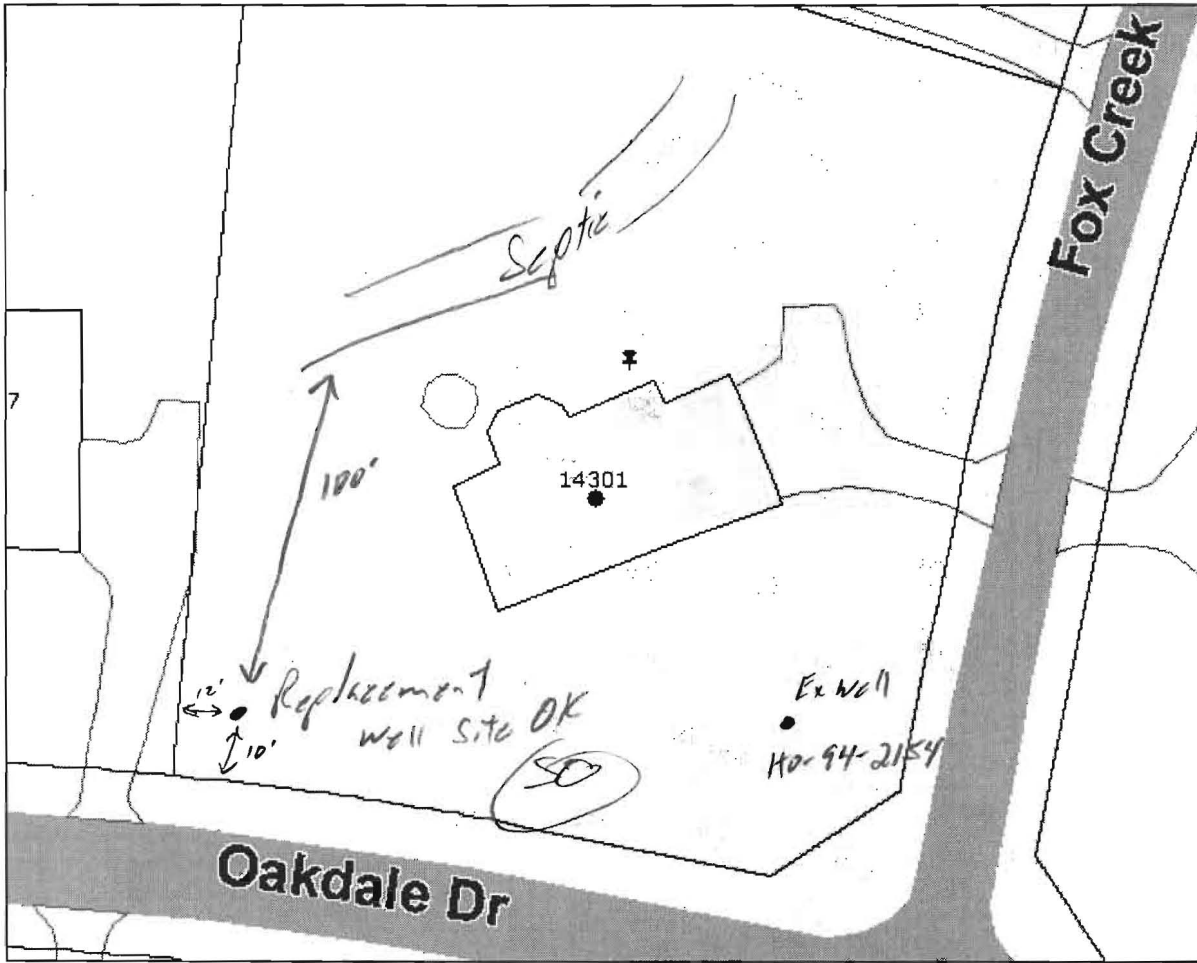

14301 Fox Creek Ct

3/18/08 Site inspection, site OK (SD)