



Building Permit Application

Howard County Maryland
Department of Inspections, Licenses and Permits
3430 Court House Drive
Permits: 410-313-2455
www.howardcountymd.gov

Date Received: _____

Permit No.: _____

Building Address: 14078 Paterson Farm Ct
 City: Glenelg State: md Zip Code: 21737
 Suite/Apt. # _____ SDP/WP/BA #: _____
 Census Tract: _____ Subdivision: Hopkins Choice
 Section: _____ Area: _____ Lot: 9
 Tax Map: _____ Parcel: 0111 Grid: 0012
 Zoning: _____ Map Coordinates: _____ Lot Size: .758 ac.

Existing Use: _____
 Proposed Use: _____
 Estimated Construction Cost: \$ 22000.-
 Description of Work: Add Deck to Rear of Home with Steps to Grade
 Occupant or Tenant: _____
 Was tenant space previously occupied? Yes No
 Contact Name: _____
 Address: _____
 City: _____ State: _____ Zip Code: _____
 Phone: _____ Fax: _____
 Email: _____

Property Owner's Name: Erik Bloomquist
 Address: 14078 Paterson Farm Ct
 City: Glenelg State: md Zip Code: 21737
 Phone: 310-903-2579 Fax: _____
 Email: _____

Applicant's Name & Mailing Address, (If other than stated herein)
 Applicant's Name: Matney Construction
 Address: P.O. Box 1018
 City: MT AIRY State: md Zip Code: 21771
 Phone: 410-635-2500 Fax: 410-635-2964
 Email: Rick@matneyconstruction.com

Contractor Company: Matney Construction Services
 Contact Person: Rick Matney
 Address: P.O. Box 1018
 City: MT AIRY State: md Zip Code: 21771
 License No.: 89780
 Phone: 410-635-2500 Fax: 410-635-2964
 Email: Rick@matneyconstruction.com

Engineer/Architect Company: _____
 Responsible Design Prof.: _____
 Address: _____
 City: _____ State: _____ Zip Code: _____
 Phone: _____ Fax: _____
 Email: _____

Commercial Building Characteristics	Residential Building Characteristics
Height:	<input checked="" type="checkbox"/> SF Dwelling <input type="checkbox"/> SF Townhouse
No. of stories:	<u>Depth</u> <u>Width</u>
Gross area, sq. ft./floor:	1 st floor:
	2 nd floor:
Area of construction (sq. ft.):	Basement:
	<input type="checkbox"/> Finished Basement
Use group:	<input type="checkbox"/> Unfinished Basement
	<input type="checkbox"/> Crawl Space
Construction type:	<input type="checkbox"/> Slab on Grade
<input type="checkbox"/> Reinforced Concrete	No. of Bedrooms:
<input type="checkbox"/> Structural Steel	Multi-family Dwelling
<input type="checkbox"/> Masonry	No. of efficiency units:
<input type="checkbox"/> Wood Frame	No. of 1 BR units:
<input type="checkbox"/> State Certified Modular	No. of 2 BR units:
	No. of 3 BR units:
	Other Structure:
	Dimensions:
<input checked="" type="checkbox"/> Roadside Tree Project Permit	Footings:
<input type="checkbox"/> Yes <input checked="" type="checkbox"/> No	Roof:
Roadside Tree Project Permit #	<input type="checkbox"/> State Certified Modular
	<input type="checkbox"/> Manufactured Home

Utilities	
Water Supply	
<input type="checkbox"/> Public	
<input checked="" type="checkbox"/> Private	
Sewage Disposal	
<input checked="" type="checkbox"/> Public	
<input type="checkbox"/> Private	
Electric: <input type="checkbox"/> Yes <input type="checkbox"/> No	
Gas: <input type="checkbox"/> Yes <input type="checkbox"/> No	
Heating System	
<input type="checkbox"/> Electric <input type="checkbox"/> Oil	
<input type="checkbox"/> Natural Gas <input type="checkbox"/> Propane Gas	
<input type="checkbox"/> Other:	
Sprinkler System:	
<input type="checkbox"/> Yes <input type="checkbox"/> No	
Grading Permit Number:	
Building Shell Permit Number:	

THE UNDERSIGNED HEREBY CERTIFIES AND AGREES AS FOLLOWS: (1) THAT HE/SHE IS AUTHORIZED TO MAKE THIS APPLICATION; (2) THAT THE INFORMATION IS CORRECT; (3) THAT HE/SHE WILL COMPLY WITH ALL REGULATIONS OF HOWARD COUNTY WHICH ARE APPLICABLE THERETO; (4) THAT HE/SHE WILL PERFORM NO WORK ON THE ABOVE REFERENCED PROPERTY NOT SPECIFICALLY DESCRIBED IN THIS APPLICATION; (5) THAT HE/SHE GRANTS COUNTY OFFICIALS THE RIGHT TO ENTER ONTO THIS PROPERTY FOR THE PURPOSE OF INSPECTING THE WORK PERMITTED AND POSTING NOTICES.

Applicant's Signature _____

Print Name _____

Email Address _____

Date _____

Health Dept Approved 3/31/15 H. Osgood

FRIK Bloomqvist
14078 Patterson Farm Ct
61wcl9, md 21737
300-903-2579

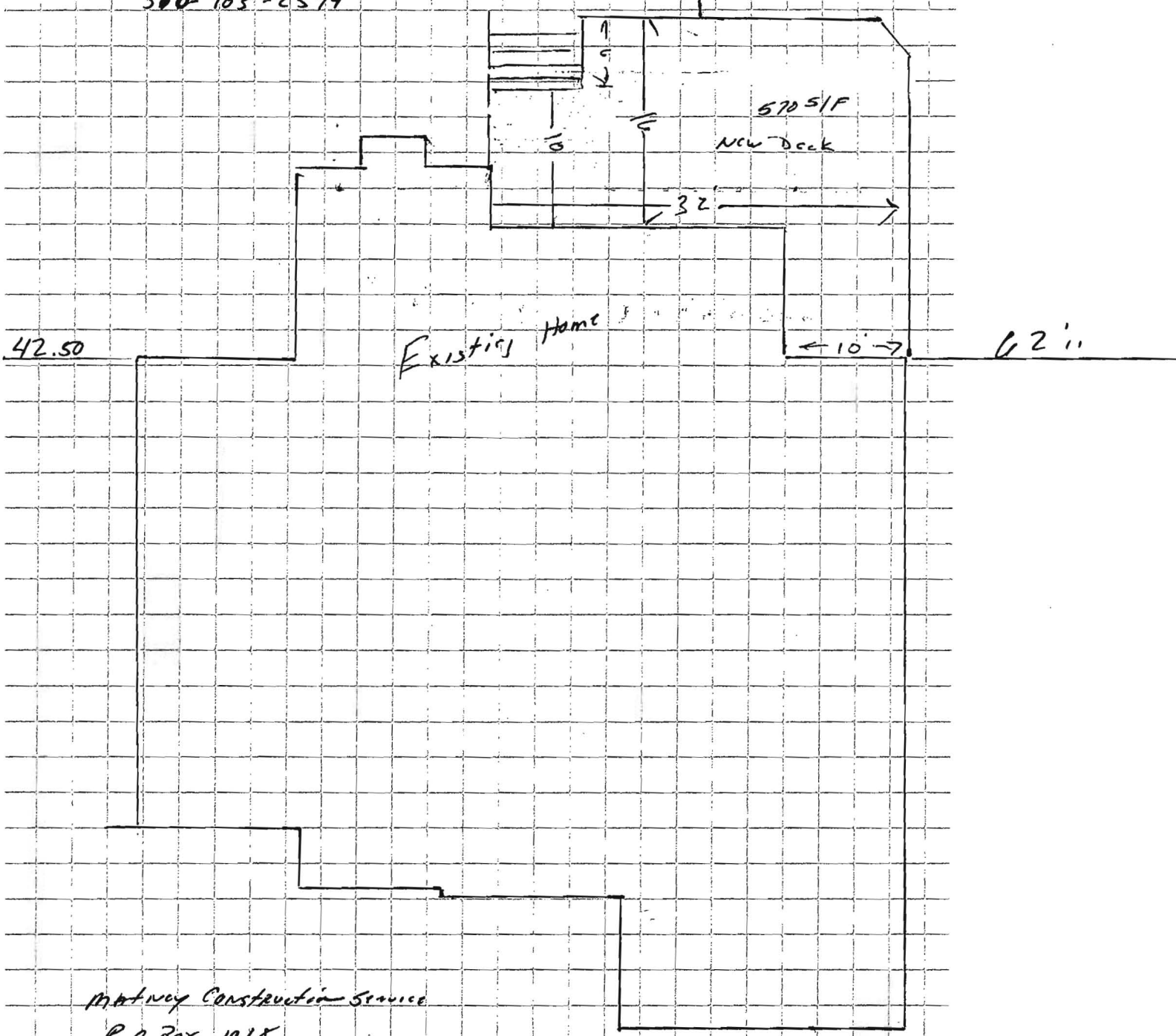

Matney Construction Service
P.O. Box 1018
MT AIRY, MD 21771
MHIC 89780
410-635-2520

3/32 Scale

PATTERSON FARM CT.

