



Building Permit Application

Howard County Maryland
Department of Inspections, Licenses and Permits
3430 Court House Drive
Permits: 410-313-2455
www.howardcountymd.gov

Date Received: _____

Permit No.: _____

Building Address: 16331 Cattail River Dr
City: WOODBINE State: MD Zip Code: 2
Suite/Apt. # _____ SDP/WP/BA #: _____
Census Tract: _____ Subdivision: _____
Section: _____ Area: _____ Lot: _____
Tax Map: _____ Parcel: _____ Grid: _____
Zoning: _____ Map Coordinates: _____ Lot Size: _____

Existing Use: SFD
Proposed Use: 18x16 Deck w/Landing w/ STAIRS
Estimated Construction Cost: \$ 14,000
Description of Work: 18x14 DECK w/ Landing w/ STAIRS

Occupant or Tenant: _____
Was tenant space previously occupied? Yes No
Contact Name: _____
Address: _____
City: _____ State: _____ Zip Code: _____
Phone: _____ Fax: _____
Email: _____

Commercial Building Characteristics	Residential Building Characteristics
Height:	<input checked="" type="checkbox"/> SF Dwelling <input type="checkbox"/> SF Townhouse
No. of stories:	Depth Width
Gross area, sq. ft./floor:	1 st floor:
	2 nd floor:
Area of construction (sq. ft.):	Basement:
	<input type="checkbox"/> Finished Basement
Use group:	<input type="checkbox"/> Unfinished Basement
	<input type="checkbox"/> Crawl Space
Construction type:	<input type="checkbox"/> Slab on Grade
<input type="checkbox"/> Reinforced Concrete	No. of Bedrooms:
<input type="checkbox"/> Structural Steel	Multi-family Dwelling
<input type="checkbox"/> Masonry	No. of efficiency units:
<input type="checkbox"/> Wood Frame	No. of 1 BR units:
<input type="checkbox"/> State Certified Modular	No. of 2 BR units:
	No. of 3 BR units:
	Other Structure:
	Dimensions:
<input checked="" type="checkbox"/> Roadside Tree Project Permit	Footings:
<input type="checkbox"/> Yes <input type="checkbox"/> No	Roof:
Roadside Tree Project Permit #	<input type="checkbox"/> State Certified Modular
	<input type="checkbox"/> Manufactured Home

Property Owner's Name: JIMMY PATER
Address: 16331 Cattail River Dr
City: WOODBINE State: MD Zip Code: _____
Phone: _____ Fax: _____
Email: _____

Applicant's Name & Mailing Address, (if other than stated herein)
Applicant's Name: _____
Address: _____
City: _____ State: _____ Zip Code: _____
Phone: _____ Fax: _____
Email: _____

Contractor Company: TIMELESS CONST.
Contact Person: DAVID BENFER
Address: 5364 Hesperus Dr
City: Columbia State: MD Zip Code: 21044
License No.: MHTC # 95285
Phone: 301-674-3604 Fax: _____
Email: dcbenfer@gmail.com

Engineer/Architect Company: _____
Responsible Design Prof.: _____
Address: _____
City: _____ State: _____ Zip Code: _____
Phone: _____ Fax: _____
Email: _____

Utilities	
Water Supply	
<input type="checkbox"/> Public	
<input checked="" type="checkbox"/> Private	
Sewage Disposal	
<input type="checkbox"/> Public	
<input checked="" type="checkbox"/> Private	
Electric: <input type="checkbox"/> Yes <input type="checkbox"/> No	
Gas: <input type="checkbox"/> Yes <input type="checkbox"/> No	
Heating System	
<input type="checkbox"/> Electric <input type="checkbox"/> Oil	
<input type="checkbox"/> Natural Gas <input type="checkbox"/> Propane Gas	
<input type="checkbox"/> Other:	
Sprinkler System:	
<input type="checkbox"/> Yes <input type="checkbox"/> No	
Grading Permit Number:	
Building Shell Permit Number:	

THE UNDERSIGNED HEREBY CERTIFIES AND AGREES AS FOLLOWS: (1) THAT HE/SHE IS AUTHORIZED TO MAKE THIS APPLICATION; (2) THAT THE INFORMATION IS CORRECT; (3) THAT HE/SHE WILL COMPLY WITH ALL REGULATIONS OF HOWARD COUNTY WHICH ARE APPLICABLE THERETO; (4) THAT HE/SHE WILL PERFORM NO WORK ON THE ABOVE REFERENCED PROPERTY NOT SPECIFICALLY DESCRIBED IN THIS APPLICATION; (5) THAT HE/SHE GRANTS COUNTY OFFICIALS THE RIGHT TO ENTER ONTO THIS PROPERTY FOR THE PURPOSE OF INSPECTING THE WORK PERMITTED AND POSTING NOTICES.

Applicant's Signature: [Signature]
Email Address: dcbenfer@gmail.com
Title/Company: owner / TIMELESS

Print Name: DAVID BENFER
Date: 4/22/15

Checks Payable to: DIRECTOR OF FINANCE OF HOWARD COUNTY
PLEASE WRITE NEATLY & LEGIBLY
-FOR OFFICE USE ONLY-

AGENCY	DATE	SIGNATURE OF APPROVAL
State Highways		
Building Officials		
PSZA (Zoning)		
PSZA (Engineering)		
Health	<u>4/22/15</u>	<u>H. OSWALD</u>

Is Sediment Control approval required for issuance? Yes No
 CONTINGENCY CONSTRUCTION START

DPZ SETBACK INFORMATION
Front:
Rear:
Side:
Side St.:
All minimum setbacks met? <input type="checkbox"/> Yes <input type="checkbox"/> No
Is Entrance Permit Required? <input type="checkbox"/> Yes <input type="checkbox"/> No
Historic District? <input type="checkbox"/> Yes <input type="checkbox"/> No
Lot Coverage for New Town Zone:
SDP/Red-line approval date:

Filing Fee	\$
Permit Fee	\$
Tech Fee	\$
Excise Tax	\$
PSFS	\$
Guaranty Fund	\$
Add'l per Fee	\$
Total Fees	\$
Sub-Total Paid	\$
Balance Due	\$
Check	#

Distribution of Copies: White: Building Officials Green: PSZA,Zoning Yellow: PSZA,Engineering Pink: Health Gold: SHA

FUTURE IMPROVEMENTS. THIS PLAT DOES NOT PROVIDE THE ACCURATE IDENTIFICATION OF PROPERTY BOUNDARY LINES, BUT SUCH IDENTIFICATION MAY NOT BE REQUIRED FOR THE TRANSFER OF TITLE OR SECURING FINANCING OR REFINANCING. THIS PLAT CONTAINS A TOLERANCE OF ACCURACY OF 0.5' MORE OR LESS.

MARYLAND STATE GRID UTM83/91

10' PUBLIC TREE MAINTENANCE EASEMENT

CATTAIL RIVER DRIVE
(PUBLIC ACCESS PLACE)
40' RIGHT-OF-WAY

R=430.00'
L=48.11'

S31°04'21"W
50.00'

HO-95-0109

N65°20'18"W
105.63'

APPROVED

WALK-THRU BUILDING PERMIT

BE# _____ A# _____

APPLICANT: San H. Oswald DATE: 4/22/14

DESC. OF WORK: Construct 18'x16' deck w/ landing & steps.

6' PUBLIC DRAINAGE & UTILITY EASEMENT

SEE DETAIL

ASPHALT DRIVE
49.0'

18'x16' DECK

LOT 6
48,193 S.F.

LOT 7

N17°57'24"E
269.62'



N24°39'42"E
10' BRL

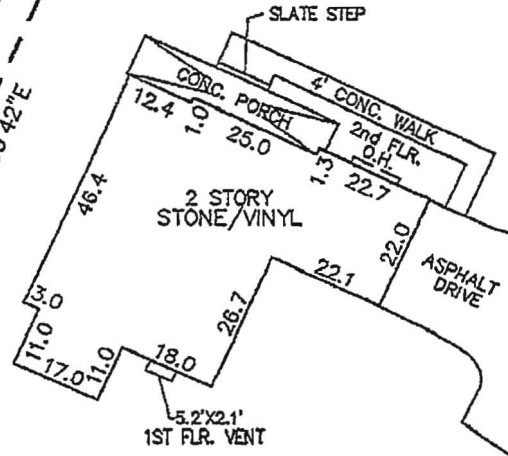

DETAIL: 1"=30'
NOT TO SCALE

NON-BUILDABLE PRESERVATION PARCEL "D"
N49°08'46"W
133.02'



I HEREBY CERTIFY TO THE BEST OF MY KNOWLEDGE, INFORMATION AND BELIEF THAT THE IMPROVEMENTS ARE LOCATED AS SHOWN AND THERE ARE NO ENCROACHMENTS EXCEPT AS SHOWN.

Thomas M. Hoffman

4-29-14

PROFESSIONAL CERTIFICATION: I HEREBY CERTIFY THAT THESE DOCUMENTS WERE PREPARED BY ME OR UNDER MY RESPONSIBLE CHARGE, AND THAT I AM A DULY LICENSED PROPERTY LINE SURVEYOR UNDER THE LAWS OF THE STATE OF MARYLAND, LICENSE NO. 267, EXPIRATION DATE JULY 28, 2014.

BUILDING PERMIT NO. B12002055

SCALE
1"=50'

DATE
04/29/14

ROBERT H. VOGEL ENGINEERING, INC.

FINAL LOCATION DRAWING
16331 CATTAIL RIVER DRIVE

THOMAS M. HOFFMAN JR., PROPERTY LINE SURVEYOR #267 DATE