

WELL COMPLETION REPORT

1 2 3 6
(THIS NUMBER IS TO BE PUNCHED
IN COLS. 3-6 ON ALL CARDS)

FILL IN THIS FORM COMPLETELY
PLEASE TYPE

COUNTY NUMBER A 518641

ST/CO USE ONLY
DATE Received
MM 10 DD 27 YY 06

DATE WELL COMPLETED
MM 10 DD 27 YY 06

Depth of Well
22 260 26
(TO NEAREST FOOT)

PERMIT NO.
FROM "PERMIT TO DRILL WELL"
HD 95 - 0378

OWNER MATTHEWS & LYONS
last name first name
STREET OR RFD Road A TOWN Glenely
SUBDIVISION CLARIFIED SECTION _____ LOT 18

WELL LOG

Not required for driven wells

STATE THE KIND OF FORMATIONS PENETRATED, THEIR
COLOR, DEPTH, THICKNESS AND IF WATER BEARING

DESCRIPTION (Use additional sheets if needed)	FEET		check if water bearing
	FROM	TO	
Top Soil	0	2	
Sandy	2	95	✓
Sand Stone	95	100	
MICKA	100	150	
Sand Stone	150	155	✓
MICKA	155	260	

GROUTING RECORD

WELL HAS BEEN GROUTED (Circle Appropriate Box) Y N

TYPE OF GROUTING MATERIAL (Circle one)
CEMENT CM BENTONITE CLAY BC

NO. OF BAGS 24 NO. OF POUNDS 2400

GALLONS OF WATER 144

DEPTH OF GROUT SEAL (to nearest foot)
from 0 ft. to 30+ ft.
48 TOP 52 ft. to 54 BOTTOM 58 ft.
(enter 0 if from surface)

CASING RECORD

casing types insert appropriate code below

ST STEEL CO CONCRETE
 PL PLASTIC OT OTHER

MAIN CASING TYPE PL Nominal diameter top (main) casing (nearest inch) 6 Total depth of main casing (nearest foot) 106

60 61 63 64 66 70

OTHER CASING (if used)

diagram diameter depth (feet)
inch from to

SCREEN RECORD

screen type or open hole (insert appropriate code below)

ST STEEL BR BRASS HO OPEN HOLE
 PL PLASTIC OT OTHER

C 2 DEPTH (nearest ft.)
1 2 HO 104 260

E	8	9	11	15	17	21
A						
C	23	24	26	30	32	36
S						
R	38	39	41	45	47	51
E						
N						

SLOT SIZE 1 _____ 2 _____ 3 _____

DIAMETER OF SCREEN _____ (NEAREST INCH)
56 _____ 60 _____
from to

GRAVEL PACK IF WELL DRILLED WAS FLOWING WELL INSERT F IN BOX 68 _____ 68

MDE USE ONLY (NOT TO BE FILLED IN BY DRILLER)
T _____ (E.R.O.S.) W Q _____
70 _____ 72 _____ 74 75 76 _____

TELESCOPE CASING LOG INDICATOR OTHER DATA

C 3

PUMPING TEST

HOURS PUMPED (nearest hour) 3

PUMPING RATE (gal. per min.) 6

METHOD USED TO MEASURE PUMPING RATE Bucket

WATER LEVEL (distance from land surface)

BEFORE PUMPING 26 ft.
17 20

WHEN PUMPING 57 ft.
22 25

TYPE OF PUMP USED (for test)

A air P piston T turbine
 C centrifugal R rotary O other (describe below)
 J jet S submersible

PUMP INSTALLED

DRILLER INSTALLED PUMP (CIRCLE) (YES OR NO) YES NO

IF DRILLER INSTALLS PUMP, THIS SECTION MUST BE COMPLETED FOR ALL WELLS.

TYPE OF PUMP INSTALLED PLACE (A,C,J,P,R,S,T,O) IN BOX 29 29

CAPACITY: GALLONS PER MINUTE (to nearest gallon) 31 _____ 35 _____

PUMP HORSE POWER 37 _____ 41 _____

PUMP COLUMN LENGTH (nearest ft.) 43 _____ 47 _____

CASING HEIGHT (circle appropriate box and enter casing height)

+ above } LAND SURFACE
 - below } 2 (nearest foot)
49 51

LOCATION OF WELL ON LOT

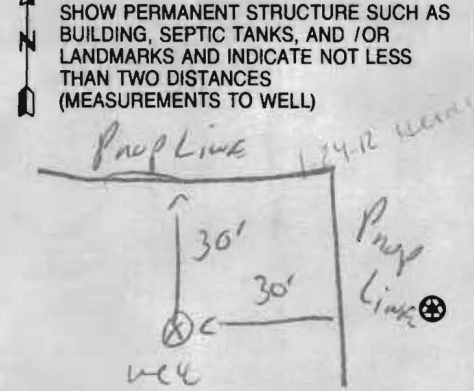

NUMBER OF UNSUCCESSFUL WELLS: 0

WELL HYDROFRACTURED Y N

- CIRCLE APPROPRIATE LETTER
- A** A WELL WAS ABANDONED AND SEALED WHEN THIS WELL WAS COMPLETED
 - E** ELECTRIC LOG OBTAINED
 - P** TEST WELL CONVERTED TO PRODUCTION WELL

I HEREBY CERTIFY THAT THIS WELL HAS BEEN CONSTRUCTED IN ACCORDANCE WITH COMAR 26.04.04 "WELL CONSTRUCTION" AND IN CONFORMANCE WITH ALL CONDITIONS STATED IN THE ABOVE CAPTIONED PERMIT, AND THAT THE INFORMATION PRESENTED HEREIN IS ACCURATE AND COMPLETE TO THE BEST OF MY KNOWLEDGE.

DRILLERS LIC. NO. M 5 D 117
DRILLERS SIGNATURE (MUST MATCH SIGNATURE ON APPLICATION)

LIC. NO. D

SITE SUPERVISOR (sign. of driller or journeyman responsible for sitework if different from permittee)

B 1 0977

SEQUENCE NO. (MDE USE ONLY)

STATE OF MARYLAND APPLICATION FOR PERMIT TO DRILL WELL please type 524386

STATE PERMIT NUMBER HD-95-0378 fill in this form completely

OWNER INFORMATION Date Received (APA) 8 MM DD YY 13 Cloverfield/PepperKorn LLC 15 Last Name Owner First Name 34 36 Street or RFD 55 57 Town 70 State 72 Zip 76

LOCATION OF WELL B 3 Howard 8 COUNTY 21 23 SUBDIVISION 42 52 NEAREST TOWN 71 SECTION 44 46 LOT 48 50 GLENELG 52 NEAREST TOWN 71 MILES FROM TOWN (enter 0 if in town) 73 I MI 76 77 78

DRILLER INFORMATION Driller's Name 76 License No. 81 Ralph E. Mayne M S D 117 Firm Name Ralph E. Mayne, Inc. Address 17024 Hardy Rd. Mt. Airy MD 21771 Signature Date 3/05/06

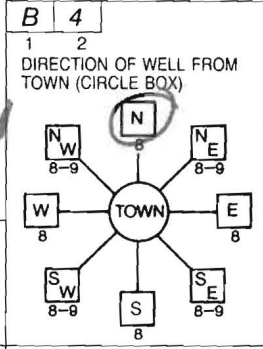

11 ROAD A. 30 NEAR WHAT ROAD ON WHICH SIDE OF ROAD (CIRCLE APPROPRIATE BOX) NORTH 34 50 37 DISTANCE FROM ROAD ENTER FT OR MI 38 39 TAX MAP: 15 BLK: PARCEL 4

WELL INFORMATION B 2 APPROX. PUMPING RATE (GAL. PER MIN.) 8 12 5 AVERAGE DAILY QUANTITY NEEDED (GAL. PER DAY) 14 20 500

USE FOR WATER (CIRCLE APPROPRIATE BOX) D DOMESTIC POTABLE SUPPLY & RESIDENTIAL IRRIGATION F FARMING (LIVESTOCK WATERING & AGRICULTURAL IRRIGATION) I INDUSTRIAL, COMMERCIAL, DEWATERING P PUBLIC WATER SUPPLY WELL T TEST, OBSERVATION, MONITORING G GEO-THERMAL

NOT TO BE FILLED IN BY DRILLER HEALTH DEPARTMENT APPROVAL Howard 13 COUNTY NAME COUNTY NO. STATE SIGNATURE INSERT S DATE ISSUED 5/2/06 CO SIGNATURE EXP. DATE 5/2/06 NORTH GRID 800 000 EAST GRID 530 000

APPROXIMATE DEPTH OF WELL 24 28 150 FEET APPROXIMATE DIAMETER OF WELL 6 NEAREST INCH

SHOW MAJOR FEATURES OF BOX & LOCATE WELL WITH AN X SOURCES OF DRILLING WATER 1. well 2. 3. WRITE THE BOX NUMBER FROM THE MAP HERE E 530 000 000 N 800 000

METHOD OF DRILLING (circle one) BORED (or Augered) JETTED Jetted & DRIVEN AIR-ROTary AIR-PERCussion ROTARY (Hydraulic Rotary) CABLE REVERSE-ROTary DRIVE-POINT other

REPLACEMENT OR DEEPEMED WELLS (CIRCLE APPROPRIATE BOX) N THIS WELL WILL NOT REPLACE AN EXISTING WELL Y THIS WELL WILL REPLACE A WELL THAT WILL BE ABANDONED AND SEALED S THIS WELL WILL REPLACE A WELL THAT WILL BE USED AS A STANDBY-CONTACT LOCAL APPROVING AUTHORITY FOR POLICY ON STANDBY WELLS D THIS WELL WILL DEEPEN AN EXISTING WELL PERMIT NUMBER OF WELL TO BE REPLACED OR DEEPEMED (IF AVAILABLE) 41 52

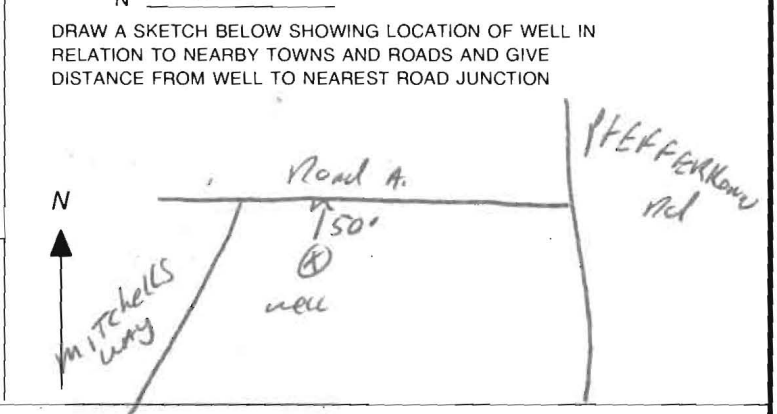

Not to be filled in by driller (MDE OR COUNTY USE ONLY) APPROP. PERMIT NUMBER G PERMIT No. 70 71 72 73 74 75 76 77 78 79

SPECIAL CONDITIONS NOTE - APPROVING AUTHORITIES SHOULD USE SEPARATE SHEET IF NEI (3.1)

**HOWARD COUNTY HEALTH DEPARTMENT
BUREAU OF ENVIRONMENTAL HEALTH
WATER AND SEWERAGE PROGRAM
TEL: (410)313-2640 FAX: (410)313-2648
313-1771**

Information Form for the Installation of the Well Pump, Pitless Adapter, and Supply Piping

NOTE: The installer is responsible for requesting an inspection prior to 9 am on the day of the desired inspection. No work is to be covered until approved by the Health Department. All installations must comply with the National Standard Plumbing Code (NSPC, as amended locally) and COMAR 26.04.04 (MD Well Construction Regulations). Submission of a complete form is required prior to Use and Occupancy approval.

Company Name: ATLANTIC BLUE Telephone #: (410) 840 8112
Address: 75 ALLEGAN CT
WESTMINSTER MD 21157

(Must circle one) Licensed Plumber Licensed Well Driller Licensed Well Pump Installer
License # and name of individual responsible for the field installation:
Name (Print): MARK MATHER License# 03797

*A licensed individual must perform the actual installation. Apprentices must be under the direct supervision of a licensed journeyman or master plumber, pump installer or well driller. Licenses may be subjected to field verification.

Name of Property Owner: CLOVERFIELD LLC Telephone #: 410-442-2211
Subdivision: CLOVERFIELD Lot #: 18 Well Tag #: HO-95-0378
Site Address: CLOVERFIELD LOT 18
ALENECA, MD

<u>Submersible Pump Data</u>	<u>Pitless Adapter</u>	<u>Well Cap and Electric Conduit</u>
Make: _____	Make: <u>CAMPBELL</u>	Two piece watertight cap: <input checked="" type="checkbox"/>
Model #: _____	Model#: <u>PA500</u>	Screened, vented well cap: <input checked="" type="checkbox"/>
Pump Capacity _____ GPM	Depth: <u>42</u> (36" min)	Cap secured to casing: <input checked="" type="checkbox"/>
Well Yield: _____ GPM	NSF approved: <input checked="" type="checkbox"/>	Conduit min 18" B.G.: <input checked="" type="checkbox"/>
Depth of well encountered at time of pump installation: _____ (feet)		Conduit secured to well cap: <input checked="" type="checkbox"/>

If pump capacity exceeds well yield, a low water cut off switch is required by NSPC 1990 Section 17.8.4
Torque arrestors or Cable guards are required - Must circle one
Safety rope, if used, attached to inside of well casing with eye bolt _____

<u>Piping to house</u>	<u>House Connection</u>
Type: <u>POLYETHYLENE</u>	PVC sleeved to undisturbed soil at wall penetration: <u>YES</u>
PSI: <u>160</u> (160 psi min)	Approximate length of sleeve: <u>2 FT</u>
Depth of supply line: <u>42</u> (36" min)	Sleeve caulked and sealed properly: <u>YES</u>

The water supply line is required to be at least ten feet from the septic tank, pump chamber, sewage piping, distribution box, drainfields, and sewage reserve area. If this cannot be accomplished, contact this office for approval prior to installation.

Signature of company representative responsible for installation: [Signature] date 8/30/12

For Health Department Use Only - Not to be completed by Installer

Date Insp. Requested: 8/31/12 Date Insp. Approved: _____
Inspection Data: Pitless adapter and water supply line at least 36" below grade _____
Two piece cap installed and attached to casing securely _____
Elec. conduit extends at least 18" below grade/attached to cap properly _____
Safety rope installed inside of well casing _____
Correct well tag attached properly and casing 8" above finished grade _____
Water supply line sleeved adequately at house connection _____
Adequate grout observed below pitless adapter _____



Howard County
Health Department

7178 Columbia Gateway Dr. • Columbia, MD 21046
(410) 313-2640 Fax (410) 313-2648
TDD (410) 313-2323 Toll Free 1-866-313-6300
website: www.hchealth.org

Penny E. Borenstein, M.D., M.P.H., Health Officer

ATTENTION WELL DRILLERS!!!

When submitting a well application for a new or replacement well,
please indicate one of the following:

- The well site has been staked by FCC
on by 3/31/06 and is ready for site inspection.
- _____ will call the Health Department
for a time to meet in the field to verify a well location.
- Site plan for new well is attached to well permit application.

Please attach this sheet when submitting your green application.
This should help improve communication allowing a more timely
service for our citizens.

KN



TRACE LABORATORIES, INC
 5 North Park Drive
 Hunt Valley, MD 21030 USA
 Telephone: 410/584-9099 / Fax: 410/584-9117
 Website: www.tracelabs.com / Email: info@tracelabs.com

Maryland State Certified Laboratory #318

CERTIFICATE OF ANALYSIS

Requester: Catonsville Builders
 11175 Stratfield Court
 Marriottsville, Maryland 21104

S/O Number: 88870

Report Date: April 23, 2013

Property Sampled: 13525 Mitchells Way, 21794
Sample Location: Pressure Tank Tap
Residual Chlorine: <0.1 mg/L

Building Permit #: B12000153
Sampler ID #: 7483AM
Samples Iced: Yes

County: Howard
Map: 15

Subdivision: Cloverfield
Parcel: 4

Lot #: 18

Date/Time Collected in Field: April 22, 2013 @ 10:39 am
Date/Time Received in Lab: April 22, 2013 @ 11:24 am

Well Tag #: HO-95-0378
Well Condition: 2-Piece Cap, Satisfactory

'OK' RB 4/24/13

Water Treatment/Conditioning: None

PARAMETER	METHOD	MCL/*SMCL	RESULT	PASS/FAIL
Total Coliform	SM 9223B	Absent	Absent ✓	Pass
E. coli	SM 9223B	Absent	Absent ✓	Pass
Nitrate	SM 4500D	10 mg/L as N	9.1 mg/L as N ✓	Pass
Turbidity	EPA 180.1	10 NTU	<1.0 NTU ✓	Pass
pH	EPA 150.1	*6.5-8.5 Units	6.3 Units ✓	***
Sand		Absent	Absent ✓	Pass

The results in this report relate only to those items tested. If any additional information or clarification of this report is required, please contact us. This test report shall not be reproduced except in full without the written approval of Trace Laboratories Inc.

Katherine C. Higgs
 Katherine C. Higgs
 Manager - Drinking Water Testing

MCL: Maximum Contamination Level, an enforceable level established by the EPA
 *SMCL: Secondary Maximum Contamination Level, a level recommended by the EPA
 ***A non-enforceable parameter that may cause cosmetic effects or aesthetic effects (such as taste, color or odor) in drinking water.

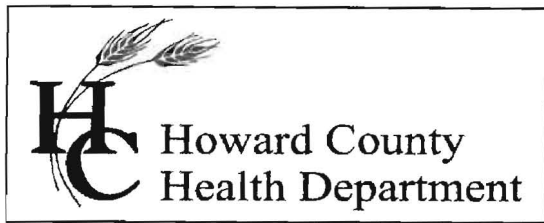

Bureau of Environmental Health

7178 Columbia Gateway Drive, Columbia, MD 21046-2147

Main: 410-313-6300 | Fax: 410-313-6303

TDD 410-313-2323 | Toll Free 1-866-313-6300

www.hchealth.org

Facebook: www.facebook.com/hocohealth

Twitter: HowardCoHealthDep

Maura J. Rossman, M.D., Health Officer

INTERIM CERTIFICATE OF POTABILITY

Expiration Date – October 30, 2013

April 30, 2013

Homeowner
13525 Mitchells Way
West Friendship, MD 21794

**RE: Cloverfield, Lot 18
13525 Mitchells Way
Building Permit: B12000153
Well Permit: HO-95-0378**

Dear Homeowner:

This is to advise you that the septic system installation and water well construction for the above referenced property have been inspected and approved. Final approval of the septic system was granted on **4/26/2013**. Final approval of the well line connection to the dwelling was granted on **9/5/2012**. The well construction was completed on **10/27/2006**. Water samples were collected on **4/22/2013**.

The water sample results indicate that the water samples submitted for testing were free of coliform and fecal coliform bacteria at the time of sampling and are bacteriologically safe for drinking. This certifies that the initial sampling requirements of COMAR 26.04.04 "Well Regulations" have been met for the water supply system installed under well permit HO-95-0378. Although the submitted sample results are in compliance with COMAR standards, the Health Department does not guarantee water supplies.

This Interim Certificate of Potability will expire **six months** from the date of issuance. Submission of a second bacteriological test indicating the water is free of coliform and fecal coliform bacteria is required prior to the expiration date, after which time a Final Certificate of Potability will be issued. **Failure to submit an additional sample and obtain a Final Certificate of Potability will result in a Notice of Violation and is punishable as a misdemeanor under the *Annotated Code of Maryland, Environment Article, 9-1311*, subject to a fine of up to \$500 or imprisonment not to exceed three months.**

Please contact (410) 313-1773 to schedule a final water sample appointment or contact a Maryland certified water laboratory to schedule a water sample. A list of laboratories certified by the state of Maryland may be found at the following website:

<http://www.mde.state.md.us/assets/document/WSP-Labs-2010apr16.pdf>

Approving Authority,

A handwritten signature in black ink, appearing to read "Heidi Scott". The signature is written in a cursive style with a large, stylized initial 'H'.

Heidi Scott, R.S.
Environmental Sanitarian
Well & Septic Program

cc: Howard County Dept. of Inspections, Licenses, and Permits
Community Hygiene Program
File