

# APPLICATION

PERCOLATION TESTING

A \_\_\_\_\_

P \_\_\_\_\_

HOWARD COUNTY HEALTH DEPARTMENT  
BUREAU OF ENVIRONMENTAL HEALTH  
3525-H ELLICOTT MILLS DRIVE/ELLICOTT CITY, MARYLAND 21043  
TELEPHONE: 313-2840

DISTRICT \_\_\_\_\_

DATE \_\_\_\_\_

TO: THE COUNTY HEALTH OFFICER  
ELLICOTT CITY, MARYLAND

I HEREBY APPLY FOR THE NECESSARY TEST PRIOR TO APPLICATION FOR PERMIT TO CONSTRUCT (OR RECONSTRUCT) A SEWAGE DISPOSAL SYSTEM.

PROPERTY OWNER KENNARD WARFIELD JR

ADDRESS 14663 TRIADELPHIA ROAD PHONE 410-442-2337

AGENT OR PROSPECTIVE BUYER LAND DESIGN & DEVELOPMENT

ADDRESS 8000 MAIN STREET ELLICOTT CITY PHONE 410-480-9105

PROPERTY LOCATION:  
SUBDIVISION THE WARFIELDS II LOT NO. 74

ROAD AND DESCRIPTION SOUTH SIDE OF TRIADELPHIA ROAD AT THE INTERSECTION OF TRIADELPHIA ROAD AND HOWARD ROAD

TAX MAP 21 PARCEL # \_\_\_\_\_

SIZE OF LOT ONE ACRE TYPE BLDG. SINGLE FAMILY DWELLING  
(SINGLE FAMILY DWELLING OR COMMERCIAL)

THE SYSTEM INSTALLED UNDER THIS APPLICATION IS ACCEPTABLE ONLY UNTIL PUBLIC FACILITIES BECOME AVAILABLE. I FULLY UNDERSTAND THE FEE CONNECTED WITH THE FILING OF THIS PERC TEST APPLICATION IS NON-REFUNDABLE UNDER ANY CIRCUMSTANCES. I ALSO AGREE TO COMPLY WITH ALL M.O.S.H.A. REQUIREMENTS IN TESTING THIS LOT. DONALD R. REUMER  
(SIGNATURE OF APPLICANT)

APPROVED BY \_\_\_\_\_ FOR \_\_\_\_\_ DATE \_\_\_\_\_

DISAPPROVED BY \_\_\_\_\_ FOR \_\_\_\_\_ DATE \_\_\_\_\_

HOLD PENDING FURTHER TESTS \_\_\_\_\_

REASONS FOR REJECTION OR HOLDING \_\_\_\_\_

PERCOLATION TEST PLAT/PRELIMINARY PLAT - TITLE OR I.D. # \_\_\_\_\_ DATE \_\_\_\_\_

SITE DEVELOPMENT PLAN/FINAL PLAT - TITLE OR I.D. # \_\_\_\_\_ DATE \_\_\_\_\_

## THIS IS NOT A PERMIT

COUNTY #

SOIL PROFILE

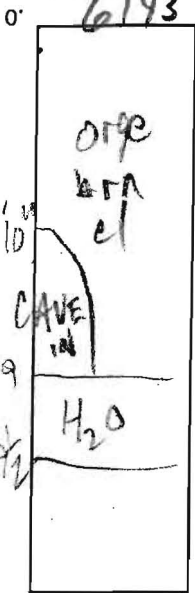

6194

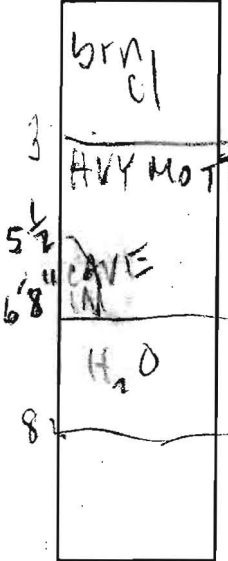

6195

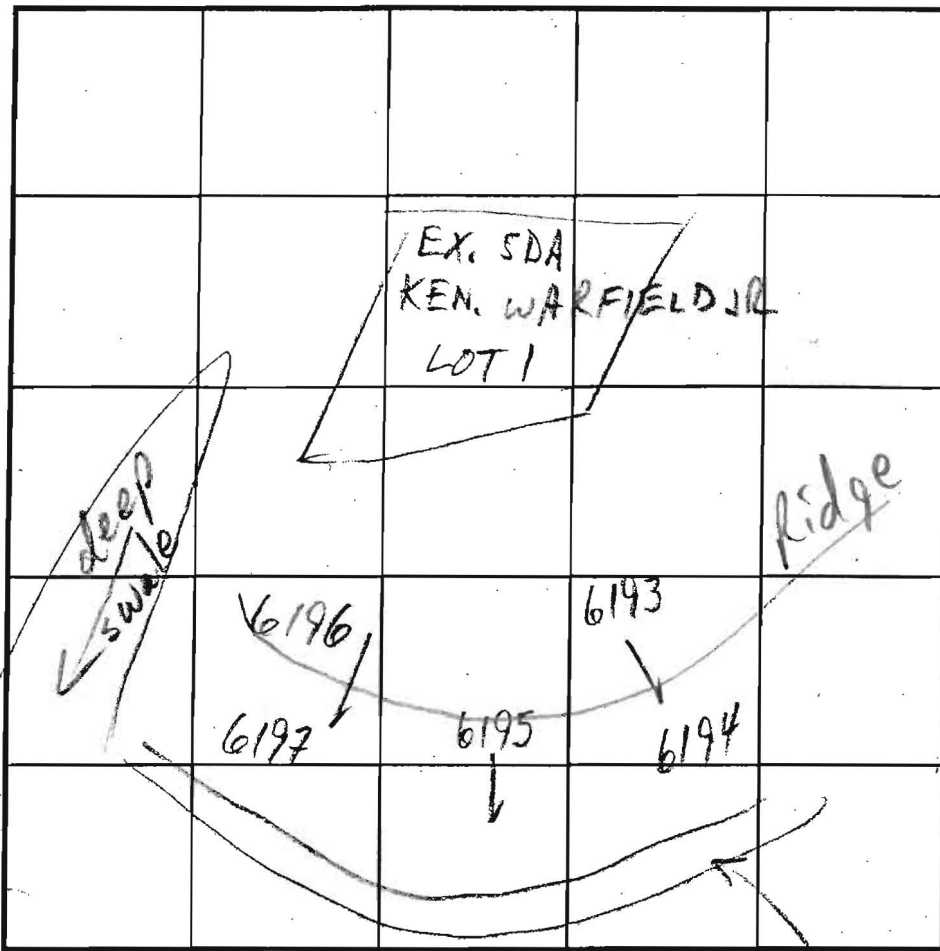
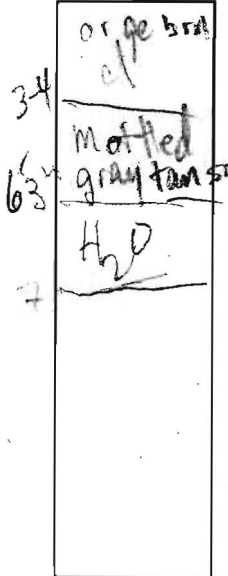

SOIL PROFILE

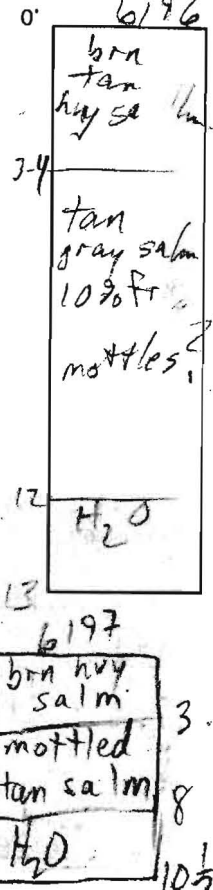

INDICATE NORTH - NAME ADJOINING ROADWAY AS BASE LINE

DATE	TEST NO.	DEPTH	PRE-WET		TEST - 1" DROP		TIME
			START	STOP	START	STOP	
1/15/03	6193 ✓	9 1/2'	H <sub>2</sub> O				F
	6194 ✓	8'					F
	6195 ✓	7'					F
	6196 ✓	13'	WST	REQ'D			
	6197 ✓	10 1/2'					F

REMARKS ALL HOLES PER PLAN, MOST FAIL

TYPE OF SOIL \_\_\_\_\_

TESTED BY M. Ribkin ALSO PRESENT \_\_\_\_\_

TRENCH DESIGN DATA: AVERAGE PERCOLATION TIME \_\_\_\_\_ TRENCH WIDTH \_\_\_\_\_

INLET DEPTH \_\_\_\_\_ MAXIMUM BOTTOM DEPTH \_\_\_\_\_ SQ. FT./BEDROOM \_\_\_\_\_

# APPLICATION

8-12-88  
Revised  
9/30  
1 SF

## PERCOLATION TESTING

A 42044

P \_\_\_\_\_

HOWARD COUNTY HEALTH DEPARTMENT  
BUREAU OF ENVIRONMENTAL HEALTH  
P.O. BOX 476 ELLICOTT CITY, MARYLAND 21043  
TELEPHONE: 461-9933

DISTRICT 5

DATE 6/23

TO: THE COUNTY HEALTH OFFICER  
ELLICOTT CITY, MARYLAND

I, HEREBY, APPLY FOR THE NECESSARY TEST IN ORDER TO CONSTRUCT (OR RECONSTRUCT) A SEWAGE DISPOSAL SYSTEM.

PROPERTY OWNER Warfield Brothers c/o Howard Co Land Services

ADDRESS 8307 Main St PHONE 465-5855

PROSPECTIVE BUYER N/A

ADDRESS \_\_\_\_\_ PHONE \_\_\_\_\_

PROPERTY LOCATION: KENNARD WARFIELD JR F 90-78 LOT 14

SUBDIVISION Howard Rd Parcel C LOT NO. 1

ROAD AND DESCRIPTION Howard Rd, south of Triadelphia

TAX MAP 21 PARCEL # 68

SIZE OF LOT 3 acres TYPE BLDG. SFD  
(SINGLE FAMILY DWELLING OR COMMERCIAL)

THE SYSTEM INSTALLED UNDER THIS APPLICATION IS ACCEPTABLE ONLY UNTIL PUBLIC FACILITIES BECOME AVAILABLE. I FULLY UNDERSTAND THE FEE CONNECTED WITH THE FILING OF THIS PERC TEST APPLICATION IS NON-REFUNDABLE UNDER ANY CIRCUMSTANCES. I ALSO AGREE TO COMPLY WITH ALL M.O.S.H.A. REQUIREMENTS IN TESTING THIS LOT.

Malden  
(SIGNATURE OF APPLICANT)

APPROVED BY C. Williams FOR SHALLOW TRENCHES DATE 3/23/90

REJECTED BY \_\_\_\_\_ FOR \_\_\_\_\_ DATE \_\_\_\_\_

HOLD PENDING FURTHER TESTS \_\_\_\_\_ DATE \_\_\_\_\_

REASONS FOR REJECTION OR HOLDING 8/12/88 Perc OK Hold for test RFD  
Test not to start

# THIS IS NOT A PERMIT

A42044  
1-C

SOIL PROFILE

0  
BROWN CLAY TOPSOIL  
2 1/2  
SAND LIGHT BROWN LOAM  
9  
ROCK BOT

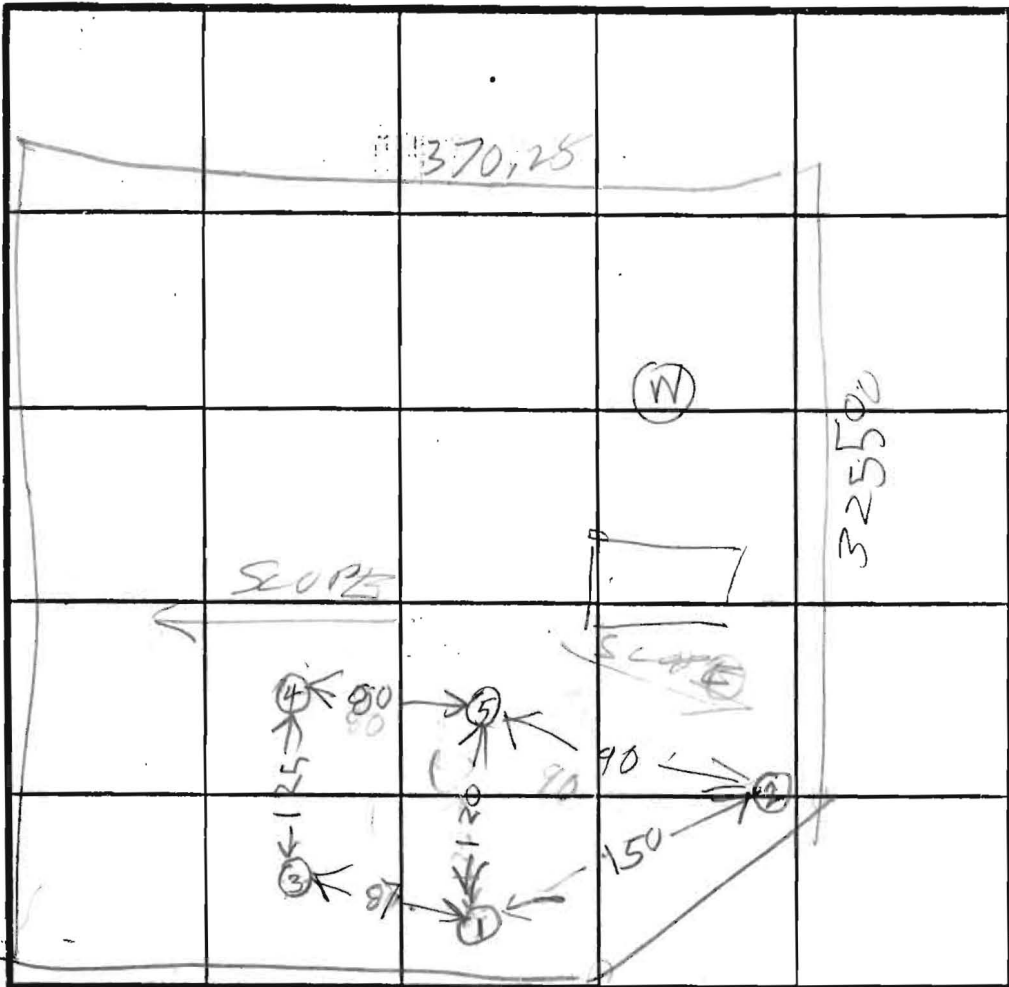

(5)  
0  
CLAY  
2  
LIGHT BROWN SAND LOAM  
11

X 7 MIN  
210  
INLOT 2 1/2  
BOTTOM 4

INDICATE NORTH - NAME ADJOINING ROADWAY AS BASE LINE.

(2)  
CLAY TOPSOIL  
WATER  
LIGHT BROWN SAND LOAM

DATE	TEST NO.	DEPTH	PRE-WET		TEST - 1" DROP		TIME	
			START	STOP	START	STOP		
12/12/81	1S	2 1/2	1105	1108	1108	1112	4	
	1V	9	ROCK BOTTOM					
	2V	10	WATER 9 FT UNSAT					
	3S	4	1123	1130	1130	1141	11	
	3S	14	OK					
	4S	4	1147	1154	1154	1158	4	
	4V	8.5	1147	1154	1154	1203		
	4V	12	OK OK					
	5V	11	OK					

REMARKS \_\_\_\_\_

TYPE OF SOIL \_\_\_\_\_

TESTED BY R. ADORGEI ALSO PRESENT ORSTORMA-MOVE MARK

EH-12-1079

(3)  
LIGHT BROWN SAND LOAM  
(4)  
CLAY



# MILBERG, MOCHI & ASSOCIATES, INC.

ENGINEERS • SURVEYORS • PLANNERS

3300 North Ridge Road, Suite 235, Ellicott City, Maryland 21043-3350  
(301) 461-0078 D.C. Metro: (301) 621-5768

N 51

HOWARD COUNTY DEPARTMENT OF HEALTH

COUNTY HEALTH OFFICER



THIS AREA DESIGNATES A PRIVATE OF 10,000 SQ. FT., AS REQUIRED BY STATE DEPT. OF THE ENVIRONMENT FOR INDIVIDUAL SEWAGE DISPOSAL

KID STABLES (PARCEL C)  
PERC CERTIFICATION  
PLAT  
3/20/90

