

C 1 15983 SEQUENCE NO. (MDE USE ONLY)

STATE OF MARYLAND WELL COMPLETION REPORT FILL IN THIS FORM COMPLETELY PLEASE TYPE

THIS REPORT MUST BE SUBMITTED WITHIN 45 DAYS AFTER WELL IS COMPLETED.

COUNTY NUMBER A522 987

1 2 3 6 (THIS NUMBER IS TO BE PUNCHED IN COLS. 3-6 ON ALL CARDS)

ST/CO USE ONLY DATE Received MM 05 DD 05 YY 11

DATE WELL COMPLETED MM 04 DD 15 YY 11

Depth of Well 22 165 26 (TO NEAREST FOOT) 9/15/11

PERMIT NO. FROM "PERMIT TO DRILL WELL" HO-95-2072

OWNER last name first name STREET OR RFD TOWN SUBDIVISION SECTION LOT

WELL LOG Not required for driven wells STATE THE KIND OF FORMATIONS PENETRATED, THEIR COLOR, DEPTH, THICKNESS AND IF WATER BEARING

GROUTING RECORD WELL HAS BEEN GROUTED (Circle Appropriate Box) TYPE OF GROUTING MATERIAL (Circle one) CEMENT BENTONITE CLAY NO. OF BAGS NO. OF POUNDS GALLONS OF WATER DEPTH OF GROUT SEAL (to nearest foot)

CASING RECORD casing types insert appropriate code below MAIN CASING TYPE Nominal diameter top (main) casing (nearest inch)! Total depth of main casing (nearest foot)

OTHER CASING (if used) diameter inch depth (feet) from to

SCREEN RECORD screen type or open hole insert appropriate code below DEPTH (nearest ft.)

NUMBER OF UNSUCCESSFUL WELLS: 0

WELL HYDROFRACTURED YES NO CIRCLE APPROPRIATE LETTER A A WELL WAS ABANDONED AND SEALED WHEN THIS WELL WAS COMPLETED E ELECTRIC LOG OBTAINED P TEST WELL CONVERTED TO PRODUCTION WELL

I HEREBY CERTIFY THAT THIS WELL HAS BEEN CONSTRUCTED IN ACCORDANCE WITH COMAR 26.04.04 "WELL CONSTRUCTION" AND IN CONFORMANCE WITH ALL CONDITIONS STATED IN THE ABOVE CAPTIONED PERMIT, AND THAT THE INFORMATION PRESENTED HEREIN IS ACCURATE AND COMPLETE TO THE BEST OF MY KNOWLEDGE.

DRILLERS LIC. NO. M 5 D 117 DRILLERS SIGNATURE LIC. NO. 1

SITE SUPERVISOR (sign. of driller or journeyman responsible for sitework if different from permittee)

GRAVEL PACK IF WELL DRILLED WAS FLOWING WELL INSERT F IN BOX 68 MDE USE ONLY (NOT TO BE FILLED IN BY DRILLER) T (E.R.O.S.) W Q

TELESCOPE CASING LOG INDICATOR OTHER DATA

PUMPING TEST HOURS PUMPED (nearest hour) PUMPING RATE (gal. per min.) METHOD USED TO MEASURE PUMPING RATE WATER LEVEL (distance from land surface) BEFORE PUMPING WHEN PUMPING TYPE OF PUMP USED (for test)

PUMP INSTALLED DRILLER INSTALLED PUMP (CIRCLE) (YES OR NO) IF DRILLER INSTALLS PUMP, THIS SECTION MUST BE COMPLETED FOR ALL WELLS. TYPE OF PUMP INSTALLED PLACE (A,C,J,P,R,S,T,O) IN BOX 29. CAPACITY: GALLONS PER MINUTE (to nearest gallon) PUMP HORSE POWER PUMP COLUMN LENGTH (nearest ft.) CASING HEIGHT (circle appropriate box and enter casing height) LAND SURFACE

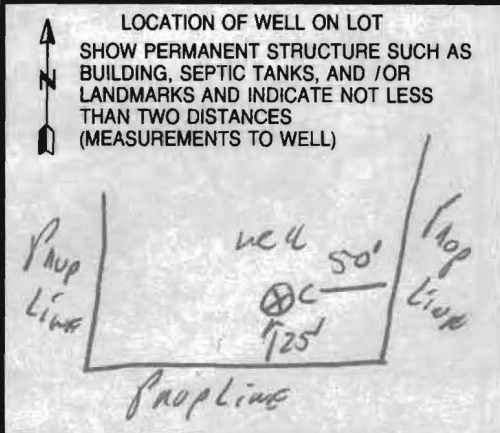

B 1 8498
1 2 3 6

SEQUENCE NO. (MDE USE ONLY)

STATE OF MARYLAND
APPLICATION FOR PERMIT TO DRILL WELL

STATE PERMIT NUMBER

HO-95-2072
fill in this form completely

534488 please type

Date Received (APA)
030711
8 MM DD YY 13

OWNER INFORMATION

15 Last Name Owner First Name 34
Heritage Realty & Land Develop
PO BOX 482
36 Street or RFD 55
Lisbon MD. 21765
57 Town 70 State 72 Zip 76

B 3 LOCATION OF WELL

8 COUNTY 21
Howard
23 SUBDIVISION 42
Meriwether Farm
SECTION 2 44 46 LOT 20 48 50
GLENEGS
52 NEAREST TOWN 71
MILES FROM TOWN (enter 0 if in town) 8.2 M I
73 76 77 78

DRILLER INFORMATION

76 Driller's Name License No. 81
Ralph E. Wayne M S D 117
76 Firm Name
Ralph E. Wayne Well Drilling
76 Address
17024 Handy Rd Mt. Airy Md 21771
76 Signature Date
R E Wayne 3/4/11

B 4

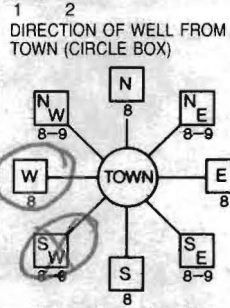

11 DIRECTION OF WELL FROM TOWN (CIRCLE BOX)
Meriwether Rd.
NEAR WHAT ROAD 30
ON WHICH SIDE OF ROAD (CIRCLE APPROPRIATE BOX)
NORTH
WEST 32 EAST
SOUTH
400 37
DISTANCE FROM ROAD
ENTER FT OR MI 38 39
TAX MAP: 21 BLK: 16 PARCEL 28

B 2 WELL INFORMATION
1 2 APPROX. PUMPING RATE (GAL. PER MIN.) 5
AVERAGE DAILY QUANTITY NEEDED (GAL. PER DAY) 500 12 14 20

USE FOR WATER (CIRCLE APPROPRIATE BOX)

- D DOMESTIC POTABLE SUPPLY & RESIDENTIAL IRRIGATION
- F FARMING (LIVESTOCK WATERING & AGRICULTURAL IRRIGATION)
- I INDUSTRIAL, COMMERCIAL, DEWATERING
- P PUBLIC WATER SUPPLY WELL
- T TEST, OBSERVATION, MONITORING
- G GEO-THERMAL

NOT TO BE FILLED IN BY DRILLER HEALTH DEPARTMENT APPROVAL

Howard 13 A522987
COUNTY NAME COUNTY NO.
STATE SIGNATURE INSERT S
DATE ISSUED 3/21/2011 Brian Baker 3/21/2012 41
43 MM DD YY 48 CO SIGNATURE EXP DATE
NORTH GRID 519 000 EAST GRID 791 000
50 55 57 63

APPROXIMATE DEPTH OF WELL 150 FEET
24 28

APPROXIMATE DIAMETER OF WELL 6" NEAREST INCH

METHOD OF DRILLING (circle one)

30 BORED (or Augered) JETTED Jetted & DRIVEN
AIR-ROTary AIR-PERCussion ROTARY (Hydraulic Rotary)
37 CABLE REVERSE-ROTary DRIVE-POINT
other

REPLACEMENT OR DEEPEMED WELLS (CIRCLE APPROPRIATE BOX)

- N THIS WELL WILL NOT REPLACE AN EXISTING WELL
 - Y THIS WELL WILL REPLACE A WELL THAT WILL BE ABANDONED AND SEALED
 - S THIS WELL WILL REPLACE A WELL THAT WILL BE USED AS A STANDBY-CONTACT LOCAL APPROVING AUTHORITY FOR POLICY ON STANDBY WELLS
 - D THIS WELL WILL DEEPEN AN EXISTING WELL
- PERMIT NUMBER OF WELL TO BE REPLACED OR DEEPEMED (IF AVAILABLE) 41 52

SHOW MAJOR FEATURES OF BOX & LOCATE WELL WITH AN X

SOURCES OF DRILLING WATER
1. well
2.
3.

WRITE THE BOX NUMBER FROM THE MAP HERE

E 52019
N 791

DRAW A SKETCH BELOW SHOWING LOCATION OF WELL IN RELATION TO NEARBY TOWNS AND ROADS AND GIVE DISTANCE FROM WELL TO NEAREST ROAD JUNCTION

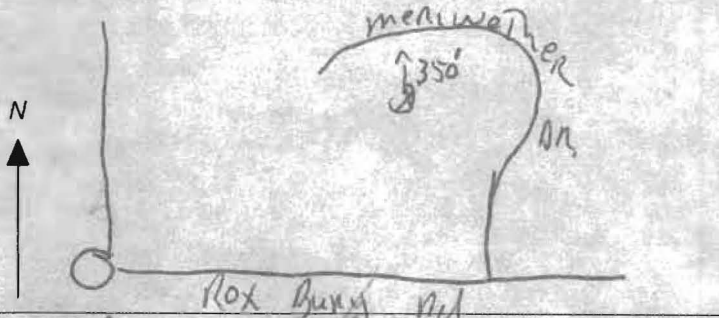

Not to be filled in by driller (MDE OR COUNTY USE ONLY)

APPROP. PERMIT NUMBER HO2008G010
PERMIT No. HO-95-2072
70 71 72 73 74 75 76 77 78 79

SPECIAL CONDITIONS

Wells Within 100' Must Be Yield Tested Simultaneously

FIELD DATA SHEET
HOWARD COUNTY WELL YIELD TEST

Well Permit No. HO - 95-2072
 Location of property (road) Meriwether Dr
 Subdivision Meriwether Farm Lot 20 Block _____ Plat _____ Sec. 2
 Well Driller Ralph Mayne Owner Heritage Realty & Land Develop.

Depth of well 165
 Distance of measuring point (M.P.) above ground 2 ft
 Static water level (S.W.L.) below M.P. 47 ft

I. High rate pumping -- reservoir drawdown

Time pump started 7:00 Pumping rate 10 GPM
 Total time 15 min to reach pumping water level 70 ft. below M.P.

II. Recovery pump test data - observations to be recorded every 15 minutes

TIME (in 15 minute intervals)	WATER LEVEL below M.P.	PUMPING RATE time to fill <u>I</u> gallon bucket	FLOW METER READING (if used)	CALCULATED FLOW (gallons per minute)
7:00	47 ft.	6 Sec		10 GPM
			Test started	
7:15	70 ft	6 Sec		10 GPM
7:30	70 ft	6 Sec		10 GPM
7:45	70 ft	6 Sec		10 GPM
8:00	70 "	6 "		10 "
8:15	70 "	6 "		10 "
8:30	70 "	6 "		10 "
8:45	70 ft	6 Sec		10 GPM
9:00	70 ft	6 Sec		10 GPM
9:15	70 ft	6 Sec		10 GPM
9:30	70 "	6 "		10 "
9:45	70 "	6 "		10 "
10:00	70 ft	6 Sec		10 GPM
10:15	70 ft	6 Sec		10 GPM

HOWARD COUNTY HEALTH DEPARTMENT
 BUREAU OF ENVIRONMENTAL HEALTH
 WELL & SEPTIC PROGRAM
 TEL: (410)313-1771 FAX: (410)313-2648

Information Form for the Installation of the Well Pump, Pitless Adapter, and Supply Piping

NOTE: The installer is responsible for requesting an inspection prior to 9 am on the day of the desired inspection. No work is to be covered until approved by the Health Department. All installations must comply with the National Standard Plumbing Code (NSPC, as amended locally) and COMAR 26.04.04 (MD Well Construction Regulations). Submission of a complete form is required prior to Use and Occupancy approval.

Company Name: _____ Telephone #: _____
 Address: _____

(Must circle one) Licensed Plumber Licensed Well Driller Licensed Well Pump Installer
 License # and name of individual responsible for the field installation:
 Name (Print): _____ License# _____

***A licensed individual must perform the actual installation. Apprentices must be under the supervision of a licensed journeyman or master plumber, pump installer or well driller. Licenses may be subjected to field verification. Unlicensed individuals may be reported to the appropriate licensing agency.**

Name of Property Owner: _____ Telephone #: _____
 Subdivision: Merimether Farms Lot # (20) Well Tag #: HO-98-2072 ✓
 Site Address: 14881 Merimether Dr.

<u>Submersible Pump Data</u>	<u>Pitless Adapter</u>	<u>Well Cap and Electric Conduit</u>
Make: _____	Make: _____	Two piece watertight cap: _____
Model #: _____	Model#: _____	Screened, vented well cap: _____
Pump Capacity _____ GPM	Depth: _____ (36" min)	Cap secured to casing: _____
Well Yield: _____ GPM	NSF/WSC approved: _____	Conduit min 18" B.G.: _____
Depth of well encountered at time of pump installation: _____ (feet)		Conduit secured to well cap: _____

If pump capacity exceeds well yield, a low water cut off switch is required by NSPC 1990 Section 17.8.4
 Torque arrestors, Cable guards, or other acceptable method used- Must circle one
 Safety rope, if used, attached to brass rope adapter or other acceptable method inside of well casing

<u>Piping to house</u>	<u>House Connection</u>
Type: _____	PVC sleeve to undisturbed soil at wall penetration: _____
PSI: _____ (160 psi min)	Length of sleeve (5' minimum from foundation): _____
Depth of supply line: _____ (36" min)	Sleeve sealed properly: _____

The water supply line is required to be at least ten feet from the septic tank, pump chamber, sewage piping, distribution box, drainfields, and sewage reserve area. If this cannot be accomplished, contact this office for approval prior to installation.

Signature of company representative responsible for installation _____ date _____

For Health Department Use Only - Not to be completed by Installer

Date Insp. Requested: 7/9/14 Date Insp. Approved: 7/9/14 Inspector: (RC)
 Inspection Data: Pitless adapter watertight & water supply line at least 36" below grade ✓
 Two piece cap installed and attached to casing securely ✓
 Elec. conduit extends at least 18" below grade/attached to cap properly ✓
 Safety rope not outside of well cap/casing ✓
 Correct well tag attached properly and casing 8" above finished grade ✓
 Water supply line sleeved adequately at house connection ✓
 Adequate grout observed below pitless adapter ✓

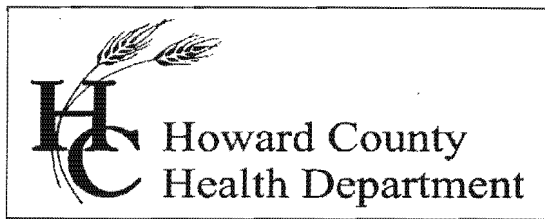

Bureau of Environmental Health

8930 Stanford Blvd., Columbia, MD 21045
Main: 410-313-1771 | Fax: 410-313-2648
TDD 410-313-2323 | Toll Free 1-866-313-6300
www.hchealth.org
Facebook: www.facebook.com/hocohealth
Twitter: HowardCoHealthDep

Maura J. Rossman, M.D., Health Officer

INTERIM CERTIFICATE OF POTABILITY

Expiration Date – June 23, 2015

January 23, 2015

Homeowner
14881 Meriwether Farm
Lisbon, Maryland 21765

RE: Meriweather Farm Sec. II, Lot #20
14881 Meriwether Farm
Building Permit: B13004093
Well Permit: HO-95-2072

Dear Homeowner:

This is to advise you that the septic system installation and water well construction for the above referenced property have been inspected and approved. Final approval of the septic system was granted on **1/12/2015**. Final approval of the well line connection to the dwelling was granted on **7/9/2014**. The well construction was completed on **04/15/2011**. Water samples were collected on **1/15/2015**.

The water sample results indicate that the water samples submitted for testing were free of coliform and fecal coliform bacteria at the time of sampling and are bacteriologically safe for drinking. This certifies that the initial sampling requirements of COMAR 26.04.04 "Well Regulations" have been met for the water supply system installed under well permit HO-95-2072. Although the submitted sample results are in compliance with COMAR standards, the Health Department does not guarantee water supplies.

This Interim Certificate of Potability will expire **six months** from the date of issuance. Submission of a second bacteriological test indicating the water is free of coliform and fecal coliform bacteria is required prior to the expiration date, after which time a Final Certificate of Potability will be issued. **Failure to submit an additional sample and obtain a Final Certificate of Potability will result in a Notice of Violation and is punishable as a misdemeanor under the Annotated Code of Maryland, Environment Article, 9-1311, subject to a fine of up to \$500 or imprisonment not to exceed three months.**

Please contact (410) 313-1773 to schedule a final water sample appointment or contact a Maryland certified water laboratory to schedule a water sample. A list of laboratories certified by the state of Maryland may be found at the following website:

<http://www.mde.state.md.us/assets/document/WSP-Labs-2010apr16.pdf>

Approving Authority,

A handwritten signature in cursive script that reads "Dana Bernard".

Dana Bernard, R.E.H.S., L.E.H.S
Environmental Sanitarian
Well & Septic Program

cc: Howard County Dept. of Inspections, Licenses, and Permits
Community Hygiene Program
File

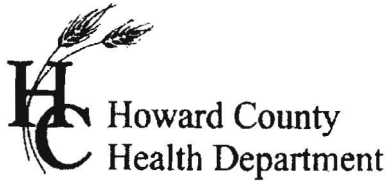

7178 Columbia Gateway Dr., Columbia, MD 21046
(410) 313-2640 Fax (410) 313-2648
TDD (410) 313-2323 Toll Free 1-866-313-6300
website: www.hchealth.org

Peter L. Bielenon, M.D., M.P.H., Health Officer

TO ALL INTERESTED PARTIES

When submitting a well application for a proposed well for new construction, please indicate one of the following:

Well Site Location:

<u>Meriwether Farm, Sec. II, Ph. 2</u>	<u>20</u>	<u>Meriwether Drive</u>
Subdivision/Property Name	Lot #	Road Name

- The well site has been staked by Fisher, Collins & Carter, Inc.,
(professional land surveyor or company employing professional land surveyors)
on 3/21/11 (date) and does not require a site inspection.
- The well driller, builder or property owner will call the Health Department to schedule a time to meet in the field to verify the proposed well site location.

This sheet, along with two copies of an acceptable well site plan, must be attached to the green well permit application.

Revised 3/11/07

FOUNTAIN VALLEY ANALYTICAL LABORATORY, INC.

1413 Old Taneytown Rd. Westminster, MD (410) 848-1014 (410) 876-4554 FAX (410) 848-0298

REPORT OF ANALYSIS

Laboratory ID #: 98562 Account #: 1930
Reference: Toll Brothers Lot 20 Company: Fogle's Well Drilling
Location: 14881 Meriwether Drive Requested By: Dave Fogle
Glenelg, MD 21737 Source: Well Water
Date/ Time Collected: 1/14/2015 1410 Site: Kitchen Sink Tap
Date/Time Rec'd: 1/14/2015 1537 Treatment: None
Chlorine ppm: Free: ND Total: ND pH: 5.1
Collected By: J. Fogle 1974JF Well #: HO-95-2072

PARAMETERS	RESULTS	UNITS	REFERENCE	METHOD	DATE/TIME/ANALYST
Bacteria, Coliform, Total, MPN	<1.0	MPN/ 100 ml	<1.0	SM18 9223	1/15/2015 / 1005 / LLO
Bacteria, E. coli, MPN	<1.0	MPN/ 100 ml	<1.0	SM18 9223	1/15/2015 / 1005 / LLO

OK
DB
1-23-15

NOTES

- 1 MPN/ 100 ml = Most Probable Number [of viable bacteria] per 100 ml of sample.
- 2 Results less than or within the reference range are considered satisfactory and within potable water limits at the time of sampling.
- 3 ND:None Detected
- 4 Sample collected by client, analyzed as received
- 5 pH tested in lab, chlorine level tested on site

Reason for Test : Use & Occupancy

Building Permit # : 13004093

Date Reported: 1/15/2015

FOUNTAIN VALLEY ANALYTICAL LABORATORY, INC.

1413 Old Taneytown Rd. Westminster, MD (410) 848-1014 (410) 876-4554 FAX (410) 848-0298

REPORT OF ANALYSIS

Laboratory ID #: 98473 Account #: 1930
Reference: Toll Brothers Lot 20 Company: Fogle's Well Drilling
Location: 14881 Meriwether Drive Requested By: Dave Fogle
Glenelg, MD 21737 Source: Well Water
Date/ Time Collected: 1/7/2015 1430 Site: Laundry Tub
Date/Time Rec'd: 1/7/2015 1528 Treatment: None
Chlorine ppm: Free: ND Total: ND pH: 5.4
Collected By: J. Fogle 1974JF Well #: HO-95-2072

PARAMETERS	RESULTS	UNITS	REFERENCE	METHOD	DATE/TIME/ANALYST
Bacteria, Coliform, Total, MPN	5.3 ✓	MPN/ 100 ml	<1.0	SM18 9223	1/8/2015 / 0935 / CCH
Bacteria, E. coli, MPN	<1.0	MPN/ 100 ml	<1.0	SM18 9223	1/8/2015 / 0935 / CCH
Nitrate	5.96	mg/L	10	601	1/7/2015 / 1600 / CRS
Turbidity	1.27	NTU	<10	SM18 2130B	1/7/2015 / 1620 / CRS
Sand	NS	mg/L	5	Visual/Gravimetric	1/7/2015 / 1620 / CRS

NOT
OK
1-23-15

NOTES

- 1 mg/L = milligrams per liter (also, parts per million)
- 2 MPN/ 100 ml = Most Probable Number [of viable bacteria] per 100 ml of sample.
- 3 NS = None Seen (NS indicates less than 5 mg/L)
- 4 NTU = Nephelometric Turbidity Units
- 5 Results less than or within the reference range are considered satisfactory and within potable water limits at the time of sampling.
- 6 ND:None Detected
- 7 Sample collected by client, analyzed as received
- 8 pH and Chlorine level tested in lab

Reason for Test : Use & Occupancy

Building Permit # : 13004093

Date Reported: 1/8/2015

FOUNTAIN VALLEY ANALYTICAL LABORATORY, INC.

1413 Old Taneytown Rd. Westminster, MD (410) 848-1014 (410) 876-4554 FAX (410) 848-0298

REPORT OF ANALYSIS

Laboratory ID #: 98473 Account #: 1930
Reference: Toll Brothers Lot 20 Company: Fogle's Well Drilling
Location: 14881 Meriwether Drive Requested By: Dave Fogle
Glenelg, MD 21737 Source: Well Water
Date/ Time Collected: 1/7/2015 1430 Site: Laundry Tub
Date/Time Rec'd: 1/7/2015 1528 Treatment: None
Chlorine ppm: Free: ND Total: ND pH: 5.4
Collected By: J. Fogle 1974JF Well #: HO-95-2072

PARAMETERS	RESULTS	UNITS	REFERENCE	METHOD	DATE/TIME/ANALYST
Bacteria, Coliform, Total, MPN	5.3	MPN/ 100 ml	<1.0	SM18 9223	1/8/2015 / 0935 / CCH
Bacteria, E. coli, MPN	<1.0	MPN/ 100 ml	<1.0	SM18 9223	1/8/2015 / 0935 / CCH
Nitrate	5.96	mg/L	10	601	1/7/2015 / 1600 / CRS
Turbidity	1.27	NTU	<10	SM18 2130B	1/7/2015 / 1620 / CRS
Sand	NS	mg/L	5	Visual/Gravimetric	1/7/2015 / 1620 / CRS

NOTES

- 1 mg/L = milligrams per liter (also, parts per million)
- 2 MPN/ 100 ml = Most Probable Number [of viable bacteria] per 100 ml of sample.
- 3 NS = None Seen (NS indicates less than 5 mg/L)
- 4 NTU = Nephelometric Turbidity Units
- 5 Results less than or within the reference range are considered satisfactory and within potable water limits at the time of sampling.
- 6 ND:None Detected
- 7 Sample collected by client, analyzed as received
- 8 pH and Chlorine level tested in lab

Reason for Test : Use & Occupancy**Building Permit # :** 13004093Date Reported: 1/8/2015

11. NON-TRANSFERRABLE - THIS PERMIT IS NON-TRANSFERRABLE. A NEW OWNER MAY ACQUIRE AUTHORIZATION TO CONTINUE THIS APPROPRIATION BY FILING A NEW APPLICATION WITH THE ADMINISTRATION. AUTHORIZATION WILL BE ACCOMPLISHED BY ISSUANCE OF A NEW PERMIT.

12. *****
* INITIATION OF WITHDRAWAL - THE PERMITTEE SHALL NOTIFY THE*
* ADMINISTRATION BY CERTIFIED MAIL WHEN WITHDRAWALS FOR THE*
* USES SPECIFIED IN THIS PERMIT HAVE BEEN INITIATED. THIS *
* PERMIT SHALL EXPIRE IF WATER WITHDRAWAL IS NOT COMMENCED *
* WITHIN TWO YEARS AFTER THE EFFECTIVE DATE OF THIS PERMIT *
* EXCEPT THAT UPON WRITTEN REQUEST TO THE ADMINISTRATION *
* PRIOR TO THE EXPIRATION OF THE TWO YEAR PERIOD, THE TIME *
* LIMIT MAY BE EXTENDED FOR GOOD CAUSE, AT THE DISCRETION *
* OF THE ADMINISTRATION. *

13. WELL SPACING- IN ORDER TO MINIMIZE THE POTENTIAL FOR INTERFERENCE BETWEEN WELLS, ALL WELLS SHALL BE LOCATED WITHIN LOCALLY APPROVED WELL BOXES AND, WHERE FEASIBLE, BE CONSTRUCTED SO AS TO ACHIEVE A SEPARATION OF AT LEAST 100 FEET FROM EACH OTHER AND/OR FROM EXISTING WELLS ON OTHER PROPERTIES. THE PERMITTEE SHALL CONDUCT SIMULTANEOUS YIELD TESTS FOR ANY WELLS THAT ARE SEPARATED BY LESS THAN 100 FEET. IN THE EVENT THAT A WELL TESTED SIMULTANEOUSLY WITH OTHER WELLS DOES NOT MEET MINIMUM YIELD STANDARDS, THE PERMITTEE SHALL RELOCATE OR DEEPEN THE WELL OR SEEK LOCAL APPROVAL TO RELOCATE THE WELL BOXES SO AS TO ACHIEVE THE 100-FOOT SEPARATION DISTANCE. ALL WELLS SHALL COMPLY WITH WELL CONSTRUCTION REQUIREMENTS.

BY AUTHORITY OF THE DIRECTOR
WATER MANAGEMENT ADMINISTRATION

John W. Grace

2/6/2009

for John W. Grace, Chief
SOURCE PROTECTION AND APPROPRIATION DIV

MSM