

# APPLICATION

PERCOLATION TESTING

A 42612  
P \_\_\_\_\_

HOWARD COUNTY HEALTH DEPARTMENT  
BUREAU OF ENVIRONMENTAL HEALTH  
P.O. BOX 476 ELLICOTT CITY, MARYLAND 21043  
TELEPHONE: 461-9933

DISTRICT 4<sup>TH</sup>

8-05-88 DATE \_\_\_\_\_

TO: THE COUNTY HEALTH OFFICER  
ELLICOTT CITY, MARYLAND

I, HEREBY, APPLY FOR THE NECESSARY TEST IN ORDER TO CONSTRUCT (OR RECONSTRUCT) A SEWAGE DISPOSAL SYSTEM.

PROPERTY OWNER Mr. Robert M. Warfield Selfridge Builders

ADDRESS 2425 Daisy Road, Woodbine, Md. 21797 PHONE 410-799-0200

PROSPECTIVE BUYER Carman Associates

ADDRESS P.O. Box 122, Ellicott City, Md. PHONE 854-6797

PROPERTY LOCATION:

SUBDIVISION Warfields Grant LOT NO. 188

ROAD AND DESCRIPTION West Side Daisy Road (16003 Misty Knoll Court)

TAX MAP 13 PARCEL # 128

SEWER PERMIT SIGNED  
AND RETURNED 4/19/95  
SFD - 4 Boms  
(SINGLE FAMILY DWELLING OR COMMERCIAL)

SIZE OF LOT 3 acres TYPE SFD

THE SYSTEM INSTALLED UNDER THIS APPLICATION IS ACCEPTABLE ONLY UNTIL PUBLIC FACILITIES BECOME AVAILABLE. I FULLY UNDERSTAND THE

FEE CONNECTED WITH THE FILING OF THIS PERC TEST APPLICATION IS NON-REFUNDABLE UNDER ANY CIRCUMSTANCES. I ALSO AGREE TO COMPLY

WITH ALL M.O.S.H.A. REQUIREMENTS IN TESTING THIS LOT. Philip A. Mangoff

(SIGNATURE OF APPLICANT)

APPROVED BY \_\_\_\_\_ FOR \_\_\_\_\_ DATE \_\_\_\_\_

REJECTED BY \_\_\_\_\_ FOR \_\_\_\_\_ DATE \_\_\_\_\_

HOLD PENDING FURTHER TESTS \_\_\_\_\_ DATE \_\_\_\_\_

REASONS FOR REJECTION OR HOLDING 10/27/88 Perc Satisfactory - Providing Area can be moved higher than hole four (4) w/ 10R & w/ suitable house level size. Hold for PERC. sab

HD-216

# THIS IS NOT A PERMIT

A-42612

②  
SOIL PROFILE

0	AD
5"	Yellow Bk silty clay loam 10-20% Frag
3'	Yellow Bk Micaceous silty loam 10-20% Frag
12"	

DAISY Rd.

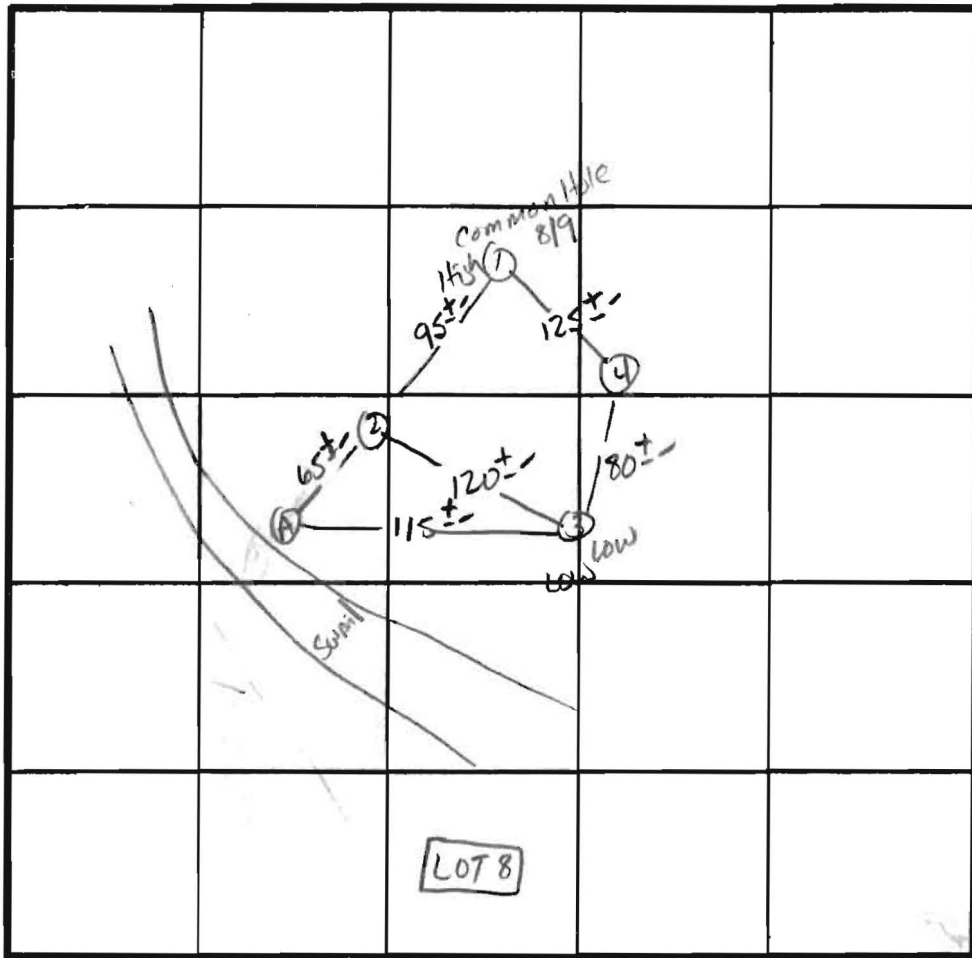

$\bar{x}$  Perc  
4min  
180#/BR  
Inlet 3'  
Bottom 45'

INDICATE NORTH - NAME ADJOINING ROADWAY AS BASE LINE.

EDWARDS Rd.

DATE	TEST NO.	DEPTH	PRE-WET		TEST - 1" DROP		TIME
			START	STOP	START	STOP	
10/27/68	1S	4"	12:51	12:53	12:53	12:58	5min
		8"	12:52	12:54	12:54	12:57	3min
	1V	12.5	As Profiled				
	2S	3.5	1:11	1:13	1:13	1:15	2 min
		8.0	1:11	1:12	1:12	1:14	2 min
	2V	12.0	As Profiled				
	3S	3.0	1:14	1:16	1:16	1:21	5 min
		12"	Similar	to Profile	H <sub>2</sub> O AT	11.2"	
	4S	3.0"	1:13	1:14	1:14	1:17	3min
		12.5	Similar	TO Profile			
11/9/68	(B)	4"	10:58	11:04	11:04	11:14	10min
		11V	Water				
	A-	H <sub>2</sub> O 10.0'					

REMARKS Holes Diff Than PLAT - Shallow Syst only - move Perc Area Above Hole # 3 to Hole 4+ Above to Pass Lot's SAG

TYPE OF SOIL \_\_\_\_\_

TESTED BY S. Abel

ALSO PRESENT Phil M., Roby  
Machin, C-13361

LOT 3  
3.025 AC±

SHEET 2 OF 3

BUCKS RUN COU  
N46°00'00"E 359.64'  
S46°00'00"W 359.64'

LOT 8  
3.102 AC±

LOT 10  
3.152 AC±

LOT 9  
3.764 AC±

LOT 7  
3.028 AC±

25' WETLANDS  
BUFFER  
LOT 16  
3.060 AC±

ARFIELD'S GRANT LIMITED PARTNERSHIP

