

C1 3457

SEQUENCE NO. (MDE USE ONLY)

STATE OF MARYLAND WELL COMPLETION REPORT FILL IN THIS FORM COMPLETELY PLEASE TYPE

THIS REPORT MUST BE SUBMITTED WITHIN 45 DAYS AFTER WELL IS COMPLETED.

COUNTY NUMBER 13 A511503

1 2 3 4 5 6 (THIS NUMBER IS TO BE PUNCHED IN COLS. 3-6 ON ALL CARDS)

ST/CO USE ONLY DATE Received MM DD YY

DATE WELL COMPLETED MM DD YY 6-7-04

Depth of Well 22 300 26 (TO NEAREST FOOT)

PERMIT NO. FROM "PERMIT TO DRILL WELL" HO-94-3921

OWNER Pulte Homes, Inc. STREET OR RFD 3205 Route 32 TOWN West Friendship SUBDIVISION Paddocks East SECTION LOT 22

WELL LOG

Not required for driven wells

STATE THE KIND OF FORMATIONS PENETRATED, THEIR COLOR, DEPTH, THICKNESS AND IF WATER BEARING

Table with columns: DESCRIPTION (Use additional sheets if needed), FEET (FROM, TO), check if water bearing. Rows include Brown mica, Gray mica, white, Gray mica, white, Gray mica.

GROUTING RECORD

WELL HAS BEEN GROUTED (Circle Appropriate Box) YES Y NO N TYPE OF GROUTING MATERIAL (Circle one) CEMENT CM BENTONITE CLAY BC NO. OF BAGS 19 NO. OF POUNDS 1786 GALLONS OF WATER 114 DEPTH OF GROUT SEAL (to nearest foot) from 0 ft. to 32 ft.

CASING RECORD

MAIN CASING TYPE ST Nominal diameter top (main) casing (nearest inch)! 6 Total depth of main casing (nearest foot) 63

OTHER CASING (if used)

Table with columns: diameter inch, depth (feet) from, to. Rows for EACH CASING.

SCREEN RECORD

screen type or open hole insert appropriate code below ST BR HO PL OT

DEPTH (nearest ft.) HO 63 300

Table with columns: A, C, H, S, R, E, N. Rows for slot size and diameter of screen.

GRAVEL PACK IF WELL DRILLED WAS FLOWING WELL INSERT F IN BOX 68

MDE USE ONLY (NOT TO BE FILLED IN BY DRILLER) T (E.R.O.S.) W Q TELESCOPE CASING LOG INDICATOR OTHER DATA

C 3

PUMPING TEST

HOURS PUMPED (nearest hour) 3 PUMPING RATE (gal. per min.) 5.11 METHOD USED TO MEASURE PUMPING RATE 1 gal WATER LEVEL (distance from land surface) BEFORE PUMPING 21 ft. WHEN PUMPING 126 ft. TYPE OF PUMP USED (for test) S submersible

PUMP INSTALLED

DRILLER INSTALLED PUMP YES NO IF DRILLER INSTALLS PUMP, THIS SECTION MUST BE COMPLETED FOR ALL WELLS. TYPE OF PUMP INSTALLED PLACE (A,C,J,P,R,S,T,O) IN BOX 29. CAPACITY: GALLONS PER MINUTE (to nearest gallon) 31 35 PUMP HORSE POWER 37 41 PUMP COLUMN LENGTH (nearest ft.) 43 47 CASING HEIGHT (circle appropriate box and enter casing height) + above LAND SURFACE - below 01 (nearest foot)

LOCATION OF WELL ON LOT

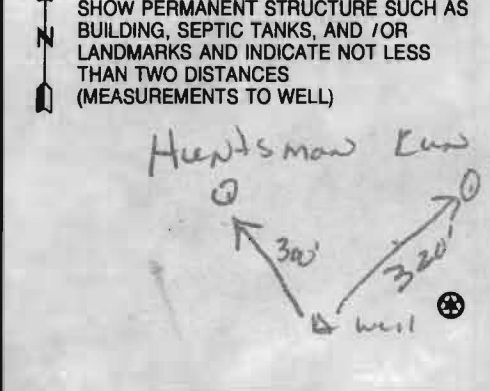

NUMBER OF UNSUCCESSFUL WELLS: 0

WELL HYDROFRACTURED YES Y NO N

CIRCLE APPROPRIATE LETTER A A WELL WAS ABANDONED AND SEALED WHEN THIS WELL WAS COMPLETED E ELECTRIC LOG OBTAINED P TEST WELL CONVERTED TO PRODUCTION WELL

I HEREBY CERTIFY THAT THIS WELL HAS BEEN CONSTRUCTED IN ACCORDANCE WITH COMAR 26.04.04 "WELL CONSTRUCTION" AND IN CONFORMANCE WITH ALL CONDITIONS STATED IN THE ABOVE CAPTIONED PERMIT, AND THAT THE INFORMATION PRESENTED HEREIN IS ACCURATE AND COMPLETE TO THE BEST OF MY KNOWLEDGE.

DRILLERS LIC. NO. M SD 009

DRILLERS SIGNATURE (MUST MATCH SIGNATURE ON APPLICATION)

LIC. NO. D

SITE SUPERVISOR (sign. of driller or journeyman responsible for sitework if different from permittee)

B 1 0993

SEQUENCE NO. (MDE USE ONLY)

STATE OF MARYLAND APPLICATION FOR PERMIT TO DRILL WELL

STATE PERMIT NUMBER

HO-94-3921

520092 please type

fill in this form completely

Date Received (APA)

3/11/2004

OWNER INFORMATION

MORDELEY, Grotchen, Summer Hill Farm Rt 144, West Friendship Md, 21794

LOCATION OF WELL

Howard, Paddicks East, SECTION 44 46 LOT 48 50, GENEVIA, 2 MILES FROM TOWN

DRILLER INFORMATION

Allen Compton, MS D 009, Fogles Well Drilling, 580 Obrecht Rd., 1-31-04

DIRECTION OF WELL FROM TOWN

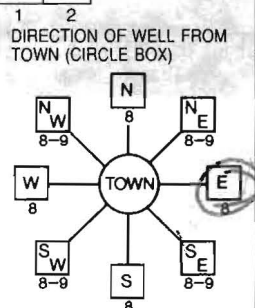

Huntsmans Run, Sykesville Rd.

ON WHICH SIDE OF ROAD (CIRCLE APPROPRIATE BOX) EAST, 34 650 37, DISTANCE FROM ROAD, TAX MAP: 22 BLK: 8 PARCEL 7

WELL INFORMATION

APPROX. PUMPING RATE 5 GAL. PER MIN., AVERAGE DAILY QUANTITY NEEDED 500 GAL. PER DAY

USE FOR WATER (CIRCLE APPROPRIATE BOX)

- Domestic Potable Supply & Residential Irrigation (D), Farming (F), Industrial, Commercial, Dewatering (I), Public Water Supply Well (P), Test, Observation, Monitoring (T), Geo-Thermal (G)

NOT TO BE FILLED IN BY DRILLER HEALTH DEPARTMENT APPROVAL

Howard (13) A511503, COUNTY NAME, COUNTY NO., STATE SIGNATURE, DATE ISSUED 3/18/2004, CO SIGNATURE Brian Baker 3/18/2005, NORTH GRID 526 000, EAST GRID 808 000

APPROXIMATE DEPTH OF WELL 300 FEET

APPROXIMATE DIAMETER OF WELL 6 INCH

METHOD OF DRILLING (circle one)

BORED (or Augered), JETTED, Jetted & DRIVEN, AIR-ROTary, AIR-PERCussion, ROTARY (Hydraulic Rotary), CABLE, REverse-ROTary, DRIVE-POINT

REPLACEMENT OR DEEPEMED WELLS (CIRCLE APPROPRIATE BOX)

- THIS WELL WILL NOT REPLACE AN EXISTING WELL (N), THIS WELL WILL REPLACE A WELL THAT WILL BE ABANDONED AND SEALED (Y), THIS WELL WILL REPLACE A WELL THAT WILL BE USED AS A STANDBY-CONTACT LOCAL APPROVING AUTHORITY FOR POLICY ON STANDBY WELLS (S), THIS WELL WILL DEEPEM AN EXISTING WELL (D)

PERMIT NUMBER OF WELL TO BE REPLACED OR DEEPEMED (IF AVAILABLE)

Not to be filled in by driller (MDE OR COUNTY USE ONLY)

APPROX. PERMIT NUMBER H02002G009, PERMIT No. HO-94-3921

SHOW MAJOR FEATURES OF BOX & LOCATE WELL WITH AN X

SOURCES OF DRILLING WATER

WRITE THE BOX NUMBER FROM THE MAP HERE

E 8008, N 5206

DRAW A SKETCH BELOW SHOWING LOCATION OF WELL IN RELATION TO NEARBY TOWNS AND ROADS AND GIVE DISTANCE FROM WELL TO NEAREST ROAD JUNCTION



SPECIAL CONDITIONS

NOTE - APPROVING AUTHORITIES SHOULD USE SEPARATE SHEET IF NEEDED

HOWARD COUNTY HEALTH DEPARTMENT
BUREAU OF ENVIRONMENTAL HEALTH
WATER AND SEWERAGE PROGRAM
TEL: (410)313-2640 FAX: (410)313-2648

Information Form for the Installation of the Well Pump, Pitless Adapter, and Supply Piping

NOTE: The installer is responsible for requesting an inspection prior to 9 am on the day of the desired inspection. No work is to be covered until approved by the Health Department. All installations must comply with the National Standard Plumbing Code (NSPC, as amended locally) and COMAR 26.04.04 (MD Well Construction Regulations). Submission of a complete form is required prior to Use and Occupancy approval.

Company Name: Fogles Well Drilling Telephone #: 410-795-5670
Address: 580 Obrecht Rd
Sykesville, Md 21784

(Must circle one) Licensed Plumber Licensed Well Driller Licensed Well Pump Installer
License # and name of individual responsible for the field installation:

Name (Print): Allen Compton License# MSD 009

*A licensed individual must perform the actual installation. Apprentices must be under the direct supervision of a licensed journeyman or master plumber, pump installer or well driller. Licenses may be subjected to field verification.

Name of Property Owner: Pulte Homes Telephone #:
Subdivision: The Paddocks East Lot #: 22 Well Tag #: HO-94-3921
Site Address: Hudsonian Run

<u>Submersible Pump Data</u>	<u>Pitless Adapter</u>	<u>Well Cap and Electric Conduit</u>
Make: <u>Goulds</u>	Make: <u>Campbell</u>	Two piece watertight cap: <u>yes</u>
Model #: <u>75807422</u>	Model#: <u>N/A</u>	Screened, vented well cap: <u>yes</u>
Pump Capacity <u>7</u> GPM	Depth: <u>36</u> (36" min)	Cap secured to casing: <u>yes</u>
Well Yield: <u>5</u> GPM	NSF approved: <u>yes</u>	Conduit min 18" B.G.: <u>yes</u>
Depth of well encountered at time of pump installation: <u>300</u> (feet)		Conduit secured to well cap: <u>yes</u>
If pump capacity exceeds well yield, a low water cut off switch is required by NSPC 1990 Section 17.8.4		
Torque arrestors or Cable guards are required - Must circle one		
Safety rope, if used, attached to inside of well casing with eye bolt <u>N/A</u>		

<u>Piping to house</u>	<u>House Connection</u>
Type: <u>1" Black Plastic</u>	PVC sleeved to undisturbed soil at wall penetration: <u>yes</u>
PSI: <u>160</u> (160 psi min)	Approximate length of sleeve: <u>5</u>
Depth of supply line: <u>42</u> (36" min)	Sleeve caulked and sealed properly: <u>yes</u>

The water supply line is required to be at least ten feet from the septic tank, pump chamber, sewage piping, distribution box, drainfields, and sewage reserve area. If this cannot be accomplished, contact this office for approval prior to installation.

Allen Compton 4-7-06
Signature of company representative responsible for installation date

For Health Department Use Only - Not to be completed by Installer

Date Insp. Requested: _____ Date Insp. Approved: 4/18/06 BB

Inspection Data:

Pitless adapter and water supply line at least 36" below grade	<input checked="" type="checkbox"/>
Two piece cap installed and attached to casing securely	<input checked="" type="checkbox"/>
Elec. conduit extends at least 18" below grade/attached to cap properly	<input checked="" type="checkbox"/>
Safety rope installed inside of well casing	<input checked="" type="checkbox"/>
Correct well tag attached properly and casing 8" above finished grade	<input checked="" type="checkbox"/>
Water supply line sleeved adequately at house connection	<input checked="" type="checkbox"/>
Adequate grout observed below pitless adapter	<input checked="" type="checkbox"/>

3/19/04

Well site staked
by surveyor on
3/12/04

BB

HUNTSMAN'S RUN

460

S 15°44'02" E 281.68

250

480
490

500

510

520

530

560

570

580

N 80°36'22" E 874.45

1008
PROP. 20' UTILITY EASEMENT

Proposed
Septic Easement
1,092sf ±

1002

1001
1003
1004

140'

126'

PROP. 20' DRAINAGE
PROP. 20' UTILITY EASEMENT

PROP. 5' TREASURY
BUFFER

LIMITS OF 100
YEAR FLOODPLAIN

251

NON-BUILDABLE PRESERVATION
PARCEL "G" PRIVATELY OWNED
AND MAINTAINED 03.93 ac ±

50'
STREAM
BUFFER

470

480

490

500

510

520

530

FOUNTAIN VALLEY ANALYTICAL LABORATORY, INC.

1413 Old Taneystown Rd. Westminster, MD (410) 848-1014 (410) 876-4554 FAX (410) 848-0298

REPORT OF ANALYSIS

Laboratory ID #: 58840 Account #: 1930
 Reference: Pulte Lot 22 Company: Fogle's Well Drilling
 Location: 3421 Huntsman Run Requested By: Dave Fogle
 Ellicott City, MD 21042 Source: Well Water
 Date/ Time Collected: 4/18/2006 1000 Site: Kitchen Sink Tap
 Date/Time Rec'd: 4/18/2006 1120 Treatment: None
 Chlorine ppm: Free: ND Total: ND pH: 6.2
 Collected By: V.M. Fadoul 6804VF-FS Well #: HO-94-3921

PARAMETERS	RESULTS	UNITS	REFERENCE	METHOD	DATE/TIME/ANALYST
Bacteria, Coliform, Total, MPN	<1.0	MPN/ 100 ml	<1.0	SM18 9223 B.	4/19/2006 / 1145 / AMD/CM
Bacteria, E. coli, MPN	<1.0	MPN/ 100 ml	<1.0	SM18 9223 B.	4/19/2006 / 1145 / AMD/CM
Nitrate	1.84	mg/L	10	601	4/18/2006 / 1500 / CWM
Turbidity	5.33	NTU	<10	SM18 2130B	4/18/2006 / 1515 / AMD/CM
Sand	NS	mg/L	5	Visual/Gravimetric	4/18/2006 / 1515 / AMD/CM

NOTES:

- 1 mg/L = milligrams per liter (also, parts per million)
- 2 MPN/ 100 ml - Most Probable Number [of viable bacteria] per 100 ml of sample.
- 3 NS = None Seen (NS indicates less than 5 mg/L)
- 4 NTU = Nephelometric Turbidity Units
- 5 Results less than or within the reference range are considered satisfactory and within potable water limits at the time of sampling.
- 6 ND:None Detected
- 7 Sample collected by client, analyzed as received
- 8 pH tested on-site

Reason for Test : Use & Occupancy

Building Permit # : B00154757

Date Reported: 4/19/2006

MD State Certification # 133



7178 Columbia Gateway Drive, Columbia Maryland 21046
(410) 313-1771 Fax (410) 313-2648
TDD (410) 313-2323 Toll Free 1-866-313-6300
website: www.hchealth.org

Pennv E. Borenstein, M.D., M.P.H., Health Officer

April 21, 2006

Pulte Homes, Inc.
1501 S. Edgewood Street
Baltimore, MD 21227

RE: Paddocks East, Lot 22
3421 Huntsman Run
West Friendship, MD 21794
BP #: B00154757
Well Permit # HO-94-3921

Dear Madam:

This is to advise you that the septic system for the above referenced property has been installed and inspected. **Final approval of the septic system was granted on 04/19/06. Final approval of the well line connection to the dwelling was approved on 04/18/2006.**

The water sample results indicate that the water samples submitted for testing were free of coliform and fecal coliform bacteria at the time of sampling and are bacteriologically safe for drinking. The water sample results were found to be in compliance with COMAR water quality standards.

INTERIM CERTIFICATE OF POTABILITY

This certifies that the initial sampling requirements of COMAR 26.04.04 "Well Regulations" have been met for the water supply system installed under well permit #HO-94-3921. Although the submitted sample results are in compliance with COMAR standards, the Health Department does not guarantee water supplies. Based upon satisfactory investigation and evaluation, the Howard County Health Department as authorized by the Maryland Department of the Environment accepts this well system as required by COMAR 26.04.04.

This certificate may become final upon completion of the second bacteriological test, which is to be taken by the county health department within six months of receipt of this letter. **Please contact (410) 313-1773 to schedule a final water sample appointment. Currently, there is no charge for this final sampling.**

Date of Water Sample: 04/18/2006
Date of Well Completion: 06/07/2004

Approving Authority,

Stuart Oster, R. S.
Well & Septic Program

cc: Building Inspector's Office
Community Health Services
File

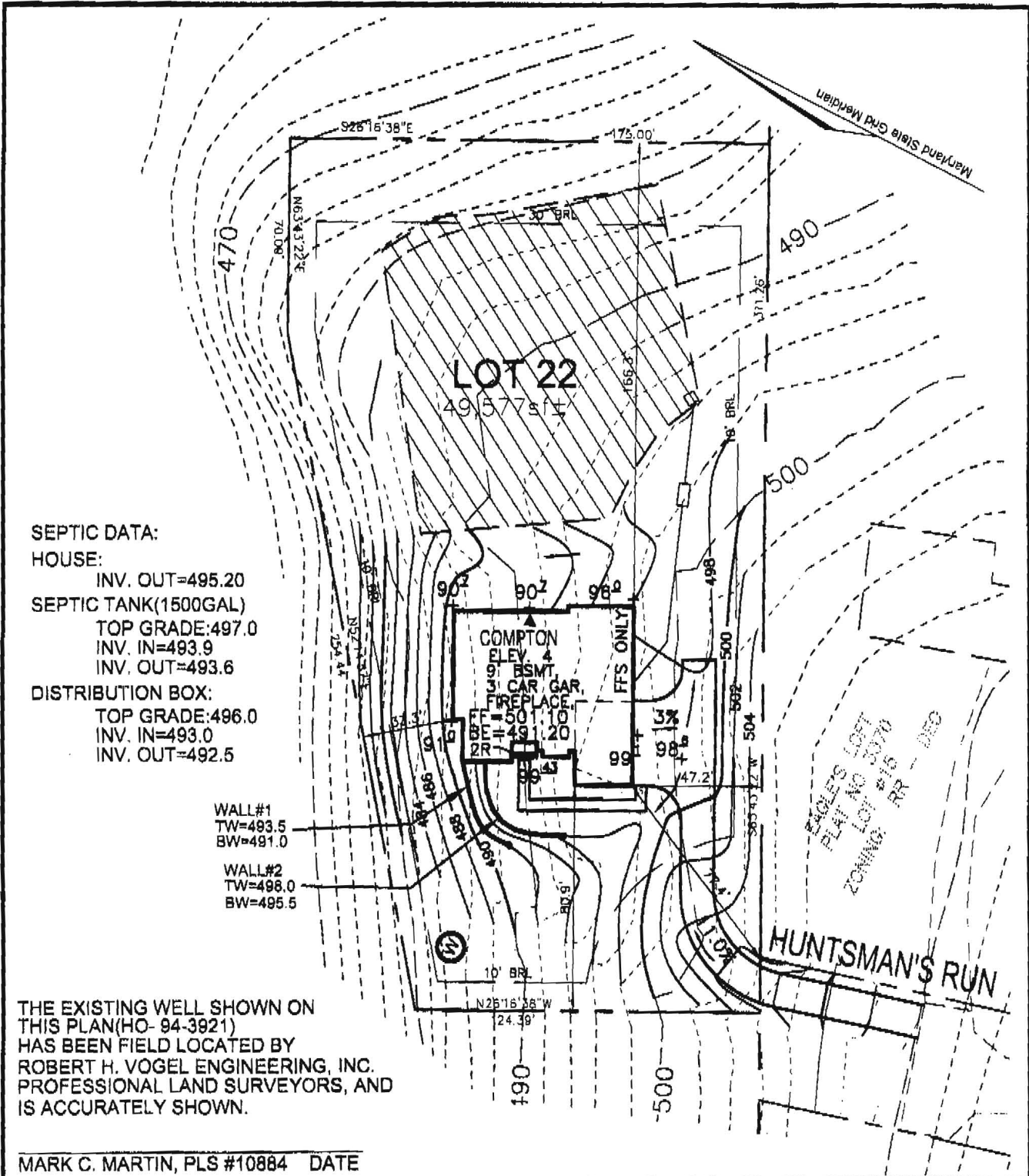

SEPTIC DATA:
 HOUSE:
 INV. OUT=495.20
 SEPTIC TANK(1500GAL)
 TOP GRADE:497.0
 INV. IN=493.9
 INV. OUT=493.6
 DISTRIBUTION BOX:
 TOP GRADE:496.0
 INV. IN=493.0
 INV. OUT=492.5

WALL#1
 TW=493.5
 BW=491.0
 WALL#2
 TW=498.0
 BW=495.5

THE EXISTING WELL SHOWN ON THIS PLAN(HO- 94-3921) HAS BEEN FIELD LOCATED BY ROBERT H. VOGEL ENGINEERING, INC. PROFESSIONAL LAND SURVEYORS, AND IS ACCURATELY SHOWN.

MARK C. MARTIN, PLS #10884 DATE

SCALE 1"=50'
 DRAWN BY JCO
 CHECKED BY RHV
 DATE JUNE, 2005
 W. O. # 2034058
 SHEET# 1 OF 1

TAX MAP 22
 3RD ELECTION DISTRICT
 REV. 7/25/05
 REV. 9/21/05

PULTE HOMES PARCEL 7
 PADDOCKS EAST HOWARD COUNTY, MARYLAND



LOT 22
ROBERT H. VOGEL ENGINEERING, INC.
 ENGINEERS • SURVEYORS • PLANNERS
 8407 MAIN STREET TEL: 410.461.7866
 ELLICOTT CITY, MD 21043 FAX: 410.461.8961