

0638

SEQUENCE NO. (MDE USE ONLY)

STATE OF MARYLAND WELL COMPLETION REPORT

FILL IN THIS FORM COMPLETELY PLEASE TYPE

THIS REPORT MUST BE SUBMITTED WITHIN 45 DAYS AFTER WELL IS COMPLETED.

COUNTY NUMBER

13 11/19/01 OK

(THIS NUMBER IS TO BE PUNCHED IN COLS. 3-6 ON ALL CARDS)

ST/CO USE ONLY

DATE WELL COMPLETED

Depth of Well

PERMIT NO. FROM "PERMIT TO DRILL WELL"

DATE RECEIVED MM DD YY

10/19/01

22 500 26 (TO NEAREST FOOT)

HO-94-3177

OWNER: Floyd Lane LLC, STREET OR RFD: Buckskin Wood Drive, TOWN: Bellicott City, SUBDIVISION: Buckskin Ridge, SECTION: , LOT: 34

WELL LOG Not required for driven wells

GRROUTING RECORD yes no WELLS HAS BEEN GROUTED (Circle Appropriate Box) Y N

PUMPING TEST 1 2 C 3

STATE THE KIND OF FORMATIONS PENETRATED, THEIR COLOR, DEPTH, THICKNESS AND IF WATER BEARING

TYPE OF GROUTING MATERIAL (Circle one) CEMENT CM BENTONITE CLAY BC

HOURS PUMPED (nearest hour) 3

Table with columns: DESCRIPTION (Use additional sheets if needed), FEET (FROM, TO), check if water bearing. Rows include Top Soil, Brown Shale, Brown Mica, Gray Mica, Opening, Fractured zone, Gray Mica.

NO. OF BAGS 25 NO. OF POUNDS 2500 GALLONS OF WATER 150 DEPTH OF GROUT SEAL (to nearest foot) from 0 ft. to 99 ft.

PUMPING RATE (gal. per min.) 10 METHOD USED TO MEASURE PUMPING RATE Bucket

CASING RECORD casing types insert appropriate code below ST STEEL CO CONCRETE PL PLASTIC OT OTHER

WATER LEVEL (distance from land surface) BEFORE PUMPING 107 ft. WHEN PUMPING 190 ft.

MAIN CASING TYPE St Nominal diameter top (main) casing (nearest inch)! 6" Total depth of main casing (nearest foot) 113'

TYPE OF PUMP USED (for test) A air P piston T turbine C centrifugal R rotary O other J jet S submersible

OTHER CASING (if used) diameter inch depth (feet) from to

PUMP INSTALLED DRILLER INSTALLED PUMP (CIRCLE) (YES or NO) YES NO

NUMBER OF UNSUCCESSFUL WELLS: 0

DEPTH (nearest ft.) HO 111 500

TYPE OF PUMP INSTALLED PLACE (A,C,J,P,R,S,T,O) IN BOX 29 CAPACITY: GALLONS PER MINUTE (to nearest gallon) 31 35

WELL HYDROFRACTURED yes no Y N

SCREEN RECORD screen type or open hole insert appropriate code below ST STEEL BR BRASS PL PLASTIC HO OPEN HOLE OT OTHER

PUMP HORSE POWER 37 41 PUMP COLUMN LENGTH (nearest ft.) 43 47

CIRCLE APPROPRIATE LETTER A A WELL WAS ABANDONED AND SEALED WHEN THIS WELL WAS COMPLETED E ELECTRIC LOG OBTAINED P TEST WELL CONVERTED TO PRODUCTION WELL

SLOT SIZE 1 2 3 DIAMETER OF SCREEN (NEAREST INCH) 58 60

CASING HEIGHT (circle appropriate box and enter casing height) above below LAND SURFACE (nearest foot) 2

I HEREBY CERTIFY THAT THIS WELL HAS BEEN CONSTRUCTED IN ACCORDANCE WITH COMAR 26.04.04 "WELL CONSTRUCTION" AND IN CONFORMANCE WITH ALL CONDITIONS STATED IN THE ABOVE CAPTIONED PERMIT, AND THAT THE INFORMATION PRESENTED HEREIN IS ACCURATE AND COMPLETE TO THE BEST OF MY KNOWLEDGE.

GRAVEL PACK IF WELL DRILLED WAS FLOWING WELL INSERT F IN BOX 68

LOCATION OF WELL ON LOT SHOW PERMANENT STRUCTURE SUCH AS BUILDING, SEPTIC TANKS, AND /OR LANDMARKS AND INDICATE NOT LESS THAN TWO DISTANCES (MEASUREMENTS TO WELL) see plat

DRILLERS LIC. NO. 1 MWD 040 DRILLERS SIGNATURE (MUST MATCH SIGNATURE ON APPLICATION)

MDE USE ONLY (NOT TO BE FILLED IN BY DRILLER) T (E.R.O.S.) W Q

LIC. NO. 1 MSD 038

70 72 TELESCOPE CASING LOG INDICATOR OTHER DATA

SITE SUPERVISOR (sign. of driller or journeyman responsible for sitework if different from permittee)

B 1 9260

SEQUENCE NO. (MDE USE ONLY)

STATE OF MARYLAND PERMIT TO DRILL WELL

STATE PERMIT NUMBER

HO-94-3177

W515311 please print or type

Date Received (APA)

06-28-01

OWNER INFORMATION

8651

Floyd Lane L L C

P. O. Box 999

Columbia, Md 21044

Town State Zip

B 3

Howard

LOCATION OF WELL

CC#

Buckskin Ridge

SECTION LOT

Glenelg

NEAREST TOWN

MILES FROM TOWN

DRILLER INFORMATION

George F. Easterday

M W D 040

L. Franklin Easterday, Inc.

9265 Brown Church Rd., Mt. Airy, Md. 21771

George F. Easterday 6/25/2001

B 4

DIRECTION OF WELL FROM TOWN

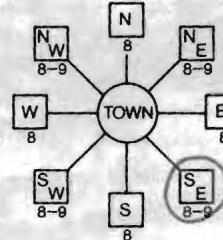

Buckskin Wood Drive

NEAR WHAT ROAD

ON WHICH SIDE OF ROAD



DISTANCE FROM ROAD

ENTER FT OR MI

TAX MAP: BLK: PARCEL

B 2

WELL INFORMATION

APPROX. PUMPING RATE 5

AVERAGE DAILY QUANTITY NEEDED 500

USE FOR WATER

- DOMESTIC POTABLE SUPPLY & RESIDENTIAL IRRIGATION
FARMING (LIVESTOCK WATERING & AGRICULTURAL IRRIGATION)
INDUSTRIAL, COMMERCIAL, DEWATERING
PUBLIC WATER SUPPLY WELL
TEST, OBSERVATION, MONITORING
GEO-THERMAL

NOT TO BE FILLED IN BY DRILLER HEALTH DEPARTMENT APPROVAL

Howard 13
COUNTY NAME COUNTY NO.

STATE SIGNATURE INSERT S

DATE ISSUED

519 000 0806 000
GRID EAST GRID

APPROXIMATE DEPTH OF WELL 300 FEET

APPROXIMATE DIAMETER OF WELL 6 INCH

METHOD OF DRILLING

- BORED (or Augered) JETTED Jetted & DRIVEN
AIR-ROTary AIR-PERcussion ROTARY (Hydraulic Rotary)
CABLE REVERSE-ROTary DRIVE-POINT

REPLACEMENT OR DEEPEMED WELLS

- THIS WELL WILL NOT REPLACE AN EXISTING WELL
THIS WELL WILL REPLACE A WELL THAT WILL BE ABANDONED AND SEALED
THIS WELL WILL REPLACE A WELL THAT WILL BE USED AS A STANDBY-CONTACT LOCAL APPROVING AUTHORITY FOR POLICY ON STANDBY WELLS
THIS WELL WILL DEEPEM AN EXISTING WELL

PERMIT NUMBER OF WELL TO BE REPLACED OR DEEPEMED

Not to be filled in by driller (MDE OR COUNTY USE ONLY)

APPROX. PERMIT NUMBER HO 2000G 01 1(01)

PERMIT No HO-94-3177

SHOW MAJOR FEATURES OF BOX & LOCATE WELL WITH AN X

SOURCES OF DRILLING WATER

- 1. wells
2.
3.

WRITE THE BOX NUMBER FROM THE MAP HERE

519 000

DRAW A SKETCH BELOW SHOWING LOCATION OF WELL IN RELATION TO NEARBY TOWNS AND ROADS AND GIVE DISTANCE FROM WELL TO NEAREST ROAD JUNCTION

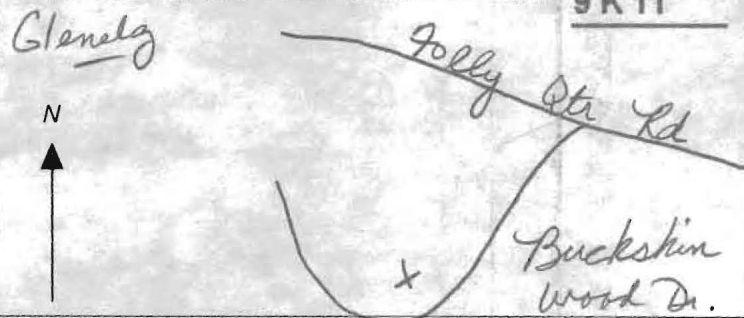

SPECIAL CONDITIONS

NOTE - APPROVING AUTHORITIES SHOULD USE SEPARATE SHEET IF NEEDED







HOWARD COUNTY HEALTH DEPARTMENT  
BUREAU OF ENVIRONMENTAL HEALTH  
WATER AND SEWERAGE PROGRAM  
TEL: (410)313-2640 FAX: (410)313-2648

Information Form for the Installation of the Well Pump, Pitless Adapter, and Supply Piping

NOTE: The installer is responsible for requesting an inspection prior to 9 am on the day of the desired inspection. No work is to be covered until approved by the Health Department. All installations must comply with the National Standard Plumbing Code (NSPC, as amended locally) and COMAR 26.04.04 (MD Well Construction Regulations). Submission of a complete form is required prior to Use and Occupancy approval.

Company Name: ROBERT L. FREEZER CO INC Telephone #: 410-781-4655  
Address: 6321 BALNETT AVENUE  
SYKEVILLE, MD 21784

(Must circle one) Licensed Plumber Licensed Well Driller Licensed Well Pump Installer

License # and name of individual responsible for the field installation:  
Name (Print): ROBERT L. FREEZER CO INC License# 2122

\*A licensed individual must perform the actual installation. Apprentices must be under the direct supervision of a licensed journeyman or master plumber, pump installer or well driller. Licenses may be subjected to field verification.

Name of Property Owner: STEEL ISAACS PLUMBING Telephone #: 410-442-5780  
Subdivision: BUCKSKIN RIDGE Lot #: 34 Well Tag #: HO-94-3177  
Site Address: 4298 BUCKSKIN WOOD DRIVE  
ELLCOTT CITY, MD 21042

<u>Submersible Pump Data</u>	<u>Pitless Adapter</u>	<u>Well Cap and Electric Conduit</u>
Make: <u>STALITE</u>	Make: <u>CAMPBELL</u>	Two piece watertight cap: <input checked="" type="checkbox"/>
Model #: <u>SSP4E02AL</u>	Model #: <u>PA800</u>	Screened, vented well cap: <input checked="" type="checkbox"/>
Pump Capacity: <u>5</u> GPM	Depth: <u>42</u> (36" min)	Cap secured to casing: <input checked="" type="checkbox"/>
Well Yield: <u>10</u> GPM	NSF approved: <input checked="" type="checkbox"/>	Conduit min 18" B.G.: <input checked="" type="checkbox"/>
Depth of well encountered at time of pump installation: <u>500</u> (feet)		Conduit secured to well cap: <input checked="" type="checkbox"/>

If pump capacity exceeds well yield, a low water cut off switch is required by NSPC 1990 Section 17.8.4

Torque arrestors or Cable guards are required - Must circle one.  
Safety rope, if used, attached to inside of well casing with eye bolt

<u>Piping to house</u>	<u>House Connection</u>
Type: <u>POLY</u>	PVC sleeved to undisturbed soil at wall penetration: <input checked="" type="checkbox"/>
PSI: <u>200</u> (150 psi min)	Approximate length of sleeve: <u>5</u>
Depth of supply line: <u>42</u> (36" min)	Sleeve caulked and sealed properly: <input checked="" type="checkbox"/>

The water supply line is required to be at least ten feet from the septic tank, pump chamber, sewage piping, distribution box, drainfields, and sewage reserve area. If this cannot be accomplished, contact this office for approval prior to installation.

Signature of company representative responsible for installation: Robert L. Freezer date: 5/31/06

For Health Department Use Only - Not to be completed by Installer

Date Insp. Requested: \_\_\_\_\_ Date Insp. Approved: 5/31/06 GAC  
Inspection Data: Pitless adapter and water supply line at least 36" below grade   
Two piece cap installed and attached to casing securely   
Elec. conduit extends at least 18" below grade/attached to cap properly   
Safety rope installed inside of well casing   
Correct well tag attached properly and casing 8" above finished grade   
Water supply line sleeved adequately at house connection   
Adequate grout observed below pitless adapter



# HOWARD COUNTY HEALTH DEPARTMENT

Bureau of Environmental Health  
7178 Columbia Gateway Drive, Columbia Maryland 21046  
(410) 313-2640 FAX (410) 313-2648  
TDD (410) 313-2323 Toll Free 1-877-4MD-DHMH

**Penny E. Borenstein, M.D., M.P.H., County Health Officer**

September 8, 2006

Columbia Builders  
P.O. Box 999  
Columbia, MD 21044

**SENT VIA FACSIMILE 410-992-3020**

RE: Buckskin Ridge, Lot 34  
4298 Buckskin Wood Drive  
Ellicott City, MD 21042  
BP #: B00157814  
Well Permit # HO-94-3177

Dear Sir:

This is to advise you that the septic system for the above referenced property has been installed and inspected. **Final approval of the septic system was granted on 05/31/2006. Final approval of the well line connection to the dwelling was approved on 05/31/2006.**

The water sample results indicate that the water samples submitted for testing were free of coliform and fecal coliform bacteria at the time of sampling and are bacteriologically safe for drinking. The water sample results were found to be in compliance with COMAR water quality standards.

## INTERIM CERTIFICATE OF POTABILITY

This certifies that the initial sampling requirements of COMAR 26.04.04 "Well Regulations" have been met for the water supply system installed under well permit #HO-94-3177. Although the submitted sample results are in compliance with COMAR standards, the Health Department does not guarantee water supplies. Based upon satisfactory investigation and evaluation, the Howard County Health Department as authorized by the Maryland Department of the Environment accepts this well system as required by COMAR 26.04.04.

This certificate may become final upon completion of the second bacteriological test, which is to be taken by the county health department within six months of receipt of this letter. **Please contact (410) 313-1773 to schedule a final water sample appointment. Currently, there is no charge for this final sampling.**

Date of Water Samples: 08/28/2006 & 09/07/2006  
Date of Well Completion: 10/04/2001

Approving Authority,

Stuart Oster, R. S.  
Well & Septic Program

cc: Building Inspector's Office  
Community Health Services  
File

**FOUNTAIN VALLEY ANALYTICAL LABORATORY, INC.**

1413 Old Taneytown Rd. Westminster, MD (410) 848-1014 (410) 876-4554 FAX (410) 848-0298

**REPORT OF ANALYSIS**

Laboratory ID #:	60517	Account #:	1550
Reference:	Lot 34	Company:	Columbia Builders
Location:	4298 Buckskinwood Drive Ellicott City, MD 21042	Requested By:	Terry Brownley
Date/ Time Collected:	9/7/2006 0930	Source:	Well Water
Date/Time Rec'd:	9/7/2006 1120	Site:	Holding Tank
Chlorine ppm:	Free: ND Total: ND	Treatment	Spindown Separator**
Collected By:	C. Mooshian 7268CM	nH:	7.1
		Well #:	HO-94-3177

PARAMETERS	RESULTS	UNITS	REFERENCE	METHOD	DATE/TIME/ANALYS
Bacteria, Coliform, Total, MPN	<1.0	MPN/ 100 ml	<1.0	SM18 9223 B.	9/8/2006 / 0930 / AMD/BCD
Bacteria, E. coli, MPN	<1.0	MPN/ 100 ml	<1.0	SM18 9223 B.	9/8/2006 / 0930 / AMD/BCD

**NOTES**

- 1 \*\*Sample collected prior to treatment
- 2 MPN/ 100 ml = Most Probable Number [of viable bacteria] per 100 ml of sample.
- 3 Results less than or within the reference range are considered satisfactory and within potable water limits at the time of sampling.
- 4 ND:None Detected
- 5 Visual well check: Sealed, vented cap
- 6 pH tested on-site

Reason for Test : Use &amp; Occupancy

Building Permit # : B00157814

Date Reported: 9/8/2006

**FOUNTAIN VALLEY ANALYTICAL LABORATORY, INC.**

1413 Old Taneytown Rd. Westminster, MD (410) 848-1014 (410) 876-4554 FAX (410) 848-0298

**REPORT OF ANALYSIS**

Laboratory ID #:	60370	Account #:	1550
Reference:	Lot 34	Company:	Columbia Builders
Location:	4298 Buckswood Drive Ellicott City, MD 21042	Requested By:	Terry Brownley
Date/ Time Collected:	8/28/2006 1150	Source:	Well Water
Date/Time Rec'd:	8/28/2006 1419	Site:	Holding Tank
Chlorine ppm:	Free: ND Total: ND	Treatment:	Spindown Separator**
Collected By:	J. Yeager 6176JY	pH:	7.2
		Well #:	HO-94-3177

PARAMETERS	RESULTS	UNITS	REFERENCE	METHOD	DATE/TIME/ANALYS
Bacteria, Coliform, Total, MPN	53.1	MPN/ 100 ml	<1.0	SM18 9223 B.	8/29/2006 / 0855 / AMD/BCD
Bacteria, E. coli, MPN	<1.0	MPN/ 100 ml	<1.0	SM18 9223 B.	8/29/2006 / 0855 / AMD/BCD
Nitrate	<1.0	mg/L	10	601	8/28/2006 / 1530 / GN
Turbidity	2.35	NTU	<10	SM18 2130B	8/28/2006 / 1525 / GN
Sand	NS	mg/L	5	Visual/Gravimetric	8/28/2006 / 1520 / GN

**NOTES**

- \*\*Sample collected prior to treatment
- mg/L = milligrams per liter (also, parts per million)
- MPN/ 100 ml = Most Probable Number [of viable bacteria] per 100 ml of sample.
- NS = None Seen (NS indicates less than 5 mg/L)
- NTU = Nephelometric Turbidity Units
- Results less than or within the reference range are considered satisfactory and within potable water limits at the time of sampling.
- ND:None Detected
- Visual well check: Sealed, vented cap
- pH tested on-site

Reason for Test : Use &amp; Occupancy

Building Permit # : B00157814

Date Reported: 8/29/2006