

C1 0251 SEQUENCE NO. (MDE USE ONLY)

STATE OF MARYLAND  
WELL COMPLETION REPORT  
FILL IN THIS FORM COMPLETELY  
PLEASE TYPE

THIS REPORT MUST BE SUBMITTED WITHIN  
45 DAYS AFTER WELL IS COMPLETED  
COUNTY NUMBER 13  
PERMIT NO. FROM "PERMIT TO DRILL WELL"  
10-94-2931

ST/CO USE ONLY  
DATE RECEIVED  
MM DD YY  
8 13

DATE WELL COMPLETED  
MM DD YY  
03 07 01

Depth of Well  
22 300 26  
(TO NEAREST FOOT)

PERMIT NO. FROM "PERMIT TO DRILL WELL"  
10-94-2931  
28 29 30 31 32 33 34 35 36 37

OWNER Dale Thompson Builders  
STREET OR RFD Preservation Court  
SUBDIVISION Pindell Woods SECTION LOT 5

WELL LOG  
Not required for driven wells  
STATE THE KIND OF FORMATIONS PENETRATED, THEIR COLOR, DEPTH, THICKNESS AND IF WATER BEARING  
DESCRIPTION (Use additional sheets if needed) FEET FROM TO check if water bearing

Top Soil	0	2	
Sandy	2	60	✓
Sand Stone	60	67	
MICKA	67	95	
Sand Stone	95	100	✓
MICKA	100	300	

GROUTING RECORD  
WELL HAS BEEN GROUTED (Circle Appropriate Box) YES  NO   
TYPE OF GROUTING MATERIAL (Circle one) CEMENT  BENTONITE CLAY   
CEMENT  BENTONITE CLAY   
NO. OF BAGS 12 NO. OF POUNDS 7200  
GALLONS OF WATER 72  
DEPTH OF GROUT SEAL (to nearest foot) from 0 ft. to 30+ ft.

CASING RECORD  
casing types insert appropriate code below  
MAIN CASING TYPE PL Nominal diameter top (main) casing (nearest inch)! 6 Total depth of main casing (nearest foot) 78

OTHER CASING (if used) diameter inch depth (feet) from to

SCREEN RECORD  
screen type or open hole insert appropriate code below  
STEEL  BRASS  OPEN HOLE   
BRONZE  PLASTIC  OTHER

NUMBER OF UNSUCCESSFUL WELLS: 0  
WELL HYDROFRACTURED YES  NO

CIRCLE APPROPRIATE LETTER  
A A WELL WAS ABANDONED AND SEALED WHEN THIS WELL WAS COMPLETED  
E ELECTRIC LOG OBTAINED  
P TEST WELL CONVERTED TO PRODUCTION WELL  
I HEREBY CERTIFY THAT THIS WELL HAS BEEN CONSTRUCTED IN ACCORDANCE WITH COMAR 26.04.04 "WELL CONSTRUCTION" AND IN CONFORMANCE WITH ALL CONDITIONS STATED IN THE ABOVE CAPTIONED PERMIT, AND THAT THE INFORMATION PRESENTED HEREIN IS ACCURATE AND COMPLETE TO THE BEST OF MY KNOWLEDGE.

DEPTH (nearest ft.)  
SLOT SIZE 1 2 3  
DIAMETER OF SCREEN (NEAREST INCH) 56 60  
from to

DRILLERS LIC. NO. M SD  
DRILLERS SIGNATURE  
LIC. NO. M D

GRAVEL PACK IF WELL DRILLED WAS FLOWING WELL INSERT F IN BOX 68  
MDE USE ONLY (NOT TO BE FILLED IN BY DRILLER)  
T (E.R.O.S.) W Q  
70 72 74 75 76

PUMPING TEST  
HOURS PUMPED (nearest hour) 3  
PUMPING RATE (gal. per min.) 6  
METHOD USED TO MEASURE PUMPING RATE Bucket  
WATER LEVEL (distance from land surface) BEFORE PUMPING 45 ft. WHEN PUMPING 90 ft.  
TYPE OF PUMP USED (for test) A air P piston T turbine C centrifugal R rotary O other J jet S submersible

PUMP INSTALLED  
DRILLER INSTALLED PUMP (CIRCLE) (YES OR NO) YES NO  
IF DRILLER INSTALLS PUMP, THIS SECTION MUST BE COMPLETED FOR ALL WELLS.  
TYPE OF PUMP INSTALLED PLACE (A,C,J,P,R,S,T,O) IN BOX 29  
CAPACITY: GALLONS PER MINUTE (to nearest gallon) 31 35  
PUMP HORSE POWER 37 41  
PUMP COLUMN LENGTH (nearest ft.) 43 47  
CASING HEIGHT (circle appropriate box and enter casing height) + above } LAND SURFACE - below } 2 (nearest foot)

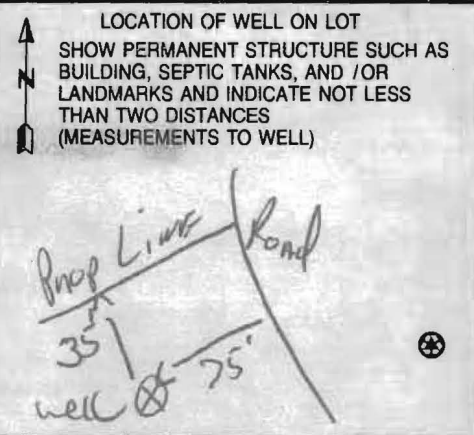

B 1 18673

SEQUENCE NO. (MDE USE ONLY)

STATE OF MARYLAND PERMIT TO DRILL WELL

STATE PERMIT NUMBER

10-94-2931

W514687 please print or type

fill in this form completely

Date Received (APA)

12/13/00

OWNER INFORMATION

Thompson Dale Builders
630 Woodside Court
Columbia, MD 21045

LOCATION OF WELL

Howard County
Pindellwoods
Fulton
3 MI

DRILLER INFORMATION

Ralph Mayne
Ralph Mayne Well Drilling
17024 Hardy Rd, Mt Airy MD 21771

DIRECTION OF WELL FROM TOWN

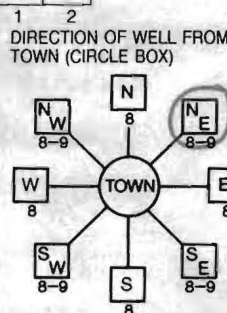

RESERVATION

Reservation
Near What Road
ON WHICH SIDE OF ROAD
DISTANCE FROM ROAD
TAX MAP: BLK: PARCEL

WELL INFORMATION

APPROX. PUMPING RATE 5 GAL. PER MIN.
AVERAGE DAILY QUANTITY NEEDED 500 GAL. PER DAY

USE FOR WATER (CIRCLE APPROPRIATE BOX)

- DOMESTIC POTABLE SUPPLY & RESIDENTIAL IRRIGATION
FARMING (LIVESTOCK WATERING & AGRICULTURAL IRRIGATION)
INDUSTRIAL, COMMERCIAL, DEWATERING
PUBLIC WATER SUPPLY WELL
TEST, OBSERVATION, MONITORING
GEO-THERMAL

NOT TO BE FILLED IN BY DRILLER HEALTH DEPARTMENT APPROVAL

Howard County
STATE SIGNATURE
DATE ISSUED
CO SIGNATURE
NORTH GRID 488 000
EAST GRID 0823 000

APPROXIMATE DEPTH OF WELL 130 FEET

APPROXIMATE DIAMETER OF WELL 6" NEAREST INCH

METHOD OF DRILLING (circle one)

- BORED (or Augered)
JETTED
Jetted & DRIVEN
AIR-ROTary
AIR-PERCussion
ROTARY (Hydraulic Rotary)
CABLE
REVERSE-ROTary
DRIVE-POINT
other

REPLACEMENT OR DEEPEMED WELLS (CIRCLE APPROPRIATE BOX)

- THIS WELL WILL NOT REPLACE AN EXISTING WELL
THIS WELL WILL REPLACE A WELL THAT WILL BE ABANDONED AND SEALED
THIS WELL WILL REPLACE A WELL THAT WILL BE USED AS A STANDBY-CONTACT LOCAL APPROVING AUTHORITY FOR POLICY ON STANDBY WELLS
THIS WELL WILL DEEPEM AN EXISTING WELL

Not to be filled in by driller (MDE OR COUNTY USE ONLY)

APPROP. PERMIT NUMBER
PERMIT No.

SHOW MAJOR FEATURES OF BOX & LOCATE WELL WITH AN X
SOURCES OF DRILLING WATER
WRITE THE BOX NUMBER FROM THE MAP HERE
Arrived at 10:10 am
Observed end of grout 78' of casing
30' open
12 bags Portland II Cement
300' deep

DRAW A SKETCH BELOW SHOWING LOCATION OF WELL IN RELATION TO NEARBY TOWNS AND ROADS AND GIVE DISTANCE FROM WELL TO NEAREST ROAD JUNCTION

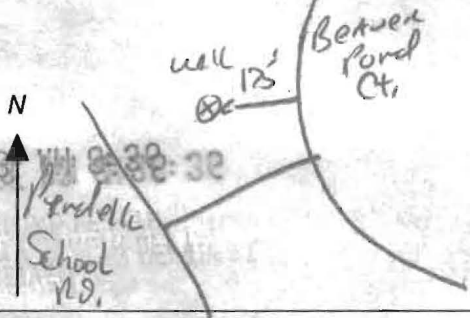

SPECIAL CONDITIONS

NOTE - APPROVING AUTHORITIES SHOULD USE SEPARATE SHEET IF NEEDED

FIELD DATA SHEET  
HOWARD COUNTY WELL YIELD TEST

Well Permit No. HO - 94-2931  
 Location of property (road) Preservation Court  
 Subdivision Pindell Woods Lot 5 Block \_\_\_\_\_ Plat \_\_\_\_\_ Sec. \_\_\_\_\_  
 Well Driller R. Mayne Owner Dale Thompson Builders

Depth of well 300  
 Distance of measuring point (M.P.) above ground 2<sup>nd</sup>  
 Static water level (S.W.L.) below M.P. 45

I. High rate pumping -- reservoir drawdown

Time pump started 8:30 Pump set 280 Pumping rate 10 GPM  
 Total time 15 min to reach pumping water level 90 ft. below M.P.

II. Recovery pump test data - observations to be recorded every 15 minutes

TIME (in 15 minute intervals)	WATER LEVEL below M.P.	PUMPING RATE time to fill <u>5</u> gallon bucket	FLOW METER READING (if used)	CALCULATED FLOW (gallons per minute)	
8:45	90 ft	10 Sec	<del>_____</del>	6 GPM	
9:00	90 ft	10 Sec		6 GPM	
9:15	90 ft	10 Sec		6 GPM	
9:30	90 "	10 "		6 "	
9:45	90 "	10 "		6 "	
10:00	90 "	10 "		6 "	
10:15	90 ft	10 Sec		6 GPM	
10:30	90 ft	10 Sec		6 GPM	
10:45	90 "	10 Sec		6 GPM	
11:00	90 "	10 "		6 "	
11:15	90 "	10 "		6 "	
11:30	90 ft	10 ft		6 ft	
11:45	90 ft	10 ft		6 ft	

HD-224 78 ft CITS in  
30' open 12 BAYS



**HOWARD COUNTY HEALTH DEPARTMENT  
BUREAU OF ENVIRONMENTAL HEALTH  
WATER AND SEWERAGE PROGRAM  
TEL: (410)313-2640 FAX: (410)313-2648**

**Information Form for the Installation of the Well Pump, Pitless Adapter, and Supply Piping**

**NOTE:** The installer is responsible for requesting an inspection prior to 9 am on the day of the desired inspection. No work is to be covered until approved by the Health Department. All installations must comply with the National Standard Plumbing Code (NSPC, as amended locally) and COMAR 26.04.04 (MD Well Construction Regulations). Submission of a complete form is required prior to Use and Occupancy approval.

Company Name: WILLOUGHBY PLUMB Telephone #: 410-781-7051  
Address: 1203 PATRICK DR  
SUKESVILLE, MD 21784

(Must circle one) Licensed Plumber Licensed Well Driller Licensed Well Pump Installer  
License # and name of individual responsible for the field installation:  
Name (Print): CHRIS WILLOUGHBY License# 6992

\*A licensed individual must perform the actual installation. Apprentices must be under the direct supervision of a licensed journeyman or master plumber, pump installer or well driller. Licenses may be subjected to field verification.

Name of Property Owner: DALE THOMPSON BLDG Telephone #: 410-995-1073  
Subdivision: FINDELL WOODS Lot #: 5 Well Tag #: HO-94-2931  
Site Address: 1209 PRESERVATION CT  
FULTON, MD 20759

**Submersible Pump Data** Pitless Adapter **Well Cap and Electric Conduit**  
Make: ITALIZZI Make: HARVARD Two piece watertight cap:   
Model #: \_\_\_\_\_ Model #: \_\_\_\_\_ Screened, vented well cap:   
Pump Capacity \_\_\_\_\_ GPM Depth: 42" (36" min) Cap secured to casing:   
Well Yield: 6 GPM NSF approved: \_\_\_\_\_ Conduit min 1 1/2" B.G.:   
Depth of well encountered at time of pump installation: 300 (feet) Conduit secured to well cap:   
If pump capacity exceeds well yield, a low water cut off switch is required by NSPC 1990 Section 17.8.4  
Torque arrestors or Cable guards are required - Must circle one  
Safety rope, if used, attached to inside of well casing with eye bolt \_\_\_\_\_

*State #5*

**Piping to house** **House Connection**  
Type: CRESTLINE PVC sleeved to undisturbed soil at wall penetration:   
PSI: 1/2" (160 psi min) Approximate length of sleeve: 6'  
Depth of supply line: 36" min Sleeve caulked and sealed properly:

The water supply line is required to be at least ten feet from the septic tank, pump chamber, sewage piping, distribution box, drainfields, and sewage reserve area. If this cannot be accomplished, contact this office for approval prior to installation.

Signature of company representative responsible for installation: Chris Willoughby date: 7/21/06

**For Health Department Use Only - Not to be completed by Installer**

Date Insp. Requested: \_\_\_\_\_ Date Insp. Approved: 7/25/06 BB  
Inspection Data: Pitless adapter and water supply line at least 36" below grade   
Two piece cap installed and attached to casing securely   
Elec. conduit extends at least 18" below grade/attached to cap properly   
Safety rope installed inside of well casing   
Correct well tag attached properly and casing 8" above finished grade   
Water supply line sleeved adequately at house connection   
Adequate grout observed below pitless adapter



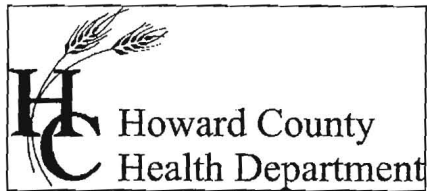

Bureau of Environmental Health  
7178 Columbia Gateway Drive Columbia, Maryland 21046-2132  
(410) 313-2640 Fax (410) 313-2648  
TDD (410) 313-2323 Toll Free 1-866-313-6300  
website: www.hchealth.org

Penny E. Borenstein, M.D., M.P.H., Health Officer

July 26, 2006

Dale Thompson Builders  
6300 Woodside Court  
Columbia, MD 21046

**SENT VIA FACSIMILE 410-381-8747**

RE: 7209 Preservation Court  
Pindell Woods, Lot 5  
Fulton, MD 20759  
BP #: B00156588  
Well Permit # HO-94-2931

Dear Sir:

This is to advise you that the septic system for the above referenced property has been installed and inspected. **Final approval of the septic system was granted on 7/25/2006. Final approval of the well line connection to the dwelling was approved on 7/25/2006.**

The water sample results indicate that the water samples submitted for testing were free of coliform and fecal coliform bacteria at the time of sampling and are bacteriologically safe for drinking. The water sample results were found to be in compliance with COMAR water quality standards.

**INTERIM CERTIFICATE OF POTABILITY**

This certifies that the initial sampling requirements of COMAR 26.04.04 "Well Regulations" have been met for the water supply system installed under well permit #HO-94-2931. Although the submitted sample results are in compliance with COMAR standards, the Health Department does not guarantee water supplies. Based upon satisfactory investigation and evaluation, the Howard County Health Department as authorized by the Maryland Department of the Environment accepts this well system as required by COMAR 26.04.04.

This certificate may become final upon completion of the second bacteriological test, which is to be taken by the county health department within six months of receipt of this letter. **Please contact (410) 313-1773 to schedule a final water sample appointment. Currently, there is no charge for this final sampling.**

Date of Water Samples: 7/21/2006  
Date of Well Completion: 3/07/2001

Approving Authority

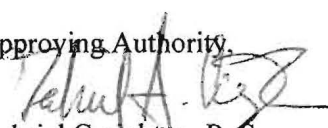
  
Gabriel Creighton, R. S.  
Well & Septic Program

cc: Building Inspector's Office  
Community Health Services  
File

## CERTIFICATE OF ANALYSIS



TRACE LABORATORIES  
5 North Park Drive  
Hunt Valley, MD 21030  
Telephone: 410/252-7742  
Telephone: 410/584-9099  
Fax: 410/584-9117  
Email:  
tracelab@connext.net  
www.tracelabs.com

Maryland State Certified  
Water Quality Laboratory  
No. 318

**Requester:**  
Dale Thompson Builders  
6300 Woodside Court  
Columbia, Maryland 21046

**S/O Number:** 07-1265  
**Report Date:** July 24, 2006

**Property Sampled:** 7209 Preservation Court

**County:** Howard  
**Subdivision:** Pindell Woods  
**Lot #:** 5  
**Building Permit #:** B00156588

**Tax Map #:** 41  
**Parcel #:** 274

**Date/Time Collected:** July 21, 2006 at 11:40 am  
**Date/Time Received:** July 21, 2006 at 1:50 pm

**Sample Location:** Laundry Tub Tap & Pressure Tank Tap  
**Sampler ID:** 6724GP  
**Samples Iced:** Yes  
**Residual Cl<sub>2</sub> <0.1 mg/L:** Yes

**Well Tag Number:** HO-94-2931  
**Well Condition:** 2-Piece Cap  
Satisfactory

**Water Conditioning/Treatment:** Sediment Filter

PARAMETER	RESULT	METHOD	MCL/*SMCL	
Nitrate	<1.0 mg/L as N	SM 4500D	10 mg/L as N	Pass
Turbidity(Raw)	1.2 NTU	EPA 180.1	10 NTU	Pass
Turbidity(Treated)	<1.0 NTU	EPA 180.1	10 NTU	Pass
pH	6.4 Units	EPA 150.1	*6.5-8.5 Units	***
Sand	Negative		Negative	
Total Coliform	Absent	SM 9223B	Absent	Pass
E.coli	Absent	SM 9223B	Absent	Pass

  
 Heather R. Beam  
 Manager-Drinking Water Testing

MCL=Maximum Contamination Level

\*SMCL=Secondary Maximum Contamination Level

\*\*\*A non-enforceable parameter that may cause cosmetic effects or aesthetic effects (such as taste, color or odor) in drinking water.