

2/25/89 10:30

Files

PERMIT 05-341442 P 44779

SEWAGE DISPOSAL SYSTEM

A REPAIR

MARYLAND STATE DEPARTMENT OF HEALTH DISTRICT 5th

HOWARD COUNTY
BUREAU OF ENVIRONMENTAL HEALTH
461-9933

DATE 7/21/89

DATE SYSTEM APPROVED 7/25/89

INDEXED

INSPECTOR C.B.S.

R.M. 7/21 C.B.S.

(M. Zepp at site)

Zepp Plumbing and Heating IS PERMITTED TO INSTALL ALTER

ADDRESS 6344 Ten Oaks Road, Clarksville, MD 21029 PHONE 531-6712

SUBDIVISION ROAD 6935 Pindell School Rd. 607

PROPERTY OWNER Mr. Dress

ADDRESS 6935 Pindell School Road, Fulton, MD 20759

IF GARBAGE GRINDER IS USED INCREASE SEPTIC TANK CAPACITY BY 50% AND ABSORPTION AREA BY 22%.

GARBAGE GRINDER? YES NO

SEPTIC TANK CAPACITY _____ GALLONS NUMBER OF BEDROOMS _____ [Due to swales + tops] REPAIR - Call for an inspection when ground is opened up so Sanitarian can

recommend the repair system. (1) 15' x 15' ± Dry Well - 20' off old one; (2) 3' Man. depth 10' + (3) new cleanouts; 1 for existing septic tank, 1 for existing dry well + 1 for new dry well. Note: Payment is in mail for repair.

PLANS APPROVED BY Craig Williams DATE 7/21/89 C.B.S.

COVER NO WORK UNTIL INSPECTED AND APPROVED

NEITHER THE HOWARD COUNTY COUNCIL NOR THE HEALTH DEPARTMENT IS RESPONSIBLE FOR THE SUCCESSFUL OPERATION OF ANY SYSTEM.

NOTE: CLEANOUT REQUIRED EVERY 70 FEET OF SEWER LINE AND/OR AT 90° SWEEPS IN LINES FROM HOUSE TO DRAIN FIELDS

NOTE: ALL PARTS OF SEPTIC SYSTEMS (I.E. TANK, DISTRIBUTION BOX, TRENCHES) TO BE 100 FEET FROM WELL (UNLESS OTHERWISE SPECIFICALLY AUTHORIZED)

NOTE: IF DEEP TRENCHES ARE USED CALL FOR INSPECTION BEFORE AND AFTER PLACING GRAVEL IN TRENCHES

NOTE: NO DRY WELL SHALL EXCEED 15 FOOT IN DIAMETER NO ABSORPTION TRENCH TO EXCEED 100 FEET IN LENGTH

NOTE: ALL PIPE FROM HOUSE TO SEPTIC TANK MUST BE CAST IRON OR SCHEDULE 40 PVC OR ABS

PERMIT VOID AFTER TWO YEARS

NOTE: INSTALL STAND PIPE ON SEPTIC TANK AND DRY WELL STAND PIPES MUST BE 6 INCHES IN DIAMETER. CAST IRON, CONCRETE OR TERRA COTTA OR PVC OR ABS ACCEPTED. IF TOP OF SEPTIC TANK IS DEEPER THAN 3 FEET, MANHOLE TO GRADE REQUIRED

NOTE: DISTRIBUTION BOXES MUST HAVE BAFFLES

*INSTALLER IS RESPONSIBLE FOR OBTAINING FINAL APPROVAL ON THIS PERMIT

*CALL 461-9933 FOR INSPECTION OF SEPTIC SYSTEMS.

44779

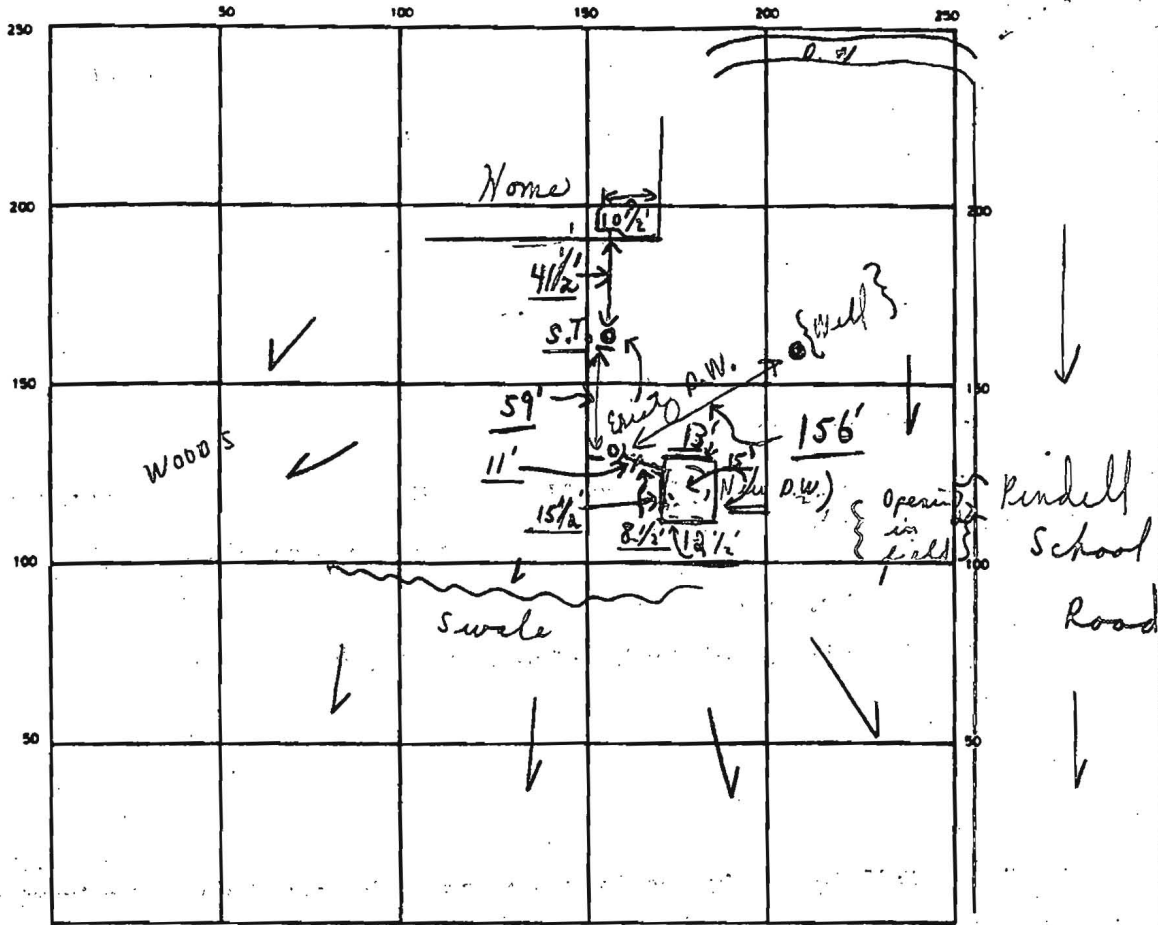

INDICATE NORTH — NAME ADJOINING ROADWAY AS BASE LINE.

SEPTIC TANK LEVEL N/A CLEANOUTS

S.T.	{ ^{#1} D.W.}	{ ^{New #2} D.W.}
OK	OK	OK

DISTRIBUTION BOX LEVEL N/A

DEPTH 10 1/2 FT. TRENCH WIDTH — FT. INLET DEPTH 3 1/2 FT.

EFFECTIVE GRAVEL DEPTH — FT. TOTAL LENGTH — FT.

NUMBER OF TRENCHES — ONE SIDEWALL/BOX AREA — SQ. FT.

DRYWELL

OUTSIDE PERIMETER } = 56 ⁺ FT	EFFECTIVE DEPTH BELOW INLET <u>7⁺</u> FT.
INSIDE PERIMETER } = 39 ⁺ FT	

ABSORBENT AREA 392⁺ SQ. FT.

REMARKS A.M. 7/21/89 DRY WELL HOLE EXCAVATED FOR NEW DRYWELL
-PARTIAL, C.B.D.; 7/25/89 REPAIR - COMPLETE OK TO COVER
FINAL.

DATE SYSTEM APPROVED 7/25/89 INSPECTOR Charles Bryan Stecker