

PUB. SEWER STATUS VERIFIED BY _____

ISSUE DATE: 5/26/06

P 524488

APPROVAL DATE: 5/31/06

A REPAIR A524050

PERMIT INDEXED

Tax ID # 05-341442

ON-SITE SEWAGE DISPOSAL SYSTEM HOWARD COUNTY HEALTH DEPARTMENT BUREAU OF ENVIRONMENTAL HEALTH

The Plumber, J.E.V. Inc. IS PERMITTED TO INSTALL ALTER

ADDRESS: 12400 Frederick Road, West Friendship PHONE NUMBER: 440-489-0987

SUBDIVISION: _____ LOT NUMBER: _____

ADDRESS: 6935 Pindell School Road PROPERTY OWNER: Andre Dress

SEPTIC TANK CAPACITY (GALLONS): _____

PUMP CHAMBER CAPACITY (GALLONS): _____

NUMBER OF BEDROOMS: _____

SQUARE FEET PER BEDROOM: _____

LINEAR FEET OF TRENCH REQUIRED: _____

TRENCHES:	Trench to be _____ feet wide. Inlet _____ feet below original grade. Bottom maximum depth _____ feet below original grade. Effective area begins at _____ feet below original grade. _____ feet of stone below distribution pipe.
LOCATION:	_____
PURPOSE:	To tie in the addition to the existing septic system.

PLANS APPROVED: _____ DATE: _____

- NOTE: PERMIT VOID AFTER 2 YEARS
- NOTE: CONTRACTOR RESPONSIBLE FOR SCHEDULING A PRE-CONSTRUCTION INSPECTION FOR ALL INSTALLATIONS
- NOTE: WATERTIGHT SEPTIC TANKS REQUIRED
- NOTE: ALL PARTS OF SEPTIC SYSTEM SHALL BE 100 FEET FROM ANY WATER WELL
- NOTE: MANHOLE RISERS REQUIRED ON ALL SEPTIC TANKS AND PUMP CHAMBERS

**NEITHER THE HOWARD COUNTY COUNCIL OR THE HEALTH DEPARTMENT IS
RESPONSIBLE FOR THE SUCCESSFUL OPERATION OF ANY SYSTEM
PERMITTEE RESPONSIBLE FOR OBTAINING FINAL APPROVAL ON THIS PERMIT
CALL 410-313-2640 FOR INSPECTION OF SEPTIC SYSTEM**

A524050

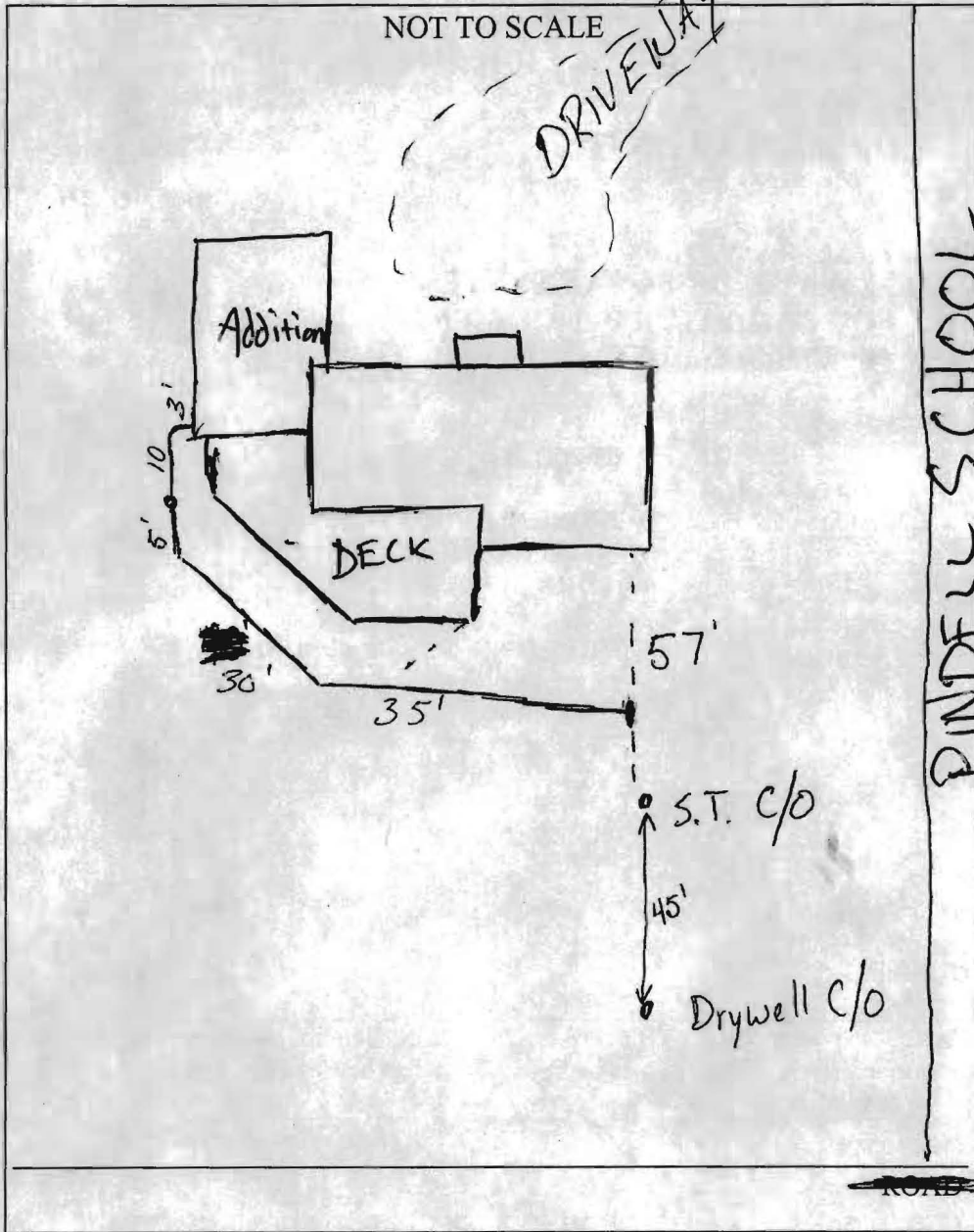

TRENCH/DRAINFIELD DATA		
WIDTH	INLET	BOTTOM
_____	_____	_____
NUMBER OF TRENCHES	_____	
TOTAL LENGTH	_____	
ABSORPTION AREA	_____	
DISTRIBUTION BOX LEVEL	_____	
DISTRIBUTION BOX BAFFLE	_____	
DISTRIBUTION BOX PORT	_____	

SEPTIC TANK DATA	
SEPTIC TANK 1 LEVEL _____	
CAPACITY	_____ GAL
SEAM LOC	_____
TANK LID DEPTH	_____
BAFFLES	_____
BAFFLE FILTER	_____
MANHOLE LOC	_____
6" PORT LOC	_____
WATERTIGHT TEST	_____
SEPTIC TANK 2 LEVEL _____	
CAPACITY	_____ GAL
SEAM LOC	_____
TANK LID DEPTH	_____
BAFFLES	_____
BAFFLE FILTER	_____
MANHOLE LOC	_____
6" PORT LOC	_____
WATERTIGHT TEST	_____

PRE-CONSTRUCTION _____

INSTALLATION _____

FINAL INSPECTOR *Samuel A. King* DATE OF APPROVAL 5/31/06

LAYOUT _____ INSP 4 _____
INSP 2 _____ INSP 5 _____
INSP 3 _____ INSP 6 _____

ISSUE DATE: 2/7/06

P 524050

APPROVAL DATE: _____

A P44779

PERMIT

TAX ID #05-341442
ON-SITE SEWAGE DISPOSAL SYSTEM
HOWARD COUNTY HEALTH DEPARTMENT
BUREAU OF ENVIRONMENTAL HEALTH

Jack fyock Septic Service Inc. _____ IS PERMITTED TO INSTALL ALTER

ADDRESS: P. O. Box 89, Glenelg MD 21737 PHONE NUMBER: 410-988-9270

SUBDIVISION: _____ LOT NUMBER: _____

ADDRESS: 6935 Pindell School Road PROPERTY OWNER: Andre Dress

SEPTIC TANK CAPACITY (GALLONS): 1500 OUTLET BAFFLE FILTER REQUIRED

PUMP CHAMBER CAPACITY (GALLONS) n/a COMPARTMENTED TANK REQUIRED

NUMBER OF BEDROOMS: 5

SQUARE FEET PER BEDROOM: _____

LINEAR FEET OF TRENCH REQUIRED: _____ HOUSE SERVED BY PUBLIC WATER

TRENCHES:	
LOCATION:	
NOTES:	In support of building permit addition to add 1 bedroom. Old septic tank must be pumped and collapsed.

PLANS APPROVED: _____ DATE: _____

NOTES: PERMIT VOID AFTER 2 YEARS
CONTRACTOR IS RESPONSIBLE FOR SCHEDULING A PRE-CONSTRUCTION INSPECTION FOR ALL INSTALLATIONS
WATERTIGHT SEPTIC TANKS REQUIRED
ALL PARTS OF SEPTIC SYSTEM SHALL BE 100 FEET FROM ANY WATER WELL UNLESS SPECIFICALLY AUTHORIZED
MANHOLE RISERS REQUIRED ON ALL SEPTIC TANKS AND PUMP CHAMBERS UNLESS SPECIFICALLY AUTHORIZED
CONTRACTOR RESPONSIBLE FOR COMPLIANCE WITH APPLICABLE REGULATIONS, GUIDELINES AND THE TERMS OF THIS PERMIT

**NEITHER THE HOWARD COUNTY COUNCIL NOR THE HEALTH DEPARTMENT IS
RESPONSIBLE FOR THE SUCCESSFUL OPERATION OF ANY SYSTEM
PERMITTEE RESPONSIBLE FOR OBTAINING FINAL APPROVAL ON THIS PERMIT
ALL 410-313-1771 FOR INSPECTION OF SEPTIC SYSTEM**

SITE INSPECTION SHEET

OWNER: Andre Dress PHONE #: 410-531-7138

ADDRESS: 6935 PUNDEW SCHAER ROAD CONTRACTOR: FYOCK

WELL TAG #: _____

SUBDIVISION: _____ LOT: _____ COUNTY #: _____

PROPOSAL: Upgrade SS to support proposed building permit addition - adding one bedroom

LOCATION DIAGRAM

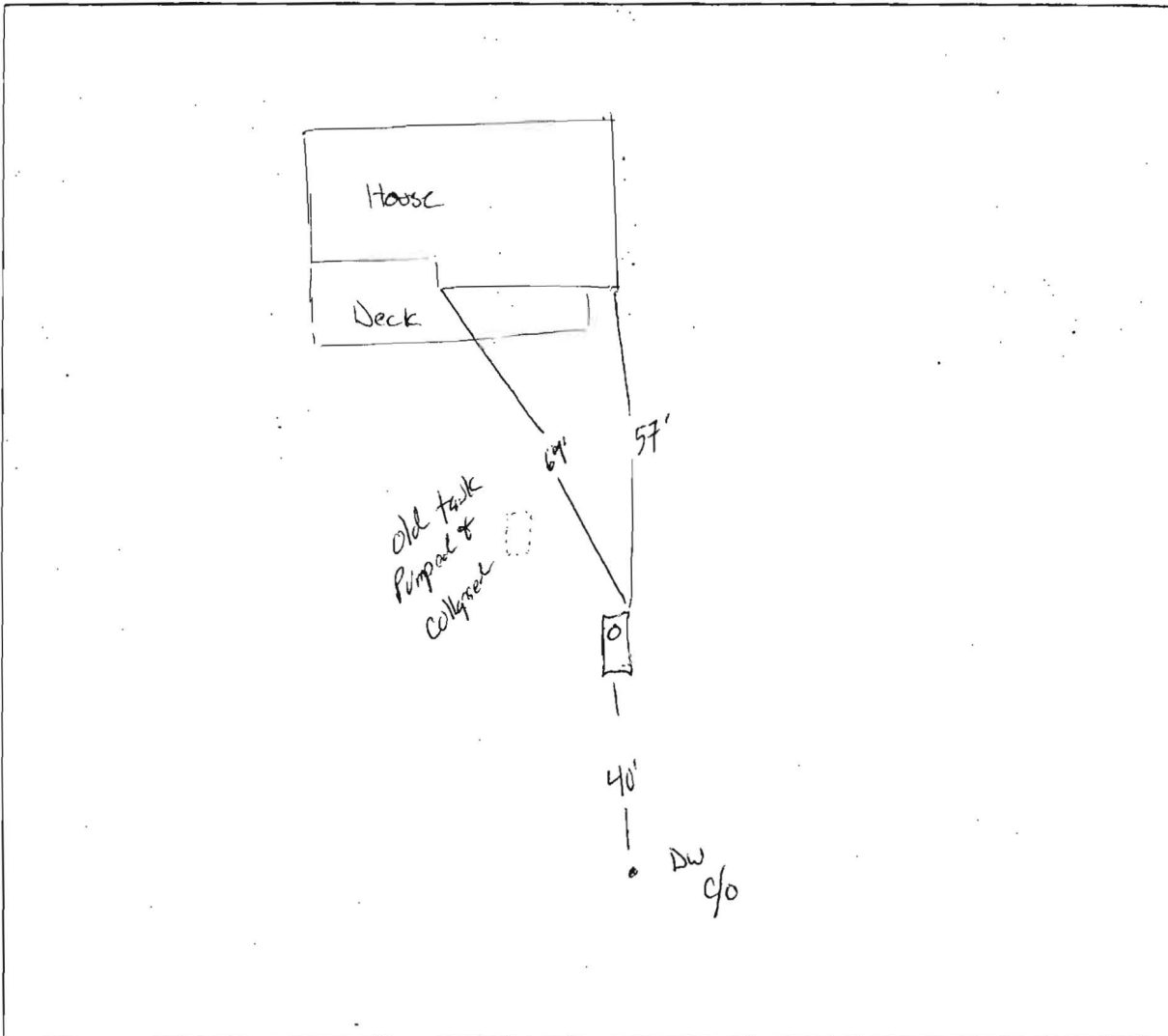

COMMENTS: now 1500 Babylon & comp. w/ 4 baffles

DATE: 2/10/06

INSPECTOR: GC