

PUB. SEWER STATUS VERIFIED BY _____

ISSUE DATE: 05/19/06

P 524473

APPROVAL DATE: 5/24/06

PERMIT
INDEXED

A REPAIR

**ON-SITE SEWAGE DISPOSAL SYSTEM
HOWARD COUNTY HEALTH DEPARTMENT
BUREAU OF ENVIRONMENTAL HEALTH**

Edward L. Linsenmeyer Sr IS PERMITTED TO INSTALL ALTER

ADDRESS: 9304 Migan Rd, Randallstown, MD 21133 PHONE NUMBER: 410-922-8172

SUBDIVISION: 1730 Route 32 LOT NUMBER: _____

ADDRESS: _____ PROPERTY OWNER: MICHAEL ALLEN

SEPTIC TANK CAPACITY (GALLONS): _____

PUMP CHAMBER CAPACITY (GALLONS): _____

NUMBER OF BEDROOMS: _____

SQUARE FEET PER BEDROOM: _____

LINEAR FEET OF TRENCH REQUIRED: _____

TRENCHES:	Trench to be _____ feet wide. Inlet _____ feet below original grade. Bottom maximum depth _____ feet below original grade. Effective area begins at _____ feet below original grade. _____ feet of stone below distribution pipe.
LOCATION:	_____
PURPOSE:	Existing septic system has failed. Call for inspection when ground is opened so sanitarian can recommend repair.

PLANS APPROVED: _____ DATE: _____

- NOTE: PERMIT VOID AFTER 2 YEARS
- NOTE: CONTRACTOR RESPONSIBLE FOR SCHEDULING A PRE-CONSTRUCTION INSPECTION FOR ALL INSTALLATIONS
- NOTE: WATERTIGHT SEPTIC TANKS REQUIRED
- NOTE: ALL PARTS OF SEPTIC SYSTEM SHALL BE 100 FEET FROM ANY WATER WELL
- NOTE: MANHOLE RISERS REQUIRED ON ALL SEPTIC TANKS AND PUMP CHAMBERS

NEITHER THE HOWARD COUNTY COUNCIL OR THE HEALTH DEPARTMENT IS RESPONSIBLE FOR THE SUCCESSFUL OPERATION OF ANY SYSTEM PERMITTEE RESPONSIBLE FOR OBTAINING FINAL APPROVAL ON THIS PERMIT CALL 410-313-2640 FOR INSPECTION OF SEPTIC SYSTEM

PS 24473

NOT TO SCALE

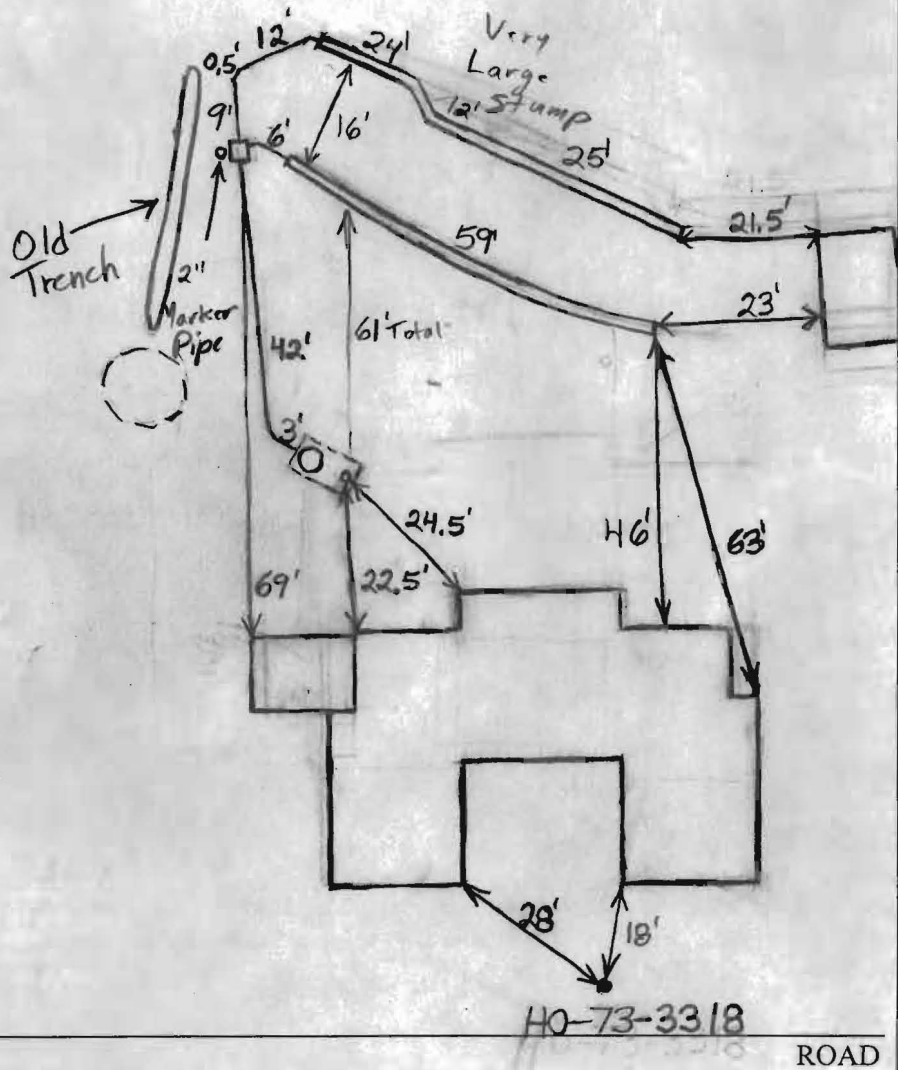

TRENCH/DRAINFIELD DATA		
WIDTH	INLET	BOTTOM
2'	5.5'	10'
NUMBER OF TRENCHES		2'
TOTAL LENGTH		120'
ABSORPTION AREA		540
DISTRIBUTION BOX LEVEL		Levelers
DISTRIBUTION BOX BAFFLE		Yes
DISTRIBUTION BOX PORT		Yes

SEPTIC TANK DATA	
SEPTIC TANK 1 LEVEL	
CAPACITY	Existing GAL
SEAM LOC	Midseam
TANK LID DEPTH	1.5'
BAFFLES	Yes
BAFFLE FILTER	None
MANHOLE LOC	Rear
6" PORT LOC	Front
WATERTIGHT TEST	No
SEPTIC TANK 2 LEVEL N/A	
CAPACITY	GAL
SEAM LOC	
TANK LID DEPTH	
BAFFLES	
BAFFLE FILTER	
MANHOLE LOC	
6" PORT LOC	
WATERTIGHT TEST	

PRE-CONSTRUCTION _____

INSTALLATION 5/24/06 System installed. Had to work around large stump with lower trench. Drywell pumped out and filled in BB

FINAL INSPECTOR B. Baker

DATE OF APPROVAL 5/24/06