



# Building Permit Application

Howard County Maryland  
 Department of Inspections, Licenses and Permits  
 3430 Court House Drive  
 Permits; 410-313-2455  
 www.howardcountymd.gov

Date Received: 1/13/15

Permit No.: B15000124

Building Address: 2883 Evergreen Ct  
 City: Ellicott City State: MD Zip Code: 21012  
 Suite/Apt. # \_\_\_\_\_ SDP/WP/BA #: \_\_\_\_\_  
 Census Tract: \_\_\_\_\_ Subdivision: Ellicott City  
 Section: \_\_\_\_\_ Area: \_\_\_\_\_ Lot: 2  
 Tax Map: 116 Parcel: 317 Grid: 19  
 Zoning: \_\_\_\_\_ Map Coordinates: \_\_\_\_\_ Lot Size: 11.00 @

Existing Use: SFD  
 Proposed Use: SFD w/ Pooling Tank  
 Estimated Construction Cost: \$ 8000  
 Description of Work: \_\_\_\_\_  
Install 100 gallon in-ground pooling tank

Occupant or Tenant: \_\_\_\_\_  
 Was tenant space previously occupied?  Yes  No  
 Contact Name: \_\_\_\_\_  
 Address: owner  
 City: \_\_\_\_\_ State: \_\_\_\_\_ Zip Code: \_\_\_\_\_  
 Phone: \_\_\_\_\_ Fax: \_\_\_\_\_  
 Email: \_\_\_\_\_

Property Owner's Name: Edward Grogan  
 Address: 2883 Evergreen Ct  
 City: Ellicott City State: MD Zip Code: 21012  
 Phone: \_\_\_\_\_ Fax: \_\_\_\_\_  
 Email: \_\_\_\_\_

**Applicant's Name & Mailing Address, (if other than stated herein)**  
 Applicant's Name: Jeremy Clancy  
 Address: PO Box 1253  
 City: Ellicott City State: MD Zip Code: 21012  
 Phone: 410-313-1229 Fax: \_\_\_\_\_  
 Email: Jeremy.Clancy@appliedandapproved.com

Contractor Company: Doist Grogan  
 Contact Person: Michael Underwood  
 Address: 360 Main St  
 City: Laurel State: MD Zip Code: 20707  
 License No.: 60029  
 Phone: 301-725-3272 Fax: \_\_\_\_\_  
 Email: \_\_\_\_\_

Engineer/Architect Company: \_\_\_\_\_  
 Responsible Design Prof.: \_\_\_\_\_  
 Address: Contractor  
 City: \_\_\_\_\_ State: \_\_\_\_\_ Zip Code: \_\_\_\_\_  
 Phone: \_\_\_\_\_ Fax: \_\_\_\_\_  
 Email: \_\_\_\_\_

Commercial Building Characteristics	Residential Building Characteristics	
Height:	<input type="checkbox"/> SF Dwelling <input type="checkbox"/> SF Townhouse	
No. of stories:	<b>Depth</b>	<b>Width</b>
Gross area, sq. ft./floor:	1 <sup>st</sup> floor:	
	2 <sup>nd</sup> floor:	
Area of construction (sq. ft.):	Basement:	
	<input type="checkbox"/> Finished Basement	
Use group:	<input type="checkbox"/> Unfinished Basement	
	<input type="checkbox"/> Crawl Space	
<b>Construction type:</b>	<input type="checkbox"/> Slab on Grade	
<input type="checkbox"/> Reinforced Concrete	No. of Bedrooms:	
<input type="checkbox"/> Structural Steel	<b>Multi-family Dwelling</b>	
<input type="checkbox"/> Masonry	No. of efficiency units:	
<input type="checkbox"/> Wood Frame	No. of 1 BR units:	
<input type="checkbox"/> State Certified Modular	No. of 2 BR units:	
	No. of 3 BR units:	
	Other Structure:	
	Dimensions:	
<input checked="" type="checkbox"/> <b>Roadside Tree Project Permit</b>	Footings:	
<input type="checkbox"/> Yes <input type="checkbox"/> No	Roof:	
<b>Roadside Tree Project Permit #</b>	<input type="checkbox"/> State Certified Modular	
	<input type="checkbox"/> Manufactured Home	

Utilities	
<b>Water Supply</b>	
<input type="checkbox"/> Public	
<input checked="" type="checkbox"/> Private	
<b>Sewage Disposal</b>	
<input type="checkbox"/> Public	
<input checked="" type="checkbox"/> Private	
Electric:	<input type="checkbox"/> Yes <input type="checkbox"/> No
Gas:	<input checked="" type="checkbox"/> Yes <input type="checkbox"/> No
<b>Heating System</b>	
<input type="checkbox"/> Electric <input type="checkbox"/> Oil	
<input type="checkbox"/> Natural Gas <input type="checkbox"/> Propane Gas	
<input type="checkbox"/> Other:	
<b>Sprinkler System:</b>	
<input type="checkbox"/> Yes <input type="checkbox"/> No	
Grading Permit Number:	
Building Shell Permit Number:	

THE UNDERSIGNED HEREBY CERTIFIES AND AGREES AS FOLLOWS: (1) THAT HE/SHE IS AUTHORIZED TO MAKE THIS APPLICATION; (2) THAT THE INFORMATION IS CORRECT; (3) THAT HE/SHE WILL COMPLY WITH ALL REGULATIONS OF HOWARD COUNTY WHICH ARE APPLICABLE THERETO; (4) THAT HE/SHE WILL PERFORM NO WORK ON THE ABOVE REFERENCED PROPERTY NOT SPECIFICALLY DESCRIBED IN THIS APPLICATION; (5) THAT HE/SHE GRANTS COUNTY OFFICIALS THE RIGHT TO ENTER ONTO THIS PROPERTY FOR THE PURPOSE OF INSPECTING THE WORK PERMITTED AND POSTING NOTICES.

Applicant's Signature: \_\_\_\_\_  
 Email Address: Jeremy.Clancy@appliedandapproved.com  
 Title/Company: Permits

Print Name: Jeremy Clancy  
 Date: 1/12/15

Checks Payable to: DIRECTOR OF FINANCE OF HOWARD COUNTY

**\*\*PLEASE WRITE NEATLY & LEGIBLY\*\***  
**-FOR OFFICE USE ONLY-**

AGENCY	DATE	SIGNATURE OF APPROVAL
State Highways		
Building Officials		
PSZA ( Zoning )		
PSZA ( Engineering )		
Health	<u>1/27/15</u>	<u>H. Oswald</u>

Is Sediment Control approval required for issuance?  Yes  No  
 CONTINGENCY CONSTRUCTION START

DPZ SETBACK INFORMATION	
Front:	
Rear:	
Side:	
Side St.:	
All minimum setbacks met?	<input type="checkbox"/> Yes <input type="checkbox"/> No
Is Entrance Permit Required?	<input type="checkbox"/> Yes <input type="checkbox"/> No
Historic District?	<input type="checkbox"/> Yes <input type="checkbox"/> No
Lot Coverage for New Town Zone:	
SDP/Red-line approval date:	

Filing Fee	\$
Permit Fee	\$ <u>100.00</u>
Tech Fee	\$ <u>10.00</u>
Excise Tax	\$
PSFS	\$
Guaranty Fund	\$
Add'l per Fee	\$
Total Fees	\$ <u>110.00</u>
Sub-Total Paid	\$
Balance Due	\$
Check	# <u>42460</u>

Distribution of Copies: White: Building Officials Green: PSZA,Zoning Yellow: PSZA,Engineering Pink: Health Gold: SHA

155870045

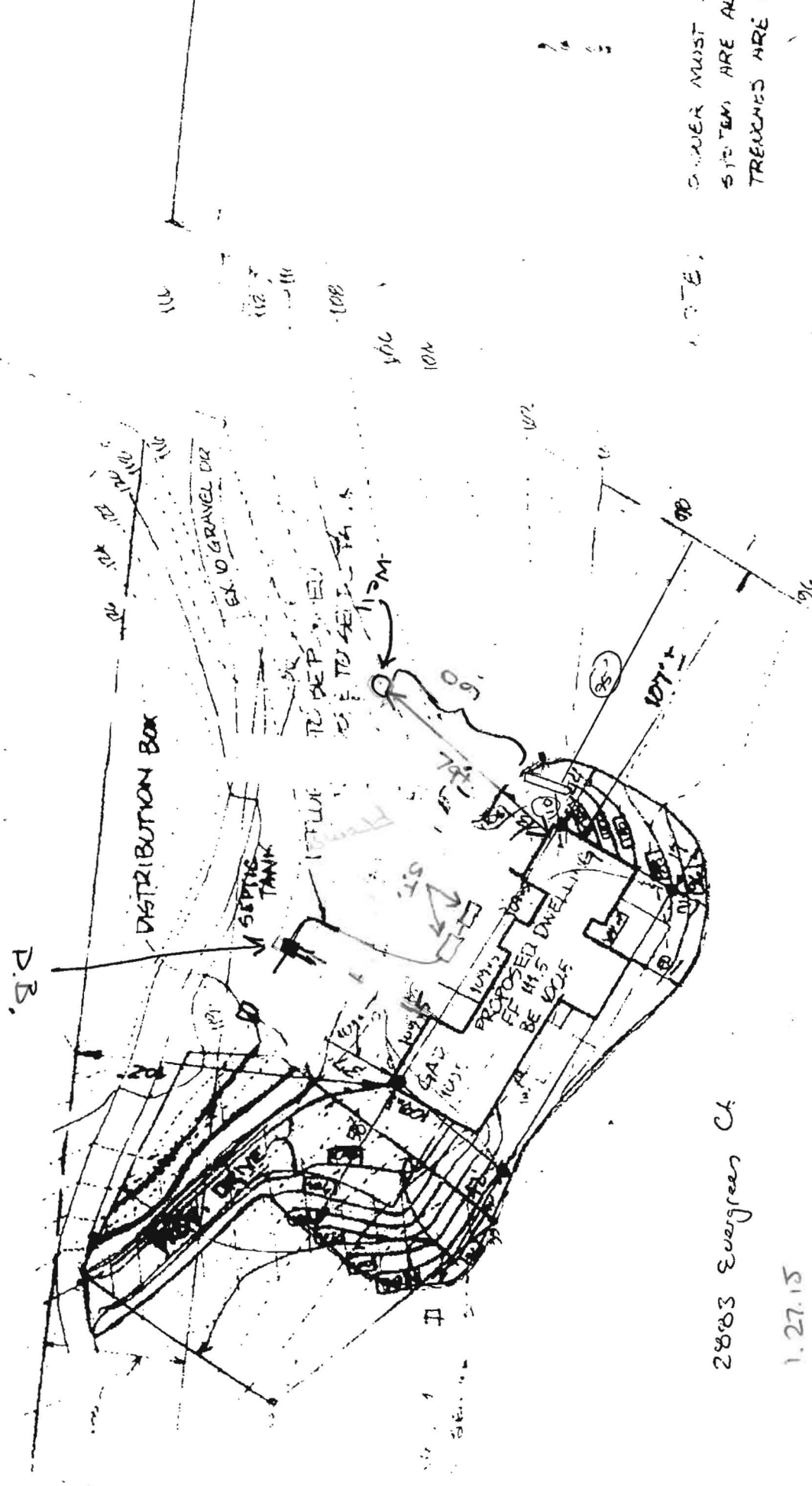

OWNER MUST  
SYSTEM ARE AL  
TRENCHES ARE

NOTE:

1"=50'

1"=50' Grogan Residence  
5/9/89  
475

2803 Evergreen Ct

1.27.15

Site plan approved  
as shown for B15000124  
(in-ground propane tank)  
-H.O.

P.B.