



Building Permit Application

Howard County Maryland
Department of Inspections, Licenses and Permits
3430 Court House Drive
Permits: 410-313-2455
www.howardcountymd.gov

Date Received: _____

Permit No.: _____

Building Address: 5255 Ilex Way
 City: Dayton State: MD Zip Code: 21036
 Suite/Apt. #: _____ SDP/WP/BA #: _____
 Census Tract: _____ Subdivision: _____
 Section: _____ Area: _____ Lot: _____
 Tax Map: _____ Parcel: _____ Grid: _____
 Zoning: _____ Map Coordinates: _____ Lot Size: _____

Existing Use: Res
 Proposed Use: Res
 Estimated Construction Cost: \$ 30,000⁰⁰
 Description of Work: Construct open deck to rear of home approx 73' x 12' w/ steps to grade
 Occupant or Tenant: _____
 Was tenant space previously occupied? Yes No
 Contact Name: _____
 Address: _____
 City: _____ State: _____ Zip Code: _____
 Phone: _____ Fax: _____
 Email: _____

Commercial Building Characteristics	Residential Building Characteristics
Height:	<input type="checkbox"/> SF Dwelling <input type="checkbox"/> SF Townhouse
No. of stories:	Depth Width
Gross area, sq. ft./floor:	1 st floor:
	2 nd floor:
Area of construction (sq. ft.):	Basement:
	<input type="checkbox"/> Finished Basement
Use group:	<input type="checkbox"/> Unfinished Basement
	<input type="checkbox"/> Crawl Space
Construction type:	<input type="checkbox"/> Slab on Grade
<input type="checkbox"/> Reinforced Concrete	No. of Bedrooms:
<input type="checkbox"/> Structural Steel	Multi-family Dwelling
<input type="checkbox"/> Masonry	No. of efficiency units:
<input type="checkbox"/> Wood Frame	No. of 1 BR units:
<input type="checkbox"/> State Certified Modular	No. of 2 BR units:
	No. of 3 BR units:
	Other Structure:
	Dimensions:
<input checked="" type="checkbox"/> Roadside Tree Project Permit	Footings:
<input type="checkbox"/> Yes <input checked="" type="checkbox"/> No	Roof:
Roadside Tree Project Permit #	<input type="checkbox"/> State Certified Modular
	<input type="checkbox"/> Manufactured Home

Property Owner's Name: Robert & Kay Squers
 Address: 5255 Ilex Way
 City: Dayton State: MD Zip Code: 21036
 Phone: _____ Fax: _____
 Email: _____

Applicant's Name & Mailing Address, (If other than stated herein)
 Applicant's Name: _____
 Address: _____
 City: _____ State: _____ Zip Code: _____
 Phone: _____ Fax: _____
 Email: _____

Contractor Company: Michael Bryan Landscaping
 Contact Person: Stephen Snyder
 Address: 7901 Wonterset Ave
 City: Pikesville State: MD Zip Code: 21008
 License No.: 102401
 Phone: 240 876-8804 Fax: _____
 Email: _____

Engineer/Architect Company: _____
 Responsible Design Prof.: _____
 Address: _____
 City: _____ State: _____ Zip Code: _____
 Phone: _____ Fax: _____
 Email: _____

Utilities
Water Supply
<input type="checkbox"/> Public
<input checked="" type="checkbox"/> Private
Sewage Disposal
<input type="checkbox"/> Public
<input checked="" type="checkbox"/> Private
Electric: <input type="checkbox"/> Yes <input type="checkbox"/> No
Gas: <input type="checkbox"/> Yes <input type="checkbox"/> No
Heating System
<input type="checkbox"/> Electric <input type="checkbox"/> Oil
<input type="checkbox"/> Natural Gas <input type="checkbox"/> Propane Gas
<input type="checkbox"/> Other:
Sprinkler System:
<input type="checkbox"/> Yes <input type="checkbox"/> No
Grading Permit Number:
Building Shell Permit Number:

THE UNDERSIGNED HEREBY CERTIFIES AND AGREES AS FOLLOWS: (1) THAT HE/SHE IS AUTHORIZED TO MAKE THIS APPLICATION; (2) THAT THE INFORMATION IS CORRECT; (3) THAT HE/SHE WILL COMPLY WITH ALL REGULATIONS OF HOWARD COUNTY WHICH ARE APPLICABLE THERETO; (4) THAT HE/SHE WILL PERFORM NO WORK ON THE ABOVE REFERENCED PROPERTY NOT SPECIFICALLY DESCRIBED IN THIS APPLICATION; (5) THAT HE/SHE GRANTS COUNTY OFFICIALS THE RIGHT TO ENTER ONTO THIS PROPERTY FOR THE PURPOSE OF INSPECTING THE WORK PERMITTED AND POSTING NOTICES.

Applicant's Signature: [Signature]
 Email Address: mike@michaelbryanlandscapes.com
 Title/Company: Michael Bryan Landscapes

Print Name: Stephen Snyder
 Date: 12/3/14

Checks Payable to: DIRECTOR OF FINANCE OF HOWARD COUNTY
 PLEASE WRITE NEATLY & LEGIBLY
 -FOR OFFICE USE ONLY-

AGENCY	DATE	SIGNATURE OF APPROVAL
State Highways		
Building Officials		
PSZA (Zoning)		
PSZA (Engineering)		
Health	<u>12/3/14</u>	<u>H. Oswald</u>

Is Sediment Control approval required for issuance? Yes No
 CONTINGENCY CONSTRUCTION START

DPZ SETBACK INFORMATION

Front: _____
 Rear: _____
 Side: _____
 Side St.: _____
 All minimum setbacks met? Yes No
 Is Entrance Permit Required? Yes No
 Historic District? Yes No
 Lot Coverage for New Town Zone: _____
 SDP/Red-line approval date: _____

Filing Fee	\$
Permit Fee	\$
Tech Fee	\$
Excise Tax	\$
PSFS	\$
Guaranty Fund	\$
Add'l per Fee	\$
Total Fees	\$
Sub-Total Paid	\$
Balance Due	\$
Check	#

Mr. [unclear]

Here is a reduction of the [unclear] site plan for our lot. Could you review it and let me know if there are any further problems, please?

(over)

JLEX WAY

1" = 50' Scale

NOTE: PROPOSED NEW GRADE LINES ARE INTENDED BE ACHIEVED BY THE CUTTING & FILLING OF EY SOIL ON SITE WITHOUT NEED FOR REMOVAL EXCESS OR DELIVERY OF ADDITIONAL SOIL.

KAY & BOB SAULERS
LOT 24
KALMIA FARMS
SECTION 2
DAYTON, MD

7/2/86
Concept Plan O.K.
Fall on houses sewer line
needs minor adjustment.
Proposed well & perc.
locations O.K.

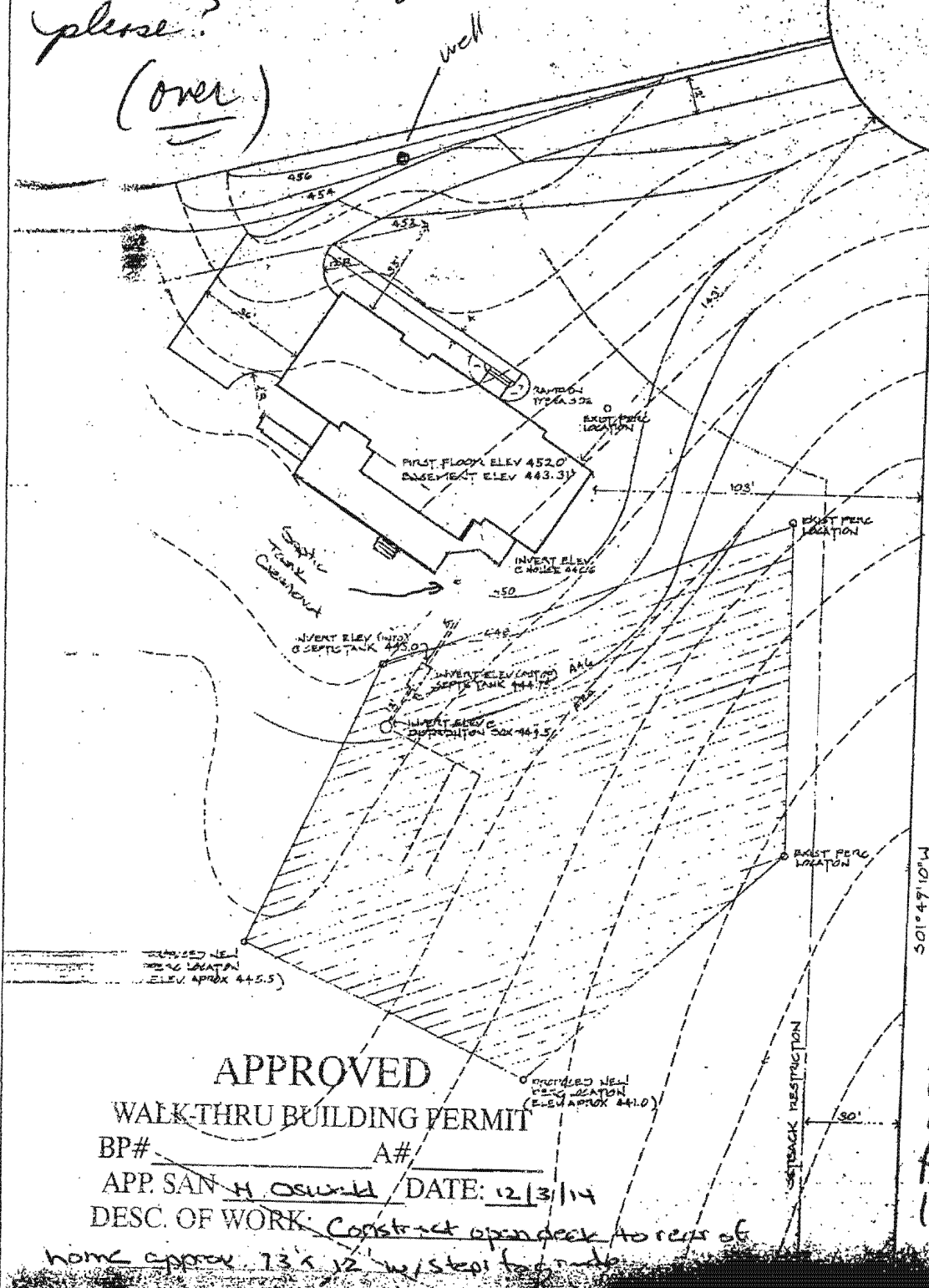

APPROVED
WALK-THRU BUILDING PERMIT

BP# _____ A# _____
APP. SAN H OSWICK / DATE: 12/3/14

DESC. OF WORK: Construct open deck to rear of home approx. 13 x 12 w/ steps to grade

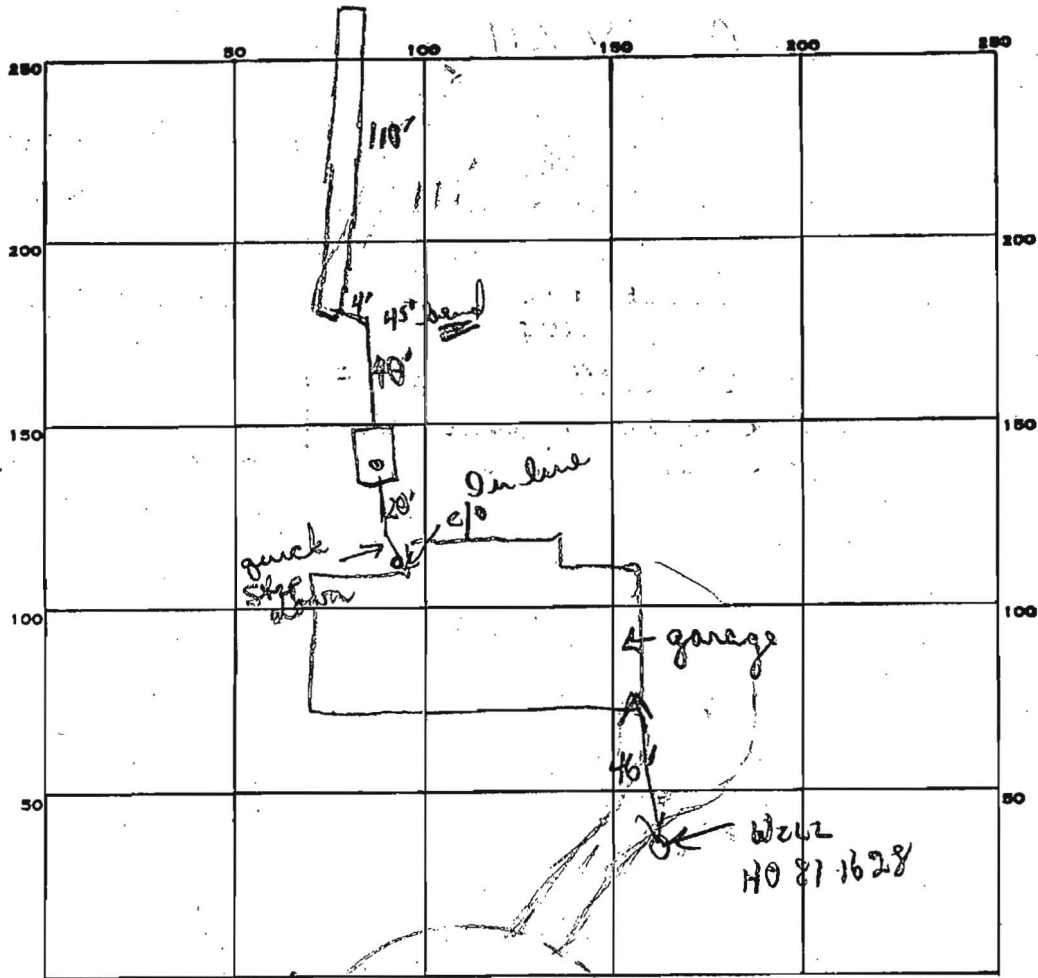

INDICATE NORTH. - NAME ADJOINING ROADWAY AS BASE LINE.

PERMIT CARD

SEPTIC TANK, LEVEL 1500

CLEANOUTS 1 In line 1 S.F.

220
3
660 (mm)

DISTRIBUTION BOX, LEVEL

TILE FIELD, DEPTH 9 FT. TRENCH WIDTH 2 FT.

GRAVEL DEPTH 6 ft IN. TOTAL LENGTH 110 FEET

NUMBER OF TRENCHES 1 TOTAL BOTTOM AREA 66 SQ. FT.

SEEPAGE PITS, INSIDE DIAMETER FT. DEPTH BELOW INLET FT.

ABSORBENT AREA 660 SQ. FT.

REMARKS 2/12/87 OK to extend trench to 110'. OK to finish adding
stone pipe paper to trench OK to cover to trench.
2/17/86 OK to cover trench + all work

DATE SYSTEM APPROVED 2/17/87

INSPECTOR B. Nipen