

LAYOUT _____ INSP 4 _____
INSP 2 _____ INSP 5 _____
INSP 3 _____ INSP 6 _____

ISSUE DATE: 05/22/07

APPROVAL DATE: 4/26/07

PERMIT
INDEXED

P 526723-B

A _____

ON-SITE SEWAGE DISPOSAL SYSTEM
HOWARD COUNTY HEALTH DEPARTMENT
BUREAU OF ENVIRONMENTAL HEALTH

NV Homes IS PERMITTED TO INSTALL ALTER

ADDRESS: 6085 Marshalee Dr, Ste 130, Elkridge PHONE NUMBER: _____

SUBDIVISION: Ellicott Meadows LOT NUMBER: 114

ADDRESS: 3035 Homeland Way PROPERTY OWNER: NVR Homes

SEPTIC TANK CAPACITY (GALLONS): _____ OUTLET BAFFLE FILTER REQUIRED

PUMP CHAMBER CAPACITY (GALLONS): _____ COMPARTMENTED TANK REQUIRED

NUMBER OF BEDROOMS: _____

SQUARE FEET PER BEDROOM: _____

LINEAR FEET OF TRENCH REQUIRED: _____

TRENCHES:	Trench to be _____ feet wide. Inlet _____ feet below original grade. Bottom maximum depth _____ feet below original grade. Effective area begins at _____ feet below original grade. _____ feet of stone below distribution pipe.
LOCATION:	Septic connection to unit only.
NOTES:	

PLANS APPROVED: _____ DATE: _____

- NOTE: PERMIT VOID AFTER 2 YEARS
- NOTE: CONTRACTOR RESPONSIBLE FOR SCHEDULING A PRE-CONSTRUCTION INSPECTION FOR ALL INSTALLATIONS
- NOTE: WATERTIGHT SEPTIC TANKS REQUIRED
- NOTE: ALL PARTS OF SEPTIC SYSTEM SHALL BE 100 FEET FROM ANY WATER WELL
- NOTE: MANHOLE RISERS REQUIRED ON ALL SEPTIC TANKS AND PUMP CHAMBERS UNLESS SPECIFICALLY AUTHORIZED

NEITHER THE HOWARD COUNTY COUNCIL NOR THE HEALTH DEPARTMENT IS RESPONSIBLE FOR THE SUCCESSFUL OPERATION OF ANY SYSTEM PERMITTEE RESPONSIBLE FOR OBTAINING FINAL APPROVAL ON THIS PERMIT CALL 410-313-2640 FOR INSPECTION OF SEPTIC SYSTEM

526723-B

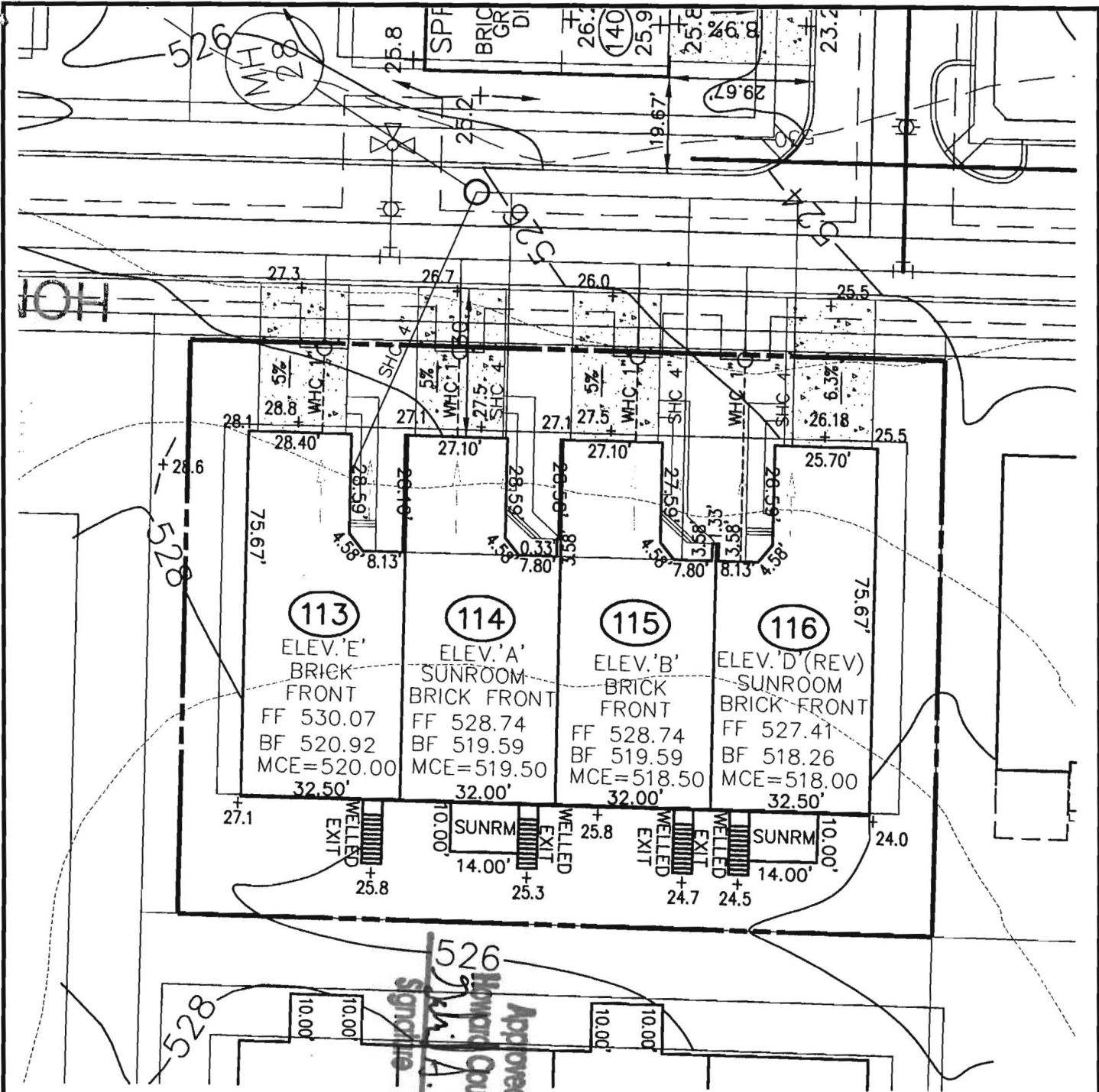

**ROBERT H. VOGEL
ENGINEERING INC.**
ENGINEERS • SURVEYORS • PLANNERS
8407 MAIN STREET TEL: 410.461.7666
ELlicOTT CITY, MD 21043 FAX: 410.461.8961

Approved Site Plan
 Howard County/Johns Hopkins
 Date 1/29/07

SCALE 1"=30'
 DRAWN BY MY
 CHECKED BY RHV
 DATE DEC. 18, 2006
 W. O. # 04-87.00
 SHEET# 1 OF 1

NV HOMES
ELLICOTT MEADOWS
UNITS 113 -116

HOMELAND SDP-03-30
 TAX MAP 16
 3RD ELECTION DISTRICT

PARCEL 53,96,165&204
 HOWARD COUNTY, MARYLAND

[Signature]
 12/20/06

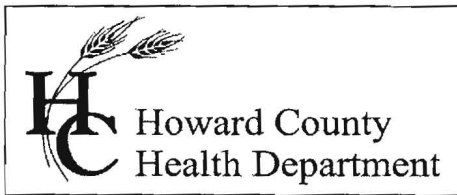

Bureau of Environmental Health
7178 Gateway Drive Columbia, MD 21046
(410) 313-2640 Fax (410) 313-2648
TDD (410) 313-2323 Toll Free 1-866-313-6300
website: www.hchealth.org

Peter L. Beilenson, M.D., M.P.H., Health Officer

July 24, 2007

NVR, Inc./Ryan Homes
6085 Marshalee Drive, Suite 130
Elkridge, MD 21075

SENT BY FACSIMILE 410-796-7094

RE: Homeland, Lot 114
Ellicott Meadows
3035 Homeland Way
Ellicott City, MD 21042
BP# B06009139
PUBLIC WATER

Dear Sir/Madam:

This is to advise you that the septic system for the above referenced property has been installed and inspected. **Final approval of the septic system was granted on 04/26/2007.**

The property is served by public water and is therefore exempt from the Health Department water sampling requirements.

By issuance of this letter, this office recommends release of the Use and Occupancy permit for the referenced property.

Approving Authority,

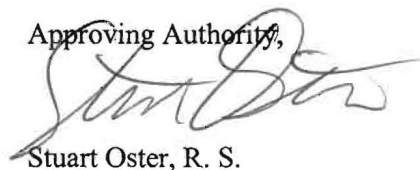

Stuart Oster, R. S.
Well & Septic Program

mlb
cc: Building Inspector's Office
File