

LAYOUT _____ INSP 4 _____

INSP 2 _____ INSP 5 _____

INSP 3 _____ INSP 6 _____

ISSUE DATE: 5/22/07

P 526723

APPROVAL DATE: 4/26/07

A _____

PERMIT INDEXED

ON-SITE SEWAGE DISPOSAL SYSTEM HOWARD COUNTY HEALTH DEPARTMENT BUREAU OF ENVIRONMENTAL HEALTH

IS PERMITTED TO INSTALL ALTER

ADDRESS: _____ PHONE NUMBER: _____

SUBDIVISION: Ellicott Meadows LOT NUMBER: 116

ADDRESS: 3031 Homeland Way PROPERTY OWNER: NVR Homes

SEPTIC TANK CAPACITY (GALLONS): _____ OUTLET BAFFLE FILTER REQUIRED

PUMP CHAMBER CAPACITY (GALLONS): _____ COMPARTMENTED TANK REQUIRED

NUMBER OF BEDROOMS: _____

SQUARE FEET PER BEDROOM: _____

LINEAR FEET OF TRENCH REQUIRED: _____

TRENCHES:	Trench to be _____ feet wide. Inlet _____ feet below original grade. Bottom maximum depth _____ feet below original grade. Effective area begins at _____ feet below original grade. _____ feet of stone below distribution pipe.
LOCATION:	Septic connection to unit only.
NOTES:	

PLANS APPROVED: _____ DATE: _____

- NOTE: PERMIT VOID AFTER 2 YEARS
- NOTE: CONTRACTOR RESPONSIBLE FOR SCHEDULING A PRE-CONSTRUCTION INSPECTION FOR ALL INSTALLATIONS
- NOTE: WATERTIGHT SEPTIC TANKS REQUIRED
- NOTE: ALL PARTS OF SEPTIC SYSTEM SHALL BE 100 FEET FROM ANY WATER WELL
- NOTE: MANHOLE RISERS REQUIRED ON ALL SEPTIC TANKS AND PUMP CHAMBERS UNLESS SPECIFICALLY AUTHORIZED

**NEITHER THE HOWARD COUNTY COUNCIL NOR THE HEALTH DEPARTMENT IS
RESPONSIBLE FOR THE SUCCESSFUL OPERATION OF ANY SYSTEM
PERMITTEE RESPONSIBLE FOR OBTAINING FINAL APPROVAL ON THIS PERMIT
CALL 410-313-2640 FOR INSPECTION OF SEPTIC SYSTEM**

P526723

NOT TO SCALE

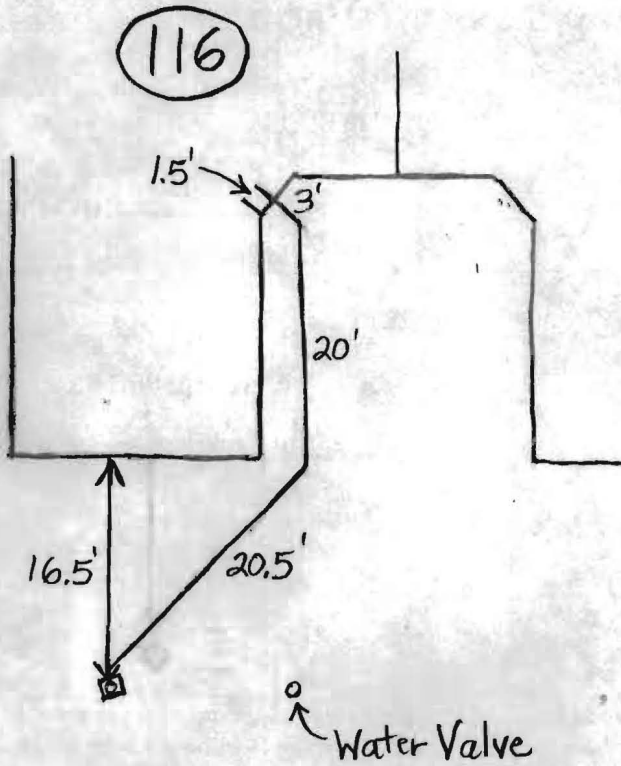

TRENCH/DRAINFIELD DATA		
WIDTH	INLET	BOTTOM
_____	_____	_____
NUMBER OF TRENCHES _____		
TOTAL LENGTH _____		
ABSORPTION AREA _____		
DISTRIBUTION BOX LEVEL _____		
DISTRIBUTION BOX BAFFLE _____		
DISTRIBUTION BOX PORT _____		

SEPTIC TANK DATA	
SEPTIC TANK 1 LEVEL _____	
CAPACITY _____	GAL
SEAM LOC _____	
TANK LID DEPTH _____	
BAFFLES _____	
BAFFLE FILTER _____	
MANHOLE LOC _____	
6" PORT LOC _____	
WATERTIGHT TEST _____	
SEPTIC TANK 2 LEVEL _____	
CAPACITY _____	GAL
SEAM LOC _____	
TANK LID DEPTH _____	
BAFFLES _____	
BAFFLE FILTER _____	
MANHOLE LOC _____	
6" PORT LOC _____	
WATERTIGHT TEST _____	

PRE-CONSTRUCTION _____

INSTALLATION 4/26/07 *Septic house connection made. O.K. to backfill. Need permit fee. (BB)*

FINAL INSPECTOR _____

DATE OF APPROVAL 4/26/07

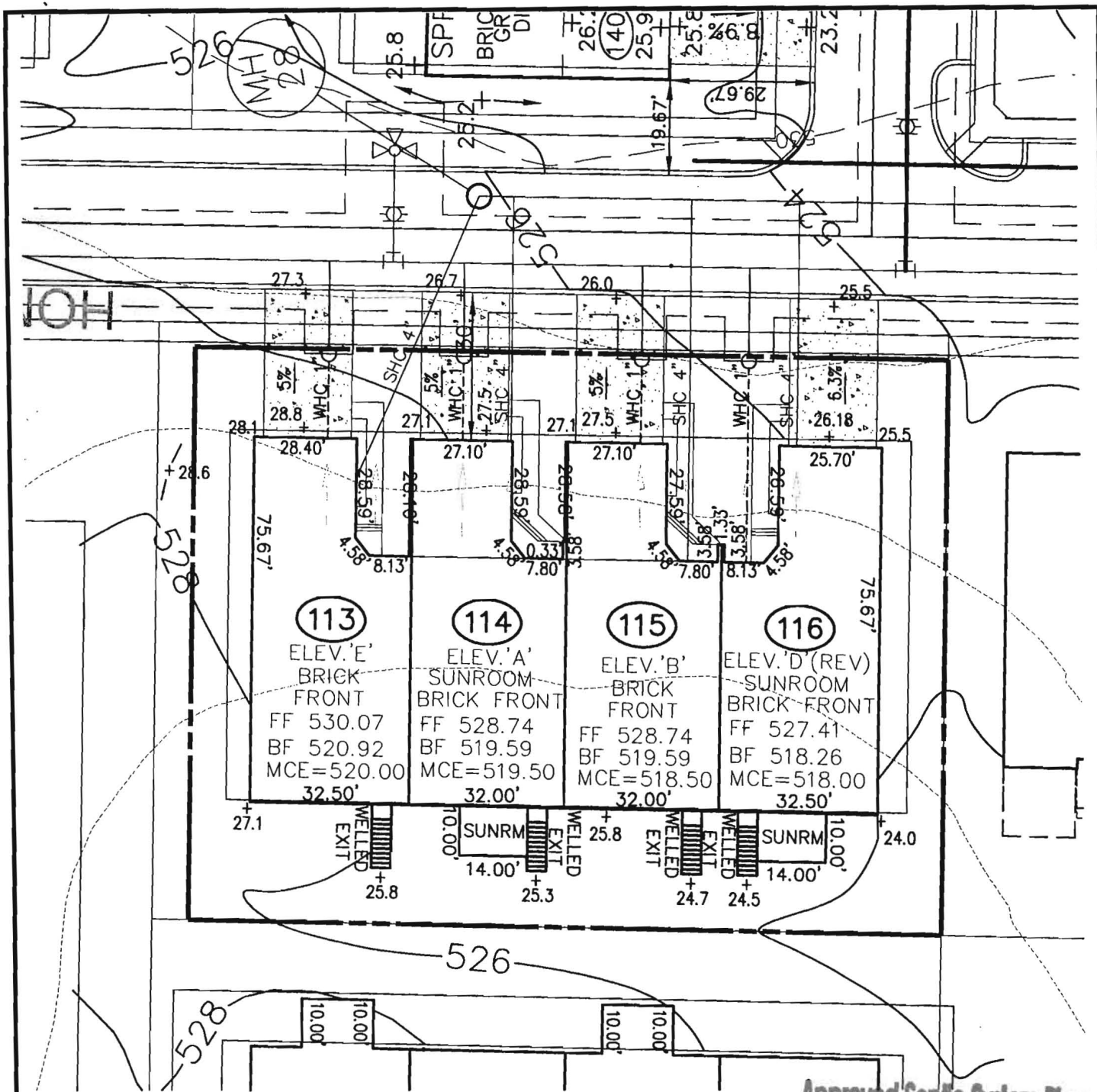

VA ROBERT H. VOGEL ENGINEERING, INC.
 ENGINEERS • SURVEYORS • PLANNERS
 8407 MAIN STREET TEL: 410.461.7666
 ELLICOTT CITY, MD 21043 FAX: 410.461.8961

Approved Septic System Plan
 Howard County Health Department
Delia J. [Signature]
 Signature Date 1/24/2007

NV HOMES
ELLICOTT MEADOWS
UNITS 113 -116

SCALE 1"=30'
 DRAWN BY MY
 CHECKED BY RHV
 DATE DEC. 18, 2006
 W. O. # 04-87.00
 SHEET# 1 OF 1

HOMELAND SDP-03-30
 TAX MAP 16
 3RD ELECTION DISTRICT

PARCEL 53,96,165&204
 HOWARD COUNTY, MARYLAND

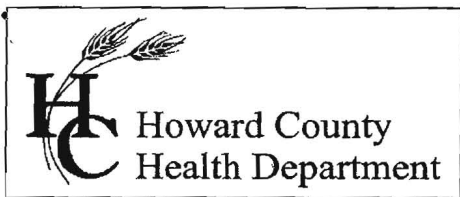

Bureau of Environmental Health
7178 Gateway Drive Columbia, MD 21046
(410) 313-2640 Fax (410) 313-2648
TDD (410) 313-2323 Toll Free 1-866-313-6300
website: www.hchealth.org

Peter L. Beilenson, M.D., M.P.H., Health Officer

July 24, 2007

NVR, Inc./Ryan Homes
6085 Marshalee Drive, Suite 130
Elkridge, MD 21075

SENT BY FACSIMILE 410-796-7094

RE: Homeland, Lot 116
Ellicott Meadows
3031 Homeland Way
Ellicott City, MD 21042
BP# B06009137
PUBLIC WATER

Dear Sir/Madam:

This is to advise you that the septic system for the above referenced property has been installed and inspected. **Final approval of the septic system was granted on 04/26/2007.**

The property is served by public water and is therefore exempt from the Health Department water sampling requirements.

By issuance of this letter, this office recommends release of the Use and Occupancy permit for the referenced property.

Approving Authority

Stuart Oster, R. S.
Well & Septic Program

mlb
cc: Building Inspector's Office
File