

LAYOUT _____

INSP 1 _____ INSP 3 _____

INSP 2 _____ INSP 5 _____

ISSUE DATE: 5/2/07

P 526 676-B

APPROVAL DATE:

5/2/2007

PERMIT SHARED SEPTIC SYSTEM

A

INDEXED

HOUSE SEWER LINE CONNECTION

HOWARD COUNTY HEALTH DEPARTMENT BUREAU OF ENVIRONMENTAL HEALTH

NVR _____ IS PERMITTED TO INSTALL ALTER

ADDRESS: 6085 Marshalee Drive, Elkridge MD 21075 PHONE NUMBER: 410-379-5956

SUBDIVISION Homeland (Ellicott Meadows) LOT NUMBER: 118

ADDRESS: 3025 Homeland Way PROPERTY OWNER: NVR, Inc.

NUMBER OF BEDROOMS: 2

HOUSE SERVED BY PUBLIC WATER? Yes

LOCATION:	Install 4" house sewer line connection per the approved site plan.
NOTES:	This permit is limited to the installation of the individual house sewer line connection and installation of the grinder pump, if applicable. The Howard County Bureau of Utilities must be contacted for scheduling of inspection of these items, as well at 410-313-4900.

PLANS APPROVED: Mike Davis DATE: 6/1/06

PERMIT VOID AFTER 2 YEARS

1. CONTRACTOR IS RESPONSIBLE FOR SCHEDULING A PRE-CONSTRUCTION INSPECTION FOR ALL INSTALLATIONS.
2. ALL PARTS OF SEPTIC SYSTEM SHALL BE 100 FEET FROM ANY WATER WELL UNLESS SPECIFICALLY AUTHORIZED.
3. MANHOLE RISERS REQUIRED ON ALL SEPTIC TANKS AND PUMP CHAMBERS UNLESS SPECIFICALLY AUTHORIZED.
4. CONTRACTOR RESPONSIBLE FOR COMPLIANCE WITH APPLICABLE REGULATIONS, GUIDELINES AND THE TERMS OF THIS PERMIT.
5. NEITHER THE HOWARD COUNTY COUNCIL OR THE HEALTH DEPARTMENT IS RESPONSIBLE FOR THE SUCCESSFUL OPERATION OF ANY SYSTEM.
6. PERMITTEE RESPONSIBLE FOR OBTAINING FINAL APPROVAL ON THIS PERMIT.

CALL 410-313-1771 FOR INSPECTION HOUSE CONNECTION

P 526676-B

NOT TO SCALE

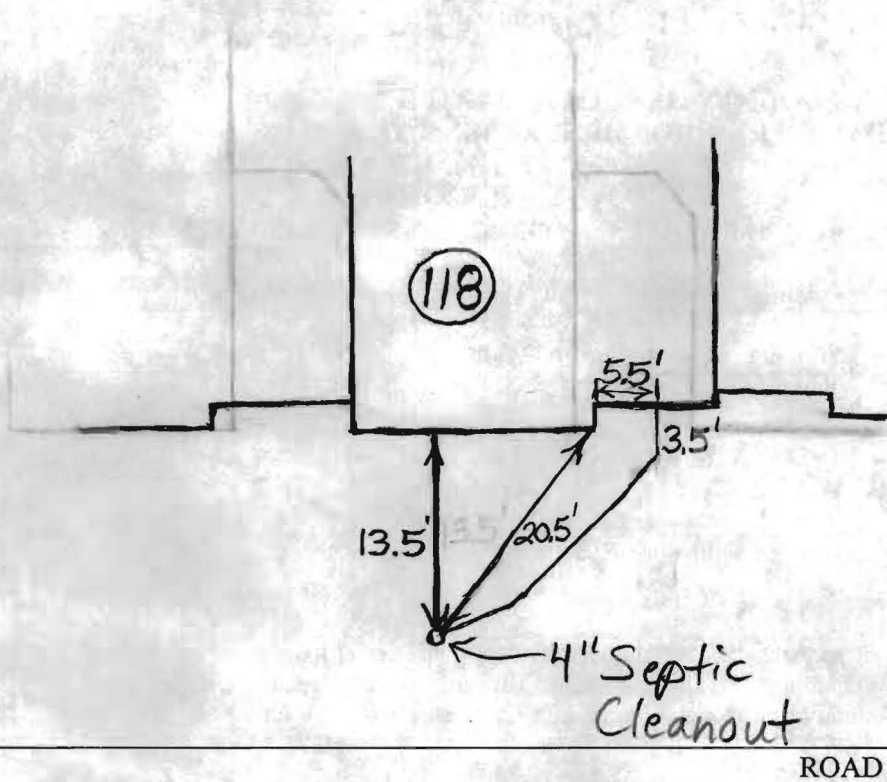

TRENCH/DRAINFIELD DATA

WIDTH	INLET	BOTTOM
_____	_____	_____
NUMBER OF TRENCHES _____		
TOTAL LENGTH _____		
ABSORPTION AREA _____		
DISTRIBUTION BOX LEVEL _____		
DISTRIBUTION BOX BAFFLE _____		
DISTRIBUTION BOX PORT _____		

SEPTIC TANK DATA

SEPTIC TANK 1 LEVEL _____

CAPACITY _____ GAL

SEAM LOC _____

TANK LID DEPTH _____

BAFFLES _____

BAFFLE FILTER _____

MANHOLE LOC _____

6" PORT LOC _____

WATERTIGHT TEST _____

SEPTIC TANK 2 LEVEL _____

CAPACITY _____ GAL

SEAM LOC _____

TANK LID DEPTH _____

BAFFLES _____

BAFFLE FILTER _____

MANHOLE LOC _____

6" PORT LOC _____

WATERTIGHT TEST _____

PRE-CONSTRUCTION ~ 8.5' below brick ledge

INSTALLATION 5/2/2007 House connection ~ 8.5' below brick ledge.
O.K. to backfill. (BB)

FINAL INSPECTOR B. Baker DATE OF APPROVAL 5/2/2007



Bureau of Environmental Health
7178 Gateway Drive Columbia, MD 21046
(410) 313-2640 Fax (410) 313-2648
TDD (410) 313-2323 Toll Free 1-866-313-6300
website: www.hchealth.org

Peter L. Beilenson, M.D., M.P.H., Health Officer

July 11, 2007

NVR, Inc./Ryan Homes
6085 Marshalee Drive, Suite 130
Elkridge, MD 21075

SENT BY FACSIMILE 410-796-7094

RE: Homeland, Lot 118
Ellicott Meadows
3025 Homeland Way
Ellicott City, MD 21042
BP# B06007188
PUBLIC WATER

Dear Sir/Madam:

This is to advise you that the septic system for the above referenced property has been installed and inspected. **Final approval of the septic system was granted on 05/02/2007.**

The property is served by public water and is therefore exempt from the Health Department water sampling requirements.

By issuance of this letter, this office recommends release of the Use and Occupancy permit for the referenced property.

Approving Authority,

Stuart Oster, R. S.
Well & Septic Program

mlb
cc: Building Inspector's Office
File

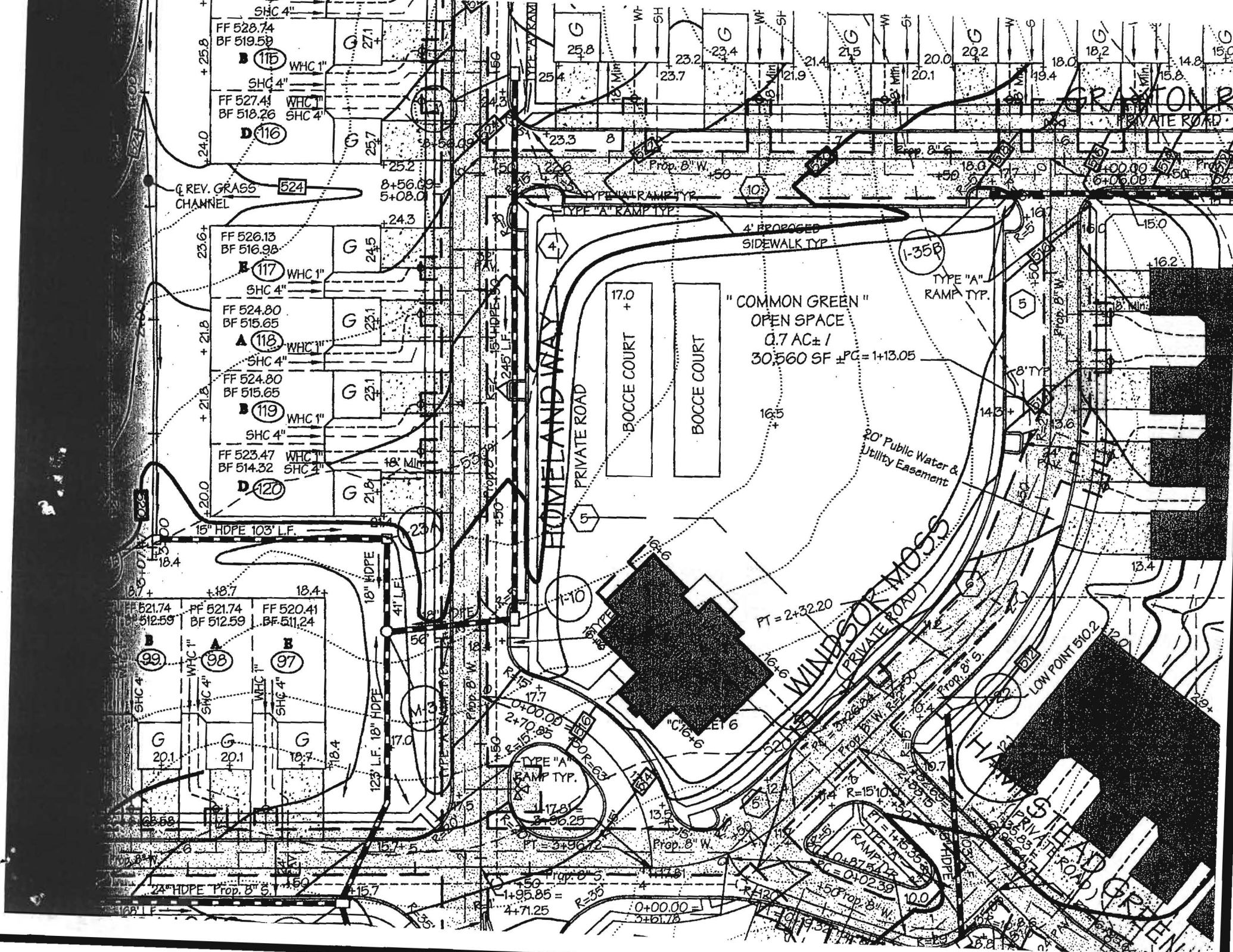

SHC 4"
FF 528.74
BF 519.59

B (115) WHC 1"
SHC 4"
FF 527.41
BF 518.26

D (116) WHC 1"
SHC 4"

FF 526.13
BF 516.98

E (117) WHC 1"
SHC 4"

FF 524.80
BF 515.65

A (118) WHC 1"
SHC 4"

FF 524.80
BF 515.65

B (119) WHC 1"
SHC 4"

FF 523.47
BF 514.32

D (120) WHC 1"
SHC 4"

FF 521.74
BF 512.59

B (99) WHC 1"
SHC 4"

A (98) WHC 1"
SHC 4"

B (97) WHC 1"
SHC 4"

G 20.1

G 20.1

G 18.7

24" HDPE Prop. 8" S.

24.0

25.2

24.3

23.6

+21.8

+21.8

+21.8

+21.8

+21.8

+20.0

+18.7

+18.4

+18.4

+18.4

+18.4

+18.4

+18.4

+18.4

+18.4

+18.4

+18.4

25.2

24.3

24.5

24.5

23.1

23.1

23.1

23.1

21.8

21.8

21.8

21.8

21.8

21.8

21.8

21.8

21.8

21.8

21.8

21.8

21.8

25.2

24.3

24.5

24.5

23.1

23.1

23.1

23.1

21.8

21.8

21.8

21.8

21.8

21.8

21.8

21.8

21.8

21.8

21.8

21.8

21.8

25.2

24.3

24.5

24.5

23.1

23.1

23.1

23.1

21.8

21.8

21.8

21.8

21.8

21.8

21.8

21.8

21.8

21.8

21.8

21.8

21.8

25.2

24.3

24.5

24.5

23.1

23.1

23.1

23.1

21.8

21.8

21.8

21.8

21.8

21.8

21.8

21.8

21.8

21.8

21.8

21.8

21.8

25.2

24.3

24.5

24.5

23.1

23.1

23.1

23.1

21.8

21.8

21.8

21.8

21.8

21.8

21.8

21.8

21.8

21.8

21.8

21.8

21.8

25.2

24.3

24.5

24.5

23.1

23.1

23.1

23.1

21.8

21.8

21.8

21.8

21.8

21.8

21.8

21.8

21.8

21.8

21.8

21.8

21.8

25.2

24.3

24.5

24.5

23.1

23.1

23.1

23.1

21.8

21.8

21.8

21.8

21.8

21.8

21.8

21.8

21.8

21.8

21.8

21.8

21.8

25.2

24.3

24.5

24.5

23.1

23.1

23.1

23.1

21.8

21.8

21.8

21.8

21.8

21.8

21.8

21.8

21.8

21.8

21.8

21.8

21.8

25.2

24.3

24.5

24.5

23.1

23.1

23.1

23.1

21.8

21.8

21.8

21.8

21.8

21.8

21.8

21.8

21.8

21.8

21.8

21.8

21.8

25.2

24.3

24.5

24.5

23.1

23.1

23.1

23.1

21.8

21.8

21.8

21.8

21.8

21.8

21.8

21.8

21.8

21.8

21.8

21.8

21.8

25.2

24.3

24.5

24.5

23.1

23.1

23.1

23.1

21.8

21.8

21.8

21.8

21.8

21.8

21.8

21.8

21.8

21.8

21.8

21.8

21.8