

LAYOUT \_\_\_\_\_  
INSP 1 \_\_\_\_\_ INSP 3 \_\_\_\_\_  
INSP 2 \_\_\_\_\_ INSP 5 \_\_\_\_\_

ISSUE DATE: 3/5/07

P 526264

APPROVAL DATE: 2/28/07

**PERMIT**  
**COMMUNITY SEPTIC SYSTEM**  
**INDEXED**

A \_\_\_\_\_

**HOUSE SEWER LINE CONNECTION**

**HOWARD COUNTY HEALTH DEPARTMENT**  
**BUREAU OF ENVIRONMENTAL HEALTH**

NV HOMES IS PERMITTED TO INSTALL  ALTER

ADDRESS: \_\_\_\_\_ PHONE NUMBER: \_\_\_\_\_

SUBDIVISION Homeland - Ellicott Meadows LOT NUMBER: 95

ADDRESS: 11947 Hampstead Green PROPERTY OWNER: NV Homes

NUMBER OF BEDROOMS: 2

**HOUSE SERVED BY PUBLIC WATER**

LOCATION:	Install 4" house sewer line connection per the approved site plan. Final acceptance of the sewer system will be subject to the approval of the Maryland Department of the Environment.
NOTES:	This permit is limited to the installation of the individual house sewer line connection.

PLANS APPROVED: \_\_\_\_\_ DATE: \_\_\_\_\_

**PERMIT VOID AFTER 2 YEARS**

1. CONTRACTOR IS RESPONSIBLE FOR SCHEDULING A PRE-CONSTRUCTION INSPECTION FOR ALL INSTALLATIONS.
2. ALL PARTS OF SEPTIC SYSTEM SHALL BE 100 FEET FROM ANY WATER WELL UNLESS SPECIFICALLY AUTHORIZED.
3. CONTRACTOR RESPONSIBLE FOR COMPLIANCE WITH APPLICABLE REGULATIONS, GUIDELINES AND THE TERMS OF THIS PERMIT.
4. NEITHER THE HOWARD COUNTY COUNCIL NOR THE HEALTH DEPARTMENT IS RESPONSIBLE FOR THE SUCCESSFUL OPERATION OF ANY SYSTEM.
5. PERMITTEE RESPONSIBLE FOR OBTAINING FINAL APPROVAL ON THIS PERMIT.

**CALL 410-313-1771 FOR INSPECTION OF SEPTIC SYSTEM**

*BUILDING PERMIT APPROVED*  
*4/5/07 507001162 10'X14' WALKOUT*

*526264-B*

NOT TO SCALE

Lot  
95

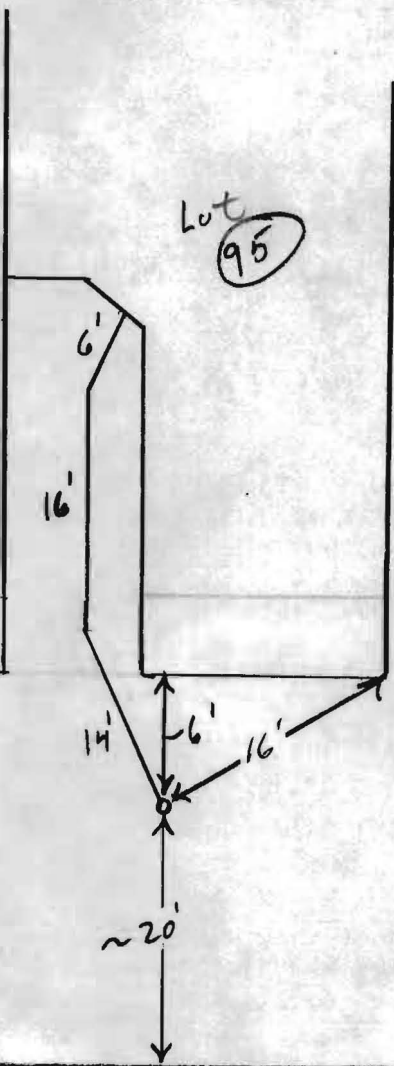

Hamstead Green

ROAD

**TRENCH/DRAINFIELD DATA**

WIDTH	INLET	BOTTOM
_____	_____	_____
NUMBER OF TRENCHES _____		
TOTAL LENGTH _____		
ABSORPTION AREA _____		
DISTRIBUTION BOX LEVEL _____		
DISTRIBUTION BOX BAFFLE _____		
DISTRIBUTION BOX PORT _____		

**SEPTIC TANK DATA**

SEPTIC TANK 1 LEVEL \_\_\_\_\_

CAPACITY \_\_\_\_\_ GAL

SEAM LOC \_\_\_\_\_

TANK LID DEPTH \_\_\_\_\_

BAFFLES \_\_\_\_\_

BAFFLE FILTER \_\_\_\_\_

MANHOLE LOC \_\_\_\_\_

6" PORT LOC \_\_\_\_\_

WATERTIGHT TEST \_\_\_\_\_

SEPTIC TANK 2 LEVEL \_\_\_\_\_

CAPACITY \_\_\_\_\_ GAL

SEAM LOC \_\_\_\_\_

TANK LID DEPTH \_\_\_\_\_

BAFFLES \_\_\_\_\_

BAFFLE FILTER \_\_\_\_\_

MANHOLE LOC \_\_\_\_\_

6" PORT LOC \_\_\_\_\_

WATERTIGHT TEST \_\_\_\_\_

PRE-CONSTRUCTION \_\_\_\_\_

INSTALLATION OK to Backfill (KW)

FINAL INSPECTOR (KW) DATE OF APPROVAL 2/28/07

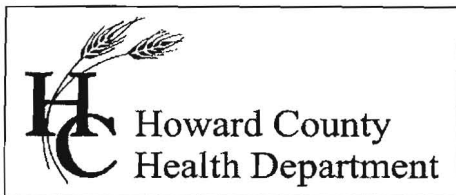

Bureau of Environmental Health  
7178 Gateway Drive Columbia, MD 21046  
(410) 313-2640 Fax (410) 313-2648  
TDD (410) 313-2323 Toll Free 1-866-313-6300  
website: www.hchealth.org

Peter L. Beilenson, M.D., M.P.H., Health Officer

May 17, 2007

NVR, Inc./NV Homes  
6085 Marshalee Drive, Suite 130  
Elkridge, MD 21075

**SENT BY FACSIMILE 301-854-9632**

RE: Homeland—Ellicott Meadows, Lot 95  
11947 Hampstead Green  
Ellicott City, MD 21042  
BP# B06008140  
**PUBLIC WATER**

Dear Sir/Madam:

This is to advise you that the septic system for the above referenced property has been installed and inspected. **Final approval of the septic system was granted on 02/28/2007.**

The property is served by public water and is therefore exempt from the Health Department water sampling requirements.

By issuance of this letter, this office recommends release of the Use and Occupancy permit for the referenced property.

Approving Authority,

Stuart Oster, R. S.  
Well & Septic Program

mlb

cc: Building Inspector's Office  
File