

LAYOUT \_\_\_\_\_ INSP 4 \_\_\_\_\_  
INSP 2 \_\_\_\_\_ INSP 5 \_\_\_\_\_  
INSP 3 \_\_\_\_\_ INSP 6 \_\_\_\_\_

ISSUE DATE: 09/18/78  
APPROVAL DATE: \_\_\_\_\_

P 28884  
A 527978

**PERMIT**  
**INDEXED**  
**TAX ID #03-282465**  
**ON-SITE SEWAGE DISPOSAL SYSTEM**  
**HOWARD COUNTY HEALTH DEPARTMENT**  
**BUREAU OF ENVIRONMENTAL HEALTH**

\_\_\_\_\_ IS PERMITTED TO INSTALL  ALTER

ADDRESS: \_\_\_\_\_ PHONE NUMBER: \_\_\_\_\_

SUBDIVISION: \_\_\_\_\_ LOT NUMBER: 8

ADDRESS: 701 Gaither Road PROPERTY OWNER: \_\_\_\_\_

SEPTIC TANK CAPACITY (GALLONS): \_\_\_\_\_ OUTLET BAFFLE FILTER REQUIRED

PUMP CHAMBER CAPACITY (GALLONS): \_\_\_\_\_ COMPARTMENTED TANK REQUIRED

NUMBER OF BEDROOMS: \_\_\_\_\_

SQUARE FEET PER BEDROOM: \_\_\_\_\_

LINEAR FEET OF TRENCH REQUIRED: \_\_\_\_\_

**BUILDING PERMIT SIGNED**  
**AND RETURNED**  
*10/17/05 800 156609 - 2 story Addition*

TRENCHES:	Trench to be _____ feet wide. Inlet _____ feet below original grade. Bottom maximum depth _____ feet below original grade. Effective area begins at _____ feet below original grade. _____ feet of stone below distribution pipe.
LOCATION:	_____
NOTES:	_____

PLANS APPROVED: \_\_\_\_\_ DATE: \_\_\_\_\_

- NOTE: PERMIT VOID AFTER 2 YEARS
- NOTE: CONTRACTOR RESPONSIBLE FOR SCHEDULING A PRE-CONSTRUCTION INSPECTION FOR ALL INSTALLATIONS
- NOTE: WATERTIGHT SEPTIC TANKS REQUIRED
- NOTE: ALL PARTS OF SEPTIC SYSTEM SHALL BE 100 FEET FROM ANY WATER WELL
- NOTE: MANHOLE RISERS REQUIRED ON ALL SEPTIC TANKS AND PUMP CHAMBERS UNLESS SPECIFICALLY AUTHORIZED

**NEITHER THE HOWARD COUNTY COUNCIL NOR THE HEALTH DEPARTMENT IS RESPONSIBLE FOR THE SUCCESSFUL OPERATION OF ANY SYSTEM PERMITTEE RESPONSIBLE FOR OBTAINING FINAL APPROVAL ON THIS PERMIT CALL 410-313-2640 FOR INSPECTION OF SEPTIC SYSTEM**

A527978

11/22/78

11/15/78 P.C.O.

11/15/78 - p.m. if possible  
or if not 11/16/78

P 28884

A 27978 11/24/78 P.C.O.

# PERMIT

SEWAGE DISPOSAL SYSTEM

MARYLAND STATE DEPARTMENT OF HEALTH

HOWARD COUNTY

## INDEX

ELLICOTT CITY

DISTRICT 3rd

DATE 9/18/78

03-282465

Pat Lendrim IS PERMITTED TO INSTALL  ALTER

ADDRESS 14010 Forsythe Road, Sykesville, Md. 21784 PHONE 442-2416

SUBDIVISION ROAD 701 Gaither Road LOT  new lot 8

PROPERTY OWNER Calvin C. Conaway

ADDRESS 7525 Main Street, Sykesville, Md. 21784 Phone: 795-3553

SPECIFICATIONS 3 bedrooms

SEPTIC TANK CAPACITY 1000 GALLONS

DRAIN FIELD DEPTH FEET, BOTTOM AREA SQ. FT.

DEEP TRENCH DEPTH FEET, BOTTOM AREA SQ. FT.

SEEPAGE PITS ABSORBENT SIDE-WALL AREA SQ. FT.

INLET PIPE FT. BELOW ORIGINAL GRADE. MAXIMUM DEPTH FT. BELOW ORIGINAL GRADE

EFFECTIVE DEPTH AT FT. BELOW ORIGINAL GRADE.

LOCATE DISPOSAL AREA FT. FROM LOT LINE AND FT. FROM LOT LINE AS SEEN WHEN FACING LOT FROM

DRY WELL AND TRENCH - System to have 200 sq. ft. effective sidewall absorption area per bedroom to begin below the first 4 ft. of non-porous soil. Maximum depth permitted for dry well or trench is 10 ft. below original grade. Place the dry well 206 ft. from the front property line and 170 ft. from the left side line as seen when facing the property from Gaither Road. Start the trench after a 5 ft. earth buffer with the dry well and proceed to dig it on level ground the necessary distance.

PLANS APPROVED BY Frank Skinner DATE 7/7/78

COVER NO WORK UNTIL INSPECTED AND APPROVED.

NEITHER THE HOWARD COUNTY COUNCIL NOR THE HEALTH DEPARTMENT IS RESPONSIBLE FOR THE SUCCESSFUL OPERATION OF ANY SYSTEM.

NOTE: IF TRENCH IS USED CALL FOR INSPECTION BEFORE PLACING GRAVEL IN TRENCH.

NOTE: NO DRY WELL SHALL EXCEED 15-FOOT IN DIAMETER.

NOTE: ALL PIPE FROM HOUSE TO DISPOSAL AREA MUST BE CAST IRON.

PERMIT VOID AFTER THREE YEARS.

NOTE: INSTALL STAND PIPE ON SEPTIC TANK AND DRY WELL. STAND PIPES MUST BE 6 INCHES IN DIAMETER. CAST IRON, CONCRETE OR TERRA COTTA ACCEPTED.

\*INSTALLER IS RESPONSIBLE FOR OBTAINING FINAL APPROVAL ON THIS PERMIT.

A 27978

A 521978

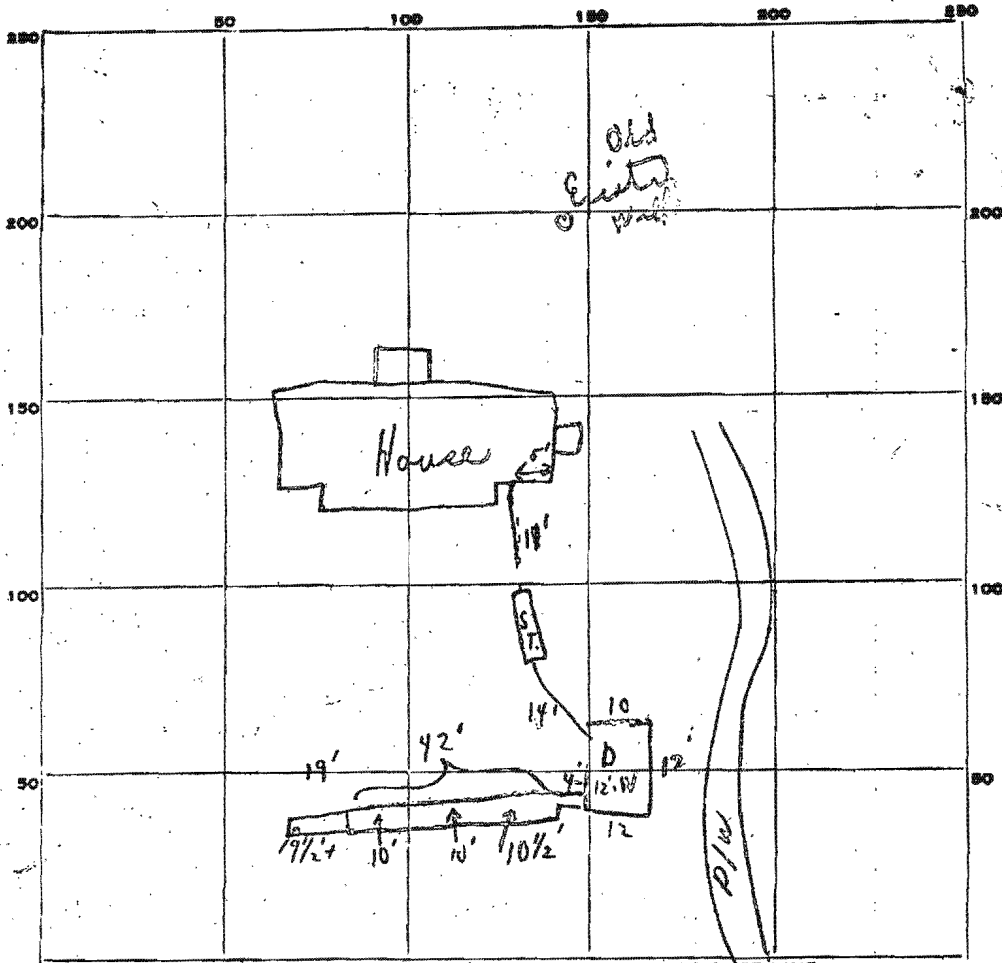

INDICATE NORTH. - NAME ADJOINING ROADWAY AS BASE LINE.

← Garther Rd →

PERMIT CARD 11/15 No. seen

SEPTIC TANK, LEVEL 11/22 No. seen OK

S.T.	D.W.
11/15 No. C.R.V.	11/15 No. C.R.V.
11/22 No. C.R.V.	11/22 No. C.R.V.

DISTRIBUTION BOX, LEVEL \_\_\_\_\_

TRENCH FIELD, DEPTH 10 avg. FT. TRENCH WIDTH 2 FT.

GRAVEL DEPTH \_\_\_\_\_ IN. TOTAL LENGTH 61 1/2 FT.

at times of inspection 11/22/78  
at times of inspection 11/15/78

NUMBER OF TRENCHES 1 TOTAL BOTTOM AREA \_\_\_\_\_

SEEPAGE PITS, INSIDE DIAMETER 41 FT. DEPTH BELOW INLET 6' + FT. (1)

ABSORBENT AREA \_\_\_\_\_ SQ. FT.

REMARKS 11/15/78 P.M. (1) at site no pipe in manholes; (2) No man in anywhere; (3) Tank in no cleanouts; (4) Drywell block in only; (5) Hole with cover and pipe of dirt outside trench. Inside of dry well was dived. Partial only. (Watch out for electric wires over + on ground near trench) (11/15/78)

P.M. 11/22/78 (1) 19' ok for trench more of trench ins. (2) ok to covers from tank to drywell. (3) saw Mr. Lambson at site (he is to call in on rec'd of job c. B.S. Partial) - P. only

DATE SYSTEM APPROVED \_\_\_\_\_ INSPECTOR \_\_\_\_\_

Hold for F.F. + Mr. Lambson

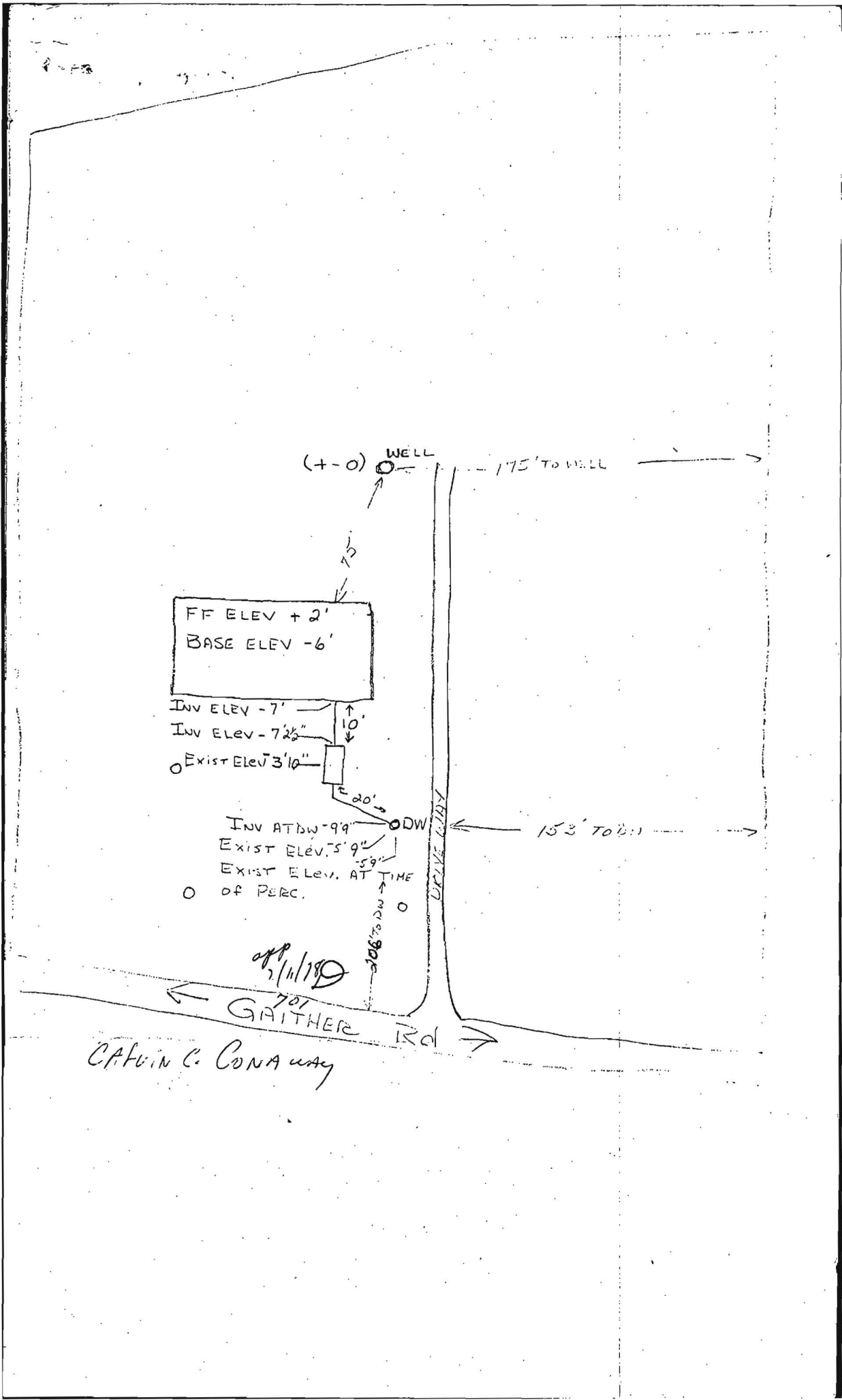

# Fyock Septic Service, Inc.

# Invoice

PO Box 89  
 Glenelg, MD. 21737  
 Phone #            Fax #  
 410-988-9270 410-531-1256

Date	Invoice #
10-17-2005	10028936

<b>Bill To</b>
Rob Conaway 701 Gaither Rd Sykesville Md 21784

<b>Service location</b>
Y.....20 Ft Morning

Customer Phone	410-489-4973	Customer Contact	Rob Conaway
Rep	Frequency	Last Serviced	Terms
B-P		10/17/2005	Due on receipt
			Due Date
			10/17/2005
			P.O. No

Item	Description	Rate	Mileage	Date Serviced	Payment	County	Amount
Contract...	Home Owner Septic Pump	140.00		10/17/2005		Howard	140.00
Fuel Sur...	Fuel Surcharge	10.00					10.00
<p><i>dm</i></p> <p><i>Pd.</i></p> <p><i>CK # 244</i></p> <p><i>Septic tank size (1250 gal.)</i></p> <p><i>Dpm</i></p>							
						<b>Total</b>	\$150.00

Thank you for your business.	Make Checks payable to: FYOCK We accept Visa and MasterCard
------------------------------	--

Notice To Customer: I understand that Fyock Septic Service is NOT responsible for any damage to driveway or lawn while rendering services on the above property.

Customer Signature: \_\_\_\_\_