

PUB. SEWER STATUS VERIFIED BY _____

ISSUE DATE: 11/15/05

P 523662

APPROVAL DATE: 3/13/06

A REPAIR

PERMIT INDEXED

TAX ID# 04-313615

ON-SITE SEWAGE DISPOSAL SYSTEM HOWARD COUNTY HEALTH DEPARTMENT BUREAU OF ENVIRONMENTAL HEALTH

Jenkins Brothers IS PERMITTED TO INSTALL ALTER

ADDRESS: 7670 Smiths Private Road, Sykesville PHONE NUMBER: 410-781-7133

SUBDIVISION: _____ LOT NUMBER: 3-A

ADDRESS: 14846 Bushy Park Road PROPERTY OWNER: Paul Dorsey

SEPTIC TANK CAPACITY (GALLONS): 1000 compartmented

PUMP CHAMBER CAPACITY (GALLONS): N/A

NUMBER OF BEDROOMS: 2 - calculated for 3

SQUARE FEET PER BEDROOM: 210

LINEAR FEET OF TRENCH REQUIRED: 105

TRENCHES:	Trench to be <u>3</u> feet wide. Inlet <u>1/2</u> feet below original grade. Bottom maximum depth <u>8</u> feet below original grade. Effective area begins at <u>5</u> feet below original grade. <u>3 1/2</u> feet of stone below distribution pipe.
LOCATION:	<u>2 x 5 1/2'</u> trenches behind garage with the lowest running through perc hole (A) Abandon existing system - Stay >
PURPOSE:	Existing septic system has failed. Call for inspection when ground is opened so sanitarian can recommend repair. <u>100'</u> from neighbor well

PLANS APPROVED: GABRIEL A. CREIGHTON (GAC) DATE: 12/14/05 neighbor well

- NOTE: PERMIT VOID AFTER 2 YEARS
- NOTE: CONTRACTOR RESPONSIBLE FOR SCHEDULING A PRE-CONSTRUCTION INSPECTION FOR ALL INSTALLATIONS
- NOTE: WATERTIGHT SEPTIC TANKS REQUIRED
- NOTE: ALL PARTS OF SEPTIC SYSTEM SHALL BE 100 FEET FROM ANY WATER WELL
- NOTE: MANHOLE RISERS REQUIRED ON ALL SEPTIC TANKS AND PUMP CHAMBERS

NEITHER THE HOWARD COUNTY COUNCIL OR THE HEALTH DEPARTMENT IS RESPONSIBLE FOR THE SUCCESSFUL OPERATION OF ANY SYSTEM PERMITTEE RESPONSIBLE FOR OBTAINING FINAL APPROVAL ON THIS PERMIT CALL 410-313-2640 FOR INSPECTION OF SEPTIC SYSTEM

P523662

NOT TO SCALE **BUSHY PARK**

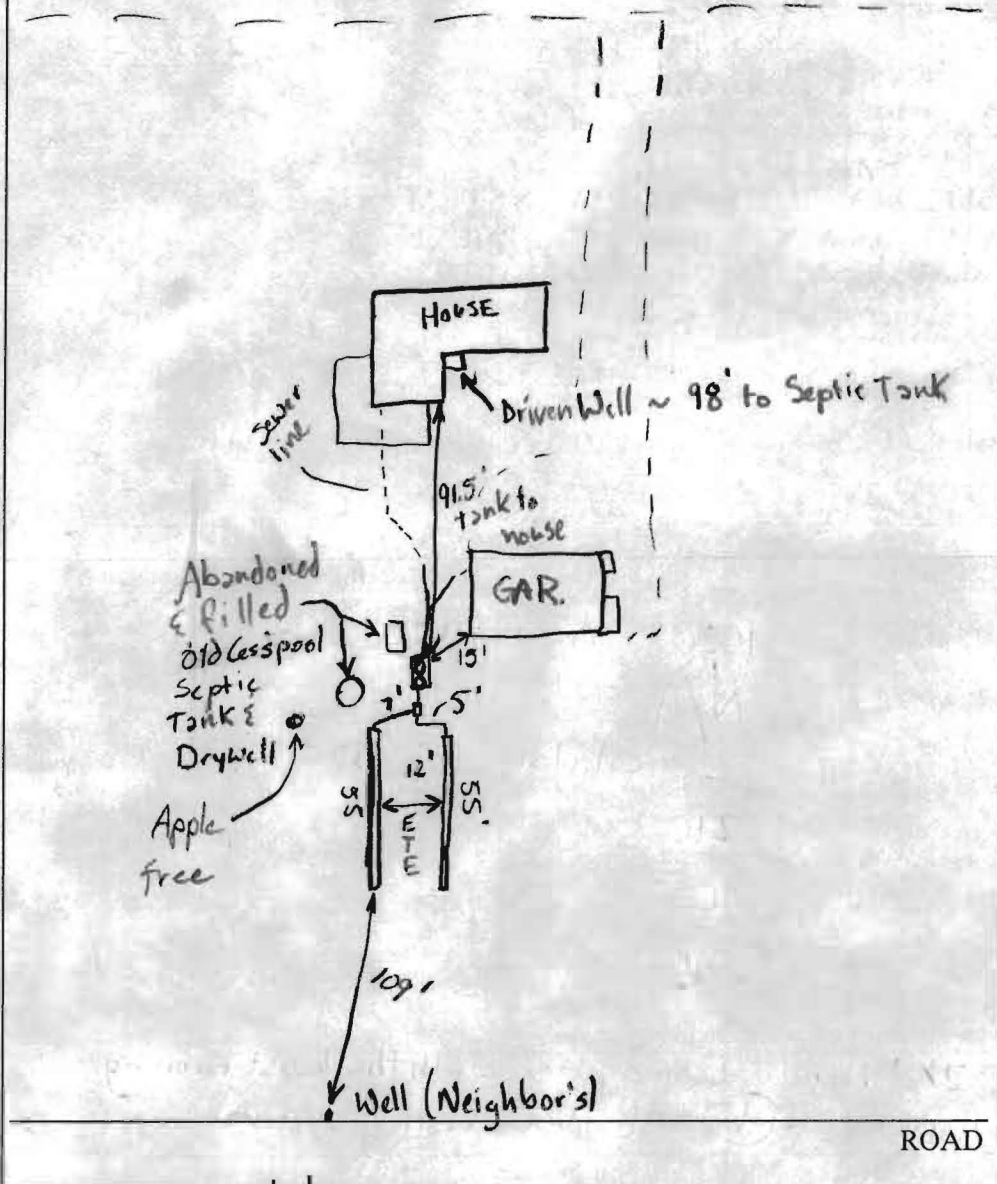

TRENCH/DRAINFIELD DATA		
WIDTH	INLET	BOTTOM
3'	4	8
NUMBER OF TRENCHES	2	
TOTAL LENGTH	110	
ABSORPTION AREA		
DISTRIBUTION BOX LEVEL	Yes	
DISTRIBUTION BOX BAFFLE	No	
DISTRIBUTION BOX PORT	No	

SEPTIC TANK DATA	
SEPTIC TANK 1 LEVEL	Yes
CAPACITY	1500 GAL
SEAM LOC	Top
TANK LID DEPTH	1 1/2'
BAFFLES	yes In & Out Mid
BAFFLE FILTER	built
MANHOLE LOC	Inlet & Outlet
6" PORT LOC	
WATERTIGHT TEST	
SEPTIC TANK 2 LEVEL	
CAPACITY	GAL
SEAM LOC	
TANK LID DEPTH	
BAFFLES	
BAFFLE FILTER	
MANHOLE LOC	
6" PORT LOC	
WATERTIGHT TEST	

12/9/05
 PRE-CONSTRUCTION Install approx. 2 x 52.5' trenches on contour
 Maintaining > 100' from neighbor's well and try and get septic tank
 INSTALLATION outside of 100' well radius if possible (for this house). (GAC)
 3/13/06 Installed ok per instruction at time of perc. (GAC) OK to cover

FINAL INSPECTOR Samuel A. Creighton DATE OF APPROVAL 3/13/06

SITE INSPECTION SHEET

OWNER: Paul Dorsey PHONE #: _____
 ADDRESS: 14846 Bushy Park CONTRACTOR: _____
 _____ WELL TAG #: _____
 SUBDIVISION: _____ LOT: _____ COUNTY #: _____
 PROPOSAL: Repair failing Septic System

LOCATION DIAGRAM

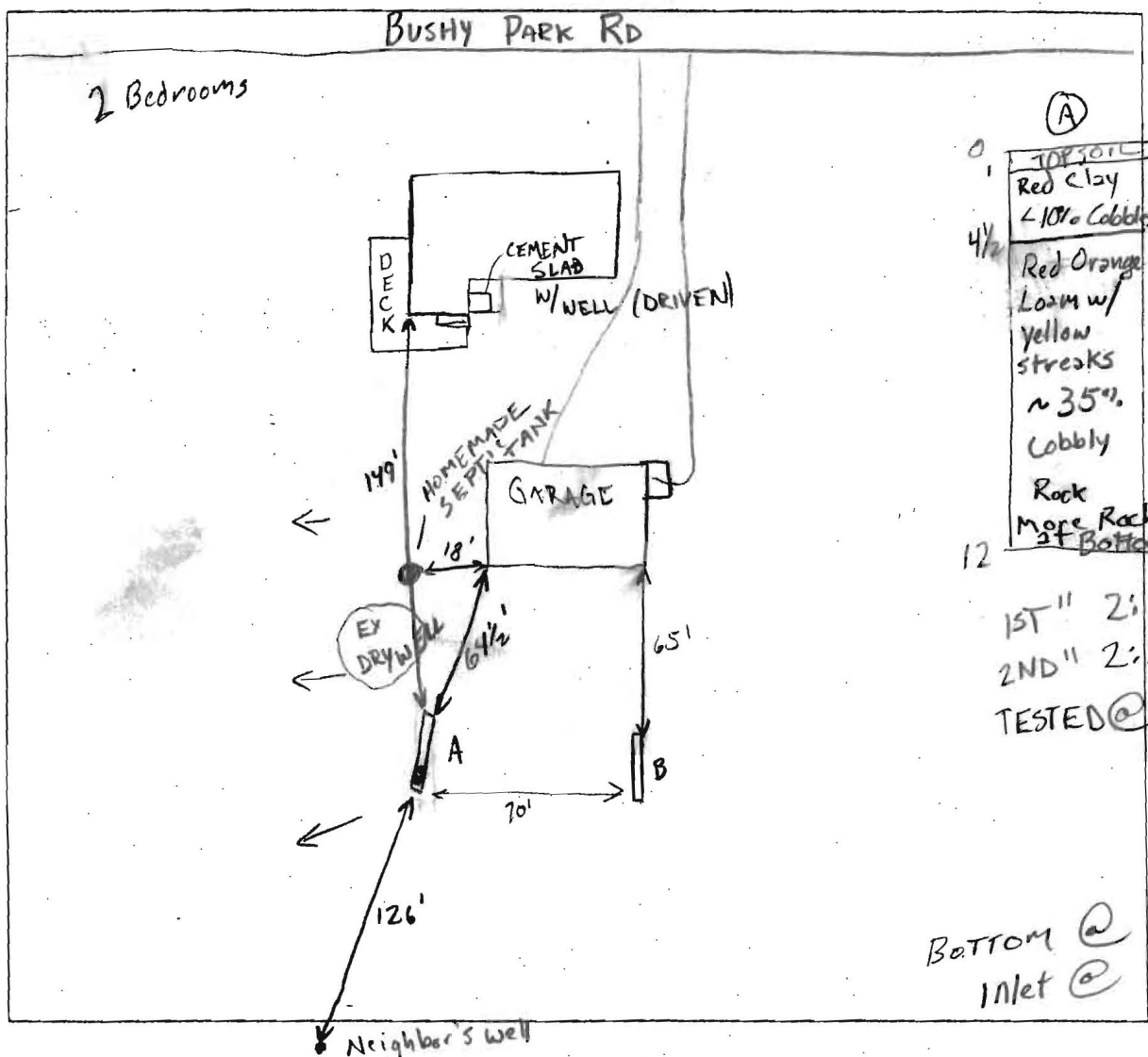

ⓐ

0	TOP SOIL
1	Red Clay
4 1/2	~ 10% Cobble
12	Red Orange Loam w/ yellow streaks ~ 35% Cobble Rock
11	more rock @ BOTTOM HARD BOTTOM

ⓑ

0	Red Clay loam
4	Red Orange loam ~ 35% Cobble Rock
11	more rock @ BOTTOM HARD BOTTOM

1ST" 2:17 - 2:22
 2ND" 2:22 - 2:32
 TESTED @ 5'

Bottom @ 8'
 Inlet @ 4 1/2'

COMMENTS: _____

$210 \times 3 = 630 / 3 = 210 \times .5 = 105 \quad 2 \times 52.5$

ⓐ Rock in hole NEW SEPTIC TANK 1000 gal 2 compartment is not prohibitive ⓐ

DATE: _____ INSPECTOR: _____