

COUNTY #

SOIL PROFILE
0' (703)

Red Br Cl Loam 2.5'-3.5'
Med Br Sa Loam
Trace Rock
Caving Water 10'
11'

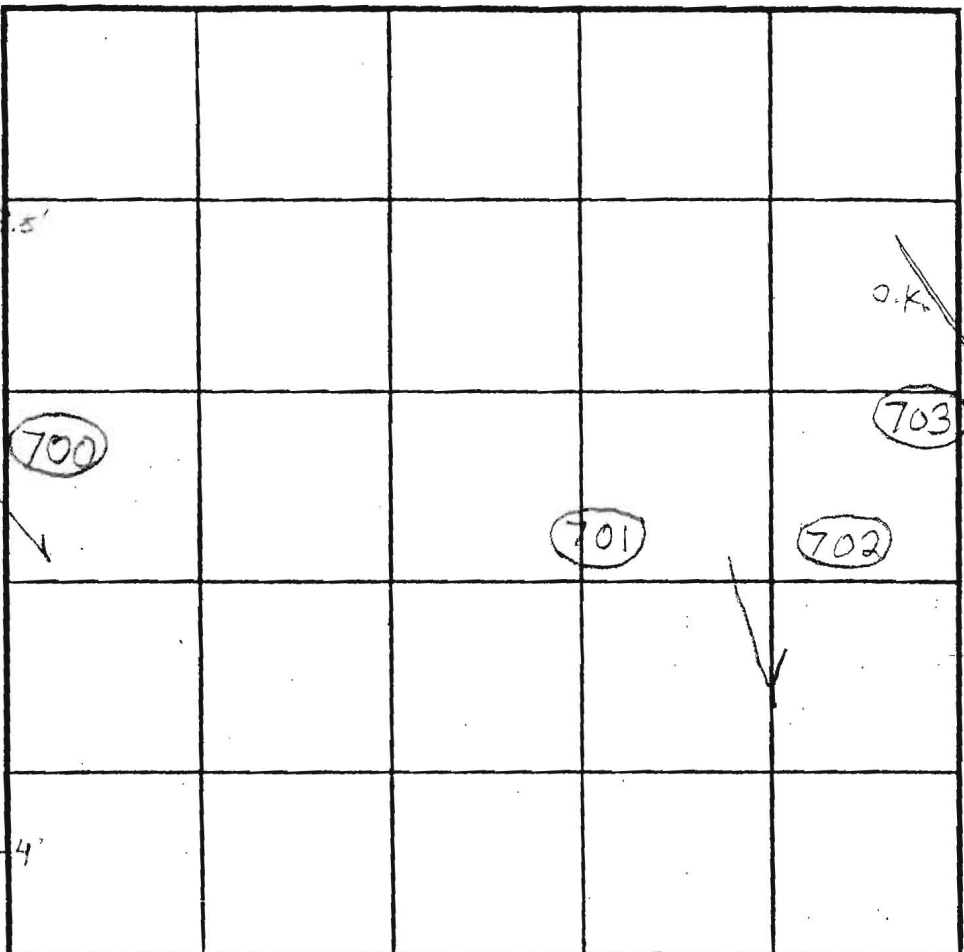

SOIL PROFILE
0' (700)

Red Br Cl Loam 4'-4.5'
Red Br Si Cl Loam and Beige Sa Loam 3.5'
Beige Sa Loam
10-15% Rock
Caving Mottling Water 10.5'
11'

(702)

Red Br Cl Loam 3.5'-4'
Med Br Sa Loam
Trace Rock
Caving Water 10'
10.5'

INDICATE NORTH - NAME ADJOINING ROADWAY AS BASE LINE.

(701)

Red Br Cl Loam; 20% Rock 4.5'
Red Br Si Cl Loam 5'-5.5'
Tan Sa Loam
Trace Rock
Caving Water 2'
13'

DATE	TEST NO.	DEPTH	PRE-WET		TEST - 1" DROP		TIME	
			START	STOP	START	STOP		
6/3/2004	703	4' 11" V	1:21:15	1:22:25	1:22:25	1:24:15	~2	O.K.
	702	10' V						O.K.
	701	5' 3" / 13' V	1:48					Slow O.K.
		5' 9"	1:52	2:06	2:06	2:30	24	
	700	5' 8" / 11" V	2:06	2:09:30	2:09:30	2:14:30	5	(F)
Must Retest Hole 220 To Determine Usability - Must Perc Shallower								

REMARKS 701 in Swale - Fails

TYPE OF SOIL _____

TESTED BY B. Baker ALSO PRESENT _____

TRENCH DESIGN DATA: AVERAGE PERCOLATION TIME _____ TRENCH WIDTH _____

INLET DEPTH _____ MAXIMUM BOTTOM DEPTH _____