

APPLICATION

SEWAGE DISPOSAL TESTING

STATE OF MARYLAND · DEPARTMENT OF HEALTH AND MENTAL HYGIENE

A 32937

P _____

HOWARD COUNTY HEALTH DEPARTMENT
ENVIRONMENTAL HEALTH SERVICES

P O BOX 473 ELLICOTT CITY, MARYLAND 21043
TELEPHONE 932-2330

DISTRICT 3rd

DATE 10/4/83

TO: THE COUNTY HEALTH OFFICER
ELLICOTT CITY, MARYLAND

I, HEREBY, APPLY FOR THE NECESSARY TEST IN ORDER TO CONSTRUCT (OR RECONSTRUCT) A SEWAGE DISPOSAL SYSTEM.

PROPERTY OWNER WILLIAM M. HAWICE

ADDRESS 7148 LASTINE LIGHTWAY COLUMBIA, MO. 21045 PHONE 465-7777 BOENDER ASSOC.

PROPERTY LOCATION:

SUBDIVISION HAWKES LANDING LOT NO. 9

ROAD AND DESCRIPTION MO. RTE. 32 (WEST SIDE), 4400' ± TO BEGINNING OF SITE
FROM OLD FREDERICK RD. (NORTH)

SIZE OF LOT 3 ACRES TYPE BLDG. 3/4
(NUMBER OF BEDROOMS)

THE SYSTEM INSTALLED UNDER THIS APPLICATION IS ACCEPTABLE ONLY UNTIL PUBLIC FACILITIES BECOME AVAILABLE. I FULLY UNDERSTAND THE FEE CONNECTED WITH THE FILING OF THIS PERC TEST APPLICATION IS NON-REFUNDABLE UNDER ANY CIRCUMSTANCES. I ALSO AGREE TO COMPLY WITH ALL M.O.S.H.A. REQUIREMENTS IN TESTING THIS LOT.

John J. Benford (agent)
(SIGNATURE OF APPLICANT)

APPROVED BY _____ FOR _____ DATE _____

REJECTED BY _____ FOR _____ DATE _____

HOLD PENDING FURTHER TESTS _____ DATE _____

REASONS FOR REJECTION OR HOLDING _____

THIS IS NOT A PERMIT

1430 Coventry Meadows

LOT 9

① SOIL PROFILE

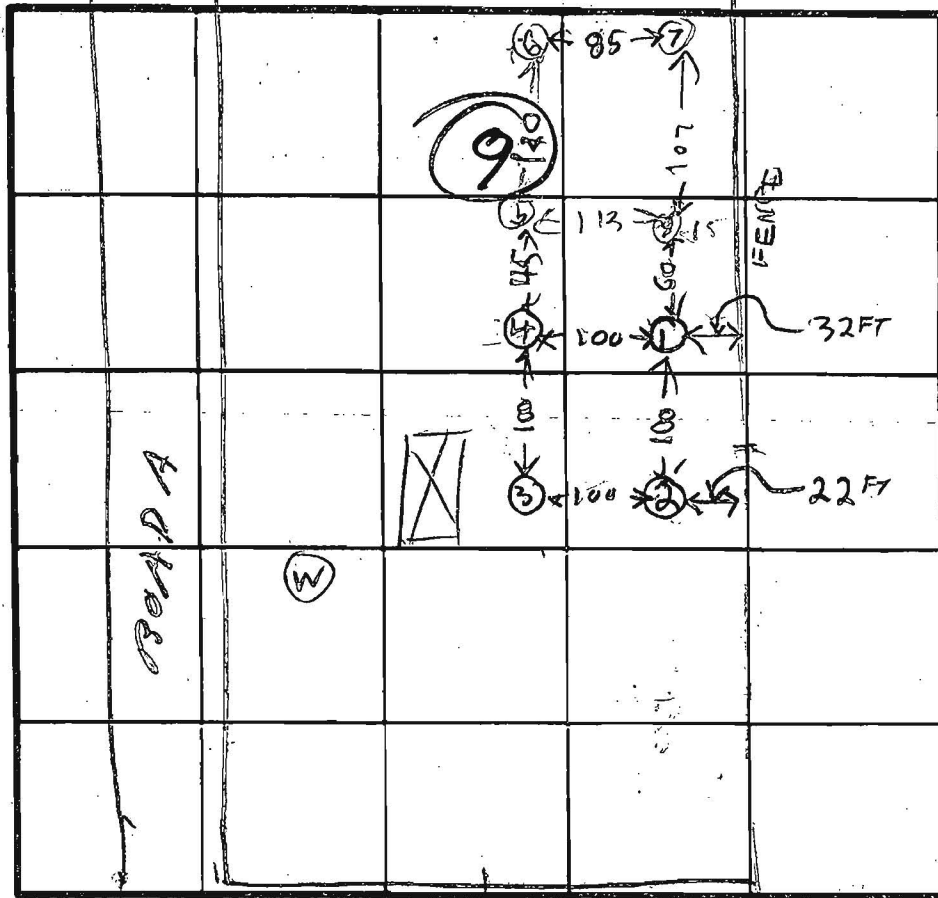
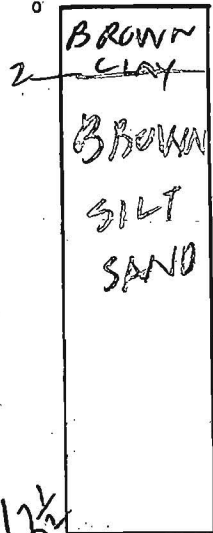

INDICATE NORTH - NAME ADJOINING ROADWAY AS BASE LINE.

SHALLOW
 $\bar{x} = 2 \text{ min}$
 Inlet = 2.0 ft
 Bottom = 4.0 ft
 180 sq ft/ bdrn
 Ho 88
 2049

15
7

HOLE ELEVATION

③ HIGH

①② LOW

Dry Well at ③ (woods)

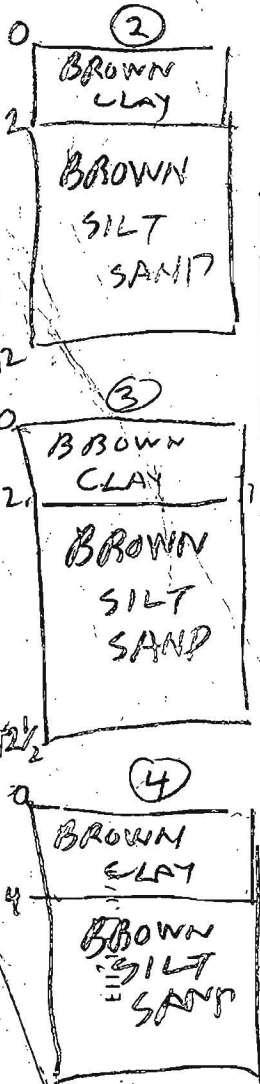

DATE	TEST NO.	DEPTH	PRE-WET		TEST - 1" DROP		TIME
			START	STOP	START	STOP	
10/18/83	1S	4	216	217	217	219	2
	1V	12 1/2	LOOKS		OK		
	2S	4	221	222	222	223	1
	2V	12	LOOKS		OK		
	3S	3 1/2	229	230	230	231	1
	3V	12 1/2	LOOKS		OK		
	4V	13	LOOKS		OK		

REMARKS HOLES LOCATED PER PLAT RH

TYPE OF SOIL _____

TESTED BY B. HODGES

ALSO PRESENT JOHN & SKIP OFFLOCK