



# Building Permit Application

Howard County Maryland  
Department of Inspections, Licenses and Permits  
3430 Court House Drive  
Permits: 410-313-2455  
www.howardcountymd.gov

Date Received: 12-3-14

Permit No.: B14004394

see  
B14003388

Building Address: 7500 Greenwood Dr  
 City: Highland State: md Zip Code: 20227  
 Suite/Apt. # \_\_\_\_\_ SDP/WP/BA #: \_\_\_\_\_  
 Census Tract: \_\_\_\_\_ Subdivision: \_\_\_\_\_  
 Section: \_\_\_\_\_ Area: \_\_\_\_\_ Lot: \_\_\_\_\_  
 Tax Map: \_\_\_\_\_ Parcel: \_\_\_\_\_ Grid: \_\_\_\_\_  
 Zoning: \_\_\_\_\_ Map Coordinates: \_\_\_\_\_ Lot Size: \_\_\_\_\_

Property Owner's Name: Richard Sigurdson  
 Address: 7500 Greenwood Dr  
 City: Highland State: md Zip Code: 20227  
 Phone: 340 655 5469 Fax: \_\_\_\_\_  
 Email: \_\_\_\_\_

**Applicant's Name & Mailing Address, (if other than stated herein)**  
 Applicant's Name: Michael Gehring  
 Address: 2115 Benson Mill Rd  
 City: SMPS State: md Zip Code: 21152  
 Phone: 410-502-3909 Fax: \_\_\_\_\_  
 Email: H

Existing Use: None  
 Proposed Use: To Build a front porch  
 Estimated Construction Cost: \$ 18,000.00  
 Description of Work: Build a 38x7 front porch with a 3/2 shed roof over top with slip in grade  
 Occupant or Tenant: \_\_\_\_\_  
 Was tenant space previously occupied?  Yes  No  
 Contact Name: \_\_\_\_\_  
 Address: \_\_\_\_\_  
 City: \_\_\_\_\_ State: \_\_\_\_\_ Zip Code: \_\_\_\_\_  
 Phone: \_\_\_\_\_ Fax: \_\_\_\_\_  
 Email: \_\_\_\_\_

Contractor Company: Green Solution Remodeling  
 Contact Person: IRA LUBITS  
 Address: 5200 Cleardin Rd  
 City: 11600 Aris State: md Zip Code: 21057  
 License No.: 3  
 Phone: 410-502-3909 Fax: 410-510-7173  
 Email: Hendalibob@aol.com

Engineer/Architect Company: \_\_\_\_\_  
 Responsible Design Prof.: \_\_\_\_\_  
 Address: \_\_\_\_\_  
 City: \_\_\_\_\_ State: \_\_\_\_\_ Zip Code: \_\_\_\_\_  
 Phone: \_\_\_\_\_ Fax: \_\_\_\_\_  
 Email: \_\_\_\_\_

Commercial Building Characteristics	Residential Building Characteristics	
Height:	<input checked="" type="checkbox"/> SF Dwelling <input type="checkbox"/> SF Townhouse	
No. of stories:	Depth	Width
Gross area, sq. ft./floor:	1 <sup>st</sup> floor:	
	2 <sup>nd</sup> floor:	
Area of construction (sq. ft.):	Basement:	
	<input type="checkbox"/> Finished Basement	
Use group:	<input type="checkbox"/> Unfinished Basement	
	<input type="checkbox"/> Crawl Space	
<b>Construction type:</b>	<input type="checkbox"/> Slab on Grade	
<input checked="" type="checkbox"/> Reinforced Concrete	No. of Bedrooms:	
<input checked="" type="checkbox"/> Structural Steel	<b>Multi-family Dwelling</b>	
<input type="checkbox"/> Masonry	No. of efficiency units:	
<input type="checkbox"/> Wood Frame	No. of 1 BR units:	
<input type="checkbox"/> State Certified Modular	No. of 2 BR units:	
	No. of 3 BR units:	
	Other Structure:	
	Dimensions:	
<input checked="" type="checkbox"/> <b>Roadside Tree Project Permit</b>	Footings:	
<input type="checkbox"/> Yes <input checked="" type="checkbox"/> No	Roof:	
<b>Roadside Tree Project Permit #</b>	<input type="checkbox"/> State Certified Modular	
	<input type="checkbox"/> Manufactured Home	

Utilities	
<b>Water Supply</b>	
<input type="checkbox"/> Public	
<input checked="" type="checkbox"/> Private	
<b>Sewage Disposal</b>	
<input type="checkbox"/> Public	
<input checked="" type="checkbox"/> Private	
Electric: <input type="checkbox"/> Yes <input type="checkbox"/> No	
Gas: <input type="checkbox"/> Yes <input type="checkbox"/> No	
<b>Heating System</b>	
<input type="checkbox"/> Electric <input type="checkbox"/> Oil	
<input checked="" type="checkbox"/> Natural Gas <input type="checkbox"/> Propane Gas	
<input type="checkbox"/> Other:	
<b>Sprinkler System:</b>	
<input type="checkbox"/> Yes <input checked="" type="checkbox"/> No	
Grading Permit Number:	
Building Shell Permit Number:	

THE UNDERSIGNED HEREBY CERTIFIES AND AGREES AS FOLLOWS: (1) THAT HE/SHE IS AUTHORIZED TO MAKE THIS APPLICATION; (2) THAT THE INFORMATION IS CORRECT; (3) THAT HE/SHE WILL COMPLY WITH ALL REGULATIONS OF HOWARD COUNTY WHICH ARE APPLICABLE THERETO; (4) THAT HE/SHE WILL PERFORM NO WORK ON THE ABOVE REFERENCED PROPERTY NOT SPECIFICALLY DESCRIBED IN THIS APPLICATION; (5) THAT HE/SHE GRANTS COUNTY OFFICIALS THE RIGHT TO ENTER ONTO THIS PROPERTY FOR THE PURPOSE OF INSPECTING THE WORK PERMITTED AND POSTING NOTICES.

Applicant's Signature: Michael Gehring Print Name: MICHAEL GEHRING  
 Email Address: Hendalibob@aol.com Date: 12/3/2014  
 Title/Company: \_\_\_\_\_

Checks Payable to: DIRECTOR OF FINANCE OF HOWARD COUNTY  
 \*\*PLEASE WRITE NEATLY & LEGIBLY\*\*  
 -FOR OFFICE USE ONLY-

AGENCY	DATE	SIGNATURE OF APPROVAL
State Highways		
Building Officials		
PSZA (Zoning)		
PSZA (Engineering)		
Health	<u>12-14-14</u>	<u>D. Bernard</u>

Is Sediment Control approval required for issuance?  Yes  No  
 CONTINGENCY CONSTRUCTION START

DPZ SETBACK INFORMATION	
Front:	
Rear:	
Side:	
Side St.:	
All minimum setbacks met?	<input type="checkbox"/> Yes <input type="checkbox"/> No
Is Entrance Permit Required?	<input type="checkbox"/> Yes <input type="checkbox"/> No
Historic District?	<input type="checkbox"/> Yes <input type="checkbox"/> No
Lot Coverage for New Town Zone:	
SDP/Red-line approval date:	

Filing Fee	\$ <u>25</u>
Permit Fee	\$
Tech Fee	\$
Excise Tax	\$
PSFS	\$
Guaranty Fund	\$
Add'l per Fee	\$
Total Fees	\$
Sub-Total Paid	\$
Balance Due	\$
Check	# <u>2923</u>

**LANDTECH ASSOCIATES, INC.**

10260 OLD COLUMBIA ROAD SUITE J  
 COLUMBIA, MARYLAND 21046-1721  
 PHONE: 410-290-8099 TOLL FREE: 888-290-1920  
 FAX: 410-290-8299 TOLL FREE 888-290-1922

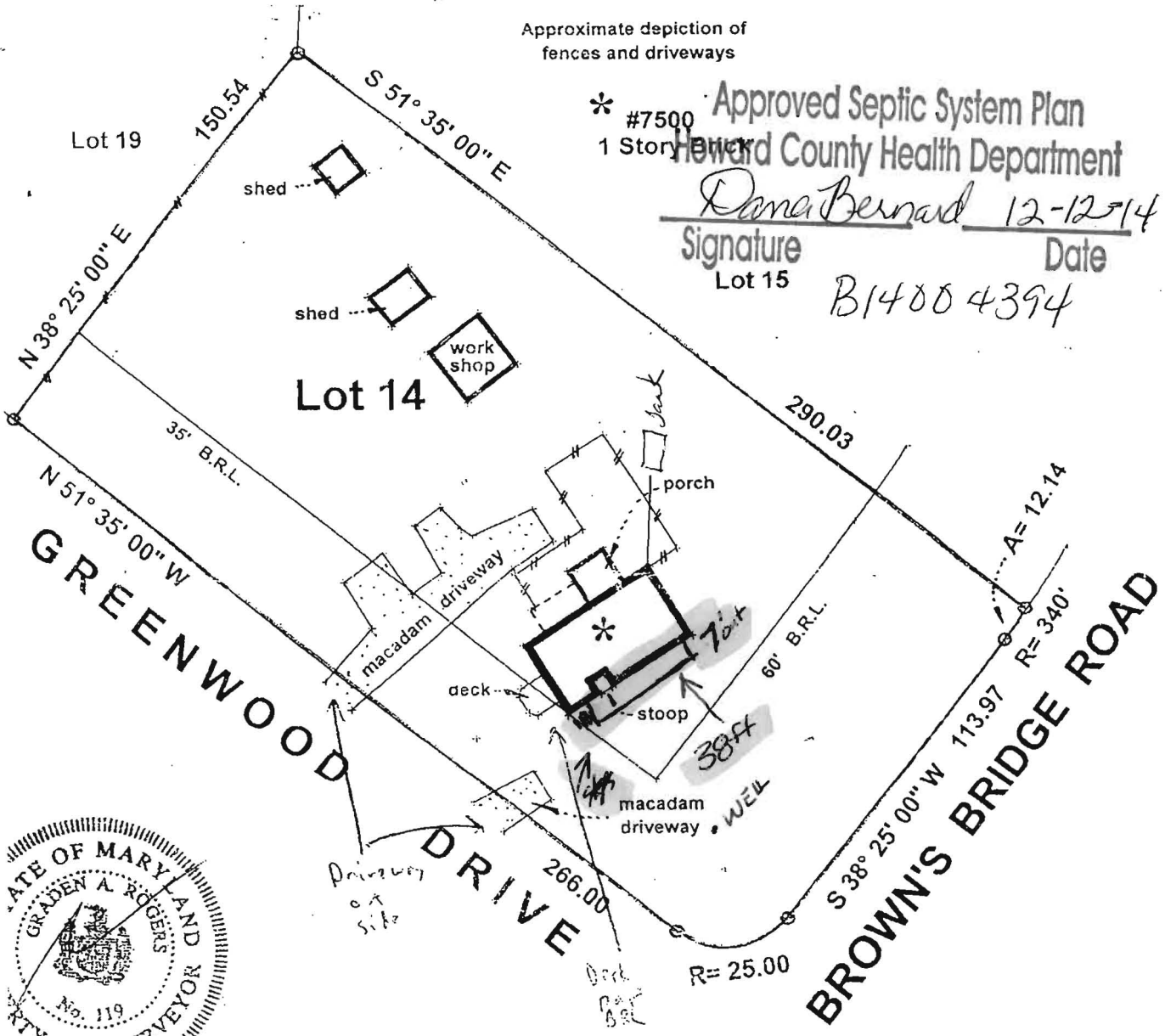

Approximate depiction of fences and driveways

\* #7500  
 1 Story House  
 Approved Septic System Plan  
 Howard County Health Department  
 Dana Bernard 12-12-14  
 Signature Date  
 Lot 15 B1400 4394



Location Survey of:	LOT: 14	BLOCK: none
#7500 Greenwood Drive	PLAT BK: 5	PLAT#: 28
SECTION TWO GREENWOOD FARMS Howard County, MD	DATE: 9-07-06	SCALE: 1"= 50'
	CASE NUMBER: 3840-06-05405	
	FILE NUMBER: LT-2064093	