

LAYOUT _____ INSP 4 _____

INSP 2 _____ INSP 5 _____

INSP 3 _____ INSP 6 _____

ISSUE DATE: 10/06/2005

P 523442

APPROVAL DATE: _____

A 519622

PERMIT

TAX ID #03-383861

**ON-SITE SEWAGE DISPOSAL SYSTEM
HOWARD COUNTY HEALTH DEPARTMENT
BUREAU OF ENVIRONMENTAL HEALTH**

Fogle's Septic Clean IS PERMITTED TO INSTALL ALTER

ADDRESS: 580 Obrecht Rd., Sykesville 21784 PHONE NUMBER: 410-795-5670

SUBDIVISION: Gibbons Property, Parcel B LOT NUMBER: Pool House

ADDRESS: 4580 Centennial Lane PROPERTY OWNER: Brian & Martha Gibbons

SEPTIC TANK CAPACITY (GALLONS): 1500 OUTLET BAFFLE FILTER REQUIRED

PUMP CHAMBER CAPACITY (GALLONS): n/a COMPARTMENTED TANK REQUIRED

NUMBER OF BEDROOMS: 0

SQUARE FEET PER BEDROOM: n/a

LINEAR FEET OF TRENCH REQUIRED: existing HOUSE SERVED BY PUBLIC WATER

TRENCHES:	Tie line from septic tank for pool house to existing septic system trenches.
LOCATION:	Install 1500 gallon septic tank for pool house and tie into the existing septic tank or distribution box.
NOTES:	Purpose of permit is to install a septic tank for the pool house. Call for inspection once the new septic tank is in place & tied into existing septic system.

PLANS APPROVED: Peter Yencsik Reviewed by: _____ DATE: 10/14/05

NOTES: PERMIT VOID AFTER 2 YEARS
CONTRACTOR IS RESPONSIBLE FOR SCHEDULING A PRE-CONSTRUCTION INSPECTION FOR ALL INSTALLATIONS
WATERTIGHT SEPTIC TANKS REQUIRED
ALL PARTS OF SEPTIC SYSTEM SHALL BE 100 FEET FROM ANY WATER WELL UNLESS SPECIFICALLY AUTHORIZED
MANHOLE RISERS REQUIRED ON ALL SEPTIC TANKS AND PUMP CHAMBERS UNLESS SPECIFICALLY AUTHORIZED
CONTRACTOR RESPONSIBLE FOR COMPLIANCE WITH APPLICABLE REGULATIONS, GUIDELINES AND THE TERMS OF THIS PERMIT

**NEITHER THE HOWARD COUNTY COUNCIL NOR THE HEALTH DEPARTMENT IS
RESPONSIBLE FOR THE SUCCESSFUL OPERATION OF ANY SYSTEM
PERMITTEE RESPONSIBLE FOR OBTAINING FINAL APPROVAL ON THIS PERMIT
ALL 410-313-1771 FOR INSPECTION OF SEPTIC SYSTEM**

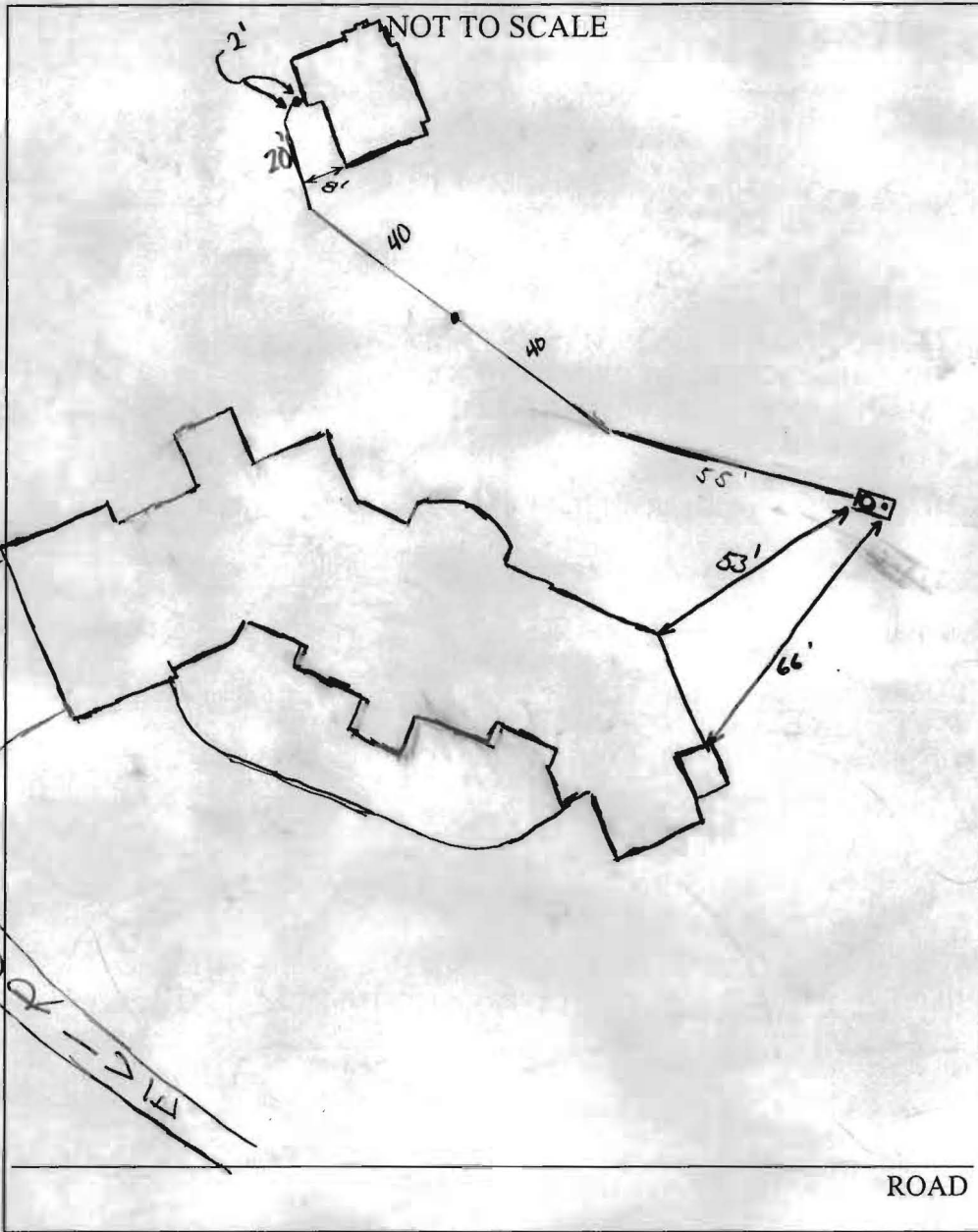

TRENCH/DRAINFIELD DATA

WIDTH	INLET	BOTTOM
_____	_____	_____
NUMBER OF TRENCHES _____		
TOTAL LENGTH _____		
ABSORPTION AREA _____		
DISTRIBUTION BOX LEVEL _____		
DISTRIBUTION BOX BAFFLE _____		
DISTRIBUTION BOX PORT _____		

SEPTIC TANK DATA

SEPTIC TANK 1 LEVEL _____

CAPACITY 1500 GAL

SEAM LOC Top

TANK LID DEPTH 2-3'

BAFFLES 4

BAFFLE FILTER No

MANHOLE LOC Inlet

6" PORT LOC Outlet

WATERTIGHT TEST N/A

~~SEPTIC TANK 2 LEVEL _____~~

~~CAPACITY _____ GAL~~

~~SEAM LOC _____~~

~~TANK LID DEPTH _____~~

~~BAFFLES _____~~

~~BAFFLE FILTER _____~~

~~MANHOLE LOC _____~~

~~6" PORT LOC _____~~

~~WATERTIGHT TEST _____~~

PRE-CONSTRUCTION _____

INSTALLATION _____

FINAL INSPECTOR _____ DATE OF APPROVAL _____

LAYOUT _____ INSP 4 _____
INSP 2 _____ INSP 5 _____
INSP 3 _____ INSP 6 _____

ISSUE DATE: 05/18/2005

PERMIT

P 522487

APPROVAL DATE: 1/18/06

A 519622

TAX ID #02-383861

**ON-SITE SEWAGE DISPOSAL SYSTEM
HOWARD COUNTY HEALTH DEPARTMENT
BUREAU OF ENVIRONMENTAL HEALTH**

Fogles Septic Clean, Inc IS PERMITTED TO INSTALL ALTER

ADDRESS: 580 Obrecht Rd, Sykesville PHONE NUMBER: 410-795-5670

SUBDIVISION: Gibbons Property LOT NUMBER: Parcel B

ADDRESS: 4580 Centennial Lane PROPERTY OWNER: Brian & Martha Gibbons

SEPTIC TANK CAPACITY (GALLONS): 1500 OUTLET BAFFLE FILTER REQUIRED

PUMP CHAMBER CAPACITY (GALLONS): N/A COMPARTMENTED TANK REQUIRED

NUMBER OF BEDROOMS: 5

SQUARE FEET PER BEDROOM: 210

LINEAR FEET OF TRENCH REQUIRED: 350 HOUSE SERVED BY PUBLIC WATER

TRENCHES:	Trench to be 3.0 feet wide. Inlet 4.0 feet below original grade. Bottom maximum depth 8.0 feet below original grade. Effective area begins at 7.5 feet below original grade. 4.0 feet of stone below distribution pipe.
LOCATION:	Place the distribution box at the highest elevation in the approved SDA. Run four 90' trenches on contour.
NOTES:	

PLANS APPROVED: Kevin J. Bell Reviewed by: _____ DATE: 9/29/04

NOTES: PERMIT VOID AFTER 2 YEARS
CONTRACTOR IS RESPONSIBLE FOR SCHEDULING A PRE-CONSTRUCTION INSPECTION FOR ALL INSTALLATIONS
WATERTIGHT SEPTIC TANKS REQUIRED
ALL PARTS OF SEPTIC SYSTEM SHALL BE 100 FEET FROM ANY WATER WELL UNLESS SPECIFICALLY AUTHORIZED
MANHOLE RISERS REQUIRED ON ALL SEPTIC TANKS AND PUMP CHAMBERS UNLESS SPECIFICALLY AUTHORIZED
CONTRACTOR RESPONSIBLE FOR COMPLIANCE WITH APPLICABLE REGULATIONS, GUIDELINES AND THE TERMS OF THIS PERMIT

**NEITHER THE HOWARD COUNTY COUNCIL NOR THE HEALTH DEPARTMENT IS
RESPONSIBLE FOR THE SUCCESSFUL OPERATION OF ANY SYSTEM
PERMITTEE RESPONSIBLE FOR OBTAINING FINAL APPROVAL ON THIS PERMIT
ALL 410-313-2640 FOR INSPECTION OF SEPTIC SYSTEM**

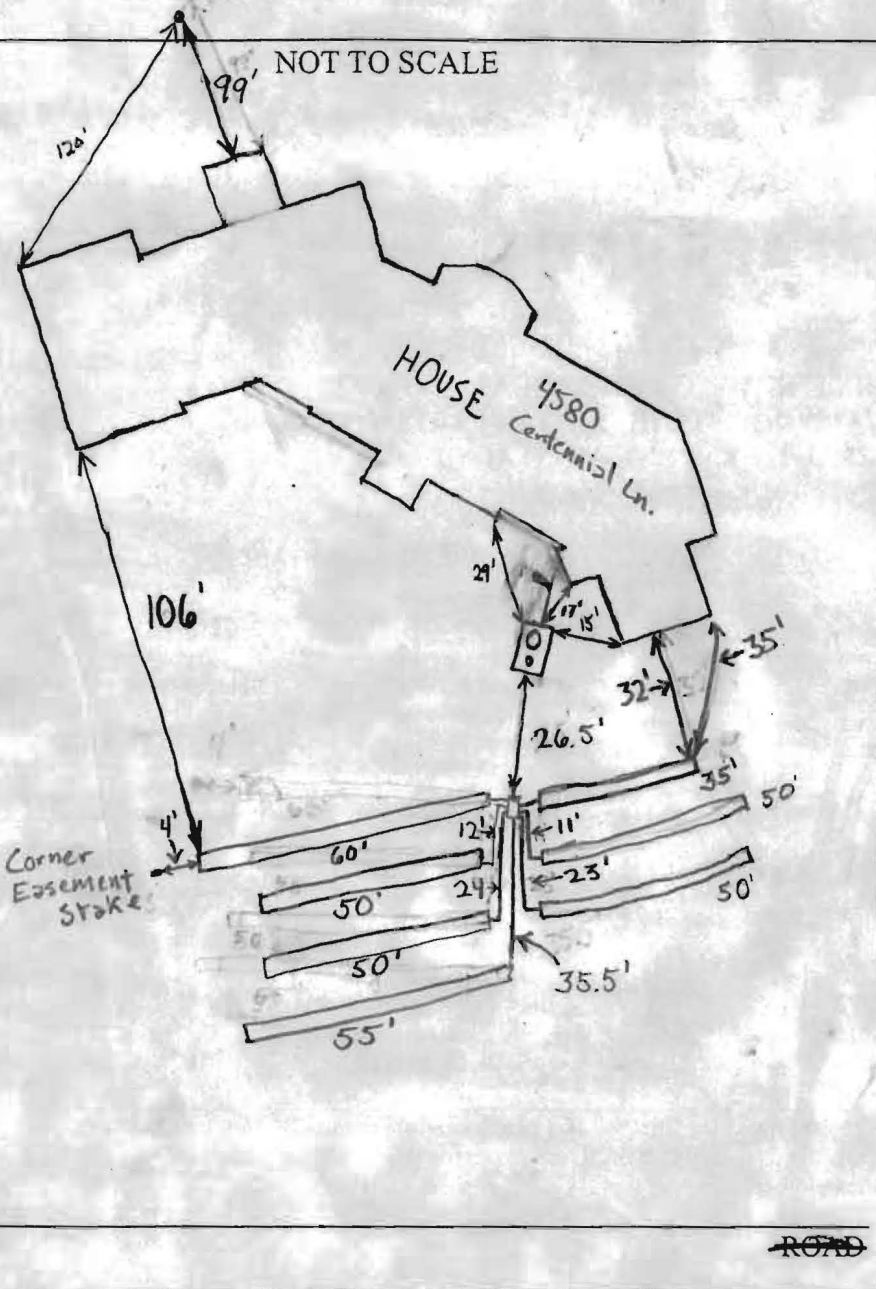

TRENCH/DRAINFIELD DATA		
WIDTH	INLET	BOTTOM
<u>3</u>	<u>4</u>	<u>8</u>
NUMBER OF TRENCHES		<u>7</u>
TOTAL LENGTH		<u>350</u>
ABSORPTION AREA		<u>1050 SF</u>
DISTRIBUTION BOX LEVEL		<u>Levelers</u>
DISTRIBUTION BOX BAFFLE		<u>Yes</u>
DISTRIBUTION BOX PORT		<u>No</u>

SEPTIC TANK DATA	
SEPTIC TANK 1 LEVEL	<u>Yes</u>
CAPACITY	<u>1500</u> GAL
SEAM LOC	<u>Top</u>
TANK LID DEPTH	<u>1.5-3'</u>
BAFFLES	<u>Yes</u>
BAFFLE FILTER	<u>No</u>
MANHOLE LOC	<u>Front</u>
6" PORT LOC	<u>Rear</u>
WATERTIGHT TEST	<u>N/A</u>
SEPTIC TANK 2 LEVEL	
CAPACITY _____ GAL	
SEAM LOC _____	
TANK LID DEPTH _____	
BAFFLES _____	
BAFFLE FILTER _____	
MANHOLE LOC _____	
6" PORT LOC _____	
WATERTIGHT TEST _____	

PRE-CONSTRUCTION D-Box to be in ^{Top} center of SDA to accommodate trenches both directions.

7 trenches on contour in both directions from D-Box.

INSTALLATION 5/23/05 Tank installed, no house connection. GAC 5/23/05 PM

Tank and Trenches installed as per instruction. Some area on left side of SDA (facing the House) not used. This area was under the driveway and use would have blocked the only access to site. Still no SHC. GAC 1/18/06 House connection made BB

FINAL INSPECTOR GAC & BB DATE OF APPROVAL 1/18/06

SITE INSPECTION SHEET

OWNER: Church PHONE #: _____
ADDRESS: 4580 Centennial Lane CONTRACTOR: _____
WELL TAG #: _____
SUBDIVISION: _____ LOT: _____ COUNTY #: _____
PROPOSAL: Septic tank to tie pool house into ex. system

LOCATION DIAGRAM

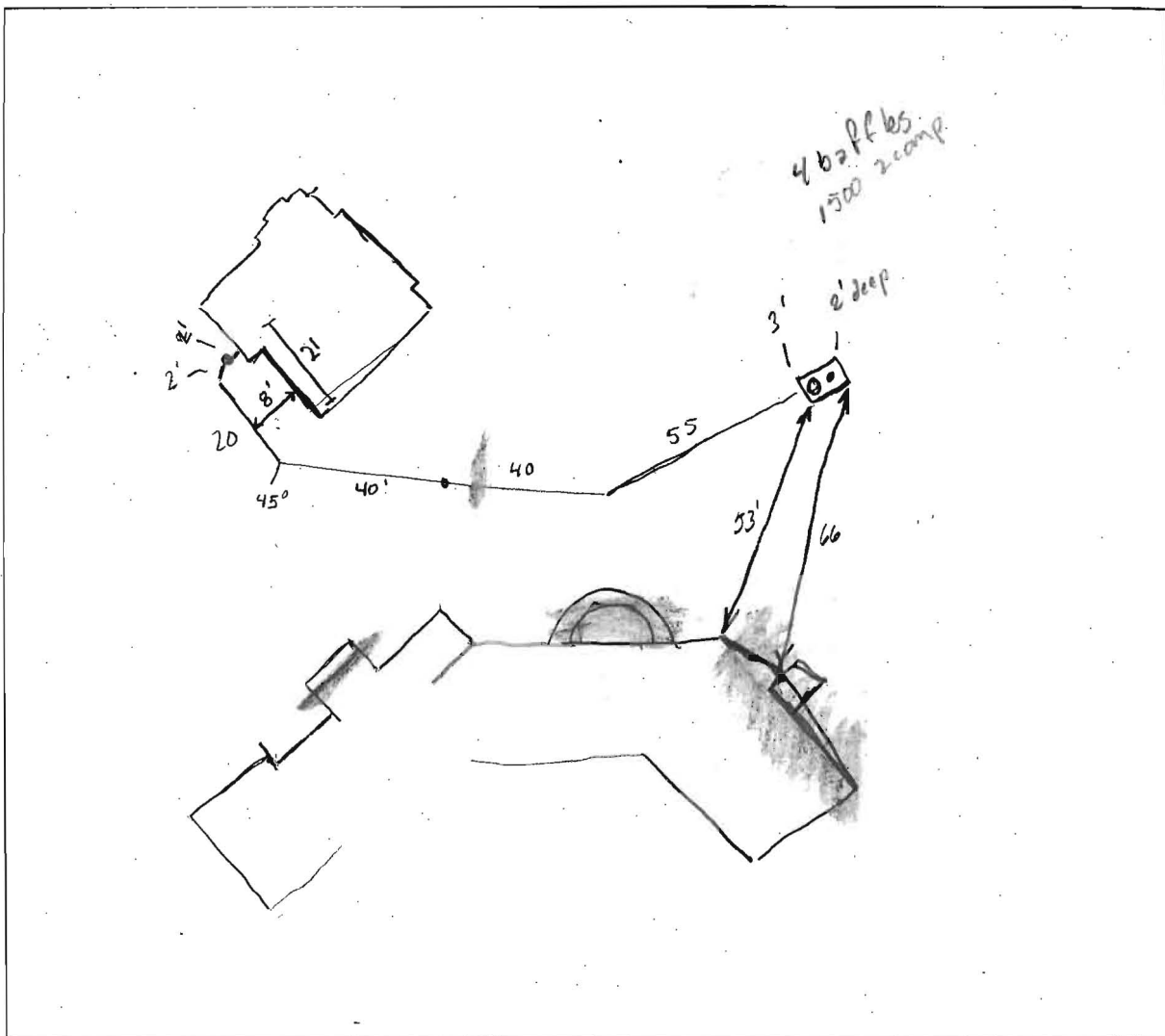

COMMENTS: _____

DATE: 2/10/06 pm INSPECTOR: GAC

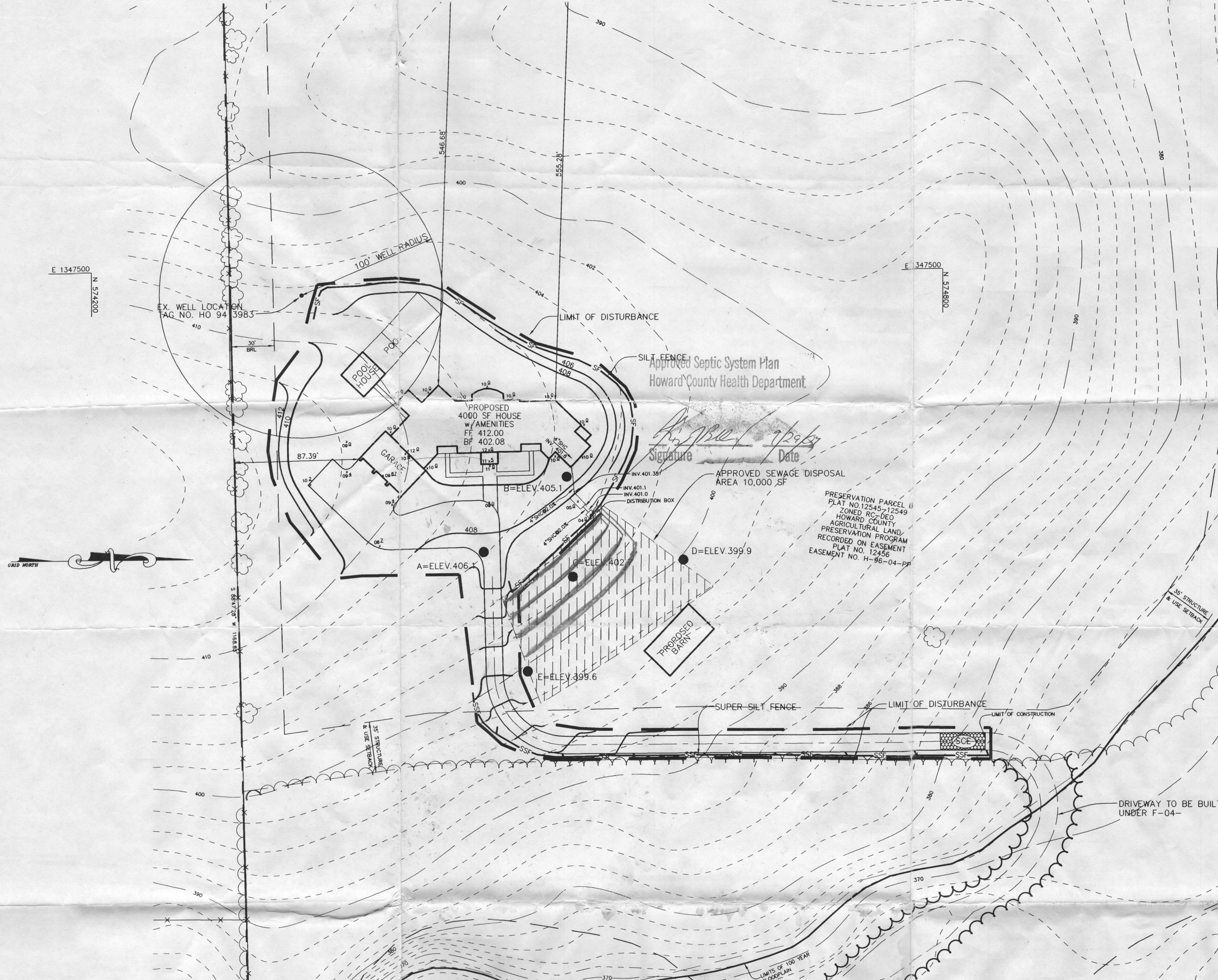

PLAN
SCALE: 1" = 40'

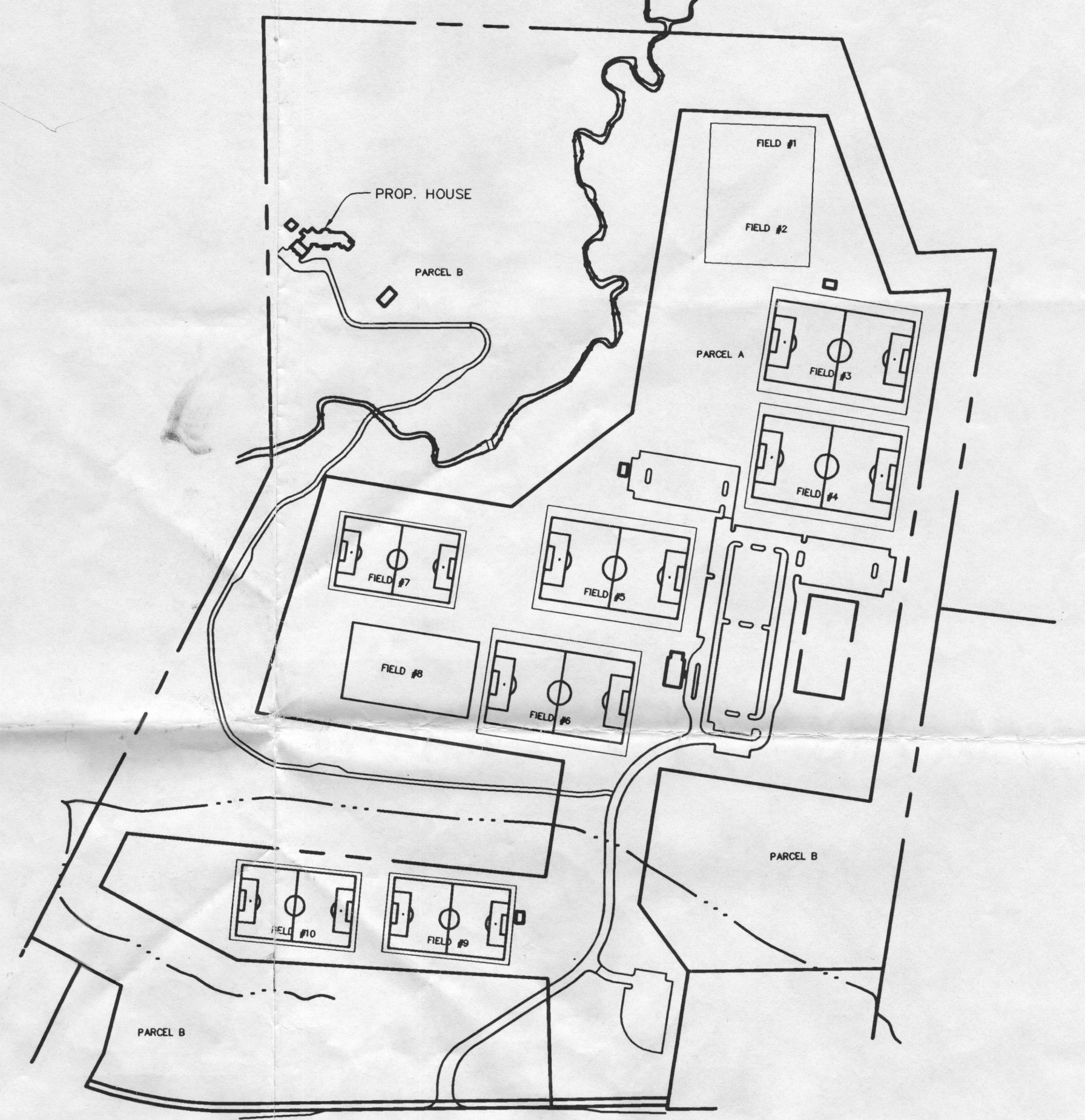

PLAN
SCALE: 1" = 300'

- NOTES**
1. WELL LOCATION WAS SURVEYED BY PATTON HARRIS RUST & ASSOCIATES DATED SEPTEMBER 15, 2004.
 2. WELL WAS DRILLED BY JOSEPH MAYNE AND TAGGED HO 94 3983.

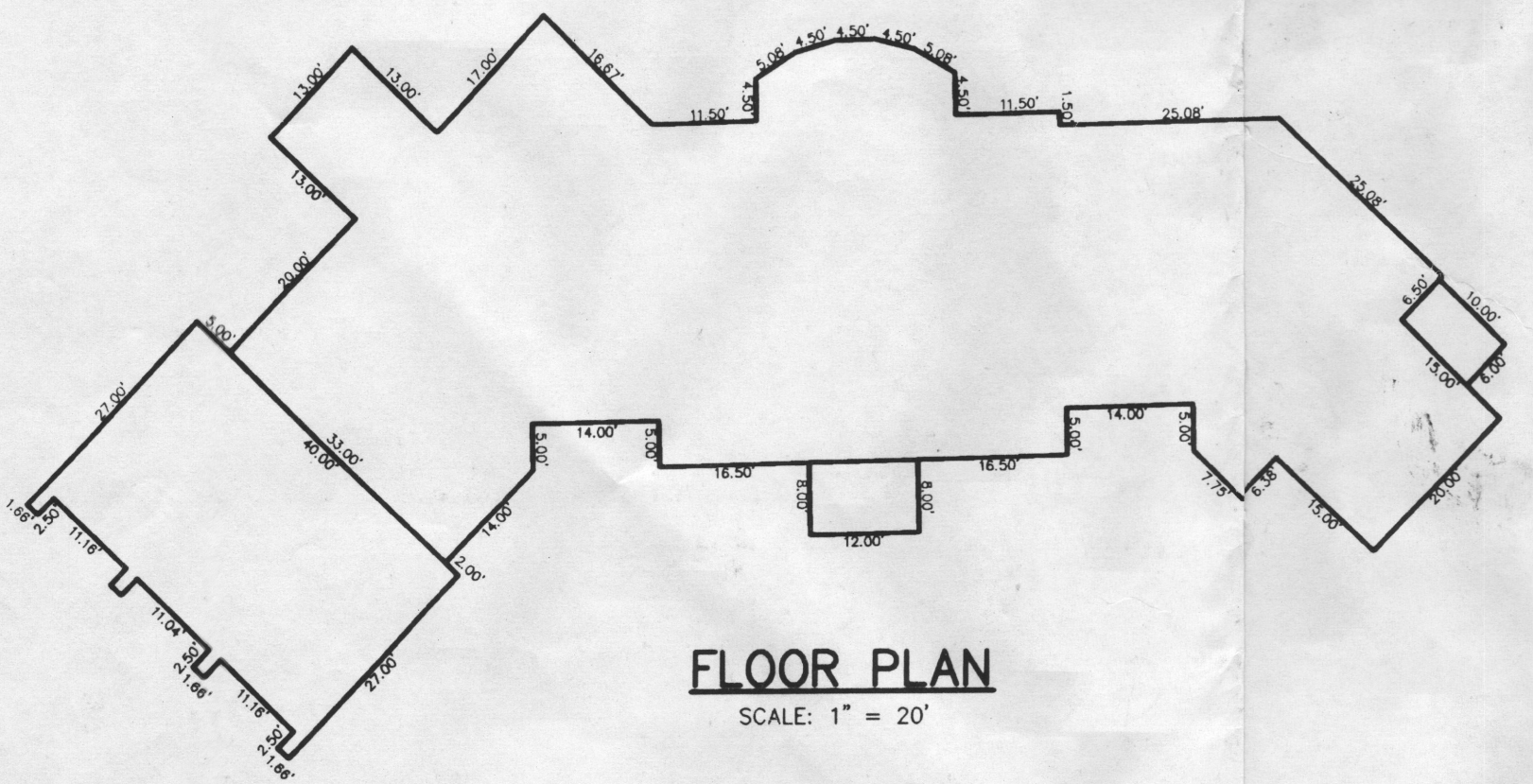

FLOOR PLAN
SCALE: 1" = 20'

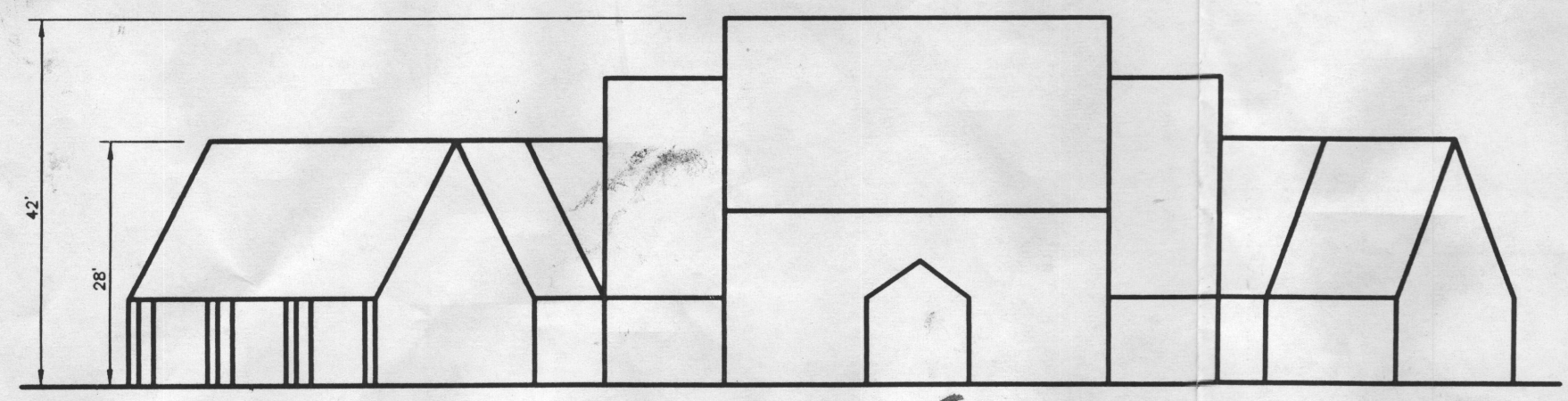

HOUSE ELEVATION
SCALE: 1" = 20'

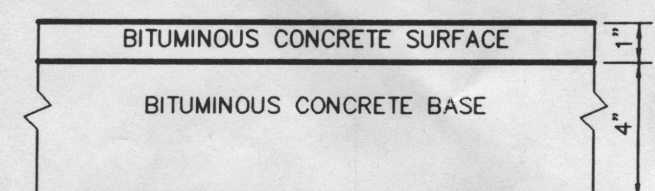
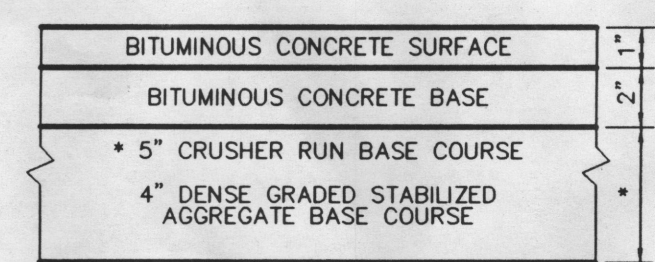

HOWARD COUNTY DESIGN MANUAL VOLUME IV - STANDARD SPECIFICATIONS AND DETAILS FOR CONSTRUCTION (DRAWING R-2.01)

P-1 PAVING
NO SCALE

DATE	NO.	REVISION
OWNER		DEVELOPER
SOCCER ASSOCIATION OF COLUMBIA, INC. 8980-D ROUTE 108 COLUMBIA, MD 21045 410-772-9373		BRIAN GIBBONS c/o ERWIN L. GREENBERG 10096 RED RUN BLVD OWINGS MILLS, MD 21117 410-559-2500
PROJECT GIBBONS RESIDENCE AT 4560 CENTENNIAL LANE		
AREA TAX MAP 30 BLOCK 1 ZONED RC-DEO PARCEL A AND PRESERVATION PARCEL B PLATS 15652-15657 2nd ELECTION DISTRICT HOWARD COUNTY, MARYLAND		
TITLE PLOT PLAN		
Patton Harris Rust & Associates, pc Engineers, Surveyors, Planners, Landscape Architects. 8818 Centre Park Drive Columbia, MD 21045 T 410.997.8900 F 410.997.9282		
9.20.04 DATE		DESIGNED BY : C.J.R.
DRAWN BY: DAM		PROJECT NO : 00287/2.0PLN PLOTPLAN1
DATE : MAY 21, 2004		SCALE : 1" = 40'
DRAWING NO. 1 OF 1		

