

PUB. SEWER STATUS VERIFIED BY _____

ISSUE DATE: 7/05/2006

P 525139

APPROVAL DATE: 7/13/06

A REPAIR

PERMIT

INDEXED

Tax ID # 05-360250

ON-SITE SEWAGE DISPOSAL SYSTEM HOWARD COUNTY HEALTH DEPARTMENT BUREAU OF ENVIRONMENTAL HEALTH

J M Contracting LLC IS PERMITTED TO INSTALL ALTER

ADDRESS: 425 Obrecht Road, Sykesville PHONE NUMBER: 443-277-7526

SUBDIVISION: Patuxent Hills LOT NUMBER: 3

ADDRESS: 11764 Clarksville Pike PROPERTY OWNER: Gloria Miller

SEPTIC TANK CAPACITY (GALLONS): New 2 comp 1000 (1500 Babylon)

PUMP CHAMBER CAPACITY (GALLONS): N/A

NUMBER OF BEDROOMS: 3

SQUARE FEET PER BEDROOM: 180

LINEAR FEET OF TRENCH REQUIRED: 108

| | |
|-----------|--|
| TRENCHES: | Trench to be <u>2</u> feet wide. Inlet <u>4</u> feet below original grade. Bottom maximum depth <u>7.5</u> feet below original grade. Effective area begins at <u>4</u> feet below original grade. <u>3.5</u> feet of stone below distribution pipe. |
| LOCATION: | <u>Keep septic tank 100' from well. 2 equal (54') trenches to the left lotline as seen from road.</u> |
| PURPOSE: | Existing septic system has failed. Call for inspection when ground is opened so sanitarian can recommend repair. |

PLANS APPROVED: GAC DATE: 7/11/06

- NOTE: PERMIT VOID AFTER 2 YEARS
- NOTE: CONTRACTOR RESPONSIBLE FOR SCHEDULING A PRE-CONSTRUCTION INSPECTION FOR ALL INSTALLATIONS
- NOTE: WATERTIGHT SEPTIC TANKS REQUIRED
- NOTE: ALL PARTS OF SEPTIC SYSTEM SHALL BE 100 FEET FROM ANY WATER WELL
- NOTE: MANHOLE RISERS REQUIRED ON ALL SEPTIC TANKS AND PUMP CHAMBERS

NEITHER THE HOWARD COUNTY COUNCIL OR THE HEALTH DEPARTMENT IS RESPONSIBLE FOR THE SUCCESSFUL OPERATION OF ANY SYSTEM PERMITTEE RESPONSIBLE FOR OBTAINING FINAL APPROVAL ON THIS PERMIT CALL 410-313-2640 FOR INSPECTION OF SEPTIC SYSTEM

P525139

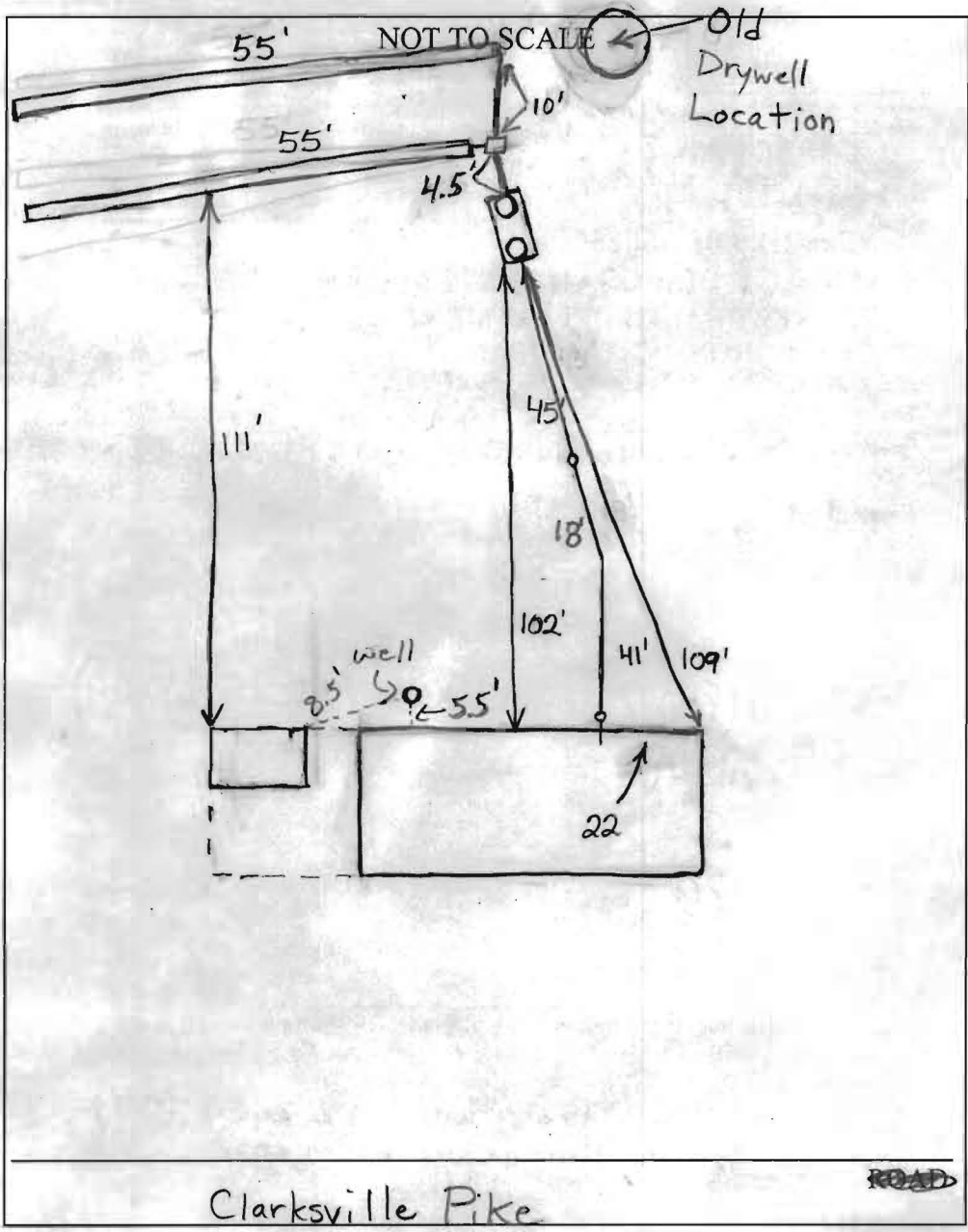

| TRENCH/DRAINFIELD DATA | | |
|-------------------------|--------|--------|
| WIDTH | INLET | BOTTOM |
| 2' | 2.5-3' | 7.5' |
| NUMBER OF TRENCHES | | 2 |
| TOTAL LENGTH | | 110' |
| ABSORPTION AREA | | 385 |
| DISTRIBUTION BOX LEVEL | | Yes |
| DISTRIBUTION BOX BAFFLE | | Yes |
| DISTRIBUTION BOX PORT | | No |

| SEPTIC TANK DATA | |
|------------------------------|------------|
| SEPTIC TANK 1 LEVEL | O.K. |
| ^{Baby low} CAPACITY | 1500 GAL |
| SEAM LOC | Top |
| TANK LID DEPTH | 1'-1.5' |
| BAFFLES | Yes |
| BAFFLE FILTER | NA |
| MANHOLE LOC | Front/Back |
| 6" PORT LOC | None |
| WATERTIGHT TEST | NA |
| SEPTIC TANK 2 LEVEL | N/A |
| CAPACITY | _____ GAL |
| SEAM LOC | _____ |
| TANK LID DEPTH | _____ |
| BAFFLES | _____ |
| BAFFLE FILTER | _____ |
| MANHOLE LOC | _____ |
| 6" PORT LOC | _____ |
| WATERTIGHT TEST | _____ |

Clarksville Pike

ROAD

PRE-CONSTRUCTION _____

INSTALLATION 7/13/06 Old tank and drywell pumped out and filled in per contractor. System finished O.K. to cover everything.

BB

FINAL INSPECTOR B. Baker

DATE OF APPROVAL 7/13/06