

LAYOUT 6/29/06 INSP 4 _____
 INSP 2 _____ INSP 5 _____
 INSP 3 _____ INSP 6 _____

ISSUE DATE: 06/27/2006

P 525133

APPROVAL DATE: 6/29/06

A 513567-F

PERMIT
 INDEXED
TAX ID #03-342131
ON-SITE SEWAGE DISPOSAL SYSTEM
HOWARD COUNTY HEALTH DEPARTMENT
BUREAU OF ENVIRONMENTAL HEALTH

K & K Excavating IS PERMITTED TO INSTALL ALTER

ADDRESS: 15882 Frederick Road, Lisbon PHONE NUMBER: 410-442-1336

SUBDIVISION: Fox Meadow LOT NUMBER: 8

ADDRESS: 13615 Fox Stream Way PROPERTY OWNER: Northridge Dev., LLC

SEPTIC TANK CAPACITY (GALLONS): 1250 OUTLET BAFFLE FILTER REQUIRED

PUMP CHAMBER CAPACITY (GALLONS): n/a COMPARTMENTED TANK REQUIRED
with effluent filter

NUMBER OF BEDROOMS: 4

SQUARE FEET PER BEDROOM: 180

LINEAR FEET OF TRENCH REQUIRED: 150 HOUSE SERVED BY PUBLIC WATER

TRENCHES:	Trench to be 3.0 feet wide. Inlet 3.0 feet below original grade. Bottom maximum depth 5.0 feet below original grade. Effective area begins at 2.0 feet below original grade. 2.0 feet of stone below distribution pipe. Shallow system for best treatment preferred.
LOCATION:	Layout of trenches at time of initial inspection/layout. Try to install trenches of similar length. May extend outside of the approved SDA a few feet if ok'd by the sanitarian.
NOTES:	Recommend cleanout in septic tank line leading to septic tank. Ensure 100' away from adjacent well.

PLANS APPROVED: SRK/Kacie Noonan Reviewed by: _____ DATE: 2/15/05

NOTES: PERMIT VOID AFTER 2 YEARS
 CONTRACTOR IS RESPONSIBLE FOR SCHEDULING A PRE-CONSTRUCTION INSPECTION FOR ALL INSTALLATIONS
 WATERTIGHT SEPTIC TANKS REQUIRED
 ALL PARTS OF SEPTIC SYSTEM SHALL BE 100 FEET FROM ANY WATER WELL UNLESS SPECIFICALLY AUTHORIZED
 MANHOLE RISERS REQUIRED ON ALL SEPTIC TANKS AND PUMP CHAMBERS UNLESS SPECIFICALLY AUTHORIZED
 CONTRACTOR RESPONSIBLE FOR COMPLIANCE WITH APPLICABLE REGULATIONS, GUIDELINES AND THE TERMS OF THIS PERMIT

**NEITHER THE HOWARD COUNTY COUNCIL NOR THE HEALTH DEPARTMENT IS
 RESPONSIBLE FOR THE SUCCESSFUL OPERATION OF ANY SYSTEM
 PERMITTEE RESPONSIBLE FOR OBTAINING FINAL APPROVAL ON THIS PERMIT
 CALL 410-313-1771 FOR INSPECTION OF SEPTIC SYSTEM**

P 525133

NOT TO SCALE

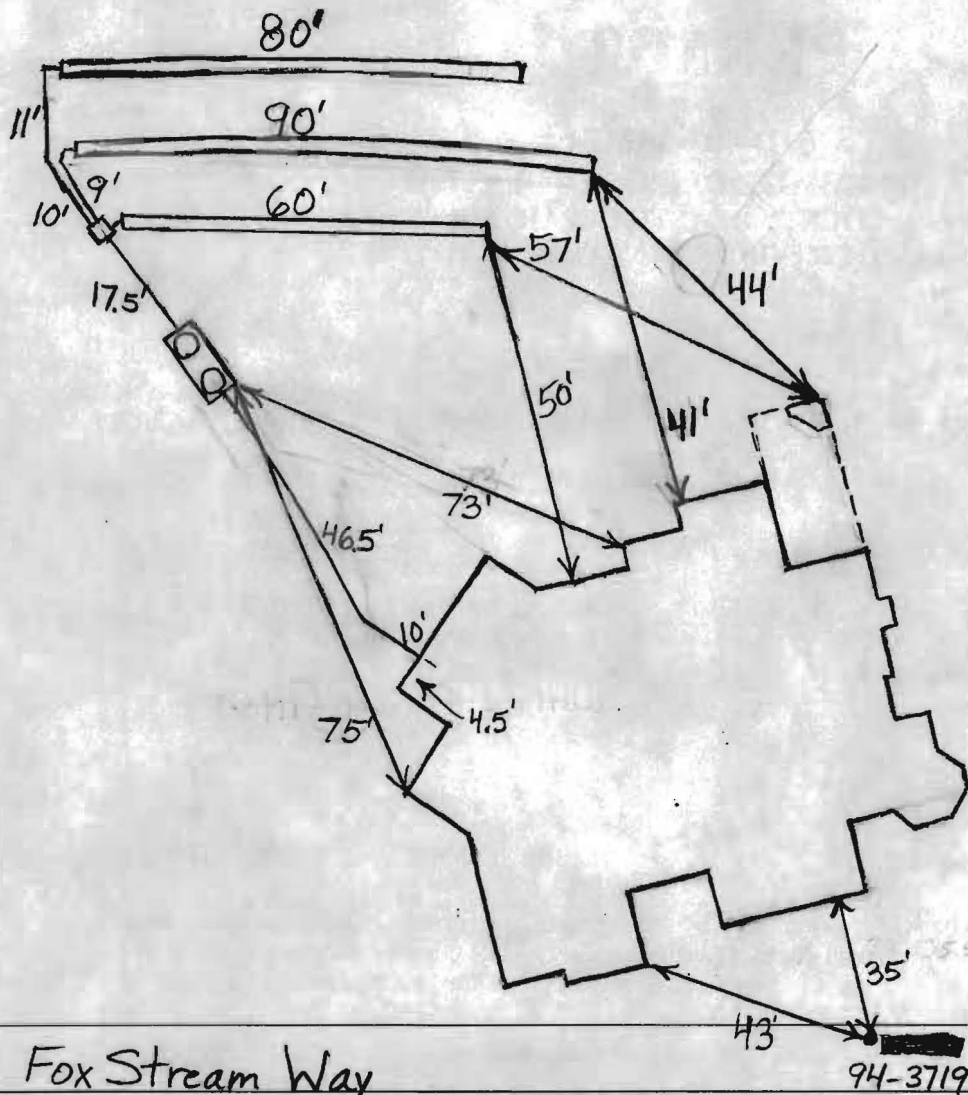

TRENCH/DRAINFIELD DATA		
WIDTH	INLET	BOTTOM
3'	3'	5'
NUMBER OF TRENCHES		3
TOTAL LENGTH		230'
ABSORPTION AREA		690 + Sidewall
DISTRIBUTION BOX LEVEL		Yes
DISTRIBUTION BOX BAFFLE		Yes
DISTRIBUTION BOX PORT		No

SEPTIC TANK DATA	
SEPTIC TANK 1 LEVEL	Yes
CAPACITY	1500 GAL
SEAM LOC	Top
TANK LID DEPTH	0.5'-1'
BAFFLES	Yes
BAFFLE FILTER	Yes
MANHOLE LOC	Front + Rear
6" PORT LOC	None
WATERTIGHT TEST	No
SEPTIC TANK 2 LEVEL	N/A
CAPACITY	_____ GAL
SEAM LOC	_____
TANK LID DEPTH	_____
BAFFLES	_____
BAFFLE FILTER	_____
MANHOLE LOC	_____
6" PORT LOC	_____
WATERTIGHT TEST	_____

PRE-CONSTRUCTION 6/28/06 I install the distribution box near the top left easement stake and run trenches on contour towards

INSTALLATION lot 9. Tank set. House connection made (BB)

6/29/06 System finished. O.K. to backfill (BB)

FINAL INSPECTOR B. Baker DATE OF APPROVAL 6/29/06

WILLIAM ROBERTS PFEFFERKORN
537/221

S76°06'46"E

138.25'

30' BRL

162'±

LOT 8

LOT 7

S16°27'37"W 281.93'

10' BRL

S16°27'37"W 287.05'

10' BRL

38'±

SEE DETAIL

12'±

10' PUBLIC TREE MAINTENANCE EASEMENT

10'

WELL (W)
HO-94-3719

50' BRL

58'±

26.99'

L=112.35'

R=275.00'

S 64°33'31" E

FOX STREAM WAY

40' R/W

SURVEYOR'S CERTIFICATE

I HEREBY CERTIFY TO THE BEST OF MY PROFESSIONAL KNOWLEDGE, INFORMATION AND BELIEF, THAT THE DIMENSIONS OF THE BUILDING WALLS SHOWN HEREON ARE CORRECT; THAT THEY ARE BASED ON A FIELD RUN SURVEY PERFORMED BY BENCHMARK ENGINEERING, INC. ON 04/25/06; AND THAT THE PROPERTY OUTLINE SHOWN HEREON IS BASED ON THE PLAT PREPARED BY DAFT McCUNE WALKER, INC. ENTITLED "FOX MEADOW LOTS 1 THROUGH 12", AND RECORDED AMONG THE LAND RECORDS OF HOWARD COUNTY AS PLAT No.16865

TOP OF FOUNDATION WALL ELEVATION = 548.0'
OFFSET DIMENSIONS TO PROPERTY LINES ARE ± 1'

~FOUNDATION DETAIL~

SCALE: 1" = 40'

David Harris

DAVID M. HARRIS
REGISTERED PROFESSIONAL LAND SURVEYOR
MD REG. No. 10978
FOR BENCHMARK ENGINEERING, INC.
MD REG. No. 351
RECORD PLAT No. 16865
FEMA FIRM No. 240044 0015 B
ZONE: C
DATED: 12/04/86



WALL CHECK

FOX MEADOW
LOTS 1 THROUGH 12

LOT No. 8

13615 FOX STREAM WAY

3RD ELECTION DISTRICT
HOWARD COUNTY, MARYLAND

SCALE: 1" = 40' DATE: 04/25/06

BENCHMARK
ENGINEERS • LAND SURVEYORS • PLANNERS
ENGINEERING, INC.

8480 BALTIMORE NATIONAL PIKE & SUITE 418
ELLCOTT CITY, MARYLAND 21043

Phone: 410-485-8105 & Fax: 410-485-8844
P:\1743 Fox Meadow\1743.dwg 5/17/2006 11:26:55 AM.cwf.

*LOT 9
wall check
ok 6/27/06
DH*



- NOTES:**
1. THE LOT SHOWN HEREON WAS RECORDED ON THE PLAT FOR FOX MEADOW, PLAT No. 16865. REFER TO THE PLAT FOR LOT DIMENSIONS, LOT AREAS AND ALL EASEMENTS.
 2. THIS AREA DESIGNATES A PRIVATE SEWERAGE EASEMENT OF 10,000 SQUARE FEET AS REQUIRED BY THE STATE DEPARTMENT OF THE ENVIRONMENT FOR INDIVIDUAL SEWER DISPOSAL. IMPROVEMENTS OF ANY NATURE IN THIS AREA IS RESTRICTED UNTIL PUBLIC SEWER IS AVAILABLE. THIS EASEMENT SHALL BECOME NULL AND VOID UPON CONNECTION TO A PUBLIC SEWERAGE SYSTEM. THE COUNTY HEALTH OFFICER SHALL HAVE THE AUTHORITY TO GRANT ADJUSTMENTS TO THE PRIVATE SEWERAGE EASEMENT. RECORDATION OF A MODIFIED SEWERAGE EASEMENT PLAT SHALL NOT BE NECESSARY.
 3. SEDIMENT AND EROSION CONTROLS WERE APPROVED BY HOWARD SOIL CONSERVATION DISTRICT UNDER GP-04-98 AND MODIFIED FOR THIS SPECIFIC HOUSE.
 4. TOPOGRAPHY SHOWN HEREON IS TAKEN FROM THE APPROVED ROAD CONSTRUCTION PLANS.
 5. EXACT LENGTH OF SEPTIC TRENCHES ARE TO BE DETERMINED BY THE HEALTH DEPARTMENT AT THE TIME OF TRENCH LAYOUT AND INSPECTION.
 6. SPOIL FROM THE TRENCHING OF THE SEPTIC AREA IS TO BE PLACED ON THE UPHILL SIDE OF THE EXCAVATION FOR EACH INDIVIDUAL LOT.
 7. ALL SEDIMENT AND EROSION CONTROL FEATURES USED ON THIS SITE SHALL COMPLY WITH 1994 MARYLAND STANDARDS AND SPECIFICATIONS FOR SOIL EROSION AND SEDIMENT CONTROL.
 8. ALL DRAINAGE AND STORMWATER MANAGEMENT FEATURES USED ON THIS SITE MUST COMPLY WITH THE APPROVED ROAD CONSTRUCTION PLANS.
 9. SEPTIC TANK FOR THIS LOT TO BE 1,250 GALLONS.
 10. THE EXISTING WELL SHOWN ON THIS PLAN, HO-94-3719, HAS BEEN FIELD LOCATED BY BENCHMARK ENGINEERING, INC. AND IS ACCURATELY SHOWN.

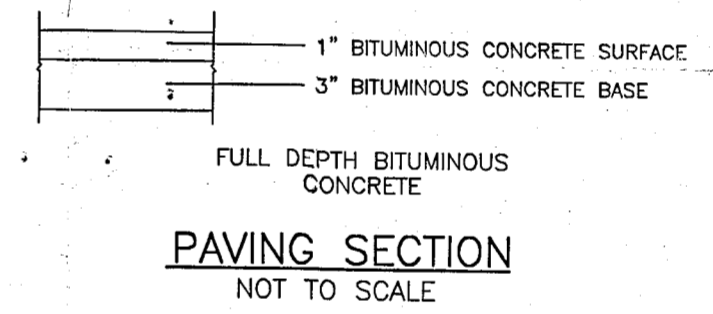
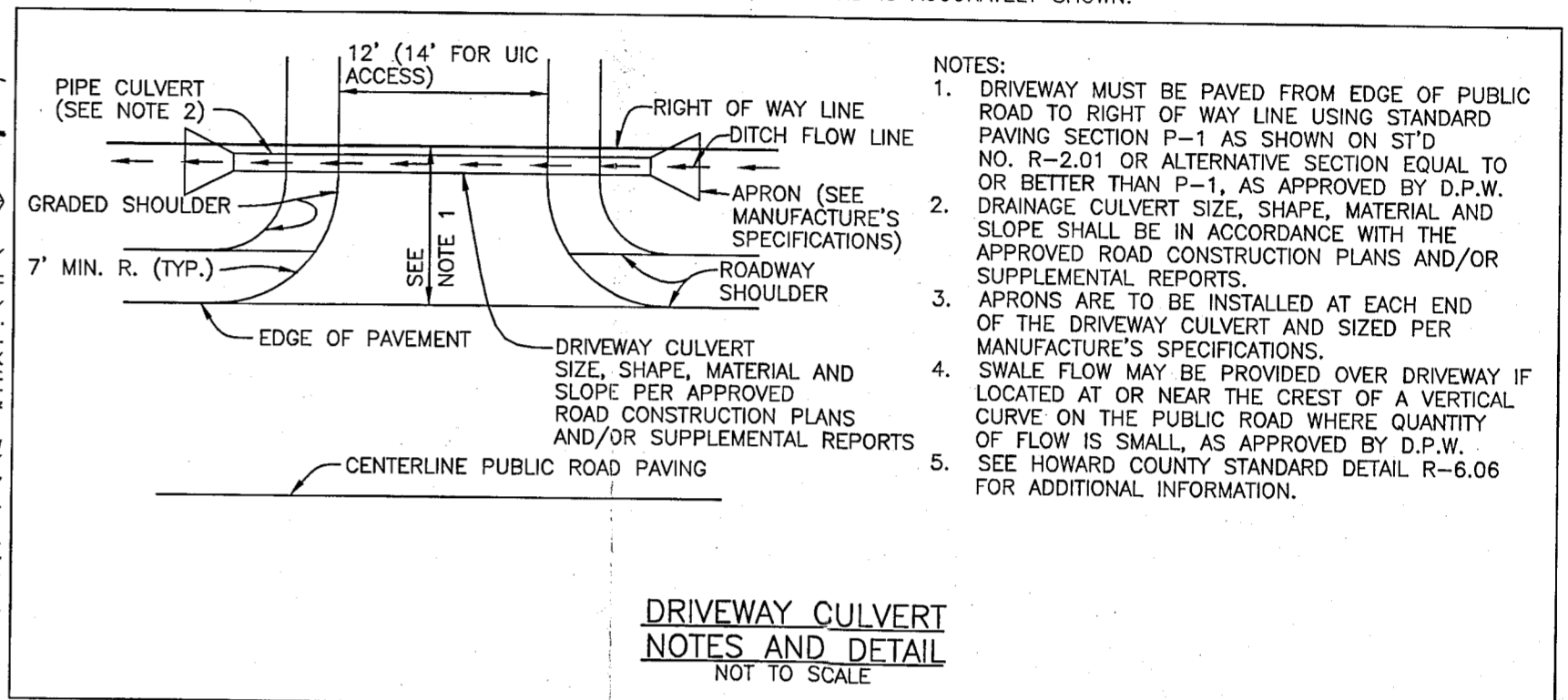

NO.	DATE	REVISION

BENCHMARK
ENGINEERS ▲ LAND SURVEYORS ▲ PLANNERS

ENGINEERING, INC.

8480 BALTIMORE NATIONAL PIKE ▲ SUITE 418
ELLICOTT CITY, MARYLAND 21043
PHONE: 410-465-6105 ▲ FAX: 410-465-6644
EMAIL: benchmrk@cais.com

OWNER/BUILDER: JAMES H. SELFRIDGE BUILDERS, INC. 14045 GARED DRIVE GLENWOOD, MD 21738 PHONE: 410-531-8930 FAX: 410-531-8939	PROJECT: FOX MEADOW LOT 8
LOCATION: 13615 FOX STREAM WAY WEST FRIENDSHIP, MD 21794 TAX MAP No. 15 - BLOCK Nos. 13, 19 & 20 - PARCEL No. 167 3rd ELECTION DISTRICT, HOWARD COUNTY, MARYLAND	TITLE: PERMIT PLAN
HOUSE TYPE: KULA RESIDENCE	DATE: FEBRUARY, 2006
DESIGN: JMC	DRAFT: JMC
SCALE: 1" = 30'	PROJECT NO. 1743 DRAWING 1 OF 1