

5/24/66
9:30

PERMIT

P 12674

A 02602

SEWAGE DISPOSAL SYSTEM

MARYLAND STATE DEPARTMENT OF HEALTH

HOWARD COUNTY

ELLICOTT CITY

DISTRICT 2

DATE 5/10/67

6/13/67
Before 1/7/68
INDEXED

Henry
problem

M. L. Klappenberger IS PERMITTED TO INSTALL ALTER

ADDRESS Rt. 4 - Box 91 - Landing Rd., Elkridge, Md. PHONE RI 4-4343

A SEWAGE DISPOSAL SYSTEM LOCATED AT _____

SUBDIVISION Henry Wehland ROAD Ilchester Rd. LOT 5

PROPERTY OWNER Allen, Arthur W. (New Owner C. Cobb)

ADDRESS _____

SPECIFICATIONS - 3 bedrooms

DRAIN FIELD _____ DEPTH _____ FEET, BOTTOM AREA _____ SQ. FT.

SEEPAGE PITS _____ ABSORBENT SIDE-WALL AREA _____ SQ. FT.

SEPTIC TANK CAPACITY 750 GALLONS

FOR GARBAGE GRINDER, INCREASE DISPOSAL AREA 22% & TANK CAPACITY 50%.

OTHER ~~Dry well - 17 ft. square pit. Set block and top for 12 ft. dia. - and fill rest of pit with gravel. Depth of dry well 10 1/2 ft. below inlet pipe. Inlet pipe shall be no deeper than 3 ft. below original grade. Dry well shall be no deeper than 13 1/2 ft. below original grade. Locate dry well 126 ft. from the front property line and 47 ft. off the left side property line as seen when facing the lot from Ilchester Road. Above measurements are to center of dry well.~~

PERMIT VOID AFTER THREE YEARS.

PLANS APPROVED BY J. Hennigan

DATE 12/21/65

FILL SEPTIC TANK AND DISTRIBUTION BOX WITH WATER BEFORE CALLING FOR AN INSPECTION. COVER NO WORK UNTIL INSPECTED AND APPROVED.

NEITHER THE HOWARD COUNTY COMMISSIONERS NOR THE HEALTH DEPARTMENT IS RESPONSIBLE FOR THE SUCCESSFUL OPERATION OF ANY SYSTEM.

NOTIFY THE HEALTH DEPARTMENT 48 HOURS BEFORE EXCAVATIONS ARE TO BE BACK FILLED.

02602

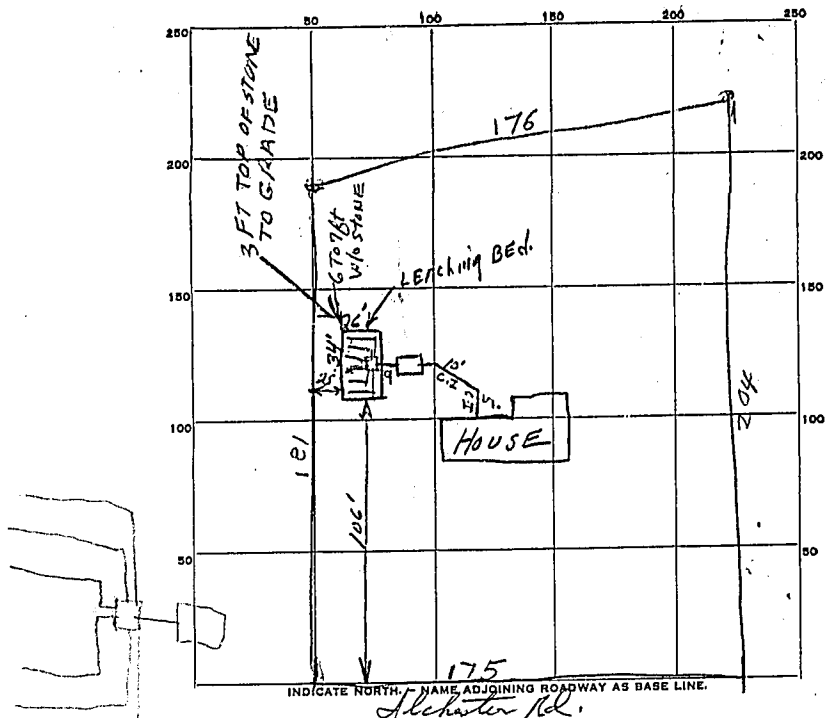

PERMIT CARD 2120

SEPTIC TANK, LEVEL Concrete 750 gal. CLEANOUTS 6" steel pipe

DISTRIBUTION BOX, LEVEL _____

LEACHING TILE FIELD, DEPTH bal FT. TRENCH WIDTH 26 FT.

GRAVEL DEPTH _____ IN. TOTAL LENGTH 34 FT.

NUMBER OF TRENCHES _____ TOTAL BOTTOM AREA _____

SEEPAGE PITS, INSIDE DIAMETER _____ FT. DEPTH BELOW INLET _____ FT.

ABSORBENT AREA _____ SQ. FT.

REMARKS 24 MAY 67 - Rd underground water in hole dug for
dry well. It is 11 FT from grade Septic Tank lines
about 4 FT below grade 25 MAY 67 - Water level still 11 FT
June 7, 1967 Preliminary OK. Backfilled to 6 ft. from original grade. JH
13 JUNE 67 - 3 TO 4 FT OF ROCK ADDED TO BED
UNDER PIPES COVER PIPES WITH ROCK & COVER

DATE SYSTEM APPROVED 6/13/67 INSPECTOR Raymond Hodges