



APPLICATION

FOR PERCOLATION TESTING AND SITE EVALUATION

TEST DATE(S) _____ TEST TIME _____

AP 527893-B

AGENCY REVIEW: _____

DATE 11/1/07

DO NOT WRITE ABOVE THIS LINE

I HEREBY APPLY FOR THE NECESSARY TESTING/EVALUATION PRIOR TO ISSUANCE OF SEWAGE DISPOSAL SYSTEM PERMIT(S) TO:

CHECK AS NEEDED:

- CONSTRUCT NEW SEPTIC SYSTEM(S)
- REPAIR/ADD TO AN EXISTING SEPTIC SYSTEM
- REPLACE AN EXISTING SEPTIC SYSTEM

CHECK AS NEEDED:

- NEW STRUCTURE(S)
- ADDITION TO AN EXISTING STRUCTURE
- REPLACE AN EXISTING STRUCTURE

CHECK ONE:

- CREATE NEW LOT(S)
- BUILD ON AN EXISTING LOT IN A SUBDIVISION
- BUILD ON AN EXISTING PARCEL OF RECORD

IS THE PROPERTY WITHIN 2500' OF ANY RESERVOIR?

- YES
- NO

THE TYPE OF STRUCTURE IS:

- RESIDENTIAL WITH _____ PROPOSED BEDROOMS IN THE COMPLETED STRUCTURE (NOTE **UNKNOWN** IF APPROPRIATE)
- COMMERCIAL (PROVIDE DETAIL OF NUMBERS AND TYPES OF EMPLOYEES/ CUSTOMERS ON ACCOMPANYING PLAN)
- INSTITUTIONAL/GOVERNMENT (PROVIDE DETAIL OF NUMBERS AND TYPES OF EMPLOYEES/USERS ON ACCOMPANYING PLAN)

PROPERTY OWNER(S) Harry Reinhardt

DAYTIME PHONE 301-829-9495 CELL _____ FAX _____

MAILING ADDRESS 18571 Penn Shop Rd Mount Airy MD 21771
STREET CITY/TOWN STATE ZIP

APPLICANT Edwin Reinhardt

DAYTIME PHONE 301-829-1908 CELL 240-674-2955 FAX _____

MAILING ADDRESS 18571 Penn Shop Rd Mt Airy MD 21771
STREET CITY/TOWN STATE ZIP

APPLICANT'S ROLE: DEVELOPER BUILDER BUYER RELATIVE/FRIEND REALTOR CONSULTANT

PROPERTY LOCATION
SUBDIVISION/PROPERTY NAME _____ LOT NO. 3

PROPERTY ADDRESS 18571 Penn Shop Rd Mt Airy MD 21771
STREET TOWN/POST OFFICE

TAX MAP PAGE(S) _____ GRID _____ PARCEL(S) _____ PROPOSED LOT SIZE 1 Acre

AS APPLICANT, I UNDERSTAND THE FOLLOWING: THE SYSTEM INSTALLED SUBSEQUENT TO THIS APPLICATION IS ACCEPTABLE ONLY UNTIL PUBLIC SEWERAGE IS AVAILABLE. THIS APPLICATION IS COMPLETE WHEN ALL APPLICABLE FEES AND A SUITABLE SITE PLAN HAVE BEEN RECEIVED. I ACCEPT THE RESPONSIBILITY FOR COMPLIANCE WITH ALL M.O.S.H.A. AND "MISS UTILITY" REQUIREMENTS. APPROVAL IS BASED UPON SATISFACTORY REVIEW OF A PERG CERTIFICATION PLAN.

TEST RESULTS WILL BE MAILED TO APPLICANT. Mary Partee
SIGNATURE OF APPLICANT

HOWARD COUNTY HEALTH DEPARTMENT, BUREAU OF ENVIRONMENTAL HEALTH, WELL AND SEPTIC PROGRAM
7178 COLUMBIA GATEWAY DRIVE COLUMBIA, MARYLAND 21046 (410) 313-1771 FAX (410) 313-2648
TDD (410) 313-2323 TOLL FREE 1-877-4MD-DHMH

A/P _____

⑦

Brown
1 1/2'

Orange/Red
heavy
Silt
4 1/2'

Yellow/gray
Silt w/
15-20%
Platy
Spherulite

HS 10 1/2'

⑧

Brown
L
2'

Yellow/Red
Silt
5'

Brown/Red
Orange
Silt w/
15-20%
Platy
Spherulite

HS 10'

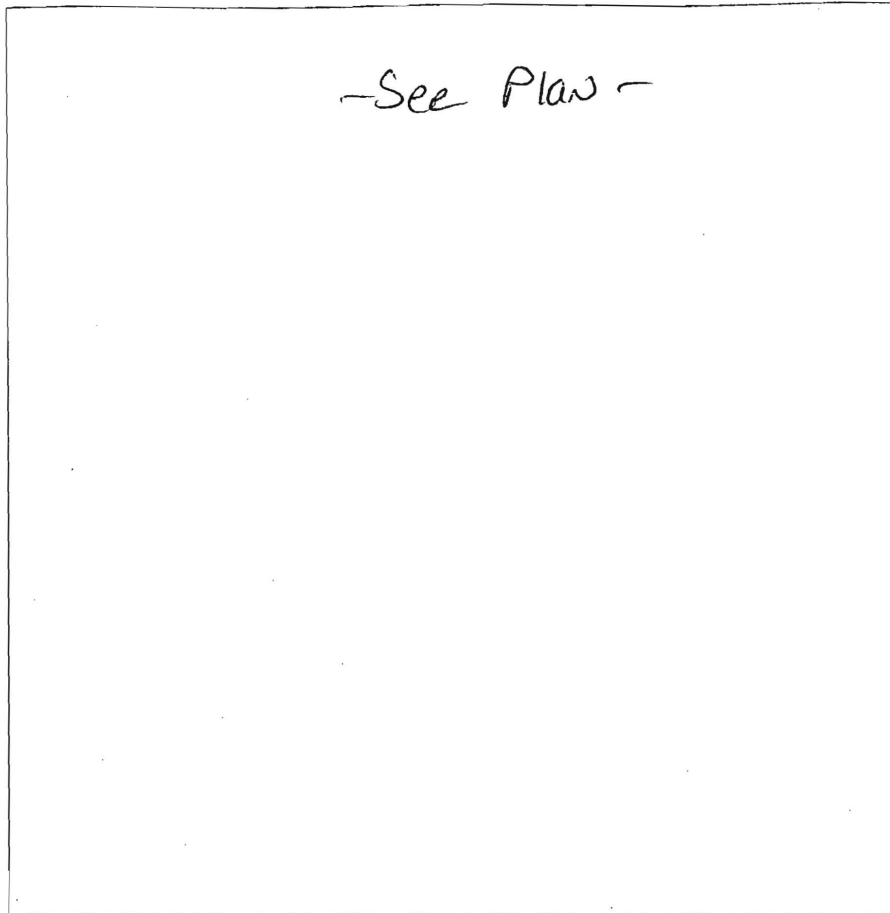

DATE	TEST #	DEPTH	START	BREAK 1" DROP	STOP 2" DROP	TIME OF 2ND INCH	P/F/H
9/6/06	7	5 10 1/2	10:58	11:10	11:32	22min	P
	8	- 10	- Visual			OK	P

REMARKS _____

SANITARIAN KJB BACKHOE Justin Brink OTHERS _____

TEST HOLES USED IN SDA _____ AVG. PERC TIME _____ SQ. FT/BR _____

TRENCH WIDTH _____ INLET DEPTH _____ MAX. BOT DEPTH _____ EFFECTIVE SW _____

AVP

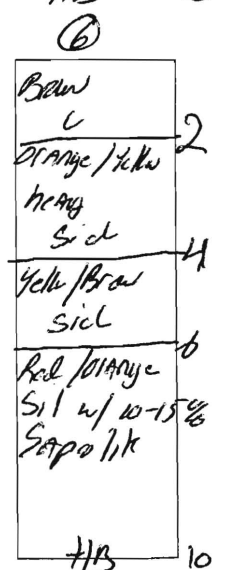
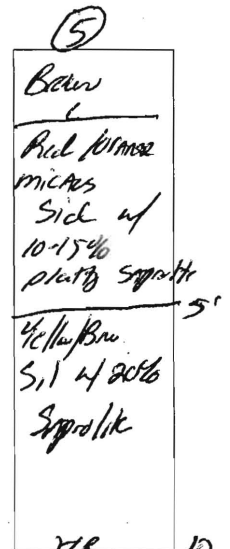
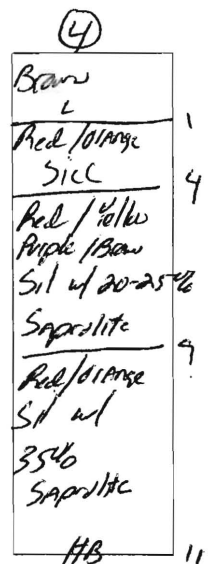
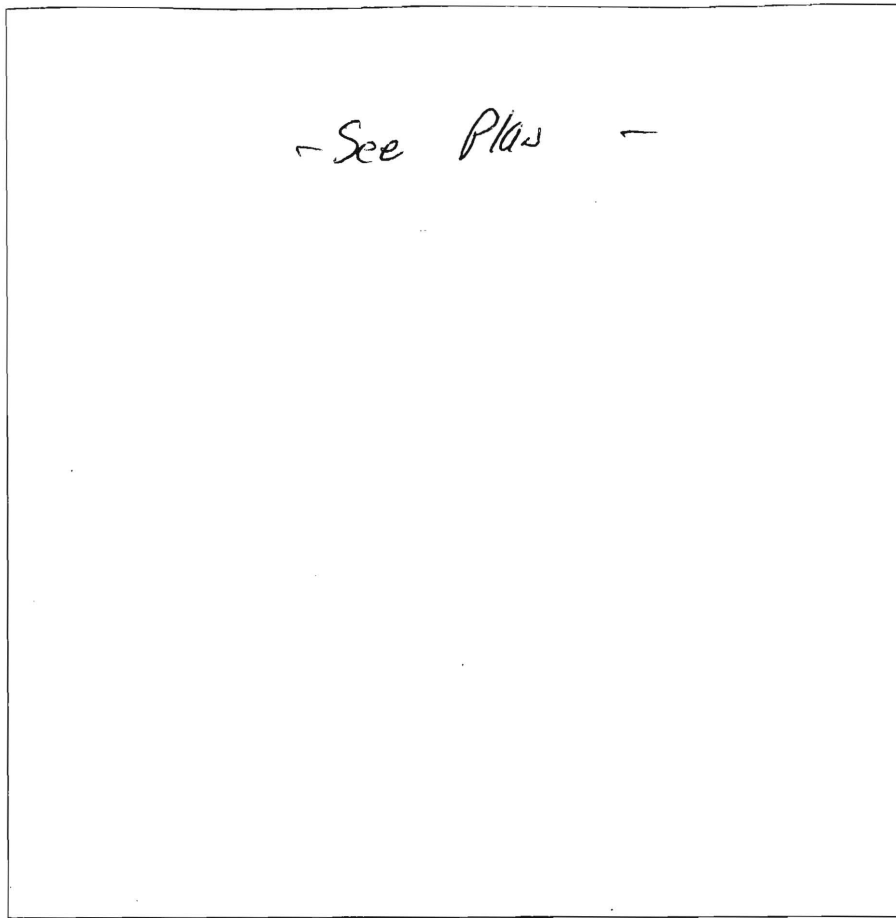
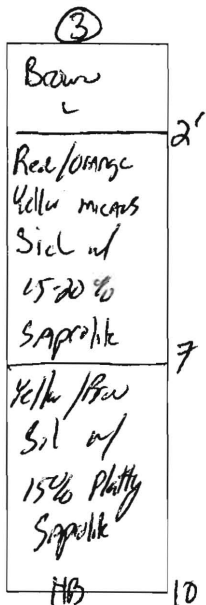
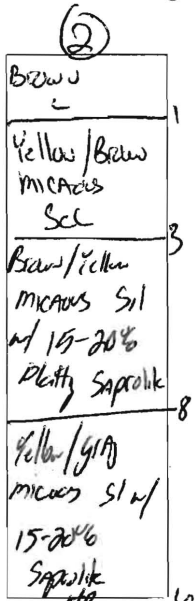
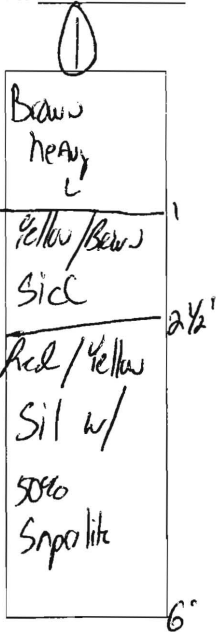

DATE	TEST #	DEPTH	START	BREAK 1" DROP	STOP 2" DROP	TIME OF 2ND INCH	P/F/H
4/5/06	1	6	- Visual -				F
	2	3 1/2' / 10	7:58	Pulled @	8:25		F
	3	5 1/2' / 10	9:01	Pulled @	9:20		F
	4	5 / 11	9:38	9:41	9:46	5 min	P
	5	5 / 10	10:08	10:10	10:13	3 min	P
	6	6 / 10	10:42	10:52	11:13	21 min	P

REMARKS all holes must be field located - see perc plan -
 SANITARIAN KJB BACKHOE Justin Brubel OTHERS _____
 TEST HOLES USED IN SDA _____ AVG. PERC TIME _____ SQ. FT/BR _____
 TRENCH WIDTH _____ INLET DEPTH _____ MAX. BOT DEPTH _____ EFFECTIVE S/W _____

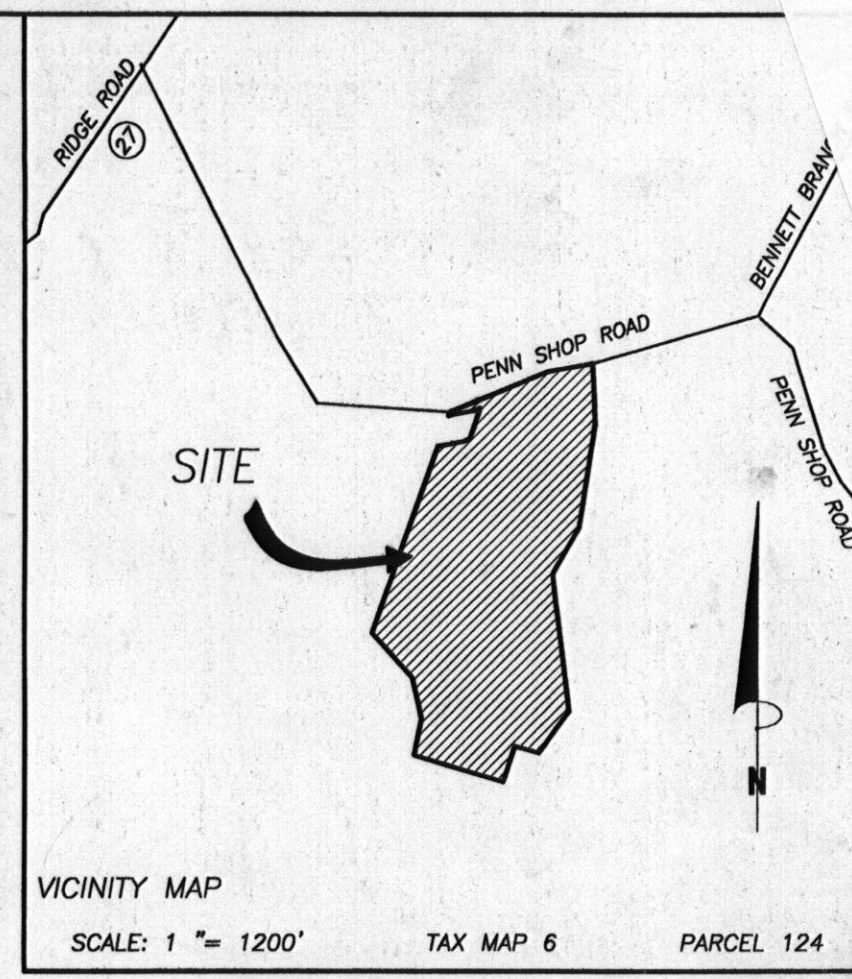

- GENERAL NOTES:
- OWNERS: HARRY W. REINHARDT CHRISTINE REINHARDT
DEED REFERENCE: LIBER 1520 FOLIO 67
DATE: AUGUST 15, 1986
GRANTOR: CHARLES E. PAYNE
 - TAX MAP: 6 GRID: 3 PARCEL: 124
 - NEAREST POTABLE WATER SUPPLY: MT. AIRY DISTANCE: 1 MILE ±
 - THERE IS NO FLOOD HAZARD (100 YEAR FLOOD PLAIN) LOCATED ON THIS PROPERTY ACCORDING TO FEMA FLOOD INSURANCE RATE MAP, COMMUNITY PANEL# 240044 0006 B, REVISED DECEMBER 4, 1986
 - TOPOGRAPHY: HOWARD COUNTY DATUM CONTOUR INTERVAL IS 2 FEET, FIELD SPOT-CHECKED BY VANMAR ASSOCIATES.
 - THERE ARE NO WELLS OR SEPTIC SYSTEMS WITHIN 100' OF THE PROPERTY BOUNDARY UNLESS OTHERWISE SHOWN HEREON.
 - THE EXISTING WELL(S) SHOWN ON THIS PLAN HO-73-3863 HAS BEEN FIELD LOCATED BY VANMAR ASSOCIATES, INC. AND ACCURATELY SHOWN.
 - SOIL TYPE: (GIB2, GIB2, LNB2, LNC2, LND2, LoE, MIC2) HOWARD COUNTY SOILS MAP No. 1.
 - ZONING DISTRICT: RODEO
 - ALL WELLS TO BE DRILLED PRIOR TO SUBMITTAL OF SIGNATURE. IT IS THE DEVELOPER'S RESPONSIBILITY TO SCHEDULE THE WELL DRILLING PRIOR TO THE FINAL PLAT SUBMISSION. IT WILL NOT BE CONSIDERED "GOVERNMENT DELAY" IF THE WELL DRILLING HOLDS-UP THE HEALTH DEPARTMENT SIGNATURE OF THE RECORD PLAT. IF A WELL SUCCESS RATE IS ACCOMPLISHED AT VARIOUS LOCATIONS WITHIN THE SITE, THE DEVELOPER WILL HAVE THE OPTION TO REQUEST RELIEF FROM DRILLING THE REMAINING WELLS PRIOR TO PLAT RECORDATION.
 - THE LOTS SHOWN HEREON COMPLY WITH THE MINIMUM OWNERSHIP WIDTH AND LOT AREAS REQUIRED BY THE MARYLAND DEPARTMENT OF THE ENVIRONMENT.

THIS AREA DESIGNATES A PRIVATE SEWERAGE EASEMENT OF AT LEAST 10,000 SQUARE FEET AS REQUIRED BY MARYLAND STATE DEPARTMENT OF ENVIRONMENT FOR INDIVIDUAL SEWERAGE DISPOSAL.

IMPROVEMENTS OF ANY NATURE IN THIS AREA ARE RESTRICTED UNTIL PUBLIC SEWERAGE IS AVAILABLE. THESE EASEMENTS SHALL BECOME NULL AND VOID UPON CONNECTION TO PUBLIC SEWERAGE SYSTEM. THE COUNTY HEALTH OFFICER SHALL HAVE THE AUTHORITY TO GRANT ADJUSTMENTS. RECORDATION OF A MODIFIED SEWERAGE EASEMENT SHALL NOT BE NECESSARY.

PROPOSED PERCOLATION TEST SITE: ⊕
(PASSED) PERCOLATION TEST SITE: ⊙
(FAILED) PERCOLATION TEST SITE: ⊛

EXISTING WELL: ●
PROPOSED HOUSE SITE: ⊠
PROPOSED WELL SITE: ⊖

25% SLOPES: ■

APPROVED:
FOR PRIVATE WATER AND PRIVATE
SEWERAGE SYSTEMS.
HOWARD COUNTY HEALTH DEPARTMENT

HOWARD COUNTY HEALTH OFFICER _____ DATE _____

OWNERS:
HARRY W. REINHARDT
CHRISTINE REINHARDT
18571 PENN SHOP ROAD
MT. AIRY, MD. 21771

I CERTIFY THAT THE INFORMATION SHOWN HEREON IS BASED ON FIELD WORK PERFORMED BY ME OR UNDER MY DIRECT SUPERVISION AND IS CORRECT, TO THE BEST OF MY KNOWLEDGE AND BELIEF.

Thomas L. Frazer 2/4/08
THOMAS L. FRAZER, JR. PROF. L. S., MD. REG. #21097 DATE

DATE	REVISIONS
2/13/06	Septic area added
10/31/07	Revised layout
12/10/07	Per Comments
2/4/08	Per Comments



PERCOLATION TEST PLAN
REINHARDT PROPERTY

LIBER 1520 FOLIO 67
SITUATED ON PENN SHOP ROAD
ELECTION DISTRICT No. 4
HOWARD COUNTY, MARYLAND
SCALE: 1" = 100' OCTOBER 2007

VANMAR ASSOCIATES, INC.
Engineers Surveyors Planners
310 South Main Street P.O. Box 328 Mount Airy, Maryland 21771
(301) 829-2899 (301)831-5015 (410) 549-2721