

THIS REPORT  
MUST BE SUBMITTED  
WITHIN 30 DAYS  
AFTER COMPLETION  
OF THE WELL

Beaverbrook Rd. WELL COMPLETION REPORT A10564

WELL DESCRIPTION

<p><b>WELL LOG</b> State the kind of formations penetrated, their color, their depth, their thickness, and if water-bearing</p>	<p><b>CASING AND SCREEN RECORD</b> State the kind and size and position of casing, liner, shoe, screen, and other accessories (if no casing used, give diameter of well).</p>
---	---

WELL LOG	FEET from ___ to ___	DIAM. (inches)	FEET from ___ to ___
Beaverbrook		Sand	
		45 ft. casing Gray Rock	
		well 108 ft.	

Permit Number HO 66-W-295  
 Owner Joseph Pugh, Jr.  
 Address \_\_\_\_\_  
 Subdivision BEAVER BROOK  
 Section A Lot 1

**PUMPING TEST**  
 Hours Pumped 1  
 Type of Pump Used Diaphragm  
 Pumping Rate \_\_\_\_\_  
 Gallons per Minute 6

**WATER LEVEL**  
 Distance from land surface to water:  
 Before Pumping 55 Ft.  
 When Pumping 80 Ft.

**APPEARANCE OF WATER**  
 Clear Partly Cloudy \_\_\_\_\_  
 Taste None  
 Odor None

Height of Casing Above Land  
 Surface 2 Ft.

**PUMP INSTALLED**  
 Type \_\_\_\_\_  
 Capacity \_\_\_\_\_  
 Gallons per Minute \_\_\_\_\_  
 Gallons per Hour \_\_\_\_\_  
 Pump Column Length \_\_\_\_\_ Ft.

**LOCATION OF WELL ON LOT**  
 Show permanent structures such as building(s), septic tank, and/or other landmarks and indicate not less than 2 distances (measurements) to well.

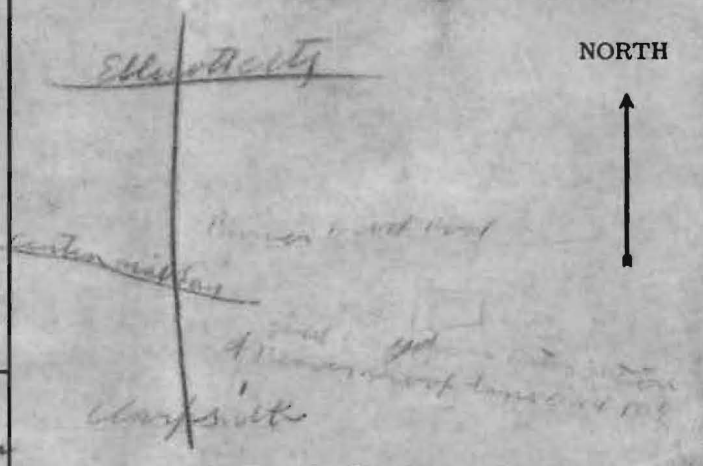

HO 66-W-295

Well  
Glen

Date Well Completed <u>May 7, 1966</u>	Well Driller Signature <u>Danny Brown</u>
--	---

