

3/29/65
OKAH

Check to see if 10 x 40

PERMIT

P 09784

SEWAGE DISPOSAL SYSTEM

A _____

MARYLAND STATE DEPARTMENT OF HEALTH

HOWARD COUNTY

ELLCOTT CITY

INDEXED

DISTRICT 2

DATE 3/18/65

Emerson Feaga IS PERMITTED TO INSTALL _____ ALTER

ADDRESS Triadelphia Rd., E. C. PHONE AT 6-2516

A SEWAGE DISPOSAL SYSTEM LOCATED AT _____

SUBDIVISION _____ ROAD Balto. National Pike LOT _____

PROPERTY OWNER Gaskin's Steak House

ADDRESS Baltimore National Pike, E. C.

SPECIFICATIONS

DRAIN FIELD _____ DEPTH _____ FEET, BOTTOM AREA _____ SQ. FT.

SEEPAGE PITS _____ ABSORBENT SIDE-WALL AREA _____ SQ. FT.

SEPTIC TANK CAPACITY _____ GALLONS

FOR GARBAGE GRINDER, INCREASE DISPOSAL AREA 22% & TANK CAPACITY 50%.

OTHER REPAIR - about 500 sq. ft. leaching bed

NOTE: CALL FOR INSPECTION OF LEACHING BED EXCAVATION BEFORE ANY GRAVEL IS INSTALLED.

PLANS APPROVED BY _____ DATE 3/18/65

FILL SEPTIC TANK AND DISTRIBUTION BOX WITH WATER BEFORE CALLING FOR AN INSPECTION. COVER NO WORK UNTIL INSPECTED AND APPROVED.

NEITHER THE HOWARD COUNTY COMMISSIONERS NOR THE HEALTH DEPARTMENT IS RESPONSIBLE FOR THE SUCCESSFUL OPERATION OF ANY SYSTEM.

10:20 Test
10:40 - 8" deep

P 09784

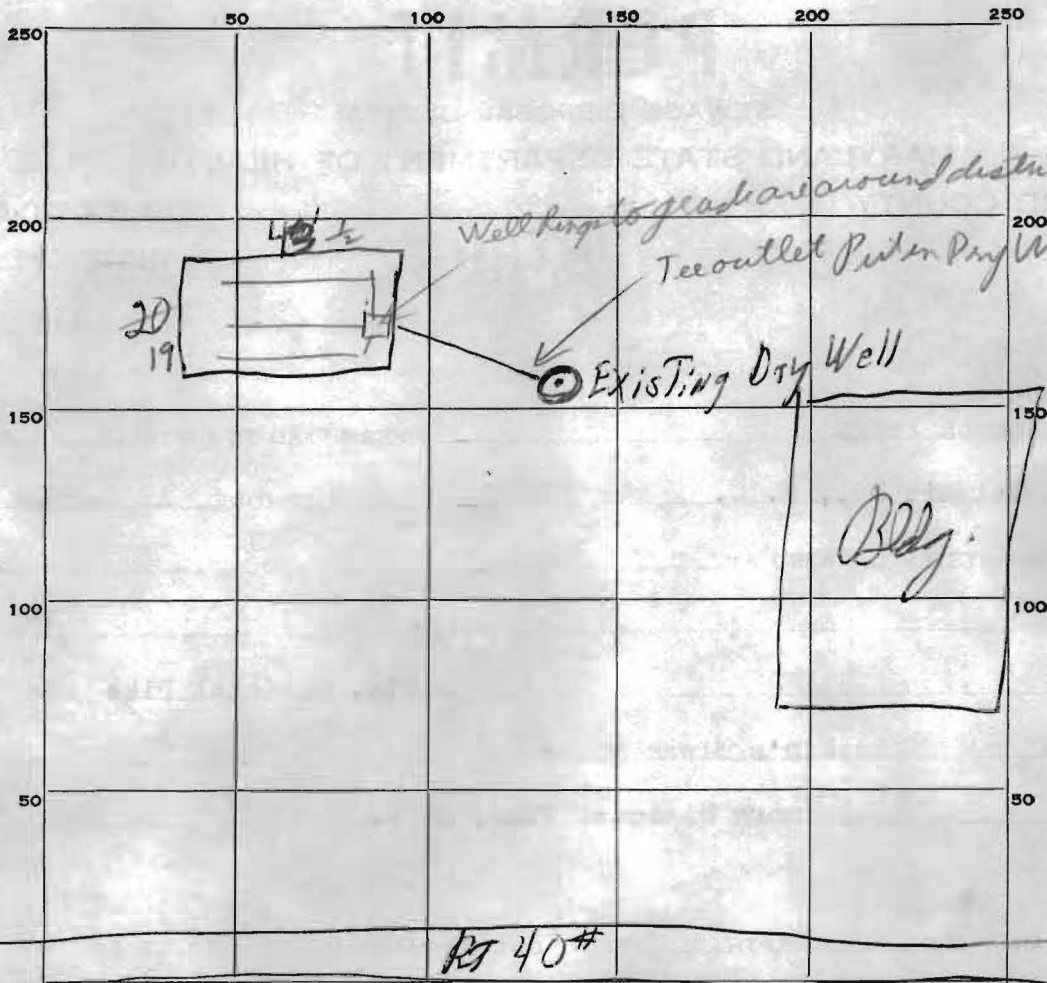

43.5
 19
 3915
 435
 826.5

N
 ↓

INDICATE NORTH. - NAME ADJOINING ROADWAY AS BASE LINE.

PERMIT CARD _____

SEPTIC TANK, LEVEL _____ CLEANOUTS _____

DISTRIBUTION BOX, LEVEL OK

LEACHING BED THE FIELD, DEPTH 8-10 FT. TRENCH WIDTH 19 FT.

GRAVEL DEPTH 4 FT according to Feaga IN. TOTAL LENGTH 43.5 FT.

NUMBER OF TRENCHES _____ TOTAL BOTTOM AREA 826

SEEPAGE PITS, INSIDE DIAMETER _____ FT. DEPTH BELOW INLET _____ FT.

ABSORBENT AREA _____ SQ. FT.

REMARKS 3/24/65 - Perc. O.K. -

3/29/65! Green soapy sewage overflowing from last dry well which was pumped out last week. Also there is a thick layer of soapy scum in dry well

DATE SYSTEM APPROVED 29 MARCH 65 INSPECTOR Raymond Hodger