

8/2/65 - Partial OK - JHK

# PERMIT

SEWAGE DISPOSAL SYSTEM

MARYLAND STATE DEPARTMENT OF HEALTH

HOWARD COUNTY

## INDEXED

ELLICOTT CITY

DISTRICT \_\_\_\_\_

DATE \_\_\_\_\_

7/12/65

P \_\_\_\_\_  
A 10526  
10036

8/2/65  
Ready  
8/3/65  
Ready

IS PERMITTED TO INSTALL \_\_\_\_\_ ALTER \_\_\_\_\_

ADDRESS Port City Construction Co. PHONE X  
5638 1/2 Baltimore National Pike, E. C. 744-6000  
A SEWAGE DISPOSAL-SYSTEM LOCATED AT \_\_\_\_\_

SUBDIVISION \_\_\_\_\_ ROAD \_\_\_\_\_ LOT \_\_\_\_\_  
Holiday Hills Vista Rd. 26  
PROPERTY OWNER \_\_\_\_\_  
ADDRESS Holiday Hills Baptist Church

### SPECIFICATIONS

- Church and Sunday School Rooms  
DRAIN FIELD \_\_\_\_\_ DEPTH \_\_\_\_\_ FEET, BOTTOM AREA \_\_\_\_\_ SQ. FT.  
SEEPAGE PITS \_\_\_\_\_ ABSORBENT SIDE-WALL AREA \_\_\_\_\_ SQ. FT.  
SEPTIC TANK CAPACITY \_\_\_\_\_ GALLONS  
1000  
FOR GARBAGE GRINDER, INCREASE DISPOSAL AREA 22% & TANK CAPACITY 50%.

### OTHER

~~Two dry wells each 12 ft. in dia. by 8 ft. deep below the inlet located 10 ft. off the front property line and 82 ft. off the right side property line and 55 ft. off the front property line and 60 ft. off the right side property line respectively. Maintain a distance of 35 ft. between dry wells measured edge to edge. Locations determined when facing the lot from Vista Road. Inlet no deeper than 4 ft.~~  
LEACHING BED - 400 sq. ft. in exact location as was given for dry well.

LEACHING BED - call for inspection of leaching bed excavation before any gravel is installed.  
PLANS APPROVED BY \_\_\_\_\_ DATE \_\_\_\_\_

J. Hennigan

4/30/65

FILL SEPTIC TANK AND DISTRIBUTION BOX WITH WATER BEFORE CALLING FOR AN INSPECTION. COVER NO WORK UNTIL INSPECTED AND APPROVED.

NEITHER THE HOWARD COUNTY COMMISSIONERS NOR THE HEALTH DEPARTMENT IS RESPONSIBLE FOR THE SUCCESSFUL OPERATION OF ANY SYSTEM.

Not in digital health  
no address

A 10036

A10036

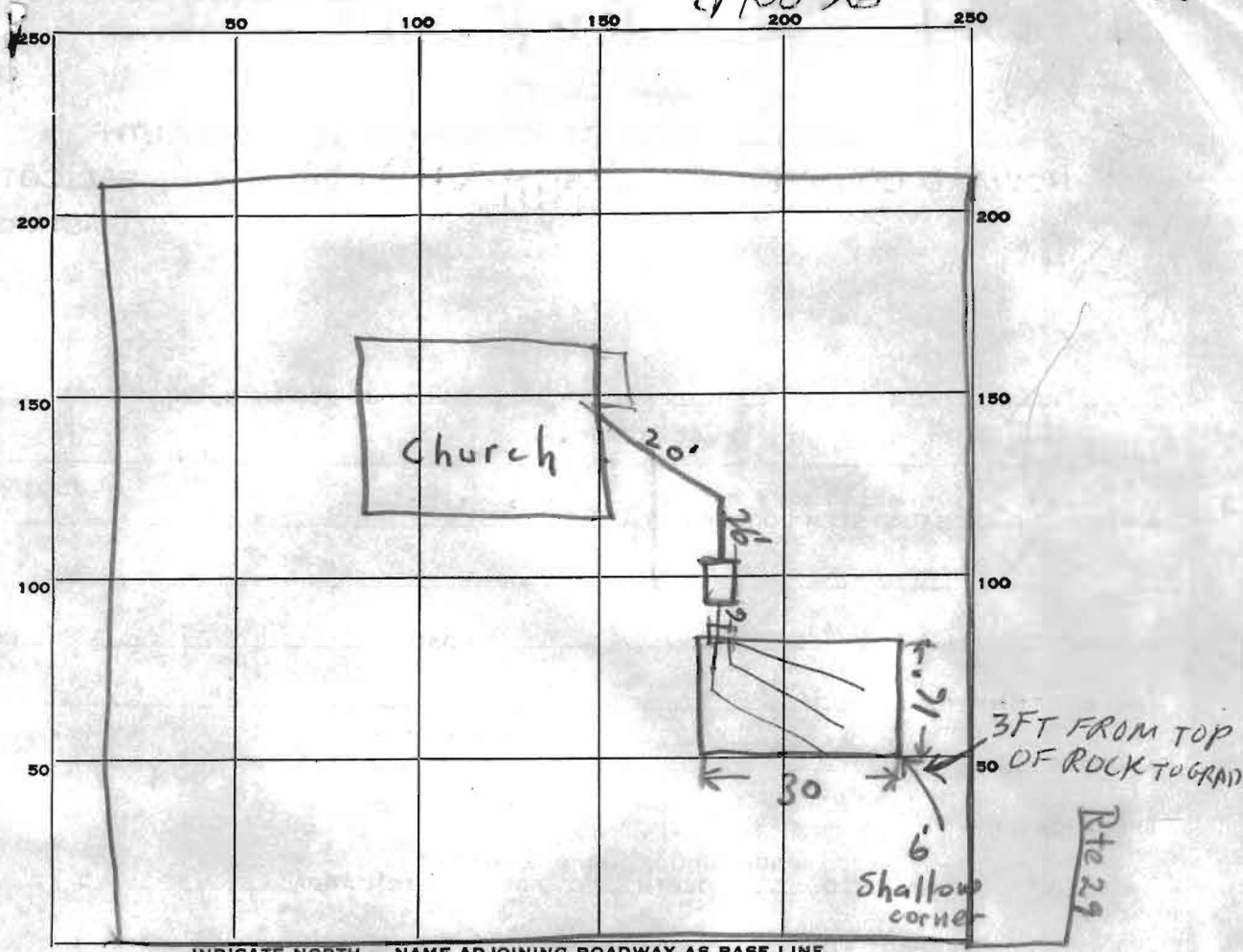

INDICATE NORTH. - NAME ADJOINING ROADWAY AS BASE LINE.

PERMIT CARD yes Vista Rd

SEPTIC TANK, LEVEL OK Top is 4ft sft below grad CLEANOUTS OK

DISTRIBUTION BOX, LEVEL \_\_\_\_\_

16  
30  
480

LEACHING BED

TILE FIELD, DEPTH 6-7 FT. TRENCH WIDTH 16 FT.

GRAVEL DEPTH 36 IN. TOTAL LENGTH 30 FT.

NUMBER OF TRENCHES \_\_\_\_\_ TOTAL BOTTOM AREA 480

SEEPAGE PITS, INSIDE DIAMETER \_\_\_\_\_ FT. DEPTH BELOW INLET \_\_\_\_\_ FT.

ABSORBENT AREA \_\_\_\_\_ SQ. FT.

REMARKS 8/2/65 - Partial OK, - OK to cover work to septic tank - JH

A 10036 Tests in area of L.B. 5 in at 5' 45"

4 in at 9', 13 in at 9 ft. 4/23/65

Sandy soil all way down JH

DATE SYSTEM APPROVED 3 AUG 65 INSPECTOR Raymond Hodges