

10/17/62

# PERMIT

P 05829  
A 05307

SEWAGE DISPOSAL SYSTEM

MARYLAND STATE DEPARTMENT OF HEALTH

HOWARD COUNTY

ELLICOTT CITY

INDEXED

DISTRICT 2

DATE 9/24/62

*Emerson League*

IS PERMITTED TO INSTALL  ALTER

ADDRESS \_\_\_\_\_

PHONE \_\_\_\_\_

A SEWAGE DISPOSAL-SYSTEM LOCATED AT \_\_\_\_\_

*PT 40 - 600 ft east of St. John's Lane*

SUBDIVISION \_\_\_\_\_

ROAD \_\_\_\_\_

LOT \_\_\_\_\_

PROPERTY OWNER \_\_\_\_\_

*Charles E. Miller  
Miller Chevrolet*

ADDRESS \_\_\_\_\_

SPECIFICATIONS

DRAIN FIELD \_\_\_\_\_ DEPTH \_\_\_\_\_ FEET, BOTTOM AREA \_\_\_\_\_ SQ. FT.

SEEPAGE PITS \_\_\_\_\_ ABSORBENT SIDE-WALL AREA \_\_\_\_\_ SQ. FT.

SEPTIC TANK CAPACITY 1250 GALLONS

FOR GARBAGE GRINDER, INCREASE DISPOSAL AREA 22% & TANK CAPACITY 50%.

OTHER \_\_\_\_\_

*Leaching Bed - 800 sq ft. Leaching Bed - not over*

*4 feet deep in area tested. For our wash water - Separate*

*system consisting of traps and 2 - 8' x 10' dry wells*

PLANS APPROVED BY \_\_\_\_\_

*Palmer F. Wine*

DATE \_\_\_\_\_

*6/19/62*

FILL SEPTIC TANK AND DISTRIBUTION BOX WITH WATER BEFORE CALLING FOR AN INSPECTION. COVER NO WORK UNTIL INSPECTED AND APPROVED.

NEITHER THE HOWARD COUNTY COMMISSIONERS NOR THE HEALTH DEPARTMENT IS RESPONSIBLE FOR THE SUCCESSFUL OPERATION OF ANY SYSTEM.

*Not in Digital Health  
9035? Bait Mate Pickers  
index card (?)*

A505307  
~~A05307~~

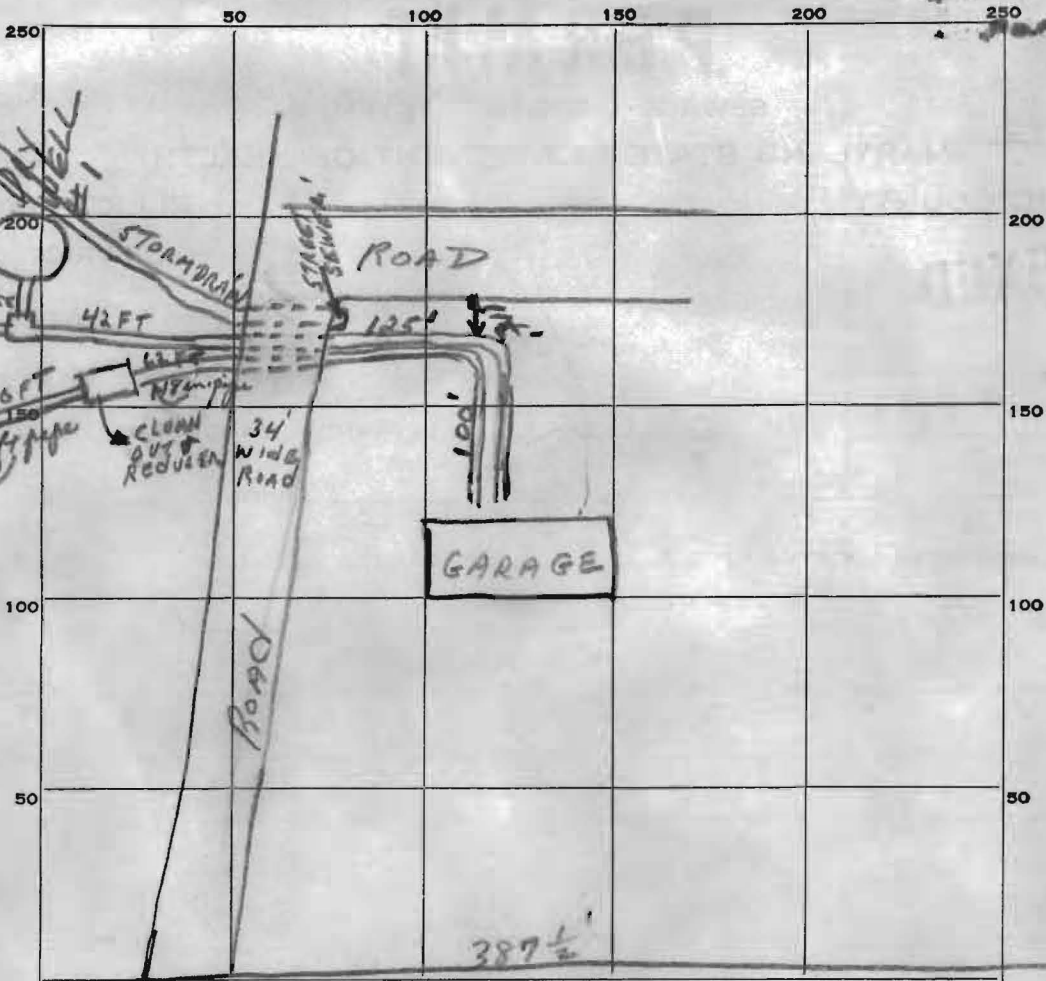

INDICATE NORTH. - NAME ADJOINING ROADWAY AS BASE LINE.

RT 40

39'  
+ 22'  
---  
61'  
+ 78'  
---  
139'  
+ 78'  
---  
217'  
+ 25'  
---  
242'  
- 210'  
---  
32'

PERMIT CARD yes

SEPTIC TANK, LEVEL bed

1250 gal concrete

CLEANOUTS cap on bed septic tank

cap on dry wells septic tank

DISTRIBUTION BOX, LEVEL bed

concrete - 3 outlets

FIELD, DEPTH 5 ft shallow side bed

FT.

TRENCH WIDTH 22'

FT.

GRAVEL DEPTH bed

IN.

TOTAL LENGTH 51'

FT.

NUMBER OF TRENCHES \_\_\_\_\_

TOTAL BOTTOM AREA 1130 sq. leaching bed

SEEPAGE PITS, INSIDE DIAMETER \_\_\_\_\_ FT.

DEPTH BELOW INLET \_\_\_\_\_ FT.

ABSORBENT AREA \_\_\_\_\_

SQ. FT.

REMARKS one ft. concrete tile in leaching

10 ft. dia by 10 ft deep below the inlet - dry well # 1

10 ft dia by 10 ft " " " " - " " # 2

10-17-62 Need more stone in dry wells. JH

10-18-62 Stone in dry wells ok. up to cover. JH. OK to approve layout

grease traps not installed. 10-19-62 Told man who works for S. Frigo to call for inspection on grease traps. JH.

DATE SYSTEM APPROVED \_\_\_\_\_

INSPECTOR \_\_\_\_\_

Complete 8/23/63 - Garage in operation