

C1 7017 SEQUENCE NO. (MDE USE ONLY)

STATE OF MARYLAND WELL COMPLETION REPORT FILL IN THIS FORM COMPLETELY PLEASE TYPE

THIS REPORT MUST BE SUBMITTED WITHIN 45 DAYS AFTER WELL IS COMPLETED.

COUNTY NUMBER (13) A518599

1 2 3 6 (THIS NUMBER IS TO BE PUNCHED IN COLS. 3-6 ON ALL CARDS)

ST/CO USE ONLY DATE Received MM DD YY 8 13

DATE WELL COMPLETED MM DD YY 4 5 07

Depth of Well 22 100 26 5/31/07 (TO NEAREST FOOT) O.K. (BP)

PERMIT NO. FROM "PERMIT TO DRILL WELL" HO-95-0741 28 29 30 31 32 33 34 35 36 37

OWNER Peddicord David STREET OR RFD Sheppard Manor Drive TOWN Ellicott City SUBDIVISION Sheppard Manor SECTION LOT 19

WELL LOG Not required for driven wells STATE THE KIND OF FORMATIONS PENETRATED, THEIR COLOR, DEPTH, THICKNESS AND IF WATER BEARING

GROUTING RECORD WELL HAS BEEN GROUTED (Circle Appropriate Box) TYPE OF GROUTING MATERIAL (Circle one) CEMENT [CM] BENTONITE CLAY [BC] NO. OF BAGS 30 NO. OF POUNDS 2820 GALLONS OF WATER 180 DEPTH OF GROUT SEAL (to nearest foot) from 0 to 18 ft.

CASING RECORD casing types insert appropriate code below MAIN CASING TYPE ST Nominal diameter top (main) casing (nearest inch)! 06 Total depth of main casing (nearest foot) 21

OTHER CASING (if used) diameter inch depth (feet) from to ST 5 17 38

SCREEN RECORD screen type or open hole (insert appropriate code below) ST BR HO PL OT

NUMBER OF UNSUCCESSFUL WELLS: 0 WELL HYDROFRACTURED [Y] [N] CIRCLE APPROPRIATE LETTER A A WELL WAS ABANDONED AND SEALED WHEN THIS WELL WAS COMPLETED E ELECTRIC LOG OBTAINED P TEST WELL CONVERTED TO PRODUCTION WELL

C 2 DEPTH (nearest ft.) 1 2 100 21 100 1 8 9 11 15 17 21 23 24 26 30 32 36 38 39 41 45 47 51 SLOT SIZE 1 2 3 DIAMETER OF SCREEN (NEAREST INCH) 56 60 from to

C 3 PUMPING TEST HOURS PUMPED (nearest hour) 03 8 9 PUMPING RATE (gal. per min.) 15 11 15 METHOD USED TO MEASURE PUMPING RATE 194L. WATER LEVEL (distance from land surface) BEFORE PUMPING 15 17 20 ft. WHEN PUMPING 23 22 25 ft. TYPE OF PUMP USED (for test) [A] air [P] piston [T] turbine [C] centrifugal [R] rotary [O] other [J] jet [S] submersible

PUMP INSTALLED DRILLER INSTALLED PUMP (CIRCLE) (YES or NO) YES [NO] IF DRILLER INSTALLS PUMP, THIS SECTION MUST BE COMPLETED FOR ALL WELLS. TYPE OF PUMP INSTALLED PLACE (A,C,J,P,R,S,T,O) IN BOX 29. CAPACITY: GALLONS PER MINUTE (to nearest gallon) 31 35 PUMP HORSE POWER 37 41 PUMP COLUMN LENGTH (nearest ft.) 43 47 CASING HEIGHT (circle appropriate box and enter casing height) [+] above } LAND SURFACE [-] below } 01 (nearest foot)

I HEREBY CERTIFY THAT THIS WELL HAS BEEN CONSTRUCTED IN ACCORDANCE WITH COMAR 26.04.04 "WELL CONSTRUCTION" AND IN CONFORMANCE WITH ALL CONDITIONS STATED IN THE ABOVE CAPTIONED PERMIT, AND THAT THE INFORMATION PRESENTED HEREIN IS ACCURATE AND COMPLETE TO THE BEST OF MY KNOWLEDGE.

DRILLERS LIC. NO. 1 M SD 009 DRILLERS SIGNATURE (MUST MATCH SIGNATURE ON APPLICATION) LIC. NO. 1 D

GRAVEL PACK IF WELL DRILLED WAS FLOWING WELL INSERT F IN BOX 68 68

MDE USE ONLY (NOT TO BE FILLED IN BY DRILLER) T (E.R.O.S.) W Q 70 72 74 75 76

SITE SUPERVISOR (sign. of driller or journeyman responsible for sitework if different from permittee)

TELESCOPE CASING LOG INDICATOR OTHER DATA

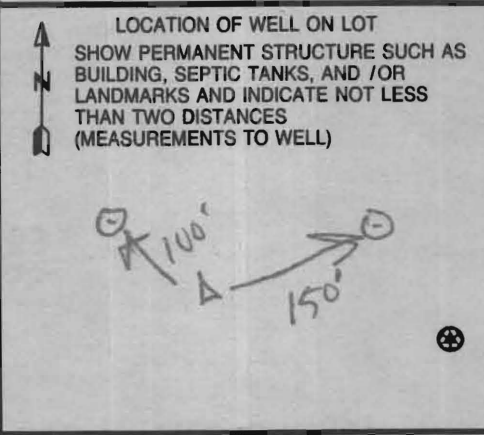

B 1 5803

SEQUENCE NO. (MDE USE ONLY)

STATE OF MARYLAND APPLICATION FOR PERMIT TO DRILL WELL please type 526205

STATE PERMIT NUMBER

HO-95-0741 fill in this form completely

Date Received (APA)

OWNER INFORMATION

Williamsburg Group LLC 5485 Harpers Farm Rd. Columbia md 21044

LOCATION OF WELL

Howard COUNTY Sheppard Manor SECTION 44 LOT 19 West Friendship NEAREST TOWN MILES FROM TOWN 5

DRILLER INFORMATION

Allen Compton M S D 009 Fogles Well Drilling 580 obrecht Rd. 1-23-07

DIRECTION OF WELL FROM TOWN

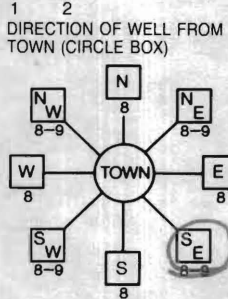

MANOR DRIVE

Sheppard Lane NEAR WHAT ROAD ON WHICH SIDE OF ROAD DISTANCE FROM ROAD 55 ENTER FT OR MI TAX MAP: 29 BLK: 1 PARCEL 268

WELL INFORMATION

APPROX. PUMPING RATE 5 (GAL. PER MIN.) AVERAGE DAILY QUANTITY NEEDED 500 (GAL. PER DAY)

NOT TO BE FILLED IN BY DRILLER HEALTH DEPARTMENT APPROVAL

Howard 13 A518599 COUNTY NAME COUNTY NO. STATE SIGNATURE Brian Baber 2/28/2008 DATE ISSUED 2/28/2008 CO SIGNATURE EXP. DATE NORTH GRID 515 000 EAST GRID 817 000

USE FOR WATER (CIRCLE APPROPRIATE BOX)

- DOMESTIC POTABLE SUPPLY & RESIDENTIAL IRRIGATION (circled) FARMING (LIVESTOCK WATERING & AGRICULTURAL IRRIGATION) INDUSTRIAL, COMMERCIAL, DEWATERING PUBLIC WATER SUPPLY WELL TEST, OBSERVATION, MONITORING GEO-THERMAL

APPROXIMATE DEPTH OF WELL 300 FEET APPROXIMATE DIAMETER OF WELL 6 INCH NEAREST TOWN

SHOW MAJOR FEATURES OF BOX & LOCATE WELL WITH AN X SOURCES OF DRILLING WATER

Sample Collected @ field test 4/5/07 Kw

METHOD OF DRILLING (circle one)

BORED (or Augered) AIR-ROTary (circled) AIR-PERcussion ROTARY (Hydraulic Rotary) CABLE REVerse-ROTary DRive-POINT other

WRITE THE BOX NUMBER FROM THE MAP HERE E 817 N 515

REPLACEMENT OR DEEPEMED WELLS (CIRCLE APPROPRIATE BOX)

THIS WELL WILL NOT REPLACE AN EXISTING WELL THIS WELL WILL REPLACE A WELL THAT WILL BE ABANDONED AND SEALED THIS WELL WILL REPLACE A WELL THAT WILL BE USED AS A STANDBY-CONTACT LOCAL APPROVING AUTHORITY FOR POLICY ON STANDBY WELLS THIS WELL WILL DEEPEM AN EXISTING WELL PERMIT NUMBER OF WELL TO BE REPLACED OR DEEPEMED

DRAW A SKETCH BELOW SHOWING LOCATION OF WELL IN RELATION TO NEARBY TOWNS AND ROADS AND GIVE DISTANCE FROM WELL TO NEAREST ROAD JUNCTION



Not to be filled in by driller (MDE OR COUNTY USE ONLY)

APPROX. PERMIT NUMBER H02005_G007 PERMIT No. HO-95-0741

SPECIAL CONDITIONS Wells to be Drilled Per Approved Shared Septic System Plans Health Dept. Must Collect Water Sample During Yield Test

**HOWARD COUNTY HEALTH DEPARTMENT
BUREAU OF ENVIRONMENTAL HEALTH
WELL & SEPTIC PROGRAM
TEL: (410)313-1771 FAX: (410)313-2648**

Information Form for the Installation of the Well Pump, Pitless Adapter, and Supply Piping

NOTE: The installer is responsible for requesting an inspection prior to 9 am on the day of the desired inspection. No work is to be covered until approved by the Health Department. All installations must comply with the National Standard Plumbing Code (NSPC, as amended locally) and COMAR 26.04.04 (MD Well Construction Regulations). Submission of a complete form is required prior to Use and Occupancy approval.

Company Name: Fogle's Well Drilling Telephone #: 443-609-4195
Address: P.O. Box 202
Woodbine, MD 21797

(Must circle one) Licensed Plumber Licensed Well Driller Licensed Well Pump Installer

License # and name of individual responsible for the field installation:

Name (Print): Allen Compton License# MSD 009

***A licensed individual must perform the actual installation. Apprentices must be under the supervision of a licensed journeyman or master plumber, pump installer or well driller. Licenses may be subjected to field verification. Unlicensed individuals may be reported to the appropriate licensing agency.**

Name of Property Owner: Williamsburg Homes Telephone #: 410-977-8800
Subdivision: Sheppard Manor Lot #: 19 Well Tag #: HO-95-0741
Site Address: 4622 Sheppard Manor DR.

Submersible Pump Data

Make: Grundfos
Model #: ISSGE07-18C
Pump Capacity 15 GPM
Well Yield: 15 GPM

Pitless Adapter

Make: Complete
Model#: win
Depth: 42 (36" min)
NSF/WSC approved: yes

Well Cap and Electric Conduit

Two piece watertight cap: yes
Screened, vented well cap: yes
Cap secured to casing: yes
Conduit min 18" B.G.: yes
Conduit secured to well cap: yes

Depth of well encountered at time of pump installation: 120' (feet)
If pump capacity exceeds well yield, a low water cut off switch is required by NSPC 1990 Section 17.8.4

Torque arrestors, Cable guards, or other acceptable method used—Must circle one

Safety rope, if used, attached to brass rope adapter or other acceptable method inside of well casing n/a

Piping to house

Type: 1" Black Plastic
PSI: 160 (160 psi min)
Depth of supply line: 42" (36" min)

House Connection

PVC sleeve to undisturbed soil at wall penetration: yes
Length of sleeve(s' minimum from foundation): 5'
Sleeve sealed properly: yes

The water supply line is required to be at least ten feet from the septic tank, pump chamber, sewage piping, distribution box, drainfields, and sewage reserve area. If this cannot be accomplished, contact this office for approval prior to installation.

Signature of company representative responsible for installation: Allen Compton date: 10/14/10

For Health Department Use Only – Not to be completed by Installer

Date Insp. Requested: _____ Date Insp. Approved: _____ Inspector: _____
Inspection Data: Pitless adapter watertight & water supply line at least 36" below grade _____
Two piece cap installed and attached to casing securely _____
Elec. conduit extends at least 18" below grade/attached to cap properly _____
Safety rope not outside of well cap/casing _____
Correct well tag attached properly and casing 8" above finished grade _____
Water supply line sleeved adequately at house connection _____
Adequate grout observed below pitless adapter _____

**HOWARD COUNTY HEALTH DEPARTMENT
BUREAU OF ENVIRONMENTAL HEALTH
WATER AND SEWERAGE PROGRAM
TEL: (410)313-2640 FAX: (410)313-2648**

Information Form for the Installation of the Well Pump, Pitless Adapter, and Supply Piping

NOTE: The installer is responsible for requesting an inspection prior to 9 am on the day of the desired inspection. No work is to be covered until approved by the Health Department. All installations must comply with the National Standard Plumbing Code (NSPC, as amended locally) and COMAR 26.04.04 (MD Well Construction Regulations). Submission of a complete form is required prior to Use and Occupancy approval.

Company Name: _____ Telephone #: _____
Address: _____

(Must circle one) Licensed Plumber Licensed Well Driller Licensed Well Pump Installer

License # and name of individual responsible for the field installation:

Name (Print): _____ License# _____

***A licensed individual must perform the actual installation. Apprentices must be under the direct supervision of a licensed journeyman or master plumber, pump installer or well driller. Licenses may be subjected to field verification.**

Name of Property Owner: _____ Telephone #: _____
Subdivision: _____ Lot #: _____ Well Tag #: HO - ____ - ____
Site Address: _____

Submersible Pump Data

Make: _____
Model #: _____
Pump Capacity _____ GPM
Well Yield: _____ GPM

Pitless Adapter

Make: _____
Model#: _____
Depth: _____ (36" min)
NSF approved: _____

Well Cap and Electric Conduit

Two piece watertight cap: _____
Screened, vented well cap: _____
Cap secured to casing: _____
Conduit min 18" B.G.: _____
Conduit secured to well cap: _____

Depth of well encountered at time of pump installation: _____ (feet)
If pump capacity exceeds well yield, a low water cut off switch is required by NSPC 1990 Section 17.8.4

Torque arrestors or Cable guards are required - Must circle one
Safety rope, if used, attached to inside of well casing with eye bolt _____

Piping to house

Type: _____
PSI: _____ (160 psi min)
Depth of supply line: _____ (36" min)

House Connection

PVC sleeved to undisturbed soil at wall penetration: _____
Approximate length of sleeve: _____
Sleeve caulked and sealed properly: _____

The water supply line is required to be at least ten feet from the septic tank, pump chamber, sewage piping, distribution box, drainfields, and sewage reserve area. If this cannot be accomplished, contact this office for approval prior to installation.

Signature of company representative responsible for installation _____ date _____

For Health Department Use Only - Not to be completed by Installer

Date Insp. Requested: _____ Date Insp. Approved: OK 10/12/10
Inspection Data: Pitless adapter and water supply line at least 36" below grade _____
Two piece cap installed and attached to casing securely _____
Elec. conduit extends at least 18" below grade attached to cap properly _____
Safety rope installed inside of well casing _____
Correct well tag attached properly and casing 3" above finished grade _____
Water supply line sleeved adequately at house connection _____
Adequate grout observed below pitless adapter _____

SHEPPARD LANE

(SCENIC ROAD)

(MINOR COLLECTOR)

(PUBLIC COUNTY ROAD)

Land dedicated to Howard
Maryland for the purpose
of a public road: 36,126.77'

Inv.: 378.55'

15" CLASS IV Ex. Utility Pole
Rcp Culvert
62 LF
to be relocated

GE108704

384

CP67 382

CP68 380

Ex. 12" CMP
(To Remain)

CP68

626.51'

-1+00

(S)
(T)

(S)
(2)

N40°45'49"E

Ex. Paving

Nose Down

NON-BUILDABLE PRESERVATION PARCEL 'C'

Area (This Sheet): 1.5648 ac.±
Total Area: 9.6994 ac.±
Privately Owned and Maintained
Easement Holders:
HOA and Howard County

Private
Entrance Feature
Easement

LOT 19

49,998sf±

75' BRL

FF: 394.10
B: 384.10

50' BRL

30' BRL

20'x20' Public Sewer
and Utility Easement

Proposed 25" Public Tree
Speed Limit 10' Sign
Maintenance
Easement

10' BRL

10' BRL

FF: 395.50
B: 385.50

LOT 18
47,701sf±

LOD

2/28/07
Mill Site
Stabled by FSH

BB

Ex. Well

100'R

382

30'

3+00' BRL



Penny E. Borenstein, M.D., M.P.H., Health Officer

ATTENTION WELL DRILLERS!!!

When submitting a well application for a new or replacement well, please indicate one of the following:

- The well site has been staked by FSH Associates on 1-26-07 and is ready for site inspection.
- _____ will call the Health Department for a time to meet in the field to verify a well location.
- Site plan for new well is attached to well permit application.

Please attach this sheet when submitting your green application. This should help improve communication allowing a more timely service for our citizens.

KN



Howard County
Health Department

Bureau of Environmental Health
7178 Gateway Drive Columbia, MD 21046
(410) 313-2640 Fax (410) 313-2648
TDD (410) 313-2323 Toll Free 1-866-313-6300
Website: www.hchealth.org

Peter Beilenson, M.D., M.P.H., Health Officer

January 20, 2011

Homeowner
4602 Sheppard Manor Drive
Ellicott City, MD 21042

RE: Sheppard Manor, Lot 19
4602 Sheppard Manor Drive
BP #: B09001863
Well Tag: HO-95-0741

Dear Sir:

This is to advise you that the septic system for the above referenced property has been installed and inspected. **Final approval of the septic system was granted on 01/19/2011. Final approval of the well line connection to the dwelling was approved on 10/12/2010.**

The water sample results indicate that the water samples submitted for testing were free of coliform and fecal coliform bacteria at the time of sampling and are bacteriologically safe for drinking. The water sample results were found to be in compliance with COMAR water quality standards.

Gross Alpha and Beta samples were also collected on 04/05/2007. Results showed a Gross Alpha level of **2.7 +/- 1.2 pCi/L** and **Gross Beta** level of **0.9 +/- 1.1 pCi/L**. The **Gross Alpha** was below the maximum contaminant level (MCL) of 15 pCi/L, while the Gross Beta was below the MCL of 50pCi/L. Future well water supply appears safe for all uses.

Enclosed with this certificate, is a copy of the septic permit and the as-built along with important information regarding the use and maintenance of your septic system. Please read through carefully and thoroughly. Any questions regarding your well and/or septic, please call this office for guidance 410-313-1771.

INTERIM CERTIFICATE OF POTABILITY

This certifies that the initial sampling requirements of COMAR 26.04.04 "Well Regulations" have been met for the water supply system installed under well permit #HO-95-0741. Although the submitted sample results are in compliance with COMAR standards, the Health Department does not guarantee water supplies. Based upon satisfactory investigation and evaluation, the Howard County Health Department as authorized by the Maryland Department of the Environment accepts this well system as required by COMAR 26.04.04.

This certificate may become final upon completion of the second bacteriological test, which is to be taken by the county health department within six months of receipt of this letter. **Please contact (410) 313-1773 to schedule a final water sample appointment. Currently, there is no charge for this final sampling.**

Date of Water Samples: 01/17/2011
Date of Radium Samples: 04/05/2007
Date of Well Completion: 10/31/2006

Approving Authority,

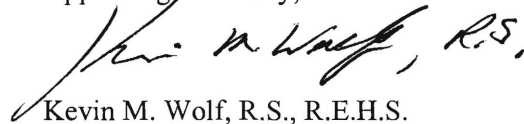

Kevin M. Wolf, R.S., R.E.H.S.
Environmental Sanitarian
Well & Septic Program

cc: Building Inspector's Office
Community Hygiene Program
File

FOUNTAIN VALLEY ANALYTICAL LABORATORY, INC.

1413 Old Taneytown Rd. Westminster, MD (410) 848-1014 (410) 876-4554 FAX (410) 848-0298

REPORT OF ANALYSIS

Laboratory ID #:	78217	Account #:	4470
Reference:	Sheppard Manor Lot 19	Company:	Williamsburg Group LLC
Location:	4602 Sheppard Manor Drive	Requested By:	Chip Lundy/ Bob Corbett
	Ellicott City, MD 21042	Source:	Well Water
Date/ Time Collected:	1/17/2011 1132	Site:	Pressure Tank ✓
Date/Time Rec'd:	1/17/2011 1317	Treatment:	None
Chlorine ppm:	Free: ND Total: ND	pH:	7.0
Collected By:	J.Yeager 6176JY	Well #:	HO-95-0741 ✓

PARAMETERS	RESULTS	UNITS	REFERENCE	METHOD	DATE/TIME/ANALYST
Bacteria, Coliform, Total, MPN	<1.0	MPN/ 100 ml	<1.0	SM18 9223	1/18/2011 / 0900 / KME
Bacteria, E. coli, MPN	<1.0	MPN/ 100 ml	<1.0	SM18 9223	1/18/2011 / 0900 / KME
Nitrate	9.79	mg/L	10	601	1/17/2011 / 1630 / CCH
Turbidity	1.17	NTU	<10	SM18 2130B	1/17/2011 / 1335 / KME
Sand	NS	mg/L	5	Visual/Gravimetric	1/17/2011 / 1335 / KME

OK

NOTES

- 1 mg/L = milligrams per liter (also, parts per million)
- 2 MPN/ 100 ml = Most Probable Number [of viable bacteria] per 100 ml of sample.
- 3 NS = None Seen (NS indicates less than 5 mg/L)
- 4 NTU = Nephelometric Turbidity Units
- 5 Results less than or within the reference range are considered satisfactory and within potable water limits at the time of sampling.
- 6 ND:None Detected
- 7 Visual well check: Sealed, vented cap
- 8 pH and Chlorine level tested on site

Reason for Test : Use & Occupancy
 Building Permit # : 09-001863

Date Reported: 1/18/2011

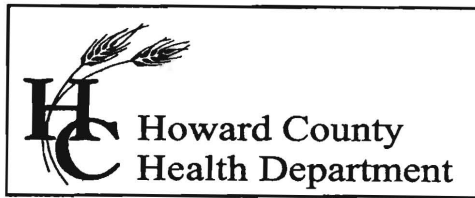

Bureau of Environmental Health
7178 Columbia Gateway Drive, Columbia, MD 21046
(410) 313-2640 Fax (410) 313-2648
TDD (410) 313-2323 Toll Free 1-866-313-6300
website: www.hchealth.org

Peter L. Beilenson, M.D., M.P.H., Health Officer

May 24, 2007

Williamsburg Group LLC
5485 Harpers Farm Road
Columbia, Maryland 21044

RE: Sheppard Manor, Lot#19
Well Tag: HO-95-0741

To Whom It May Concern:

A sample was collected from a yield test on April 5, 2007 and submitted to GPL Laboratories to assess the possible presence of **Gross Alpha** and **Gross Beta** in the future well water supply. **Gross Alpha** and **Gross Beta** measure the total alpha and beta particle activity in a water supply. In turn, this can provide information regarding naturally occurring radiation (i.e., Radionuclides) that may exist in your area of development within the County.

Results from this screening revealed a **Gross Alpha** of 2.7 ± 1.2 picocuries/liter (pCi/L); while the **Gross Beta** level was 0.9 ± 1.2 pCi/L. The **Gross Alpha** result was below its **maximum contaminant level (MCL)** of 15 pCi/L, while the **Gross Beta** level was below its target value of 50 pCi/L (roughly equivalent to the **annual dose rate of 4 millirems/year**).

At the time of testing and with respect to these parameters, the future well water supply appears safe for all uses. No additional testing for these parameters will be required to secure the future Use & Occupancy. However, other standard (potability) testing will still be necessary.

A copy of the test results is enclosed for your information. Please call this office at 410-313-1773 if you have any further questions.

Sincerely,



Bert Nixon, Deputy Director
Bureau of Environmental Health

cc: Eric Dougherty, MDE Water Mgmt., Groundwater
✓ Well & Septic File

Send Report To:

Bert Nixon

State of Maryland
DHMH - Laboratories Administration
Division of Environmental Chemistry
RADIATION LABORATORY

201 W. Preston Street, Baltimore, Maryland 21201

John M. DeBoy, Dr. P.H., Director

LABORATORY ANALYSIS REQUEST

Sample Bottle No. A: 40-95-0741 No. B: _____ Field Blank Bottle No. A: _____ No. B: _____

Plant/Site Name: Shopped Manor Lot 19 County: Howard

Sample Source: Shopped Manor Dr Location: 40-95-0741
(well no., lab sink, sample tap, etc.)

County: 1 3 Plant No.

CHECK (one per box)

Drinking Water
Landfill
Stream
Other

Community
Non-community
Private
Other

Source (raw water)
Distribution (treated)
MCL

Emergency
Routine
Recheck
Special

Collector: K. Wolf

Telephone No: 410-313-2645

Date Collected: 4/5/07

Time Collected: 10 a.m. _____ p.m.

Nitric Acid Preserved: Yes No

Iced: Yes No

Submitters Code: Federal Project: Field Data: _____

pH _____ Chlorine _____

Remarks: sample collected @ field test

✓	Test	EPA Code	Laboratory No.	Results (pCi/L)	Date Reported
✓	Gross Alpha	4000	704044-001	1.5 ± 0.9 2.7 ± 1.2	4/10/07
✓	Gross Beta	4100		1.5 ± 0.9 1.5 ± 0.3	4/10/07
	Radon-222 Bottle A	4004		0.9 ± 1.2	
	Radon-222 Bottle B	4004			
	Field Blank A	4004			
	Field Blank B	4004			
	Tritium				
	Ra - 226	4020			
	Ra - 228	4030			
	Total Uranium	4006			

Date Received: _____ / _____ / _____

Supervisor: _____