

Formerly 2200 Alpha Center Dr

DEPARTMENT OF INSPECTIONS, LICENSES AND PERMITS
3430 COURT HOUSE DRIVE
ELLCOTT CITY, MD 21043
PERMITS (410) 313-2455 INSPECTIONS (410) 313-1810
AUTOMATED INFORMATION (410) 313-3800

HOWARD COUNTY
PERMIT APPLICATION

PERMIT NUMBER

Building Address 2260 Scotts Wheeler Dr
Rt 144 MARLBOROUGH MD 21091
Suite/Apt. #: Bldg 4 SDP/WP/Petition #: _____
Census Tract _____ Subdivision _____
Section _____ Area _____ Lot _____
Tax Map 16 Parcel 253 Grid 8
Zoning _____ Map Coordinates 10 Hz Lot size 38-23 Acres

Property Owner's Name Howard COM Land
Address 3430 Court House Drive
City Ellicott City State MD Zip Code 21043
Phone _____ Phone _____
Applicant's Name & Mailing Address, (if other than stated hereon):
Phone _____ Fax _____

Existing Use TRAINING (Fire Ground)
Proposed Use SAME WITH TANKS
Estimated Construction Cost \$ 2000.00
Description of Work Install (2) 1000 Gallon
UG LP PROPANE Tank and run
Lines to Bldg 4

Contractor Company Michel Welding & Mechanical
Contact Person Robert J Michel Sr
Address 2518 Green Rd
City Baldwin State MD Zip Code 21013
License No. 73061
Phone 4106925416 Fax _____

Occupant or Tenant Public Safety Training
Contact Name Logan Godfrey
Address _____
City _____ State _____ Zip Code _____
Phone _____ Fax _____
410-313-6165

Engineer or Architect Company _____
Contact Person _____
Address _____
City _____ State _____ Zip Code _____
Phone _____ Fax _____

BUILDING DESCRIPTION - COMMERCIAL

BUILDING DESCRIPTION - RESIDENTIAL

Building Characteristics
Height: _____
No. of stories: _____
Gross area, sq. ft. per floor: _____
Use group: _____
Construction type:
 Reinforced Concrete
 Structural Steel
 Masonry
 Wood Frame
 State Certified Modular

Utilities
Water Supply:
 Public
 Private
Sewage Disposal:
 Public
 Private no toilets
Electric Yes No
Gas Yes No
Heating System:
Electric Oil
Natural Gas
Propane Gas
Sprinkler system: N/A
 Full
 Partial
 Other Suppression
 # of Heads

Building Characteristics
SF Dwelling SF Townhouse
Depth Width
1st floor: _____
2nd floor: _____
Basement:
Finished Basement Unfinished Basement
 Crawl space Slab on Grade
No. of Bedrooms _____
Height: _____
Multi-family dwellings:
No. of efficiency units: _____
No. of 1 BR units: _____
No. of 2 BR units: _____
No. of 3 BR units: _____
Other Structure: _____
Dimensions: _____
Footings: _____
Roof Height: _____
 State Certified Modular
 Manufactured Home

Utilities
Water Supply:
 Public
 Private
Sewage Disposal:
 Public
 Private
Electric Yes No
Gas Yes No
Heating System:
Electric Oil
Natural Gas
Propane Gas
Sprinkler system: N/A
 NFPA #13D
 NFPA #13R
 Other:

THE UNDERSIGNED HEREBY CERTIFIES AND AGREES AS FOLLOWS: (1) THAT HE/SHE IS AUTHORIZED TO MAKE THIS APPLICATION; (2) THAT THE INFORMATION IS CORRECT; (3) THAT HE/SHE WILL COMPLY WITH ALL REGULATIONS OF HOWARD COUNTY WHICH ARE APPLICABLE THERETO; (4) THAT HE/SHE WILL PERFORM NO WORK ON THE ABOVE REFERENCED PROPERTY NOT SPECIFICALLY DESCRIBED IN THIS APPLICATION; (5) THAT HE/SHE GRANTS COUNTY OFFICIALS THE RIGHT TO ENTER ON THIS PROPERTY FOR THE PURPOSE OF INSPECTING THE WORK PERMITTED AND POSTING NOTICES.

Michel Welding & Me. Repair
Applicant's Signature
Title/Company

Robert T Michel Sr
Print Name
6/30/08
Date

Checks payable to: **DIRECTOR OF FINANCE OF HOWARD COUNTY**
** PLEASE WRITE NEATLY AND LEGIBLY. **
- FOR OFFICE USE ONLY -

AGENCY	DATE	SIGNATURE APPROVAL
Land Development, DPZ		
State Highways		
Building Official		
Dev. Engineering, DPZ		
Health	<u>7/2/2008</u>	<u>R Buehler</u>
Fire Protection		

Is Sediment Control approval required prior to issuance?
YES NO

CONTINGENCY CONSTRUCTION START:
ONE STOP SHOP:

Distribution of Copies- White: Building Official Green: LDD, DPZ
T:\forms\PERMIT.FRM

DPZ SETBACK INFORMATION	PROPERTY ID#:
Front: _____	Filing fee \$ _____
Rear: _____	Permit fee \$ _____
Side: _____	Excise tax \$ _____
Side St.: _____	Add'l per. fee \$ _____
All minimum setbacks met? YES <input type="checkbox"/> NO <input type="checkbox"/>	TOTAL FEES \$ _____
Is Entrance Permit required? YES <input type="checkbox"/> NO <input type="checkbox"/>	Sub-total paid \$ _____
Historic District? YES <input type="checkbox"/> NO <input type="checkbox"/>	Balance due \$ _____
Lot Coverage for NewTown Zone _____	Check # _____
SDP/Red-line approval date _____	Validation # _____

Accepted by _____
Gold: SHA

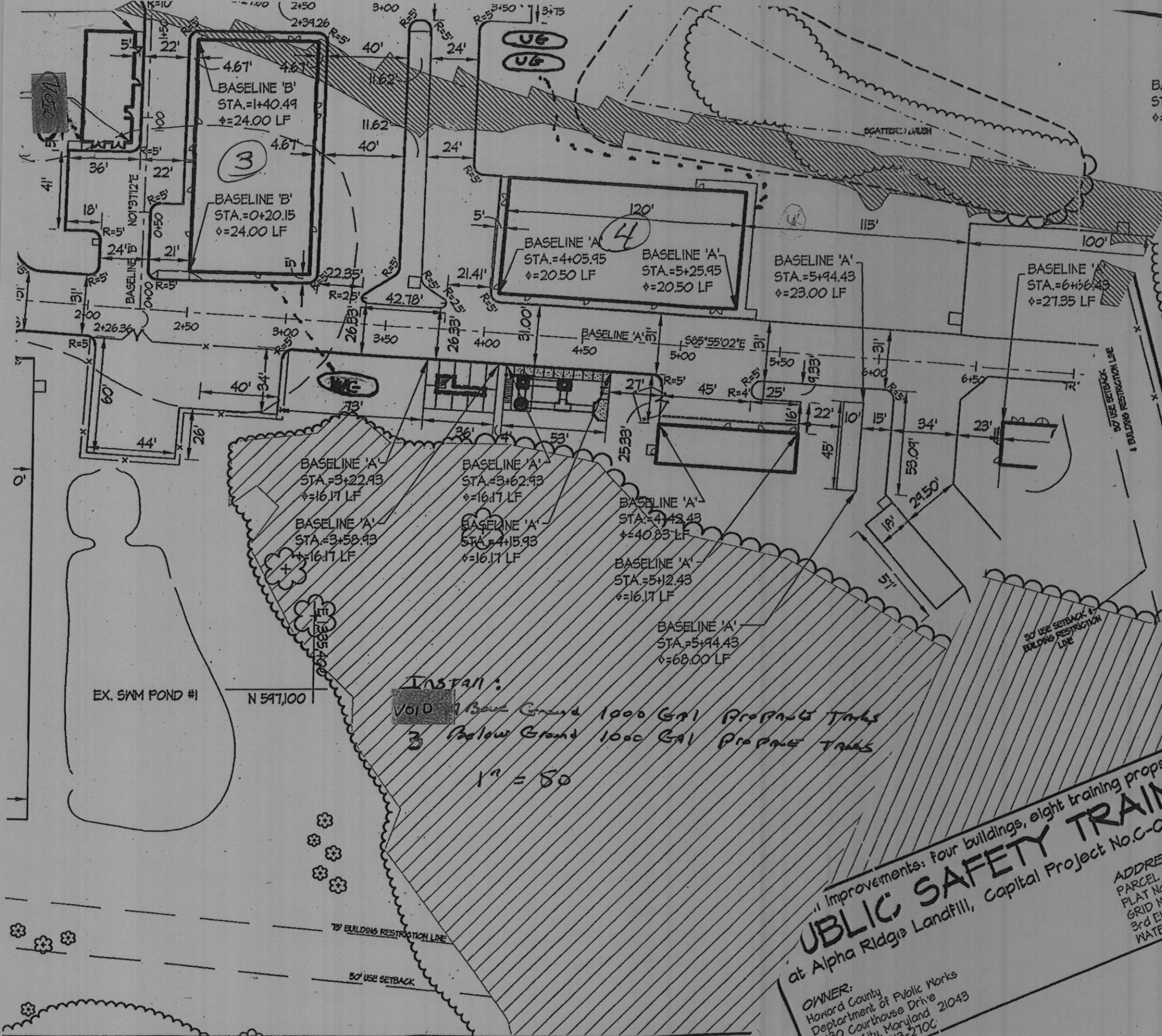

BASELINE 'A'
STA.=7+96.2
ϕ=180.55

APPROVED BUILDING PERMIT

WALKTHRU BUILDING PERMIT A#
DATE: 7/2/08
APP. SAN P. B. B. # 2 x 1000-gal PROPANE TANKS
DESC. OF WORK: Bldg 4 approved as shown

Formerly Alpha Center Dr.
2200 Alpha Center Dr.
Now Scott Wheeler Dr.
2200 Scott Wheeler Dr.
(Public Safety Training Center)
at Alpha Ridge

C2.00
SCALE:
1"=50'
SHEET
12 OF 10

Improvements: four buildings, eight training props and associated infrastructure
PUBLIC SAFETY TRAINING CENTER
at Alpha Ridge Landfill, Capital Project No. C-0182, Howard County, Maryland
OWNER:
Howard County
Department of Public Works
3430 Courthouse Drive
Ellicott City, Maryland 21043
Phone (410) 313-2700
ADDRESS / PERMIT INFORMATION:
PARCEL #253, L6689 / F 619
PLAT No. 2/8, ZONE: RC-DEO, TAX MAP No. 16
3rd Election District, Census Tract 6030
WATER CODE: T30, SEWER CODE: Private - Holding Tank

EX. SWM POND #1 N 597,100

INSTALL:
VOID 1 Below Ground 1000 GAL PROPANE TANKS
3 Below Ground 1000 GAL PROPANE TANKS
1" = 80'

HOWARD COUNTY, MARYLAND
PARCEL 200
1746843 ACRES +/-
ZONING: RC-DEO