

Formerly 2200 Alpha Center Dr.

DEPARTMENT OF INSPECTIONS, LICENSES AND PERMITS
3430 COURT HOUSE DRIVE
ELICOTT CITY, MD 21043
PERMITS (410) 313-1455 INSPECTIONS (410) 313-1810
AUTOMATED INFORMATION (410) 313-3800

HOWARD COUNTY
PERMIT APPLICATION

PERMIT NUMBER

Building Address 2230 Scotts Wheel Dr
Rt 144 Marriottsville MD 21044
Suite/Apt. #: Bull 3 SDP/WP/Petition #: _____
Census Tract _____ Subdivision _____
Section _____ Area _____ Lot _____
Tax Map 16 Parcel 253 Grid 8
Zoning _____ Map Coordinates 10H2 Lot size 38.23 Acres

Property Owner's Name Howard Co MD Land
Address 3430 Court House Drive
City Elicott City State MD Zip Code 21093
Phone _____ Phone _____
Applicant's Name & Mailing Address, (if other than stated hereon):
Phone _____ Fax _____

Existing Use Simulation Bldg (Police)
Proposed Use SAME WITH TANK
Estimated Construction Cost \$ 1000.-
Description of Work Install (1) 1000
991 UG LP TANK AND RUN
LINE TO BUILDING

Contractor Company Michel Weldy
Contact Person Robert J Michel Sr
Address 2518 Green Rd
City Baldwin State MD Zip Code 21013
License No. 73061
Phone 6425416 Fax _____

Occupant or Tenant Public Safety Training
Contact Name Logan Godfrey
Address _____
City _____ State _____ Zip Code _____
Phone 410 313 6165 Fax _____

Engineer or Architect Company _____
Contact Person _____
Address _____
City _____ State _____ Zip Code _____
Phone _____ Fax _____

BUILDING DESCRIPTION - COMMERCIAL

BUILDING DESCRIPTION - RESIDENTIAL

Building Characteristics

Height: _____
No. of stories: _____
Gross area, sq. ft. per floor: _____
Use group: _____
Construction type:
 Reinforced Concrete
 Structural Steel
 Masonry
 Wood Frame
 State Certified Modular

Utilities

Water Supply:
 Public
 Private
Sewage Disposal:
 Public
 Private
Electric Yes No
Gas Yes No
Heating System:
Electric Oil
Natural Gas
Propane Gas
Sprinkler system: N/A
 Full
 Partial
 Other Suppression
 # of Heads

Building Characteristics

SF Dwelling SF Townhouse
Depth Width
1st floor: _____
2nd floor: _____
Basement: _____
Finished Basement Unfinished Basement
 Crawl space Slab on Grade
No. of Bedrooms _____
Height: _____
Multi-family dwellings:
No. of efficiency units: _____
No. of 1 BR units: _____
No. of 2 BR units: _____
No. of 3 BR units: _____
Other Structure: _____
Dimensions: _____
Footings: _____
Roof Height: _____
 State Certified Modular
 Manufactured Home

Utilities

Water Supply:
 Public
 Private
Sewage Disposal:
 Public
 Private
Electric Yes No
Gas Yes No
Heating System:
Electric Oil
Natural Gas
Propane Gas
Sprinkler system: N/A
 NFPA #13D
 NFPA #13R
 Other:

THE UNDERSIGNED HEREBY CERTIFIES AND AGREES AS FOLLOWS: (1) THAT HE/SHE IS AUTHORIZED TO MAKE THIS APPLICATION; (2) THAT THE INFORMATION IS CORRECT; (3) THAT HE/SHE WILL COMPLY WITH ALL REGULATIONS OF HOWARD COUNTY WHICH ARE APPLICABLE THERETO; (4) THAT HE/SHE WILL PERFORM NO WORK ON THE ABOVE REFERENCED PROPERTY NOT SPECIFICALLY DESCRIBED IN THIS APPLICATION; (5) THAT HE/SHE GRANTS COUNTY OFFICIALS THE RIGHT TO ENTER ONTO THIS PROPERTY FOR THE PURPOSE OF INSPECTING THE WORK PERMITTED AND POSTING NOTICES.

Applicant's Signature Michel Weldy - Mac Repair
Title/Company _____

Print Name Robert J Michel Sr
Date 6-30-08

Checks payable to: DIRECTOR OF FINANCE OF HOWARD COUNTY
** PLEASE WRITE NEATLY AND LEGIBLY. **
FOR OFFICE USE ONLY

AGENCY	DATE	SIGNATURE APPROVAL	DPZ SETBACK INFORMATION	PROPERTY ID#:
Land Development, DPZ			Front: _____	Filing fee \$ _____
State Highways			Rear: _____	Permit fee \$ _____
Building Official			Side: _____	Excise tax \$ _____
Dev. Engineering, DPZ			Side St.: _____	Add'l per. fee \$ _____
Health <u>7/2/2008</u>		<u>R. Buehler</u>	All minimum setbacks met?	TOTAL FEES \$ _____
Fire Protection			YES <input type="checkbox"/> NO <input type="checkbox"/>	Sub-total paid \$ _____
Is Sediment Control approval required prior to issuance?			Is Entrance Permit required?	Balance due \$ _____
YES <input type="checkbox"/> NO <input type="checkbox"/>			YES <input type="checkbox"/> NO <input type="checkbox"/>	Check # _____
CONTINGENCY CONSTRUCTION START: <input type="checkbox"/>			Historic District?	Validation # _____
ONE STOP SHOP: <input type="checkbox"/>			YES <input type="checkbox"/> NO <input type="checkbox"/>	
Distribution of Copies- _____	White: Building Official	Green: LDD, DPZ	Lot Coverage for NewTown Zone _____	Accepted by _____
T:forms\PERMIT.FRM			SDP/Red-line approval date _____	Yellow: DED, DPZ
				Pink: Health
				Gold: SHA

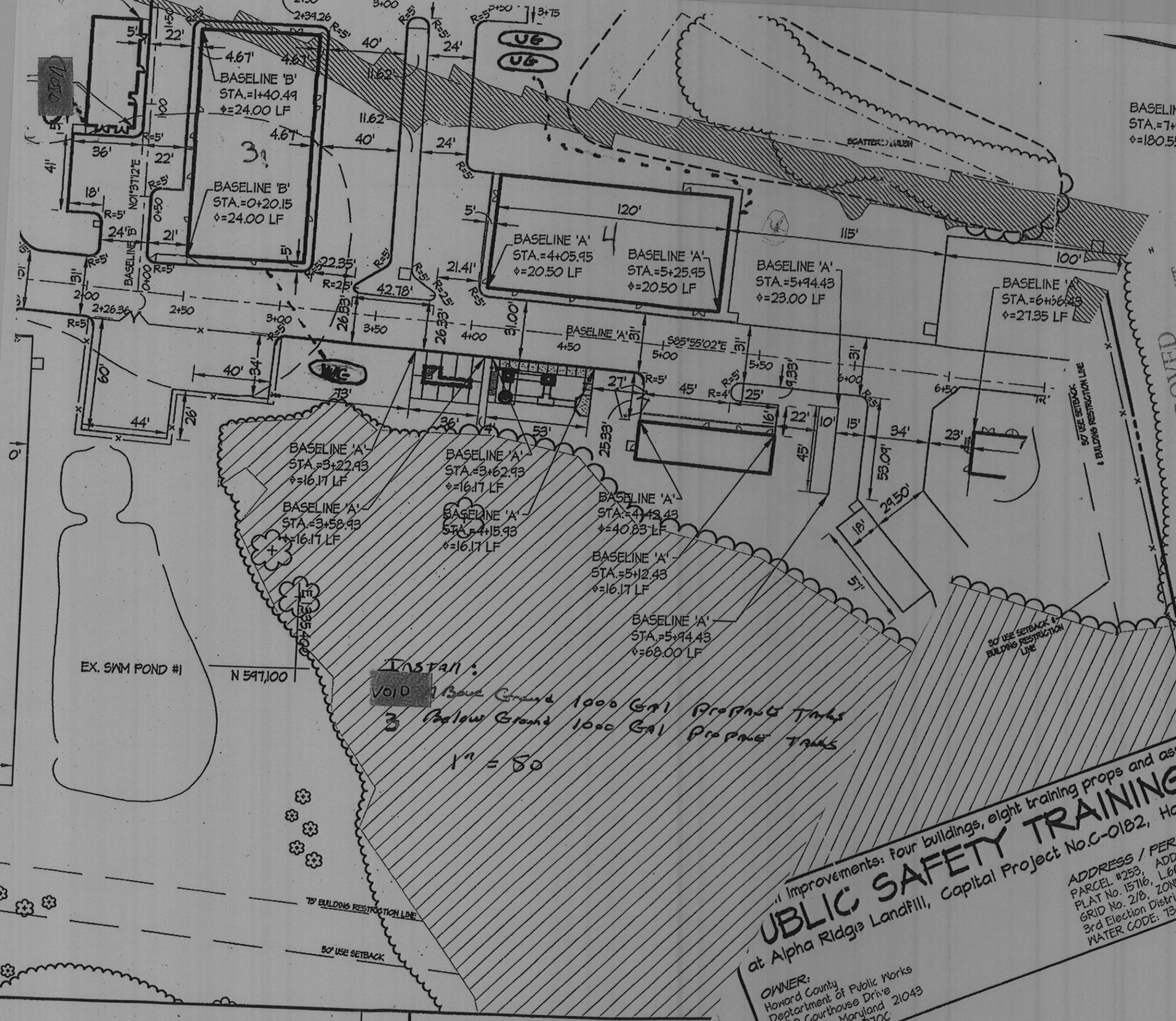

APPROVED PERMIT

WALKTHRU BUILDING A# 7/2/08
 DATE: 7/2/08
 BP# 1000-gal LP tank
 APP. SAN 1000-gal LP tank
 APP. SAN 1000-gal LP tank
 DESC. OF WORK: 1000-gal LP tank
 TO Bldg 3 as shown

Formerly
 2200 Alpha Center Dr
 Now 2200 Scott Wheeler Dr
 (Public Safety Training Center)
 at Alpha Ridge

INSTALL:
 VOID 1 Below Ground 1000 GAL PROPANE TANK
 3 Below Ground 1000 GAL PROPANE TANK
 1" = 50

Improvements: Four buildings, eight training props and associated infrastructure
PUBLIC SAFETY TRAINING CENTER
 at Alpha Ridge Landfill, Capital Project No. C-0182, Howard County, Maryland

ADDRESS / PERMIT INFORMATION:
 PARCEL #253, ADDRESS: 2200 Alpha Center Drive
 PLAT No. 15716, L6689 / F 619
 GRID No. 2/B, ZONE: RC-DEO, TAX MAP No. 16
 3rd Election District, Census Tract 6030
 WATER CODE: 130, SEWER CODE: Private - Holding Tank

OWNER:
 Howard County
 Department of Public Works
 3430 Courthouse Drive
 Ellicott City, Maryland 21043
 Phone (410) 313-2100

C2.00
 SCALE:
 1"=50
 SHEET
 12 OF 10