







May 15, 2007

Ms. Avis Corbin  
Howard County Department Of Inspections  
George Howard Building  
3430 Court House Drive  
Ellicott City, Maryland 21043

**REVISED**

Date: 5/15/07

Comments: ~~B06006112~~

Re: B06006112  
Pindell Woods Lot #18  
7224 Preservation Court  
Fulton, MD 20759

Dear Ms. Avis Corbin:

Pursuant to our Amendment for the above referenced property we submitted February 2007, enclosed please find (2) copies of the revised drawings of the lower level removing the Dental Office and X-Ray room from the plans originally submitted.

The Health Department and Planning & Zoning have advised we would be unable to install a Dental Office and X-Ray room at this time. Therefore, we have advise our homeowners of this decision, enclosed please find the May 2, 2007 letter to our homeowners. We are submitting the appropriate drawings to have the amendment released.

Should you have any questions or require additional information, please call me at (410) 995-6736.

Very truly yours,

A handwritten signature in cursive script that reads "Amy Ferrer".

Amy Ferrer

Client Contract Administrator

CC: Health

A handwritten note enclosed in a hand-drawn circle. The text inside the circle reads "OK of ZONING 5/15/07".



RECEIVED

FEB 13 2007

LICENSES & PERMITS  
DIVISION

February 5, 2007

CK 20694  
INV. 87564  
\$ 50.00

Ms. Avis Corbin  
Howard County Department Of Inspections  
George Howard Building  
3430 Court House Drive  
Ellicott City, Maryland 21043

Re: B06006112  
Pindell Woods Lot #18  
7224 Preservation Court  
Fulton, MD 20759

*Revision  
Rejected*

Dear Ms. Avis Corbin:

We are requesting an amendment to the above referenced property

The actual building footprint has not changed, however, the floor plan and layout has. Enclosed please find two (2) sets of new building drawings, along with the approved building permit set.

*NOTE: REVISED FOR GBR & HOME OCCUPATION DENTAL OFFICE*

Should you have any questions or require additional information, please call me at (410) 995-6736.

Very truly yours,

A handwritten signature in cursive script that reads "Amy Ferrer".

Amy Ferrer  
Selections Administrator

*CC: Zoning  
Health*

**HOWARD COUNTY**  
**DEPARTMENT OF INSPECTIONS, LICENSES & PERMITS**  
**3430 COURT HOUSE DRIVE**  
**ELLCOTT CITY, MD 21043**

**RESIDENTIAL**  
**BUILDING PERMIT**

**RESIDENTIAL**

**Permit Number:** B06006112  
**Application Date:** 10/17/06

**Permit Type:** New - SFD  
**Issue Date:** 02/02/07

**SITE ADDRESS:**

7224 PRESERVATION CT  
FULTON, MD 20759

**PROPERTY OWNER INFO.:**

MOUNT VIEW LLC  
6300 WOODSIDE CT  
COLUMBIA, MD 21046  
Phone #: 410-995-6736

**Subdivision:** PINDELL WOODS , Lot No. 18

**Tax Map:** 41 **Grid:** 8

**Zoning District:** RR-DEO

**SDP No.:**

**Census Tract:** 605102

**W&S Contract No.:**

**Grading Permit No.:**

**DESCRIPTION OF WORK :** SINGLE FAMILY DWELLING, FINISHED BASEMENT WITH FULL BASEMENT 5 BEDROOMS, L 3 CAR GARAGE, 4 FULL BATHS, 1 HALF BATH, 2 GAS FIREPLACES AND PATIO. \*AMENDMENT RECEIVED 11-6-2006 TO CHANGE LOCATION OF HOUSE\*

**PRIMARY CONTRACTOR INFO:**

Home Bldr License No.: 870  
AMYFERRER  
6300 Woodside Court  
A  
Columbia, MD 21046  
Phone #: 410-995-6736

**PRIMARY CONTACT INFO:**

Contact Type: Contact  
  
AMY FERRER  
6300 WOODSIDE COURT STE A  
COLUMBIA, MD 21046  
Phone #: 410-995-6736

**Building/Lot Characteristics:**

Legal Description: LOT 18 1.004 A.[ ]7224 PRESERVATIONCT[ ]PINDELL WOODS INCL A RSB

Existing Use:

Height: ft.

Basement: Partially Finished

SF # of Bedrooms: 5

SF # of Full Baths:

SF # of Half Baths:

Water Supply: Private

Sewage Disposal: Private

**Zoning Setback Requirements:**

**Front:** Proposed: n/a Required: 79  
**Rear:** Proposed: n/a Required: 30  
**Side:** Proposed: n/a Required: 10  
**Side Street:** Proposed: n/a Required: n/a  
Meets Minimum Required Setbacks?: Yes  
Lot Coverage for NT Zoning:

**Permit Fees:**

Total Fees Invoiced: \$ 20343.84  
Total Fees Paid: \$ 20343.84  
Balance Due: \$ .00

To schedule an inspection or check the results of an inspection please call (410) 313-3800

**5**

**APPROVED BY THE DIRECTOR OF INSPECTIONS, LICENSES & PERMITS - BUILDING OFFICIAL**

PREPARED BY: **RJK**  
CHECKED BY:

**GENERAL NOTES**

- SCALE:**  
Do not scale drawings. All shop drawings are to be reviewed by the Architect prior to fabrication and erection.
- DIMENSIONS:**  
Dimensions shown are to face of masonry foundation, faces of sheathing for exterior walls, face of stud for interior walls or face of structural member for structural plans.
- APPLICABLE CODES:**  
International Residential Code (IRC) 2003 edition  
-OR-  
International Building Code (IBC) 2003 edition  
International Mechanical Code 2003 edition  
International Plumbing Code 2003 edition  
International Energy Conservation Code 2003 edition  
International Fuel Gas Code 2003 edition  
National Electric Code 2008 edition  
NFPA Life Safety Code 2000 edition  
NFPA 13 Standard for the Installation of Sprinklers 2002 edition  
All Local Codes and Amendments
- PERMITS:**  
Prior to construction, the General Contractor shall be required to obtain all applicable permits associated with the project with the following exceptions: Plumbing Permits to be obtained by the plumbing sub-contractor; Electrical Permits to be obtained by the electrical sub-contractor; HVAC Permits to be obtained by the mechanical sub-contractor; and Sprinkler Permits (if applicable), to be obtained by the sprinkler sub-contractor. No construction or installation shall begin until all required permits have been obtained and thoroughly reviewed. General Contractor is responsible for obtaining final Use and Occupancy certificate.
- JOB SITE:**  
Prior to submitting any Proposal, all contractors shall visit the site and notify the Owner, Architect or General Contractor of any conditions not accounted for herein that require corrective or additional actions. No changes to these plans may be made without approval by the Architect.
- INSTALLATION:**  
All materials, supplies and equipment shall be installed per manufacturer's recommendations and per applicable codes and requirements. The Architect shall not have control or charge of, and shall not be responsible for the construction methods, techniques, sequences or procedures in connection with the work, for acts or omissions of the sub-contractor or any other person performing any of the work, or the failure of any person or material to carry out the work in accordance with the contract documents.
- MATERIAL STORAGE:**  
Material stored on site shall be protected from damage by moisture, wind, sun, abuse or any other harmful effects.
- PRODUCTS USED:**  
Manufacturers names and model numbers listed herein are for establishing a quality of product for a specific design configuration. Equal or better products may be substituted only if prior approval is obtained by the Owner, Architect or General Contractor.
- SAFETY:**  
All Subcontractors are responsible for safety precautions or safety programs required to provide a safe working environment on the job site. Unsafe conditions shall be reported to the jobsite supervisor immediately.

REVISIONS		
SYMBOL	DATE	ISSUED FOR
△	12-20-06	WINDOW 100-03 RELOCATED
△	12-20-06	SUNDECK SUPPORT REVISED- BRICK PIERS ADDED
△	12-27-06	FLOOR DRAIN ADDED TO SPA
△	01-09-07	SUNROOM/SITTING ROOM SIZE INCREASED
△	01-09-07	DOOR 100-01 REVISED TO FWH0811A1PLR
△	02-12-07	DENTAL OFFICE SUBGRADE MECHANICALS ADDED
△	03-20-07	GARAGE SLAB ELEVATION REVISED
△	03-20-07	DOOR 101-003 REVISED FROM 2888 TO 3088
△	05-14-07	DENTAL OFFICE: X-RAY DELETED

PROJECT PHASE  
**RFP/Construction Drawing**

PROJECT NAME AND ADDRESS  
**the Baptist Residence  
Pindell Woods Lot 18  
Fulton, MD**

SHEET TITLE  
**LOWER LEVEL  
PLAN**

FILE  
PW18\_Baptiste\_CD1.0

SCALE  
AS NOTED

DATE  
02-05-2007

SHEET  
**A-100**

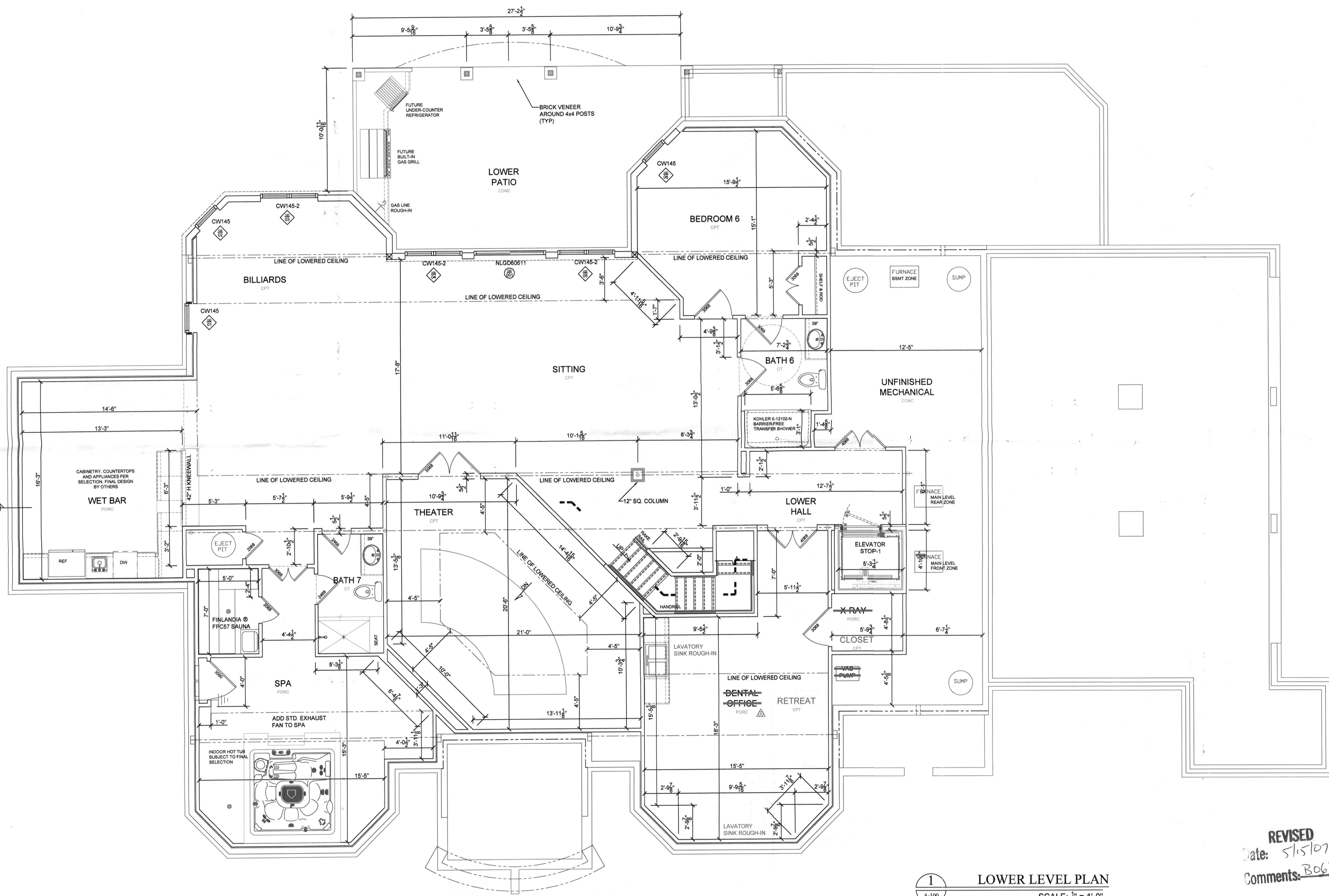

**1 LOWER LEVEL PLAN**  
A-100  
SCALE: 1/4" = 1'-0"  
3266.8587 SF SLAB AREA  
2808.7743 SF FINISHED AREA  
350.4036 SF PATIO

**REVISED**  
Date: 5/15/07  
Comments: B0620612