

HOWARD COUNTY
PERMIT APPLICATION

PERMIT NUMBER

000157147

Building Address 13293 HUNT RIDGE
ELICOTT CITY, MD 21042

Suite/Apt. #: --- SDP/WP/Petition #: ---

Census Tract --- Subdivision ---

Section --- Area --- Lot ---

Tax Map --- Parcel --- Grid ---

Zoning --- Map Coordinates --- Lot size ---

Property Owner's Name CHARLES & LISA WHITE

Address 13293 HUNT RIDGE ELICOTT CITY, MD

City ELICOTT CITY State MD Zip Code 21042

Home Phone 410 531-5912 Work Phone 443 479-0670

Applicant's Name & Mailing Address, (if other than stated hereon):
SAME

Phone --- Fax ---

Existing Use RES.

Proposed Use RES.

Estimated Construction Cost \$ 40,000

Description of Work ADD ONE 18'x24'
ADDITION TO LEFT SIDE
OF STRUCTURE. ONE LEVEL
ON CRAWL SPACE

Contractor Company ---

Contact Person ---

Address ---

City --- State --- Zip Code ---

License No. ---

Phone --- Fax ---

Occupant or Tenant CHARLES

Contact Name ---

Address ---

City --- State --- Zip Code ---

Phone --- Fax ---

Engineer or Architect Company ---

Contact Person ---

Address ---

City --- State --- Zip Code ---

Phone --- Fax ---

BUILDING DESCRIPTION - COMMERCIAL

BUILDING DESCRIPTION - RESIDENTIAL

Building Characteristics	Utilities
Height: _____	Water Supply: _____ Public <input type="checkbox"/> Private <input type="checkbox"/>
No. of stories: _____	Sewage Disposal: _____ Public <input type="checkbox"/> Private <input type="checkbox"/>
Gross area, sq. ft. per floor: _____	Electric Yes <input type="checkbox"/> No <input type="checkbox"/> Gas Yes <input type="checkbox"/> No <input type="checkbox"/>
Use group: _____	Heating System: _____ Electric <input type="checkbox"/> Oil <input type="checkbox"/> Natural Gas <input type="checkbox"/> Propane Gas <input type="checkbox"/>
Construction type: _____ Reinforced Concrete <input type="checkbox"/> Structural Steel <input type="checkbox"/> Masonry <input type="checkbox"/> Wood Frame <input type="checkbox"/> State Certified Modular <input type="checkbox"/>	Sprinkler system: N/A <input type="checkbox"/> Full <input type="checkbox"/> Partial <input type="checkbox"/> Other Suppression <input type="checkbox"/> # of Heads _____

Building Characteristics	Utilities
SF Dwelling <input type="checkbox"/> SF Townhouse <input type="checkbox"/> Depth _____ Width _____	Water Supply: _____ Public <input type="checkbox"/> Private <input type="checkbox"/>
1st floor: _____	Sewage Disposal: _____ Public <input type="checkbox"/> Private <input type="checkbox"/>
2nd floor: _____	Electric Yes <input type="checkbox"/> No <input type="checkbox"/> Gas Yes <input type="checkbox"/> No <input type="checkbox"/>
Basement: _____ Finished Basement <input type="checkbox"/> Unfinished Basement <input type="checkbox"/> Crawl space <input type="checkbox"/> Slab on Grade <input type="checkbox"/> No. of Bedrooms _____ Height: _____	Heating System: _____ Electric <input type="checkbox"/> Oil <input type="checkbox"/> Natural Gas <input type="checkbox"/> Propane Gas <input type="checkbox"/>
Multi-family dwellings: No. of efficiency units: _____ No. of 1 BR units: _____ No. of 2 BR units: _____ No. of 3 BR units: _____	Sprinkler system: N/A <input type="checkbox"/> NFPA #13D <input type="checkbox"/> NFPA #13R <input type="checkbox"/> Other: _____
Other Structure: _____ Dimensions: _____ Footings: _____ Roof Height: _____ State Certified Modular <input type="checkbox"/> Manufactured Home <input type="checkbox"/>	

THE UNDERSIGNED HEREBY CERTIFIES AND AGREES AS FOLLOWS: (1) THAT HE/SHE IS AUTHORIZED TO MAKE THIS APPLICATION; (2) THAT THE INFORMATION IS CORRECT; (3) THAT HE/SHE WILL COMPLY WITH ALL REGULATIONS OF HOWARD COUNTY WHICH ARE APPLICABLE THERETO; (4) THAT HE/SHE WILL PERFORM NO WORK ON THE ABOVE REFERENCED PROPERTY NOT SPECIFICALLY DESCRIBED IN THIS APPLICATION; (5) THAT HE/SHE GRANTS COUNTY OFFICIALS THE RIGHT TO ENTER ONTO THIS PROPERTY FOR THE PURPOSE OF INSPECTING THE WORK PERMITTED AND POSTING NOTICES.

Applicant's Signature _____
Title/Company _____

Print Name _____
Date _____

Checks payable to: **DIRECTOR OF FINANCE OF HOWARD COUNTY**
** PLEASE WRITE NEATLY AND LEGIBLY. **
- FOR OFFICE USE ONLY -

AGENCY	DATE	SIGNATURE APPROVAL
Land Development, DPZ		
State Highways		
Building Official		
Dev. Engineering, DPZ	11/22/05	<i>[Signature]</i>
Health		
Fire Protection		
Is Sediment Control approval required prior to issuance? YES <input type="checkbox"/> NO <input type="checkbox"/>		
CONTINGENCY CONSTRUCTION START: <input type="checkbox"/>		
ONE STOP SHOP: <input type="checkbox"/>		

DPZ SETBACK INFORMATION	PROPERTY ID#:
Front: _____	Filing fee \$ _____
Rear: _____	Permit fee \$ _____
Side: _____	Excise tax \$ _____
Side St.: _____	Add'l per. fee \$ _____
All minimum setbacks met? YES <input type="checkbox"/> NO <input type="checkbox"/>	TOTAL FEES \$ _____
Is Entrance Permit required? YES <input type="checkbox"/> NO <input type="checkbox"/>	Sub-total paid \$ _____
Historic District? YES <input type="checkbox"/> NO <input type="checkbox"/>	Balance due \$ _____
Lot Coverage for NewTown Zone _____	Check # _____
SDP/Red-line approval date _____	Validation # _____

Distribution of Copies- White: Building Official Green: LDD, DPZ Yellow: DED, DPZ Pink: Health Gold: SHA
T:\forms\PERMIT.FRM

ADDITION 18X24

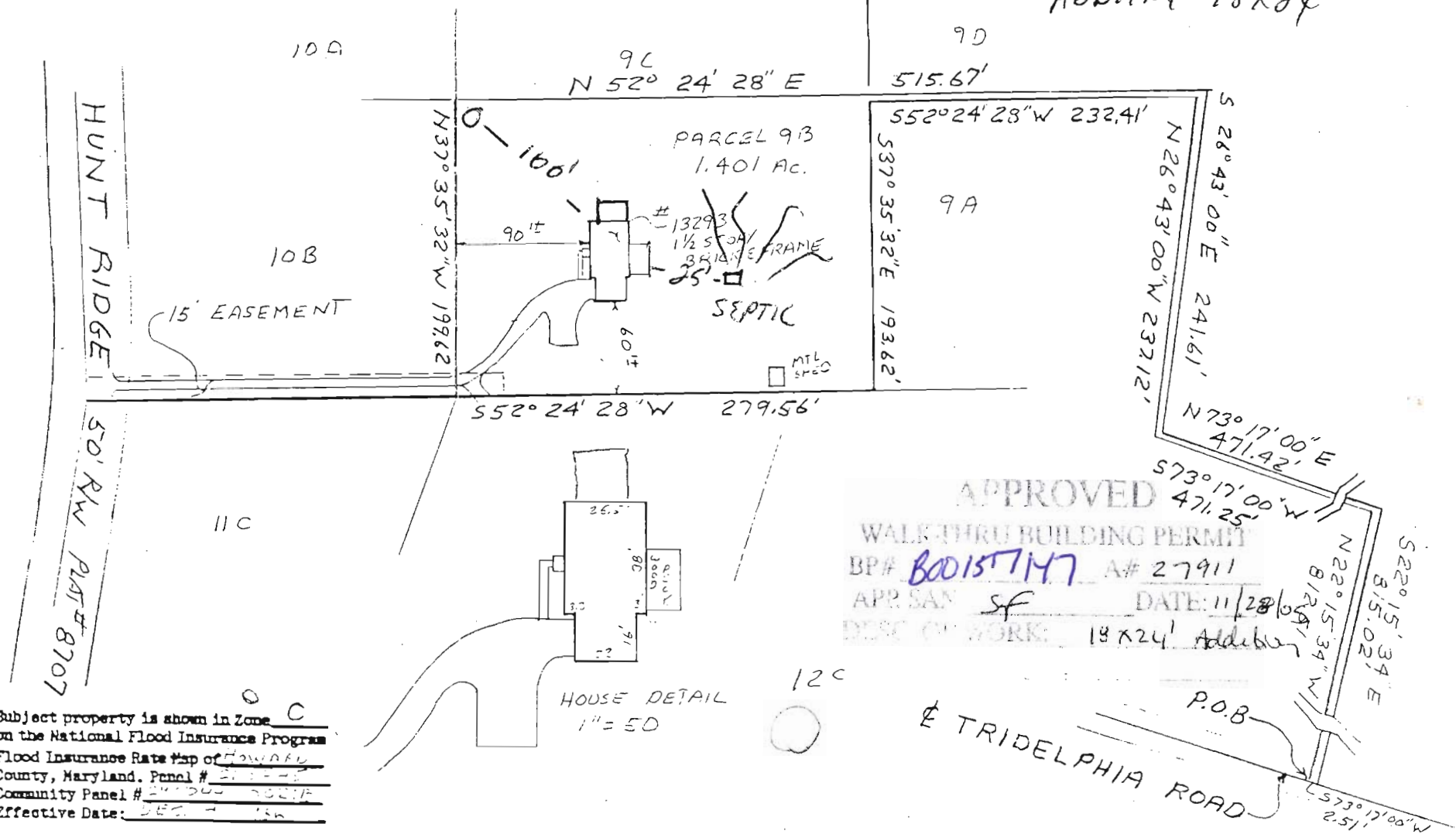

Subject property is shown in Zone C
 on the National Flood Insurance Program
 Flood Insurance Rate Map of HOWARD
 County, Maryland. Panel # 271-1-1
 Community Panel # 271-1-1
 Effective Date: DEC 7 1987

This is to certify that I have surveyed the property shown hereon, being the same property described in a deed from DONALD R. STARN to CHARLES F. WHITE & LISA MARIE WHITE and recorded among the land records of HOWARD COUNTY in Liber 1348 Folio 668 for the purpose of locating the improvements thereon.



THIS PLAT SHOWS ONLY THAT THE IMPROVEMENTS ARE CONTAINED WITHIN THE OUTLINES OF THE LOT AND IS NOT TO BE USED TO ESTABLISH PROPERTY LINES.

LOCATION SURVEY	
13293 HUNT RIDGE	
3rd ELECTION DISTRICT	
HOWARD COUNTY MD	
NTT ASSOCIATES, INC.	Scale 1" = 100'
16205 Old Frederick Road	Date 4-16-92
Mt. Airy, Maryland 21771	Field By JCH
Phone 442-2031	Drawn By JCH
	Drawing # 713251

J. Carl Hudgins PLS#96