

**REQUIRED NOTES PER COMAR 09.1308:**

- 1) THIS PLAT IS OF BENEFIT TO A CONSUMER ONLY INsofar AS IT IS REQUIRED BY A LENDER OR TITLE INSURANCE COMPANY OR ITS AGENT WITH CONNECTION WITH CONTEMPLATED TRANSFER, FINANCING OR REFINANCING.
- 2) THIS PLAT IS NOT TO BE RELIED UPON FOR THE ESTABLISHMENT OR LOCATION OF FENCES, GARAGES, BUILDINGS OR OTHER EXISTING OR FUTURE IMPROVEMENTS.
- 3) THIS PLAT DOES NOT PROVIDE FOR THE ACCURATE IDENTIFICATION OF PROPERTY BOUNDARY LINES, BUT SUCH IDENTIFICATION MAY NOT BE REQUIRED FOR THE TRANSFER OF TITLE OR SECURING FINANCING OR REFINANCING.
- 4) THE LEVEL OF ACCURACY OF APPARENT SETBACK DISTANCES IS WITHIN 3'±.

**NOTES:**

- 1) THIS PLAT IS NOT TO BE RELIED UPON FOR THE ESTABLISHMENT OF PROPERTY LINES AND DOES NOT CONSTITUTE A BOUNDARY SURVEY.
- 2) THIS PLAT WAS PREPARED WITHOUT THE BENEFIT OF A TITLE REPORT.
- 3) THIS PLAT SHOWS THE PRINCIPAL STRUCTURE AND SIGNIFICANT STRUCTURES (CLOSE TO THE APPARENT PROPERTY LINES) AS REQUIRED BY MARYLAND LAW. HOWEVER, ADDITIONAL INTERNAL STRUCTURES MAY NOT BE SHOWN.
- 4) FENCES SHOWN AS --X--X-- ARE APPROXIMATE ONLY. THE EXACT LOCATION OF FENCES AND BOUNDARY LINES CAN BE ACCOMPLISHED WITH A BOUNDARY SURVEY.

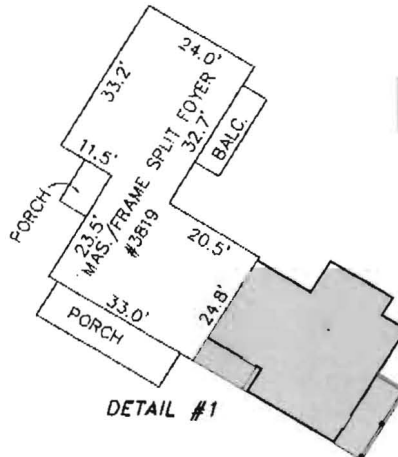

■ = new Addition

**CERTIFICATION:**

THIS IS TO CERTIFY THAT WE HAVE MADE A BUILDING LOCATION AND SAME IS SHOWN HEREON.

*[Signature]*  
 SURVEY SERVICES OF MD, LLC  
 BY ROBERT W. MATIS  
 PROPERTY LINE SURVEYOR NO.605  
 JULY 31, 2007

Angels Quest Enterprises, Inc.  
P.O. Box 171  
Finksburg, MD 21048  
(443) 340-6550 Fax (410) 510-1296  
[angelsquest@comcast.net](mailto:angelsquest@comcast.net)

2010 FEB 23 AM 10:31

February 23, 2010

Bureau of Environmental Health  
Well and Septic Program  
Howard County Health Department  
7178 Columbia Gateway Drive  
Columbia, MD 21046

RE: B08001685 – 3819 Mulligans Hill Lane – Septic System abandonment

Dear Mr. Davis:

This letter is in response to the letter dated February 9, 2010 from Sara Sappington, R.S. to Mr. Christopher Schisler and Mr. Robert Stimmel regarding the failures to provide the abandonment documentation for the above referenced septic system.

The old septic system was properly abandoned when the public sewer connection to the existing dwelling was completed and inspected on Friday, March 13, 2009.

The following events occurred:

- Tuesday, March 10, 2009 - Miss Utility marked locations #9099753 on
- Wednesday, March 11, 2009 - Freedom Septic cleaned out the old septic tank for abandonment.
- Wednesday, March 11, 2009 – Public sewer line connection started. The excavation Company dug a trench and Confer Plumbing Company installed the pipe. One large truck load of stone was used for trench and fill in of the old septic tank.
- Thursday, March 12, 2009 – a 70lb jack hammer was rented from ABC Rental to break up the septic tank lid in order to cave in the old septic tank. The excavation company then filled in the abandoned septic tank with stone. The sewer line was not inspected on this date as the Inspectors were attending a seminar.
- Friday, March 13, 2009 – Sewer line inspection. The Inspector said that everything looked good, passed inspection and gave permission to backfill.

pg.2 –septic system 3819 Mulligans Hill Lane

I have attached the work order invoices and apologize for any inconvenience regarding this matter.

Sincerely,

A handwritten signature in cursive script that reads "Judy Olson, Pres.".

Judy Olson,  
President, Angels Quest Enterprises, Inc.

Attachments

cc: Christopher Schisler  
Robert Stimmel

RECEIVED  
HOWARD COUNTY HEALTH DEPT.  
ENVIRONMENTAL HEALTH

2010 FEB 23 AM 10:31

**FREEDOM SEPTIC SERVICE, INC.**

24 Hour Service  
2809 Liberty Road  
Eldersburg, Maryland 21784  
(410) 795-2947

**JOB WORK ORDER**

029530

DATE OF ORDER 3/9/09

|                                   |  |
|-----------------------------------|--|
| PHONE                             |  |
| BILL TO Judy Olson                |  |
| ADDRESS 3319 Mulligans Hill Lane  |  |
| CITY Ellicott City, MD 21042      |  |
| LOCATION OF SEPTIC left side pipe |  |
| LAST PUMPED                       | NEW CUSTOMER <input checked="" type="checkbox"/> |

DESCRIPTION OF WORK

PAID VISA

Pump septic \$165<sup>00</sup>

A 15% Late Charge will be assessed 30 days after date of service.

**NOTICE TO CUSTOMERS**

I understand that Freedom Septic Service, Inc. is not responsible for any damage to driveway or lawn while rendering services on the above property.

Date Completed

|                 |                     |
|-----------------|---------------------|
| TOTAL MATERIALS |                     |
| TOTAL LABOR     |                     |
| TAX             |                     |
| TOTAL AMOUNT    | \$165 <sup>00</sup> |

- NO ONE AT HOME
- TOTAL AMOUNT DUE FOR ABOVE WORK; OR
- TOTAL BILLING TO BE MAILED AFTER COMPLETION OF THE WORK

Signature \_\_\_\_\_

I hereby acknowledge the satisfactory completion of the above described work



**ABC RENTAL CENTER®**

*If You Have the Job, We Have the Tools!*

**STORE HOURS**  
Monday - Saturday  
7:00am - 5:00pm  
(Sunday Rentals Available)

**LOCATION RENTED FROM:**  
**CATONSVILLE**  
**410-744-2323**  
**800 GEIPE ROAD**  
**CATONSVILLE, MD 21228**

**Catonsville**  
**410-744-2323**  
800 Geipe Road  
Catonsville, MD 21228

**Towson**  
**410-321-6800**  
1628 E. Joppa Road  
Towson, MD 21286

**Columbia**  
**410-381-5111**  
6695 Dobbin Road  
Columbia, MD 21045

[www.abcrentalcenter.com](http://www.abcrentalcenter.com)

| RENTED TO            |  |  | JOB LOCATION    |  |  | INVOICE #            |  |                   |
|----------------------|--|--|-----------------|--|--|----------------------|--|-------------------|
| OLSON, JUDITH ANN    |  |  |                 |  |  | 629600               |  |                   |
| 2556 BIRD VIEW RD    |  |  |                 |  |  | <b>INVOICE DATE</b>  |  |                   |
| WESTMINSTER MD 21157 |  |  |                 |  |  | 03/12/09             |  |                   |
|                      |  |  |                 |  |  | <b>TERMS</b>         |  |                   |
|                      |  |  |                 |  |  | DUE ON RECEIPT       |  |                   |
| <b>RECEIVED BY</b>   |  |  | <b>SOUNDEX</b>  |  |  | <b>DOB</b>           |  |                   |
| OLSON, JUDITH ANN    |  |  | 425-454-067-610 |  |  | 04-AUG-59            |  |                   |
| <b>PO/JOB #</b>      |  |  | <b>PHONE</b>    |  |  | <b>REP</b>           |  |                   |
|                      |  |  | H 443-340-6550  |  |  | DF                   |  |                   |
|                      |  |  |                 |  |  | DF                   |  |                   |
|                      |  |  |                 |  |  | <b>BILL FROM:</b>    |  | 03/12/09 11:45 AM |
|                      |  |  |                 |  |  | <b>RETURNED:</b>     |  | 03/12/09 1:13 PM  |
|                      |  |  |                 |  |  | <b>STATUS</b>        |  |                   |
|                      |  |  |                 |  |  | FINAL                |  |                   |
|                      |  |  |                 |  |  | <b>RENTAL PERIOD</b> |  |                   |

| QTY | ITEM | DESCRIPTION | MIN | DAY | WEEK | 4 WEEK | EXT AMT |
|-----|------|-------------|-----|-----|------|--------|---------|
|-----|------|-------------|-----|-----|------|--------|---------|

|  |           |                         |       |       |        |        |       |
|--|-----------|-------------------------|-------|-------|--------|--------|-------|
| 1                                      | 2235-0326 | HAMMER-70LB. (ELECTRIC) | 55.00 | 70.00 | 245.00 | 572.00 | 55.00 |
| ONLY USE WITH #10 CORD LESS THEN 50 FT |           |                         |       |       |        |        |       |

----- Payments -----  
 \*\*\*\*\* Credit Card Payments \*\*\*\*\*  
 VI Card #: XXXXXXXXXXXX8707 Type: SALE  
 APPROVAL#: 046993 03/12/09 11:48 AM  
 AMOUNT 63.80

|                   |       |                   |       |
|-------------------|-------|-------------------|-------|
| <b>RENT</b>       | 55.00 | <b>PREV PAID</b>  | 0.00  |
| <b>SALES</b>      | 0.00  | <b>PAID NOW</b>   | 63.80 |
| <b>OTHER</b>      | 0.00  |                   |       |
| <b>DMG WAIVER</b> | 5.50  |                   |       |
| <b>SALES TAX</b>  | 3.30  |                   |       |
| <b>DEPOSIT</b>    | 0.00  |                   |       |
| <b>TOTAL DUE</b>  | 63.80 | <b>TOTAL PAID</b> | 63.80 |
| <b>AMOUNT DUE</b> | 0.00  |                   |       |

NOTICE: FAILURE, REFUSAL OR NEGLECT TO RETURN THE RENTAL PROPERTY WITHIN 72 HOURS AFTER THE AGREED RENTAL PERIOD HAS EXPIRED OR THE PRESENTING OF FALSE, FICTITIOUS OR MISLEADING IDENTIFICATION TO **ABC RENTAL CENTER** SHALL BE PRIMA FACIE EVIDENCE OF AN INTENTION TO COMMIT LARCENY. I ACKNOWLEDGE RECEIPT OF EQUIPMENT, I HAVE READ AND I AGREE TO THE TERMS AND CONDITIONS TERMS ON THE REVERSE OF THIS CONTRACT. THERE ARE NO ORAL OR OTHER REPRESENTATIONS NOT INCLUDED HEREIN. ALL RENTALS - CASH IN ADVANCE • WE SELL TIME • WE CHARGE FOR ALL TIME OUT INCLUDING SATURDAYS, SUNDAYS AND HOLIDAYS • SAVE MONEY • RETURN EQUIPMENT PROMPTLY - CLEAN - IN GOOD ORDER • TIRE DAMAGE IS THE RESPONSIBILITY OF THE CUSTOMER. I ACKNOWLEDGE RECEIPT OF A COPY OF THIS CONTRACT

IF CUSTOMER SHALL BE LIABLE FOR AND AUTHORIZE **ABC RENTAL CENTER** TO CHARGE CUSTOMER'S CREDIT CARD FOR ALL RENTAL CHARGES

X

CUSTOMER SIGNATURE

REMIT PAYMENT TO:

CONFER'S PLUMBING & HEATING  
 908 EVERGREEN ROAD  
 SEVERN MD 21144-2053  
 410-969-3980

867551

|   |            |             |           |   |          |      |     |
|---|------------|-------------|-----------|---|----------|------|-----|
| NAME<br>Angel Guest Custom Homes          |            |             |           | SHIP TO<br>3819                         |          |      |     |
| ADDRESS<br>2556 Bradview Rd               |            |             |           | ADDRESS<br>Mulligan Hill Lane           |          |      |     |
| CITY, STATE, ZIP<br>Westminister Md 21157 |            |             |           | CITY, STATE, ZIP<br>Ellicott City 21043 |          |      |     |
| ORDER NUMBER                              | DEPARTMENT | SALESPERSON | WHEN SHIP | TERMS                                   | HOW SHIP | DATE | 1/1 |

| QUANTITY | DESCRIPTION                             |
|----------|---|
| 1        | Run Sewer + pipe                        |
| 1        | REPAIR WATER LINE                       |
| 1        | Fix clo with cap. up top.               |
| 1        | extra clo Behind Addition added.        |
| 1        | Patch + dig up water line "Free"        |
| 1        | PERMIT sewer.                           |
| 1        | install down spout DRAIN + PIPE         |
| 1        | clo on A down spout                     |
|          | JACK HAMMER Lid <sup>fatal</sup> "Free" |
|          | PIZZA - "thanks"                        |

(410) 795-6577  
(301) 854-6388



# Modern Foundations, Inc.

7860 Rabbit Court, Suite A  
Woodbine, MD 21797

## EXCAVATION

Date: 3-11-09

№ 20016

Day: Wednesday

Customer: Angels Quest

Address: 3819 Mulligans Hill Lane

Job: 199-00-1921

Equipment: 442 Mini Excavator Operator: Tina & Carl

Time Started: 8:30 am Time Stopped: 4:00 pm

Total Hours: 7 hrs

Description of work: Dig Trenches for downspout  
pipings Dig trench for sewer line

Signed by: \_\_\_\_\_

Title: \_\_\_\_\_

P.O. No. \_\_\_\_\_

Lunch  No Lunch

1 Load @ 57 Stone

|                    |       |          |
|--------------------|-------|----------|
| Total Hours        | x \$  | per hour |
| Moving Charge      | leave |          |
| Skid loader        | 1 hr  |          |
| 442 Mini Excavator | 6 hrs |          |
|                    | 7 hrs |          |

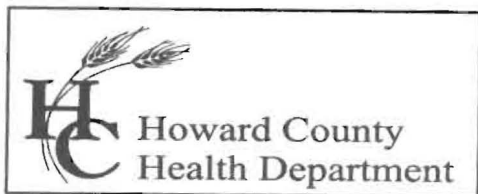

Bureau of Environmental Health  
7178 Columbia Gateway Drive, Columbia, MD 21046  
(410) 313-2640 Fax (410) 313-2648  
TDD (410) 313-2323 Toll Free 1-866-313-6300  
website: [www.hchealth.org](http://www.hchealth.org)

Peter L. Beilenson, M.D., M.P.H., Health Officer

February 9, 2010

Christopher Schisler and Robert Stimmel  
3819 Mulligans Hill Lane  
Ellicott City, Maryland 21043

RE: B08001685  
3819 Mulligans Hill Lane  
Septic system abandonment

Dear Sirs:

This letter is in reference to the abandonment of the existing septic system at 3819 Mulligans Hill Lane. Records indicate that a public sewer connection to the existing dwelling was completed on April 1, 2009. At that time, the existing septic system on the property was to be properly abandoned and documentation sent to the Health Department. The Health Department has not received the abandonment documentation for the septic system and requests immediate action to have it completed. Please forward the paperwork to the above address.

Thank you for your cooperation in this matter. If you have any questions, please contact me at the above address or by calling (410) 313-1771.

Sincerely,

Sara Sappington, R.S.  
Well and Septic Program

*original sent 2/12/10*



OFFICE USE ONLY

# SEWER CONNECTION APPLICATION HOWARD COUNTY

DEPARTMENT OF PUBLIC WORKS  
3430 COURT HOUSE DR. ELLICOTT CITY, MD. 21043

Account No. \_\_\_\_\_

APPLICATION NO.: \_\_\_\_\_  
 CONTRACT NO.: 661052  
 REBATE CONTRACT NO.: \_\_\_\_\_  
 SEWER ZONE: \_\_\_\_\_  
 CONNECTION WORKSHEET Y \_\_\_ N \_\_\_

CONTROL NO.: \_\_\_\_\_  
 PERMIT NO.: \_\_\_\_\_  
 INSPECTED BY: \_\_\_\_\_  
 DATE INSPECTED: \_\_\_\_\_

**FILL OUT APPLICATION COMPLETELY AND SIGN BELOW. IF LOCATION INFORMATION UNKNOWN, CONTACT THE OFFICE OF PLANNING AND ZONING FOR HOUSE NUMBERS, STREET NAME, ETC. NOTE: COMMERCIAL AND INDUSTRIAL FACILITIES MAY BE SUBJECT TO REQUIREMENTS OF THE COUNTY CODE FOR SEWER SURCHARGES, INDUSTRIAL COST RECOVERY CHARGES, AND PRETREATMENT.**

Application is herewith made for a sewer connection to the property described below. DATE OF APPLICATION \_\_\_\_\_

SUBDIVISION \_\_\_\_\_ SECTION \_\_\_\_\_ AREA \_\_\_\_\_ LOT \_\_\_\_\_ BLOCK \_\_\_\_\_  
 HOUSE NO. 3017 STREET Mulligans Hill Dr TAX MAP 25 GRID 11 PARCEL 254  
 POST OFFICE 511 ZIP CODE 21047 PHONE NO. \_\_\_\_\_

NEW OR EXISTING BUILDING? \_\_\_\_\_ USE (SEE PROPERTY CLASSIFICATIONS ON REVERSE SIDE) \_\_\_\_\_

| ITEMS CHECK                            | CONN. DIA. | DESCRIPTION  | CHARGES | FEE                | AMOUNT PAID | FUND                  | AGENCY | REV. ACCT B/S ACCT |
|--|------------|--|---------|--------------------|-------------|-----------------------|--------|--------------------|
| <input type="checkbox"/>               | 4"         | INSTALLATION   |         | \$                 |             | 500                   |        | 5019               |
| <input checked="" type="checkbox"/>    | 6"         | INSTALLATION   |         | \$ <u>4500.00</u>  |             | 500                   |        | 5019               |
| <input type="checkbox"/>               | 8"         | ADVANCE DEPOSIT*   |         | \$                 |             | 500                   |        | 5020               |
| <input type="checkbox"/>               | 3          | IN AID OF CONSTRUCTION CHARGE  |         | \$ <u>600.00</u>   |             | 500                   | 009    | 7120               |
|  |            | SINGLE FAMILY HOUSE (ALL TYPES) OR TRAILER                             |         |                    |             |                       |        |                    |
|  |            | APARTMENTS (ALL TYPES)   |         | \$                 | X           | NO. OF DWELLING UNITS |        |                    |
| MOTEL                                  |            | \$   | X       | NO. OF MOTEL UNITS |             |                       |        |                    |
| PUBLIC COMMERCIAL INDUSTRIAL BUILDINGS |            | REFER TO ENGINEERING FOR CHARGES                                       |         | \$                 |             |                       |        |                    |
|  |            |  |         | EST GPD            |             |                       |        |                    |
| <input type="checkbox"/>               | 4          | MIDDLE PATUXENT SUBDISTRICT SUPPLEMENTAL IN-AID OF CONSTRUCTION CHARGE |         |                    |             | 380                   | 009    | 7130               |
|  |            | SINGLE, FAMILY HOUSE (ALL TYPES) OR TRAILER                            |         | \$                 |             |                       |        |                    |
|  |            | APARTMENTS (ALL TYPES) MOTELS  |         | \$                 | X           | NO. OF UNITS          |        |                    |
| PUBLIC COMMERCIAL INDUSTRIAL BUILDINGS |            | REFER TO ENGINEERING FOR CHARGES                                       |         | \$                 |             |                       |        |                    |
|  |            |  |         | EST GPD            |             |                       |        |                    |
| <input type="checkbox"/>               | 5          | INSPECTION FEE AND PERMIT FEE  |         |                    |             | 710                   | 009    | 8211               |

\*Refer to DPZ for estimate of Advance Deposit. For installations requiring an Advance Deposit, the owner must enter into a cost agreement with Howard County prior to the commencement of any installation work.

TOTAL AMOUNT PAID

\$ 5100.00

CR#  
 CR# 020611  
 CR# 7024550

THE TERMS AND CONDITIONS OF THIS APPLICATION, INCLUDING ANYTHING ON THE REVERSE SIDE HEREOF ARE BINDING UPON THE UNDERSIGNED OWNER AND ALL SUCCEEDING OWNERS.

FULL FEE MUST ACCOMPANY THIS APPLICATION. MAKE CHECKS PAYABLE TO: DIRECTOR OF FINANCE, HOWARD COUNTY. CREDIT CARDS NOT ACCEPTED.

ANSERS GUEST LATE SERVICES INC.  
 COMPANY NAME  
556 BROADVIEW RD  
 COMPANY ADDRESS  
Judith A. Olson  
 OWNER SIGNATURE  
JUDITH A. OLSON  
 OWNER NAME (PRINT)  
SAPIC  
 OWNER ADDRESS

TAX \_\_\_\_\_ FOR \_\_\_\_\_  
 D/A \_\_\_\_\_ LEVY \_\_\_\_\_  
 TAB \_\_\_\_\_ CONTROL \_\_\_\_\_  
 TAX INDEX NO. \_\_\_\_\_

Howard County, Maryland  
Department of Finance  
3430 Court House Drive  
Ellicott City, MD 21043

6/11/2008 02:44 PM Cashier 0021  
T/Ref 0002034550 Reg 0002 Tran No 9187  
Cash Report: 080611-01 for 6/11/2008

01 - Main Location

W/S Connection 500-5019

500-5019

CONTRACT # 661

Validation Number: 307411 \$4,500.00

Sewer-In-Aid (500-009-7120)

500-009-7120

Contract Number 661

Validation Number: 307412 \$600.00

=====  
Total \$5,100.00

Check (\$5,100.00)

Check No. 1487

Thank You!

  
**Howard County**  
*Internal Memorandum*

**Subject:** Water / Sewer Connections at 3819 Mulligan Hill  
**To:** Finance  
**From:** George Abbott  
**Date:** 6/11/08

Water Only     Sewer Only     Water and Sewer

Connection was made under:

Developer's Agreement  
 Capital Project  
 Future

No connection has been made. Property Owner needs to complete the Water/Sewer House Connection Worksheet.

If I can be of any more assistance, please do not hesitate to call me directly at 410-313-4972.

Respectfully yours,

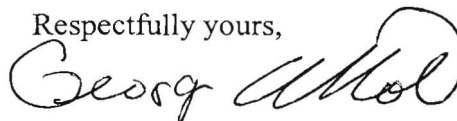

George Abbott III  
Operations Supervisor II