

7/8/94
4:00 cp

349989

PERMIT

SEWAGE DISPOSAL SYSTEM

DEPARTMENT OF HEALTH AND MENTAL HYGIENE

P 50102D

A 40871

DISTRICT 4th

DATE 4/21/94

DATE SYSTEM APPROVED 7/8/94

INSPECTOR H. Rifkin

HOWARD COUNTY HEALTH DEPARTMENT

BUREAU OF ENVIRONMENTAL HEALTH

~~XXXXXXXX~~ 313-2640

INDEXED

Fogle's Septic Clean, Inc. IS PERMITTED TO INSTALL ALTER

ADDRESS 558 Obrecht Road, Sykesville, Maryland 21784 PHONE 795-5674

SUBDIVISION Foxmoor LOT 14 ROAD 17701 Huntmaster Court

PROPERTY OWNER Eric S. and Karen L. Conn

ADDRESS _____

SEPTIC TANK CAPACITY 1250 GALLONS

NUMBER OF BEDROOMS 4

210 SQUARE FEET PER BEDROOM

LINEAR FEET OF TRENCH REQUIRED 280

BLOG. PERMIT SIGNED
AND RETURNED 4/21/94
Serial # B0104945
Decl

TRENCHES - Trench to be 3 feet wide. Inlet 3.5 feet below original grade. Bottom maximum depth 5.5 feet below original grade. Effective area begins at 3.5 feet below original grade. 2 feet of stone below distribution pipe.

LOCATION - Start the first trench 215 feet from the front lot line and 85 feet from the left lot line as seen when facing the lot from Foxmoor Drive. Run trenches on contour toward both directions. NOTE: Septic tank to be maximum 2 feet below original grade - otherwise top seam only tank required.

NOTES - No trench to exceed 100 feet in length. Provide 6" - 8" diameter cleanout and cap to grade or above on septic tank. 6-15-94 JEW

PLANS APPROVED BY Sid Abel DATE 2/21/94

COVER NO WORK UNTIL INSPECTED AND APPROVED

NEITHER THE HOWARD COUNTY COUNCIL NOR THE HEALTH DEPARTMENT IS RESPONSIBLE FOR THE SUCCESSFUL OPERATION OF ANY SYSTEM

NOTE: CLEANOUT REQUIRED EVERY 70 FEET OF SEWER LINE AND/OR AT 90° SWEEPS IN LINES FROM HOUSE TO DRAIN FIELDS, 90° ELBOWS NOT ACCEPTABLE.

NOTE: ALL PARTS OF SEPTIC SYSTEMS (I.E. TANK, DISTRIBUTION BOX TRENCHES) TO BE 100 FEET FROM WELL (UNLESS OTHERWISE SPECIFICALLY AUTHORIZED)

NOTE: IF DEEP TRENCH(ES) ARE USED CALL FOR INSPECTION BEFORE AND AFTER PLACING GRAVEL IN TRENCH(ES)

NOTE: NO DRY WELL SHALL EXCEED 15 FOOT IN DIAMETER NO ABSORPTION TRENCH TO EXCEED 100 FEET IN LENGTH

NOTE: ALL PIPE FROM HOUSE TO SEPTIC TANK MUST BE CAST IRON OR SCHEDULE 35/40 PVC OR ABS

PERMIT VOID AFTER TWO YEARS

NOTE: INSTALL STAND PIPE ON SEPTIC TANK AND DRY WELL STAND PIPES MUST BE 6 INCHES IN DIAMETER CAST IRON. CONCRETE OR TERRA COTTA OR PVA OR ABS ACCEPTED. IF TOP OF SEPTIC TANK IS DEEPER THAN 3 FEET. MANHOLE TO GRADE REQUIRED.

NOTE: DISTRIBUTION BOXES MUST HAVE BAFFLES

***INSTALLER IS RESPONSIBLE FOR OBTAINING FINAL APPROVAL ON THIS PERMIT**

A
410821

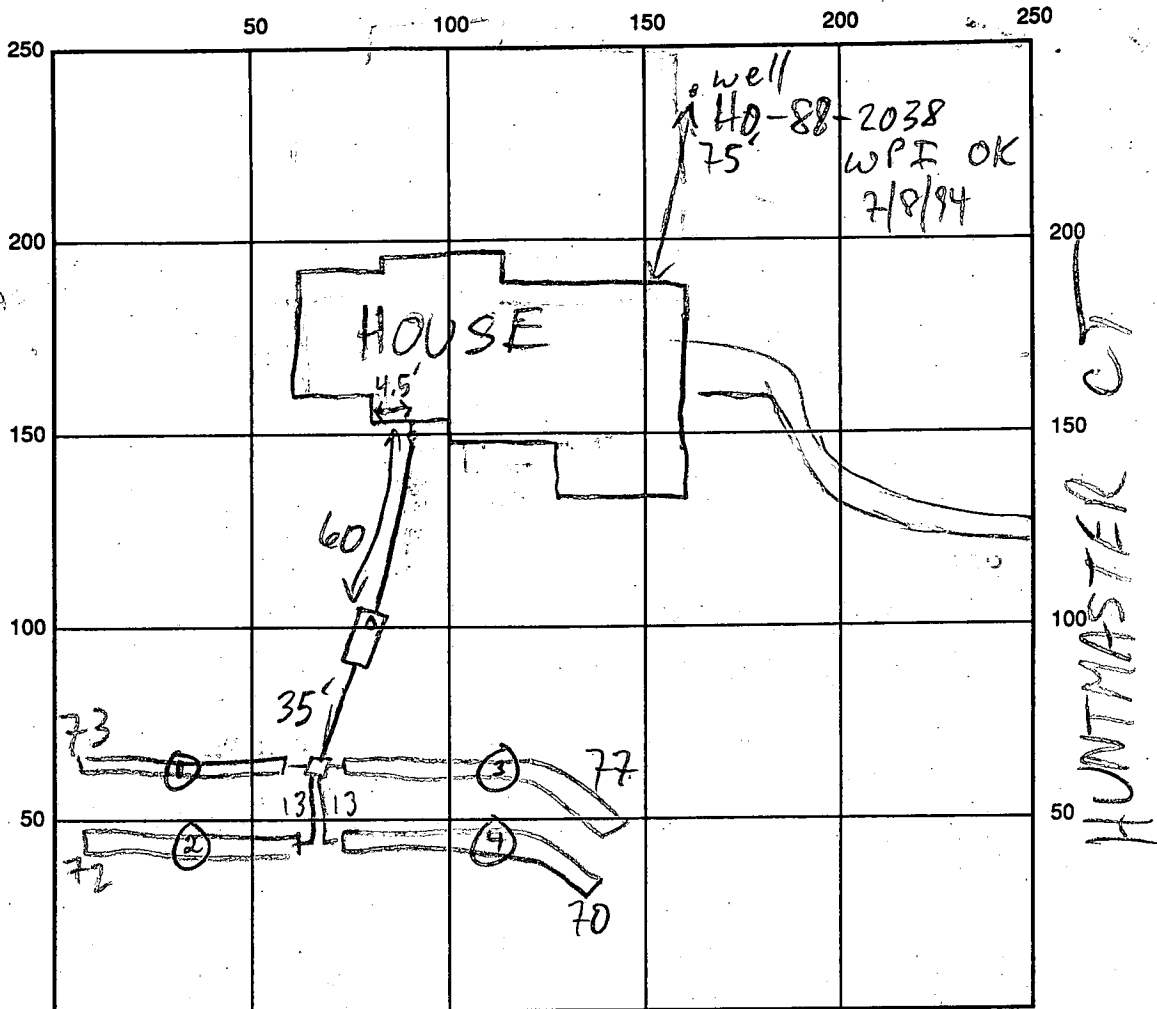

FOXMOOR DR INDICATE NORTH - NAME ADJOINING ROADWAY AS BASE LINE

SEPTIC TANK LEVEL 1250 GAL - OK CLEANOUTS S-T. & INLINE - OK

DISTRIBUTION BOX LEVEL OK - BAFFLE IN

DRAIN FIELD/TITLE DEPTH 5.5 FT. TRENCH WIDTH 3 FT. INLET DEPTH 3.5 FT.

EFFECTIVE GRAVEL DEPTH 2 FT. TOTAL LENGTH ① 73 ② 72 ③ 77 ④ 70 FT.

NUMBER OF TRENCHES 4 ONE SIDEWALL/BOTTOM AREA ① 219 ② 216 ③ 231 ④ 210 SQ. FT.

DRYWALL INSIDE DIAMETER FT. EFFECTIVE DEPTH BELOW INLET FT.

ABSORBENT AREA 876 SQ. FT.

REMARKS: 7/11/94 OK TO COVER ALL MR

DATE SYSTEM APPROVED 7/11/94 INSPECTOR M. Ritkin

