

C 1 14597

SEQUENCE NO. (MDE USE ONLY)

STATE OF MARYLAND WELL COMPLETION REPORT

THIS REPORT MUST BE SUBMITTED WITHIN 45 DAYS AFTER WELL IS COMPLETED.

(THIS NUMBER IS TO BE PUNCHED IN COLS. 3-6 ON ALL CARDS)

COUNTY NUMBER A517904

ST/CO USE ONLY DATE Received

DATE WELL COMPLETED

Depth of Well

PERMIT NO. FROM "PERMIT TO DRILL WELL" HO - 95 - 0172

OWNER Selfridge Builders STREET OR RFD Meadow Mill Dr. TOWN Glenelg SUBDIVISION Clarks Meadow SECTION LOT 1

WELL LOG

Not required for driven wells

GROUTING RECORD

WELL HAS BEEN GROUTED (Circle Appropriate Box) Y N

TYPE OF GROUTING MATERIAL (Circle one)

CEMENT CM BENTONITE CLAY BC

NO. OF BAGS 17 NO. OF POUNDS 1200

GALLONS OF WATER 102

DEPTH OF GROUT SEAL (to nearest foot) from 0 TOP 52 ft. to 304 BOTTOM 58 ft.

CASING RECORD

ST CO PL OT STEEL CONCRETE PLASTIC OTHER

MAIN CASING TYPE PL Nominal diameter top (main) casing (nearest inch)! 6 Total depth of main casing (nearest foot) 58

OTHER CASING (if used)

Table with columns for diameter inch and depth (feet) from to

SCREEN RECORD

ST BR HO PL OT STEEL BRASS BRONZE PLASTIC OPEN HOLE OTHER

DEPTH (nearest ft.)

Table with columns for depth intervals: 1-8, 9-11, 15-17, 21-23, 24-26, 30-32, 36-38, 39-41, 45-47, 51-53

SLOT SIZE 1 2 3 DIAMETER OF SCREEN (NEAREST INCH) 56 60

GRAVEL PACK IF WELL DRILLED WAS FLOWING WELL INSERT F IN BOX 68

MDE USE ONLY (NOT TO BE FILLED IN BY DRILLER) T (E.R.O.S.) W Q

70 72 74 75 76 TELESCOPE CASING LOG INDICATOR OTHER DATA

C 3

PUMPING TEST

HOURS PUMPED (nearest hour) 3

PUMPING RATE (gal. per min.) 5

METHOD USED TO MEASURE PUMPING RATE Bucket

WATER LEVEL (distance from land surface)

BEFORE PUMPING 20 ft.

WHEN PUMPING 60 ft.

TYPE OF PUMP USED (for test)

A air P piston T turbine C centrifugal R rotary O other J jet S submersible

PUMP INSTALLED

DRILLER INSTALLED PUMP (CIRCLE) (YES or NO) YES NO

IF DRILLER INSTALLS PUMP, THIS SECTION MUST BE COMPLETED FOR ALL WELLS.

TYPE OF PUMP INSTALLED PLACE (A,C,J,P,R,S,T,O) IN BOX 29

CAPACITY: GALLONS PER MINUTE (to nearest gallon) 31 35

PUMP HORSE POWER 37 41

PUMP COLUMN LENGTH (nearest ft.) 43 47

CASING HEIGHT (circle appropriate box and enter casing height) + above - below LAND SURFACE 2 (nearest foot)

LOCATION OF WELL ON LOT

SHOW PERMANENT STRUCTURE SUCH AS BUILDING, SEPTIC TANKS, AND /OR LANDMARKS AND INDICATE NOT LESS THAN TWO DISTANCES (MEASUREMENTS TO WELL)

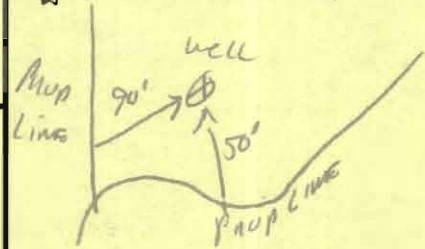

NUMBER OF UNSUCCESSFUL WELLS: 0

WELL HYDROFRACTURED Y N

CIRCLE APPROPRIATE LETTER A WELL WAS ABANDONED AND SEALED WHEN THIS WELL WAS COMPLETED E ELECTRIC LOG OBTAINED P TEST WELL CONVERTED TO PRODUCTION WELL

I HEREBY CERTIFY THAT THIS WELL HAS BEEN CONSTRUCTED IN ACCORDANCE WITH COMAR 26.04.04 "WELL CONSTRUCTION" AND IN CONFORMANCE WITH ALL CONDITIONS STATED IN THE ABOVE CAPTIONED PERMIT, AND THAT THE INFORMATION PRESENTED HEREIN IS ACCURATE AND COMPLETE TO THE BEST OF MY KNOWLEDGE.

DRILLERS LIC. NO. M SD 112 DRILLERS SIGNATURE (MUST MATCH SIGNATURE ON APPLICATION)

LIC. NO. D

SITE SUPERVISOR (sign. of driller or journeyman responsible for sitework if different from permittee)

B 1 8971

SEQUENCE NO. (MDE USE ONLY)

STATE OF MARYLAND APPLICATION FOR PERMIT TO DRILL WELL 523626 please type

STATE PERMIT NUMBER

HO - 95 - 0172

fill in this form completely

Date Received (APA) 11/19/05

OWNER INFORMATION

8 MM DD YY 13 15 Last Name Owner First Name 34 36 Street or RFD 55 57 Town 70 State 72 Zip 76 SELFRIDGE Builders 14045 GARED DRIVE GLENWOOD MD 21738

B 3

LOCATION OF WELL

8 COUNTY 21 23 SUBDIVISION 42 52 NEAREST TOWN 71 53 54 55 56 57 58 59 60 61 62 63 64 65 66 67 68 69 70 71 72 73 74 75 76 77 78 79 HOWARD 13 CLARKS MEADOW GLENWELG I I MEADOW MILLWAY

DRILLER INFORMATION

Driller's Name 76 License No. 81 Firm Name Address Signature Date RALPH E. MAYNE MS D 117 RALPH E. MAYNE INC 17024 HARDY ROAD MT AIRY MD 21771 11-7-05

B 4

DIRECTION OF WELL FROM TOWN (CIRCLE BOX)

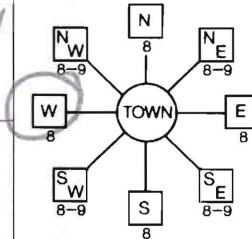

11 NEAR WHAT ROAD 30 ON WHICH SIDE OF ROAD (CIRCLE APPROPRIATE BOX) 34 35 37 DISTANCE FROM ROAD ENTER FT OR MI 38 39 TAX MAP: 21 BLK: 17 PARCEL 227

B 2

WELL INFORMATION

APPROX. PUMPING RATE (GAL. PER MIN.) 8 12 AVERAGE DAILY QUANTITY NEEDED (GAL. PER DAY) 14 20 5 500

USE FOR WATER (CIRCLE APPROPRIATE BOX)

- DOMESTIC POTABLE SUPPLY & RESIDENTIAL IRRIGATION FARMING (LIVESTOCK WATERING & AGRICULTURAL IRRIGATION) INDUSTRIAL, COMMERCIAL, DEWATERING PUBLIC WATER SUPPLY WELL TEST, OBSERVATION, MONITORING GEO-THERMAL

NOT TO BE FILLED IN BY DRILLER HEALTH DEPARTMENT APPROVAL

HOWARD 13 AS17904 COUNTY NAME COUNTY NO. STATE SIGNATURE INSERT S DATE ISSUED 11/29/05 Daniel A. Crighton 11/30/06 NORTH GRID 520 000 EAST GRID 795 000

APPROXIMATE DEPTH OF WELL 150 FEET

APPROXIMATE DIAMETER OF WELL 6" NEAREST INCH

METHOD OF DRILLING (circle one)

BORED (or Augered) JETTED Jetted & DRIVEN AIR-ROTARY AIR-PERCussion ROTARY (Hydraulic Rotary) CABLE REVERSE-ROTARY DRIVE-POINT

REPLACEMENT OR DEEPEMED WELLS (CIRCLE APPROPRIATE BOX)

- THIS WELL WILL NOT REPLACE AN EXISTING WELL THIS WELL WILL REPLACE A WELL THAT WILL BE ABANDONED AND SEALED THIS WELL WILL REPLACE A WELL THAT WILL BE USED AS A STANDBY-CONTACT LOCAL APPROVING AUTHORITY FOR POLICY ON STANDBY WELLS THIS WELL WILL DEEPEN AN EXISTING WELL PERMIT NUMBER OF WELL TO BE REPLACED OR DEEPEMED (IF AVAILABLE) 41 52

SHOW MAJOR FEATURES OF BOX & LOCATE WELL WITH AN X

SOURCES OF DRILLING WATER

- 1. well

WRITE THE BOX NUMBER FROM THE MAP HERE

E 500 795 N 795 520

DRAW A SKETCH BELOW SHOWING LOCATION OF WELL IN RELATION TO NEARBY TOWNS AND ROADS AND GIVE DISTANCE FROM WELL TO NEAREST ROAD JUNCTION

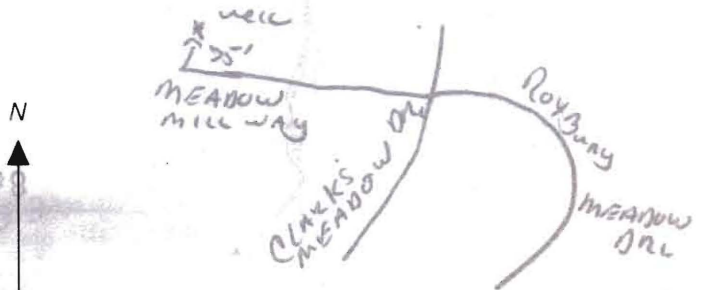

Not to be filled in by driller (MDE OR COUNTY USE ONLY)

APPROX. PERMIT NUMBER HO 20 03 G PERMIT No. HO - 95 - 0172

SPECIAL CONDITIONS

NOTE - APPROVING AUTHORITIES SHOULD USE SEPARATE SHEET IF NEEDED



DH2251

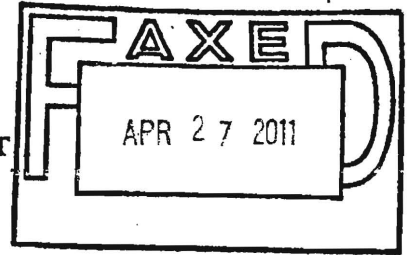

HOWARD COUNTY HEALTH DEPARTMENT
BUREAU OF ENVIRONMENTAL HEALTH
WATER AND SEWERAGE PROGRAM
TEL: (410)313-2640 FAX: (410)313-2648

Information Form for the Installation of the Well Pump, Pitless Adapter, and Supply Piping

NOTE: The installer is responsible for requesting an inspection prior to 9 am on the day of the desired inspection. No work is to be covered until approved by the Health Department. All installations must comply with the National Standard Plumbing Code (NSPC, as amended locally) and COMAR 26.04.04 (MD Well Construction Regulations). Submission of a complete form is required prior to Use and Occupancy approval.

Company Name: Burgemeister-Bell, Inc Telephone #: 410-363-0880
Address: 10331 South Delfield Road
Dwight Mills, MD 21117

(Must circle one) Licensed Plumber Licensed Well Driller Licensed Well Pump Installer
License # and name of individual responsible for the field installation:
Name (Print): Roland H. Mann, Jr License# 6592 7/11/11

*A licensed individual must perform the actual installation. Apprentices must be under the direct supervision of a licensed journeyman or master plumber, pump installer or well driller. Licenses may be subjected to field verification.

Name of Property Owner: Douglas Homes, Inc Telephone #: 410-740-0522
Subdivision: Clarks Meadow Lot #: 1 Well Tag #: HO-45-0172
Site Address: 14404 Meadow Mill Way
Glenwood, MD 21731

Submersible Pump Data	Pitless Adapter	Well Cap and Electric Conduit
Make: <u>Goulds</u>	Make: <u>Campbell</u>	Two piece watertight cap: <input checked="" type="checkbox"/>
Model #: <u>5G805422C</u>	Model#: <u>PA 13006X1</u>	Screened, vented well cap: <input type="checkbox"/>
Pump Capacity <u>5</u> GPM	Depth: <input checked="" type="checkbox"/> (36" min)	Cap secured to casing: <input type="checkbox"/>
Well Yield: <u>5</u> GPM	NSF approved: <input checked="" type="checkbox"/>	Conduit min 18" B.G.: <input type="checkbox"/>

Depth of well encountered at time of pump installation: 200 (feet) Conduit secured to well cap:
If pump capacity exceeds well yield, a low water cut off switch is required by NSPC 1990 Section 17.8.4
Torque arrestors or Cable guards are required - Must circle one
Safety rope, if used, attached to inside of well casing with eye bolt

Piping to house	House Connection
Type: <u>1" Poly</u>	PVC sleeved to undisturbed soil at wall penetration: <input checked="" type="checkbox"/>
PSI: <u>200</u> (160 psi min)	Approximate length of sleeve: <u>5</u>
Depth of supply line: <input checked="" type="checkbox"/> (36" min)	Sleeve caulked and sealed properly: <input checked="" type="checkbox"/>

The water supply line is required to be at least ten feet from the septic tank, pump chamber, sewage piping, distribution box, drainfields, and sewage reserve area. If this cannot be accomplished, contact this office for approval prior to installation.

Signature of company representative responsible for installation: Roland H. Mann, Jr date: 4/17/11

For Health Department Use Only - Not to be completed by Installer

Date Insp. Requested: _____ Date Insp. Approved: _____
Inspection Data: Pitless adapter and water supply line at least 36" below grade _____
Two piece cap installed and attached to casing securely _____
Elec. conduit extends at least 18" below grade/attached to cap properly _____
Safety rope installed inside of well casing _____
Correct well tag attached properly and casing 8" above finished grade _____
Water supply line sleeved adequately at house connection _____
Adequate grout observed below pitless adapter _____

**HOWARD COUNTY HEALTH DEPARTMENT
BUREAU OF ENVIRONMENTAL HEALTH
WATER AND SEWERAGE PROGRAM
TEL: (410)313-2640 FAX: (410)313-2648**

Information Form for the Installation of the Well Pump, Pitless Adapter, and Supply Piping

NOTE: The installer is responsible for requesting an inspection prior to 9 am on the day of the desired inspection. No work is to be covered until approved by the Health Department. All installations must comply with the National Standard Plumbing Code (NSPC, as amended locally) and COMAR 26.04.04 (MD Well Construction Regulations). Submission of a complete form is required prior to Use and Occupancy approval.

Company Name: _____ Telephone #: _____
Address: _____

(Must circle one) Licensed Plumber Licensed Well Driller Licensed Well Pump Installer

License # and name of individual responsible for the field installation:

Name (Print): _____ License# _____

***A licensed individual must perform the actual installation. Apprentices must be under the direct supervision of a licensed journeyman or master plumber, pump installer or well driller. Licenses may be subjected to field verification.**

Name of Property Owner: _____ Telephone #: _____
Subdivision: Clarks meadow Lot #: 1 Well Tag #: HO-95-0172 ✓
Site Address: 14404 Meadow Mill Rd

Submersible Pump Data

Make: _____
Model #: _____
Pump Capacity _____ GPM
Well Yield: _____ GPM

Pitless Adapter

Make: _____
Model#: _____
Depth: _____ (36" min)
NSF approved: _____

Well Cap and Electric Conduit

Two piece watertight cap: _____
Screened, vented well cap: _____
Cap secured to casing: _____
Conduit min 18" B.G.: _____
Conduit secured to well cap: _____

Depth of well encountered at time of pump installation: _____ (feet)
If pump capacity exceeds well yield, a low water cut off switch is required by NSPC 1990 Section 17.8.4
Torque arrestors or Cable guards are required - Must circle one
Safety rope, if used, attached to inside of well casing with eye bolt _____

Piping to house

Type: _____
PSI: _____ (160 psi min)
Depth of supply line: _____ (36" min)

House Connection

PVC sleeved to undisturbed soil at wall penetration: _____
Approximate length of sleeve: _____
Sleeve caulked and sealed properly: _____

The water supply line is required to be at least ten feet from the septic tank, pump chamber, sewage piping, distribution box, drainfields, and sewage reserve area. If this cannot be accomplished, contact this office for approval prior to installation.

Signature of company representative responsible for installation _____ date _____

For Health Department Use Only - Not to be completed by Installer

Date Insp. Requested: _____ Date Insp. Approved: 6/15/11 (KW)
Inspection Data: Pitless adapter and water supply line at least 36" below grade ✓
Two piece cap installed and attached to casing securely ✓
Elec. conduit extends at least 18" below grade/attached to cap properly ✓
Safety rope installed inside of well casing ✓
Correct well tag attached properly and casing 8" above finished grade ✓
Water supply line sleeved adequately at house connection ✓
Adequate grout observed below pitless adapter ✓

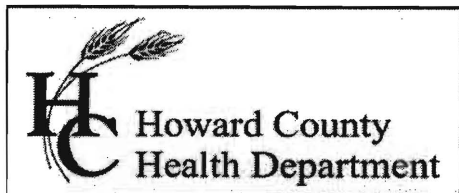

Bureau of Environmental Health
7178 Gateway Drive Columbia, MD 21046
(410) 313-2640 Fax (410) 313-2648
TDD (410) 313-2323 Toll Free 1-866-313-6300
website: www.hchealth.org

Peter L. Beilenson, M.D., M.P.H., Health Officer

INTERIM CERTIFICATE OF POTABILITY

Expiration Date – May 17, 2012

November 17, 2011

Homeowner
14404 Meadow Mill Way
Glenwood, MD 21738

**RE: Clarks Meadow, Lot 1
14404 Meadow Mill Way
Building Permit: B10003993
Well Permit: HO-95-0172**

Dear Homeowner:

This is to advise you that the septic system installation and water well construction for the above referenced property have been inspected and approved. Final approval of the septic system was granted on **11/8/2011**. Final approval of the well line connection to the dwelling was granted on **6/15/2011**. The well construction was completed on **2/7/2006**. Water samples were collected on **10/26/2011**.

The water sample results indicate that the water samples submitted for testing were free of coliform and fecal coliform bacteria at the time of sampling and are bacteriologically safe for drinking. This certifies that the initial sampling requirements of COMAR 26.04.04 "Well Regulations" have been met for the water supply system installed under well permit HO-95-0172. Although the submitted sample results are in compliance with COMAR standards, the Health Department does not guarantee water supplies.

This Interim Certificate of Potability will expire **six months** from the date of issuance. Submission of a second bacteriological test indicating the water is free of coliform and fecal coliform bacteria is required prior to the expiration date, after which time a Final Certificate of Potability will be issued. **Failure to submit an additional sample and obtain a Final Certificate of Potability will result in a Notice of Violation and is punishable as a misdemeanor under the Annotated Code of Maryland, Environment Article, 9-1311, subject to a fine of up to \$500 or imprisonment not to exceed three months.**

Please contact (410) 313-1773 to schedule a final water sample appointment or contact a Maryland certified water laboratory to schedule a water sample. A list of laboratories certified by the state of Maryland may be found at the following website:
<http://www.mde.state.md.us/assets/document/WSP-Labs-2010apr16.pdf>

Approving Authority,

Jeff Williams
Program Supervisor
Well & Septic Program

cc: Howard County Dept. of Inspections, Licenses, and Permits
Community Hygiene Program
File

Water Testing Laboratories

of Maryland, Inc.

P.O. Box 712
Stevensville, MD 21666
410-643-7711

Douglas Homes
5034 Dorsey Hall Drive, Suite 102
Ellicott City, MD 21042

Reporting Date: 10/28/2011
Report #: K7729

Submitted Sample Address: 14404 Meadow Mill Way
Glenwood, MD 21738
Submitted Sample Source: Holding tank
Date / Time Collected: 10/26/2011 9:49AM
Sample Type: Drinking Water
Sampler/Company: D. Pitts 4322DP, WTL of MD
Field Record: Chlorine residual: Absent Clear when drawn
Well #: HO-95-0172

Analytical Results

Parameter	Result	Units	Report Limit	MCL	Analytical Method
Total Coliforms	Absent	Coliforms/100 ml	Present/Absent	Present	SM 9223B
<i>E. Coli</i>	Absent	Coliforms/100 ml	Present/Absent	Present	SM 9223B
Nitrates + Nitrites	9.1	mg/L	1.0	10	EPA 353.2
Sand	Absent	P/A	Present/Absent	Present	Visual
Turbidity	ND	NTU	0.5	10	SM 2130B
pH	5.7	SU	0.1	6.5-8.5 (SMCL)	SM 4500 H ⁺ B

Notes:

1. Bacteriological analysis of this sample indicates this water is **safe** for human consumption.
2. MCL is EPA's maximum contaminant level under primary drinking water regulations. SMCL is secondary maximum contaminant level and is the aesthetic quality only. If your result is above any MCL or SMCL, you may want to consider a water treatment system or a new well. Please check your local regulations for any restrictions or additional limits.
3. ND - Not Detected.
4. Sample received and examined within EPA's recommended holding time
5. Analyzed by Lab 214.
6. SM - Greenberg, Clesceri and Eaton, *Standard Methods for the Examination of Water and Wastewater*, 21st Ed.

Reported by,

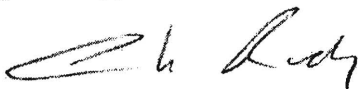

C. Rodgers, Customer Service Representative

OK
JW
11/16/11

Reviewed by: MB