

11/5/01
Repair
AM

11/6/01
Final
Noon

ISSUE DATE: 10/31/01

APPROVAL DATE: 11/6/01

PERMIT INDEXED

P 516401

A REPAIR

ON-SITE SEWAGE DISPOSAL SYSTEM HOWARD COUNTY HEALTH DEPARTMENT BUREAU OF ENVIRONMENTAL HEALTH 05-355877

Fogle's Septic Clean, Inc. IS PERMITTED TO INSTALL ALTER

ADDRESS: 580 Obrecht Road, Sykesville PHONE NUMBER: 410-795-5670

SUBDIVISION: Holiday Hills LOT NUMBER: 69

ADDRESS: 10718 Hunting Lane PROPERTY OWNER: Jeanne Goodman

SEPTIC TANK CAPACITY (GALLONS): Existing

PUMP CHAMBER CAPACITY (GALLONS): N/A

NUMBER OF BEDROOMS: 3?

SQUARE FEET PER BEDROOM: 180

LINEAR FEET OF TRENCH REQUIRED: 108 2-54' Trenches

TRENCHES:	Trench to be _____ feet wide. Inlet _____ feet below original grade. Bottom maximum depth _____ feet below original grade. Effective area begins at _____ feet below original grade. _____ feet of stone below distribution pipe.
LOCATION:	
PURPOSE:	Existing septic system is failing. Call when ground is opened so sanitarian can recommend repair.

PLANS APPROVED: Brian Baker DATE: 10/31/01

- NOTE: PERMIT VOID AFTER 2 YEARS
- NOTE: CONTRACTOR RESPONSIBLE FOR SCHEDULING A PRE-CONSTRUCTION INSPECTION FOR ALL INSTALLATIONS
- NOTE: WATERTIGHT SEPTIC TANKS REQUIRED
- NOTE: ALL PARTS OF SEPTIC SYSTEM SHALL BE 100 FEET FROM ANY WATER WELL
- NOTE: MANHOLE RISERS REQUIRED ON ALL SEPTIC TANKS AND PUMP CHAMBERS

NEITHER THE HOWARD COUNTY COUNCIL NOR THE HEALTH DEPARTMENT IS RESPONSIBLE FOR THE SUCCESSFUL OPERATION OF ANY SYSTEM PERMITTEE RESPONSIBLE FOR OBTAINING FINAL APPROVAL ON THIS PERMIT CALL 410-313-2640 FOR INSPECTION OF SEPTIC SYSTEM

P 516401

- ① Red Br Cl Loam 6.5' ~ 25 minutes
- 3.5' Brown Sa Cl Loam
- 5' Brown + White Sa Cl Loam
- 6-10' Light Br + White Sa Loam
- 15' Very little Rock

NOT TO SCALE

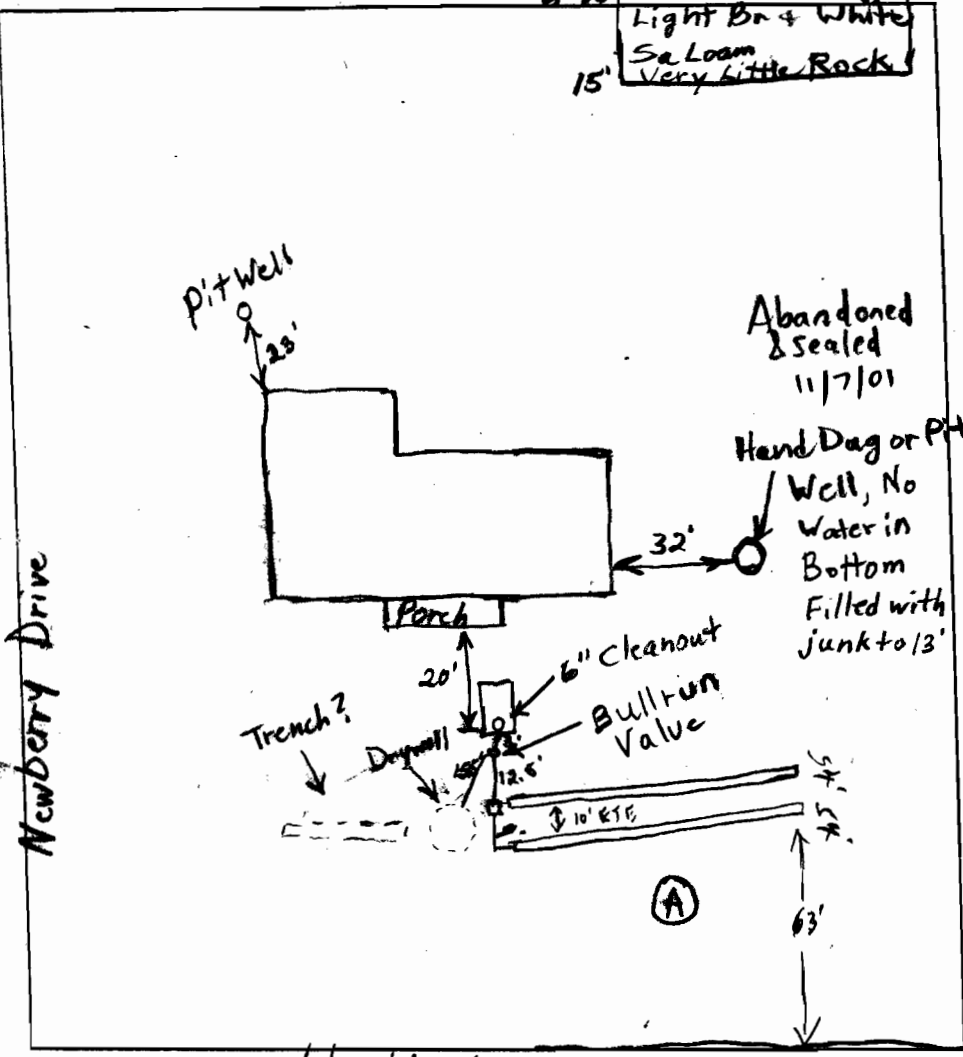

TRENCH DATA	
TRENCH WIDTH	2'
TRENCH INLET DEPTH	6'
TRENCH BOTTOM DEPTH	11'
DEPTH OF STONE	5'
NUMBER OF TRENCHES	2
TOTAL TRENCH LENGTH	54'
ABSORBENT AREA	108 #
DISTRIBUTION BOX LEVEL	<input checked="" type="checkbox"/>
BAFFLE IN DISTRIBUTION BOX	<input checked="" type="checkbox"/>

SEPTIC TANK DATA	
SEPTIC TANK	Existing GALLONS
MANHOLE RISER	No
6 INCH INSPECTION PORT	Yes
PUMP CHAMBER DATA N/A	
PUMP CHAMBER GALLONS	
MANHOLE RISER	
ALARM	
PUMP PERFORMANCE TEST	

PRE-CONSTRUCTION INSPECTION:

INSPECTION COMMENTS: 11/5/01 First trench started. Homeowner on vacation, will have to get back to them about sealing of hand dug well or old pit well with fill above it. (SL) 11/6/01 OK to cover all work (SL)

INSPECTOR [Signature] DATE SYSTEM APPROVED 11/6/01