

HOWARD COUNTY HEALTH DEPARTMENT

JOYCE M. BOYD, M.D., M.P.H.
COUNTY HEALTH OFFICER



Bureau of Environmental Health
3525 Ellicott Mills Drive
Ellicott City, Maryland 21043

Director - 461-9956
Water & Sewerage, Permits - 461-9933
Community Environmental Health - 461-9944
Technical Services - 461-9955

December 3, 1987

Mr. Carlton Colburn, Jr., President
Colburn Engineering, Inc.
P. O. Box 52
Hudson, Massachusetts 01749

RE: Green Henge
Lot 25, Section 4

Dear Mr. Colburn:

I am in receipt of your letter dated September 4, 1987. I will attempt to address your concerns in the order they were raised.

- (1) This lot is being considered under the Code of Maryland Regulations Governing Sewage Disposal and Certain Water Systems for Homes and Other Establishments in the Counties of Maryland Where a Public Sewage System is not Available. (Copy enclosed with Administrative History.)
- (2) Most of the non-conventional on-site sewage disposal systems (and requirements for these systems) are not addressed in these regulations. We have experimented with similar systems in our Innovative and Alternative On-Site System Program but this particular design deviates from the types of systems that are currently under consideration. The design of these systems is generally based on the percolation rate of the underlying material in the B horizon (the most limiting layer). Consequently, we would not recommend disturbing or excavating all of the overlying material, but could consider a sand lined pressure dosed trench designed system. This sand lined trench would be excavated into the more porous material to a depth that would allow a sufficient buffer (to attenuate the sewage) above the seasonably high water table elevation. If 4 feet or greater could be maintained, we would design the trench depth accordingly.

The sand used in the disposal trenches must meet specifications for sand used in sand mound construction (see COMAR 10.17.02 attached). Additionally, before we would approve a sand lined trench we would have to evaluate the lot for other similar systems (sand mounds, shallow pressure dosed trenches).

- (3) Our reason for considering this lot for non-conventional types of disposal systems is that it failed the necessary tests for installation of a conventional sewage disposal system. The percolation tests conducted on August 18, 1966 demonstrated an elevated water table and a deep clay overburden. Your reference to penetrating the underlying porous soils with a seepage pit is accepted practice, provided a sufficient buffer is maintained between the bottom of the pit and the seasonally high water table, rocks or other impervious strata. It has been standard public health practice to maintain this minimum 4 foot buffer (see enclosed excerpt regarding suitability of soil taken from The Manual of Septic Tank Practice Public Health Service Publication No 526 Revised 1967).
- (4) The appeals process follows the Administrative Procedure Act. (copy of appeals process enclosed).

With regard to your concerns relative to my letter dated August 4, 1987, I offer the following:

- (1) See (3) above.
- (2) As the lot failed the necessary tests for a conventional on-site disposal system, any further testing would be for determining suitability for a non-conventional innovative or alternative type system. Generally, an infiltrometer is used to test the soil percolation rate in the most limiting layer, after an appropriate pre-wet period. A 60 minutes per inch rate would be the slowest rate that could be approved. Additionally, detailed soil profile investigation would be performed.
- (3) Enclosed is a Status Report that describes some of these alternative systems, several additional documents of interest are also provided.
- (4) Generally specifications for these types of systems are outlined after the type of system that is suitable is selected. As these evaluations have not yet been performed it would be premature to speculate as to the various design parameters that would be used. Enclosed for your information is a worksheet and some information useful in preparing a sand mound system plan.

Mr. Carlton Colburn, Jr.

- 3 -

December 3, 1987

(5) A copy of the draft legal agreement is enclosed.

If you have any questions regarding this matter, please call Craig Williams or myself at 461-9933.

Very truly yours,



Frank A. Skinner, Acting Director
Bureau of Environmental Health

FAS:hs

cc: Clifford Stein

HOWARD COUNTY HEALTH DEPARTMENT

JOYCE M. BOYD, M.D., M.P.H.
COUNTY HEALTH OFFICER



Bureau of Environmental Health
3525 Ellicott Mills Drive
Ellicott City, Maryland 21043

Director - 461-9956
Water & Sewerage, Permits - 461-9933
Community Environmental Health - 461-9944
Technical Services - 461-9955

October 15, 1987

Mr. Carlton B. Colburn, Jr.
President
Colburn Engineering, Inc.
Main Street - P. O. Box 52
Hudson, Massachusetts 01772

RE: Green Henge, Section 4
Lot 25

Dear Mr. Colburn:

I am in receipt of your letter dated September 4, 1987. Many of the concerns you raise require information from outside this bureau; coordinating the response to your concerns is forthcoming and I apologize for the delay.

As one of your concerns dealt with increased costs and we had informed you that a backhoe contractor would be needed for further on-site evaluation, I have made a tentative arrangement that I trust will be suitable to all concerned parties.

I have contacted Mr. Clifford Stein, Division of Residential Sanitation, Maryland Department of the Environment to arrange for evaluation of the property for innovative or alternative design sewage disposal systems. A tentative date has been made for 9:30 a.m. on Tuesday, October 27, 1987. Holes will be dug or augered by hand and there is a possibility that the depths of the necessary holes may be too deep (to dig by hand) or if rock is encountered too deep to dig or auger. A backhoe may be necessary at a later date if problems similar to the above mentioned would arise. It is not necessary that you or your representative be present, but you are welcome. If this arrangement is agreeable, please confirm with Craig Williams or myself.

Additionally, we would need the permission of Mrs. Carol McKinley or her agent to enter upon the property to perform the necessary tests.

I look forward in hearing from you in the near future. I can be reached at 461-9933.

Very truly yours,

Frank A. Skinner, Acting Director
Bureau of Environmental Health

FS:JR

cc: Clifford Stein
Carol McKinley
Craig Williams

COLBURN ENGINEERING, INC.

Registered Professional Engineers and Surveyors

Surveying - Land Development

Structural Design and Analysis

MAIN STREET - P. O. BOX 52
HUDSON, MASS. 01749
562-5247 & 568-8708

September 4, 1987

Mr. Frank Skinner, Acting Director
Bureau of Environmental Health
Howard County Health Department
3525 Ellicott Mills Drive
Ellicott City, Maryland 21043

Re: Green Henge, Section 4
Lot 25

Dear Mr. Skinner:

As stated previously, this firm is acting as Consultant and Agent for Carol McKinley in the matter of obtaining a permit to construct a sewage disposal system on the above referenced lot.

I am in receipt of your letters dated June 10, 1987 and August 4, 1987 and I am pleased to hear that we are all working toward a common goal. However, there are several issues that need to be addressed prior to proceeding with additional testing as outlined in your letter of August 4, 1987. The testing that has been performed at this site in 1966, 1985 & 1986, already represents a significant investment in time and money.

With regard to your letter of June 10, 1987 would you please respond to the following items:

- (1) Under what regulations is this lot being considered? If it is being considered under regulations other than Title 10, Subtitle 17, amended effective December 1, 1970 would you please forward to me a copy of such regulations along with the effective date. The above regulation was represented as being in effect for this lot by Mr. Williams.

COLBURN ENGINEERING, INC.

Registered Professional Engineers and Surveyors

Surveying - Land Development

Structural Design and Analysis

MAIN STREET - P. O. BOX 52
HUDSON, MASS. 01749
562-5247 & 568-8708

Mr. Frank Skinner

2

September 4, 1987

(2) Please state specifically where the design filed with your Department on April 14, 1986 fails to meet the requirements of your Regulations, thus resulting in your denial.

(3) Setting aside the design as filed and referring to Section .17 of the above cited regulations, please state the reasons for considering this lot for a non-conventional type of system. Section .17 allows seepage pits to penetrate into underlying porous soils and the absorption area required to be calculated from Table 3. Underlying porous soils were demonstrated by a percolation test back in 1966. Note also that the above cited regulations require no separations between bottom of system and ground water.

(4) Would you please inform me of the procedure for taking an appeal of a denial by your Department. I find no such information within the above cited regulations.

With regard to your letter of Aug 4, 1987, would you please respond to the following items:

(1) Please state specifically in what ways this site "failed evaluation for conventional sewage disposal system".

(2) In light of all the testing done to date (and the associated costs), please state exactly what is to be accomplished by further on-site evaluation and to what specifications this testing is to be done .

(3) Please provide me with some description of the three types of alternative systems.

COLBURN ENGINEERING, INC.

Registered Professional Engineers and Surveyors

Surveying - Land Development

Structural Design and Analysis

MAIN STREET - P. O. Box 52
HUDSON, MASS. 01749
562-5247 & 568-8708

Mr. Frank Skinner

3

September 4, 1987

(4) Please forward to me the regulations and specifications that are to be met for a "Satisfactory" evaluation and for a "Suitable" plan, against which a plan will be reviewed and approved.

(5) Please state the nature of a "Legal Agreement" that would be filed with the deed of this property.

Now that summer is ending, along with vacations, Carol intends to move aggressively toward a conclusion of this issue through your Department, or the Courts if necessary. Carol is also exploring with Counsel whether a temporary taking of her property has been affected.

Mr. Skinner, I will look forward to your timely reply to this letter so we can proceed with our plans. If we proceed with more testing we would hope to accomplish it by the middle of October 1987.

Please do not hesitate to call me collect if you have questions or need pre-payment for copies of regulations.

Yours truly,
Colburn Engineering Inc.



Carlton B. Colburn, Jr.
President
P.E., P.L.S

CBC Jr./krc
CC: Stewart Herrick, Esq.
Carol McKinley

APRIL 29, 1986

MARCH 27, 1985

- A - MOTTLED 67" WATER 75" (IMPERVIOUS CLAY 42"-67")
- B - MOTTLED 46" WATER 70" (IMPERVIOUS 29-46")
- C - MOTTLED 76" WATER 146" (IMPERVIOUS 45-73")
- D - MOTTLED 107" WATER 107" (IMPERVIOUS 9-26")
- E - MOTTLED 126.97" WATER 126.97" (IMPERVIOUS CLAY 42"-67")

LOT 25
40,315 ±

POSSIBLE WELL LOCATION

POSSIBLE HOUSE LOCATION



1000 GAL. SEPTIC TANK

APPROX. LOC.
T.H. #1 B 2 (1966)
T.H. #9 (1985)

100% EXPANSION

10' (TYP)

2-45' TRENCHES, 2' WIDE, 15' ON CTR.
6" STONE UNDER PIPE

126.96'

EVERGREEN WAY

SCALE: 1" = 40'

AUGUST 14, 1986

1, 2 OK 4-9'

3, 4 - WATER 9'

MARCH 27, 1985

5. 2 1/2' PERC 25 MIN
WATER 11 1/2 FT

6. 2' PERC 33 MIN
LOOKS DUBIOUS 12' (HAND)

7. 2 1/2' PERC 47 MIN
LOOKS DUBIOUS 13' (HAND)

8. X NO WELL SITE.

9. WATER 11'

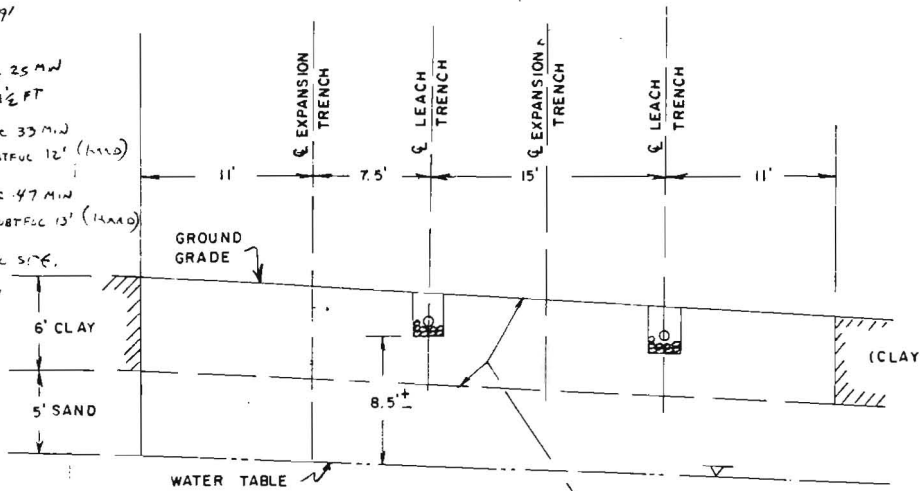

SECTION A - A SCALE: 1" = 8'

SEWER SYSTEM DESIGN

LOT 25 "GREEN HENGE" HOWARD CO., MD.

OWNED BY: CAROL MCKINLEY

PLAN BY: COLBURN ENGINEERING, INC.
454 MAIN ST., HUDSON, MASS.

SCALE: AS NOTED APRIL 14, 1986

PLAN REF:
PLAT BOOK 17 FOLIO 60

Carlton B. Colburn Jr. 4/14/86



HOWARD COUNTY HEALTH DEPARTMENT

JOYCE M. BOYD, M.D., M.P.H.
COUNTY HEALTH OFFICER



Bureau of Environmental Health
3525 Ellicott Mills Drive
Ellicott City, Maryland 21043

Director - 461-9956
Water & Sewerage, Permits - 461-9933
Community Environmental Health - 461-9944
Technical Services - 461-9955

June 10, 1987

Ms. Carol McKinley
10 Strawberry Hill Road
Southboro, Massachusetts 01772

RE: Green Henge, Lot 25, Section 4

Dear Ms. McKinley:

I am in receipt of your letter dated May 26, 1987 regarding a response to Colburn Engineering, Inc.'s letter of April 14, 1986.

I must first apologize for Mr. Williams' delay in responding to the above referenced letter.

At the time of our review of the proposal to install an "excavate and fill" on-site sewage disposal system as proposed by Mr. Colburn there was considerable discussion between our staff and the staff of the Division of Residential Sanitation, Office of Environmental Programs, regarding this type of system design.

This design is similar to a "sandlined trench" system which in April of 1986 was not considered a conventional on-site sewage disposal system design. Indeed at that time systems of this type in the Piedmont physiographic province were not even considered non-conventional using innovative and alternative technology.

During the 1986 Legislative Session Public Law 9-209.1 and 9.209.2 were passed. Additionally in Section 2, Chapter 498, Acts 1986, the Department of Health and Mental Hygiene was charged with promotion and study of the use of sandlined trenches and other innovative and alternative on-site sewage disposal systems. A report on the status of this study was due to the Governor and General Assembly on January 1, 1987. The Department is to deliver its final report and make all effects to make the sandlined trench system a conventional sewage disposal system in the State of Maryland by December 1, 1987. To the best of my knowledge the final report is not yet complete.

June 10, 1987

I have provided you this background information in an attempt to demonstrate the climate surrounding this issue and that, in fact, we were working toward a positive resolution to this situation.

In response to your request for a permit to install this sewage disposal system, I must advise you that the request is denied. This is based on the fact that this type of system (or sandlined trench concept) is experimental and subject to review and approval by the Division of Residential Sanitation, Office of Environmental Programs.

We have reviewed all of the results of the soils evaluations performed on this property. We believe that a sandlined trench system would technically be feasible. The plans for the "excavate and fill" system would probably require modification.

By copy of this letter I am also informing the Innovative and Alternative Section of the Division of Residential Sanitation, Office of Environmental Programs of this situation. A copy of the soils evaluation and Mr. Colburn's proposal will also be forwarded.

These will be concurrently reviewed and I would suggest after the review a meeting to discuss any alteration to the plan be arranged with Mr. Colburn, the reviewing agencies and yourself.

If you have any questions relating to this matter, please call me at 461-9956.

Very truly yours,



Frank A. Skinner, Assistant Director
Bureau of Environmental Health

FAS:hs

cc: Clifford Stein
David Kerr
Carlton B. Colburn, Jr.

APRIL 29, 1986

- A - MOTTLED 67" WATER 75" (IMPERVIOUS CLAY 42"-67")
- B - MOTTLED 46" WATER 70" (IMPERVIOUS 29-46")
- C - MOTTLED 126" WATER 146" (IMPERVIOUS 45-73")
- D - MOTTLED 107" WATER 107" (IMPERVIOUS CLAY 45-70")
- E - MOTTLED 126" WATER 120" (IMPERVIOUS CLAY 45-70")

MARCH 27, 1985

LOT 25
40,315 ±

POSSIBLE WELL LOCATION

POSSIBLE HOUSE LOCATION

1000 GAL. SEPTIC TANK

APPROX. LOC.
T.H. #1 & 2 (1966)
T.H. #9 (1985)

100% EXPANSION

LOT 24

AREA TO BE EXCAVATED

2-45' TRENCHES, 2' WIDE, 15' ON CTR.
6" STONE UNDER PIPE

EVERGREEN WAY

SCALE: 1" = 40'

PLAN REF:
PLAT BOOK 17 FOLIO 60

AUGUST 18, 1966

- 1,2 OK 4-9'
- 3,4 - WATER 9'

MARCH 27, 1985

- 5. 2 1/2' PERC 25 MIN WATER 11 1/2 FT
- 6. 2' PERC 33 MIN LOOKS DOUBTFUL 12' (HARD)
- 7. 2 1/2' PERC 47 MIN LOOKS DOUBTFUL 13' (HARD)
- 8. X NO WELL SITE
- 9. WATER 11'

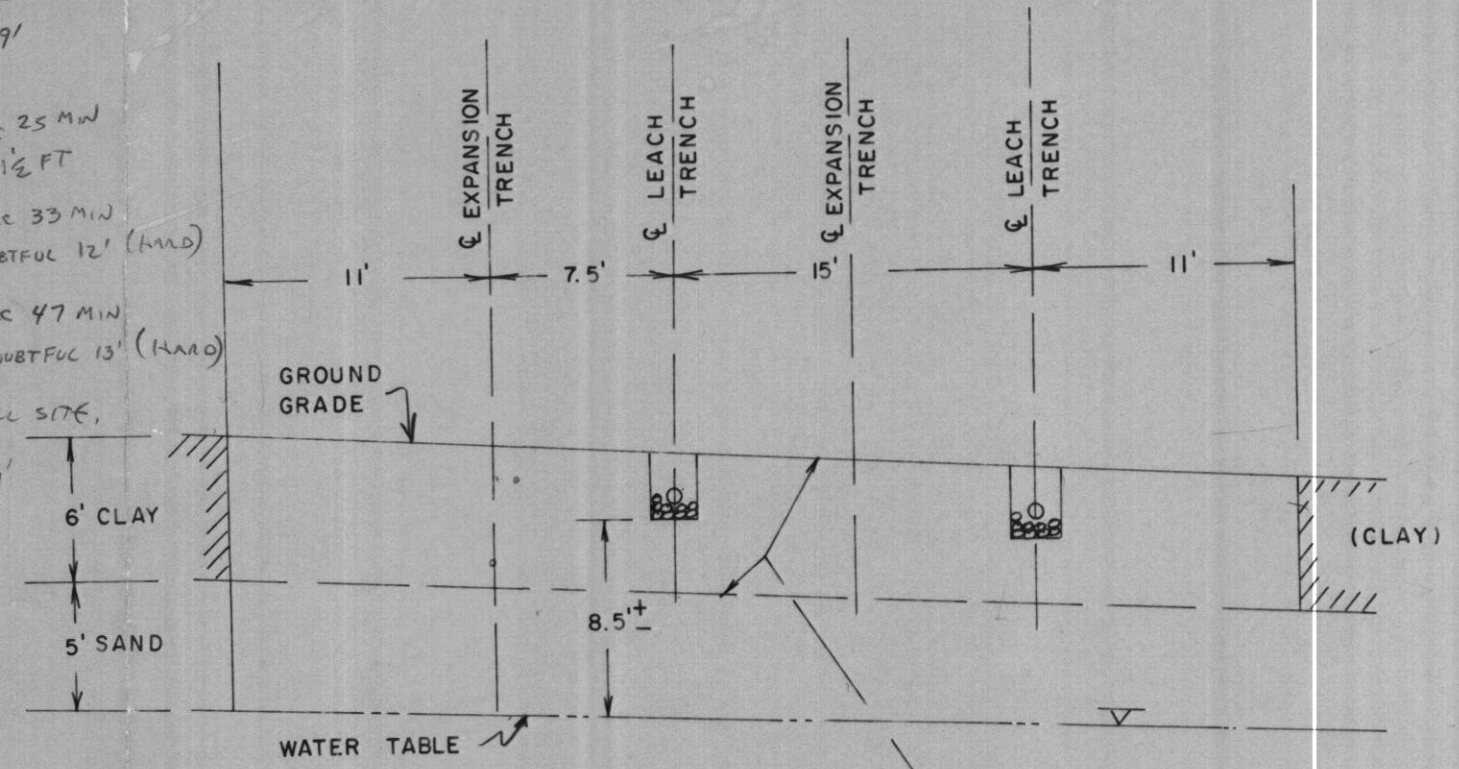

SECTION A - A SCALE: 1" = 8'

SEWER SYSTEM DESIGN

LOT 25 "GREEN HENGE" HOWARD CO., MD.

OWNED BY: CAROL MCKINLEY

PLAN BY: COLBURN ENGINEERING, INC.
454 MAIN ST., HUDSON, MASS.

SCALE: AS NOTED

APRIL 14, 1986

Carlton B. Colburn Jr. 4/14/86

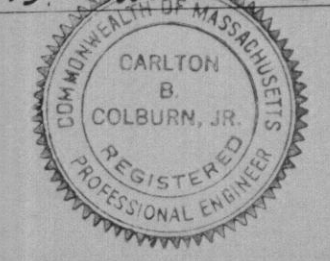

10-20-87

Re: Green Henge, Rec. 4
LOT 25

Dear Mr. Skinner,

I am looking at a copy of a letter to you, dated 9-4-87, from Calburn Engineering, Inc. I understand that you have not forwarded any requested information to them and cannot understand why you refuse to function in a fair and professional way.

Could you please, at least, send some information to my consultant? What you might not remember is that we have been asking for this for two years.

Very Sincerely,
Carol A. McKinley

10 Strawberry Hill Rd.
Southboro, MA. 01772
(617) 481-2524

HOWARD COUNTY HEALTH DEPARTMENT

JOYCE M. BOYD, M.D., M.P.H.
COUNTY HEALTH OFFICER



Bureau of Environmental Health
3525 Ellicott Mills Drive
Ellicott City, Maryland 21043

Director - 461-9956
Water & Sewerage, Permits - 461-9933
Community Environmental Health - 461-9944
Technical Services - 461-9955

August 4, 1987

Ms. Carol McKinley
10 Strawberry Hill Road
Southboro, Massachusetts 01772

RE: Green Henge, Lot 25
Section 4

Dear Ms. McKinley:

I have reviewed all relevant percolation testing and soils evaluation data for the above referenced property with Mr. Clifford Stein, Division of Residential Sanitation, Maryland Department of the Environment. The proposed design for an "excavate and fill" system was also reviewed. This design does not conform with any of the eight (8) basic experimental systems currently under evaluation by the State of Maryland Innovative and Alternative On-Site Sewage Disposal Program.

As this property has failed evaluation for conventional sewage disposal systems, and the on-site conditions appear somewhat favorable, testing for innovative or alternative design sewage disposal systems can proceed.

The types of sewage disposal systems that would be under consideration are the sand mound system; the shallow pressure dosing trench system; and the sand lined trench system.

In order to proceed with further on-site evaluation, you must engage the service of a backhoe contractor and make arrangements to meet on the site with the Division of Residential Sanitation and this Bureau's representatives. Approximately thirty gallons of water will also be needed at the site. Please contact or have your agent contact Craig Williams at 461-9933 to schedule an appointment for an evaluation.

Ms. Carol McKinley

- 2 -

August 4, 1987

If these evaluations are satisfactory, a suitable plan by a registered professional engineer or registered sanitarian must be concurrently reviewed and approved by both state and county representatives.

Additionally, a legal agreement filed with the deed of the property describing the experimental nature of the disposal system would be required.

If you have any questions regarding this matter, please call me at 461-9933.

Very truly yours,

Frank Skinner

Frank Skinner, Acting Director
Bureau of Environmental Health

FS:JR

cc:

✓ Carlton B. Colburn, Jr. *Sent 8/4/87*
✓ Clifford Stein

Carol McKinley
10 Strawberry Hill Road
Southboro, Mass. 01772

May 26, 1987

Mr. Frank Skinner, Acting Director
Howard County Health Department
Bureau of Environmental Health
3525 Ellicott Mills Drive
Ellicott City, Maryland 21043

Re: Green Henge, Section 4
Lot No. 25

Dear Mr. Skinner,

By virtue of a letter dated April 14, 1986 directed to your Department from Colburn Engineering, Inc., acting as my agent, I applied for a permit to construct a sewer system on the above captioned lot. As more than a year has elapsed since my application and I have not received a reply, I have no choice but to move ahead and take the next step available to me.

For the record, the following is a chronologic history of my efforts to obtain a permit on Lot 25, which I have owned and paid Real Estate Taxes on for 18 years.

1.) August 16, 1966: Percolation test performed yielding a rate of 4 min/inch.

2.) March 27, 1985: Deep test holes observed and percolation tests where attempted in the upper clayey stratas on Lot 25. These perc tests failed. Soil logs showed underlying sand stratas.

3.) May 20, 1985: Letter from Mr. Williams to me approving Lot 24 and indicating Lot 25 is considered unbuildable, but that relief may be available.

4.) April 14, 1986: Letter of application from Colburn Engineering, Inc. setting forth a design which Mr. Colburn felt met the requirements of your Title 10, or would be in the category of an "alternate design".

5.) April 21, 1986: Mr Colburn called Mr. Williams and made an appointment for us to see him on April 28 at 11:00 a.m.

6.) April 28, 1986: Flew in from Boston, Mass. and dropped in on Mr. Williams as messages were mixed up. It was agreed that we would do more testing.

7.) April 29, 1986: More deep test holes were observed with Mr. Williams and Mr. Able. Aspects of the proposed design were discussed between Mr. Colburn and Mr. Williams. Mr. Williams promised me that a letter would go out to me by May 2, 1986 citing the Department's decision.

8.) May 9, 1986: Called for Mr. Williams. He was not available and the secretary did not have a letter.

9.) May 15, 1986: Called for Mr. Williams. He was not available. Talked to Mr. Able who was of no help.

10.) May 20, 1986: Called Mr Williams who was out, but returned my call. He said that the project had been denied and would have a letter out the next day.

11.) June 2, 1986: Mr. Colburn called for Mr. Williams who said he was going to discuss the project with Mr. Skinner that day and would get back to Mr. Colburn later in the day. Mr. Williams said he was having trouble finding a regulation to cite for a denial. Williams did not call back.

12.) June 13, 1986: Mr. Williams called Mr. Colburn and said he still did not have a regulation to cite and that the Lot now would come under newer regulations. He said a letter would go out on June 16, 1986.

I have received nothing nor have I had any contact with your Department since June 13, 1986. In spite of having been born and raised in Maryland, and in fact having had 9 years of service with the Howard County Social Service Department, I strongly feel that I have been deceived, lied to, and denied due process. It appears that your Department is attempting to delay a finding in hopes of coming up with some way of taking away from me a valuable piece of property.

If I have not received a decision on my April 14, 1986 request for a sewer permit on or before June 12, 1987 then I will seek relief through the Courts.

Yours truly,

Carol E. McKinley
Carol E. McKinley

cc: Mr. Steward Herrick, Esq.
Colburn Engineering, Inc.

Carol McKinley
10 Strawberry Hill Road
Southboro, Mass. 01772

May 26, 1987

Mr. Frank Skinner, Acting Director
Howard County Health Department
Bureau of Environmental Health
3525 Ellicott Mills Drive
Ellicott City, Maryland 21043

Re: Green Henge, Section 4
Lot No. 25

Dear Mr. Skinner,

By virtue of a letter dated April 14, 1986 directed to your Department from Colburn Engineering, Inc., acting as my agent, I applied for a permit to construct a sewer system on the above captioned lot. As more than a year has elapsed since my application and I have not received a reply, I have no choice but to move ahead and take the next step available to me.

For the record, the following is a chronologic history of my efforts to obtain a permit on Lot 25, which I have owned and paid Real Estate Taxes on for 18 years.

1.) August 16, 1966: Percolation test performed yielding a rate of 4 min/inch.

2.) March 27, 1985: Deep test holes observed and percolation tests where attempted in the upper clayey stratas on Lot 25. These perc tests failed. Soil logs showed underlying sand stratas.

3.) May 20, 1985: Letter from Mr. Williams to me approving Lot 24 and indicating Lot 25 is considered unbuildable, but that relief may be available.

4.) April 14, 1986: Letter of application from Colburn Engineering, Inc. setting forth a design which Mr. Colburn felt met the requirements of your Title 10, or would be in the category of an "alternate design".

5.) April 21, 1986: Mr Colburn called Mr. Williams and made an appointment for us to see him on April 28 at 11:00 a.m.

BOND
USA
6.) April 28, 1986: Flew in from Boston, Mass. and dropped in on Mr. Williams as messages were mixed up. It was agreed that we would do more testing.

7.) April 29, 1986: More deep test holes were observed with Mr. Williams and Mr. Able. Aspects of the proposed design were discussed between Mr. Colburn and Mr. Williams. Mr. Williams promised me that a letter would go out to me by May 2, 1986 citing the Department's decision.

8.) May 9, 1986: Called for Mr. Williams. He was not available and the secretary did not have a letter.

9.) May 15, 1986: Called for Mr. Williams. He was not available. Talked to Mr. Able who was of no help.

10.) May 20, 1986: Called Mr. Williams who was out, but returned my call. He said that the project had been denied and would have a letter out the next day.

11.) June 2, 1986: Mr. Colburn called for Mr. Williams who said he was going to discuss the project with Mr. Skinner that day and would get back to Mr. Colburn later in the day. Mr. Williams said he was having trouble finding a regulation to cite for a denial. Williams did not call back.

12.) June 13, 1986: Mr. Williams called Mr. Colburn and said he still did not have a regulation to cite and that the Lot now would come under newer regulations. He said a letter would go out on June 16, 1986.

I have received nothing nor have I had any contact with your Department since June 13, 1986. In spite of having been born and raised in Maryland, and in fact having had 9 years of service with the Howard County Social Service Department, I strongly feel that I have been deceived, lied to, and denied due process. It appears that your Department is attempting to delay a finding in hopes of coming up with some way of taking away from me a valuable piece of property.

If I have not received a decision on my April 14, 1986 request for a sewer permit on or before June 12, 1987 then I will seek relief through the Courts.

Yours truly,

Carol E. McKinley
Carol E. McKinley

cc: Mr. Steward Herrick, Esq.
Colburn Engineering, Inc.

BATCH
BERKSHIRE

Ms. Carol McKinley
ry Hill Road
Mass. 01772

CLAIM CHECK
NO.

005689

HOLD

DATE

5/28/87

1ST NOTICE

6-3

2ND NOTICE

6-12

RETURN

FINAL NOTICE

Detached from
PS Form 3849-A
Oct. 1980

**RETURN RECEIPT
REQUESTED**

*Top of envelope to the right
return address.*

CERTIFIED

587 763 323

MAIL

Mr. Frank Skinner, Acting Director
Howard County Health Department
Bureau of Environmental Health
3525 Ellicott Mills Drive
Ellicott City, Maryland 21043



PROCEDURES FOR THE APPEAL OF DECISIONS RELATING TO
APPLICATIONS FOR ENVIRONMENTAL PERMITS ISSUED
BY COUNTY OFFICERS

This decision may be appealed by filing within ten days of receipt of this decision a Notice of Intent to Appeal and a Request for Hearing, if desired, with the Chief Hearing Examiner, Cornelia Bright Gordon, Maryland Department of the Environment, 201 West Preston Street, 5th Floor, Baltimore, Maryland 21201, with a copy to the Principal Counsel, Richard M. Hall, Maryland Department of the Environment, 300 West Preston Street, Baltimore, Maryland 21201.

The Notice of Intent to Appeal shall contain any grounds upon which you contend that the decision is unlawful, unreasonable, or unnecessary for protection of the public health or comfort.

If a Request for Hearing is submitted, upon receipt you will be advised in writing of the time, date and place of the hearing set for your appeal.

Prior to the hearing, you may examine and copy departmental documents regarding your case. If you wish to do so, you should make arrangements in advance of the hearing. The hearing will be presided over by a Maryland Department of the Environment hearing officer, who will make the decision. At the hearing, you may be represented by an attorney of your choosing, or you may represent yourself. The Howard County Health Department and the Maryland Department of the Environment often will be represented by an attorney.

Employees of the Howard County Health Department and the Maryland Department of the Environment will testify (and introduce documents) at the hearing in support of the reasons for the decision rendered or the conditions to which you object. These witnesses may be cross-examined by you or your attorney. You will be given the opportunity to testify personally, to call qualified witnesses of your choosing, and introduce documents to refute the evidence presented. You and your witnesses may be cross-examined by the Howard County Health Department or the Maryland Department of the Environment representatives.

You should be aware that failure to present a good case (usually including evidence from qualified expert witnesses) on your behalf may result in a decision adverse to you, since the evidence presented by the Howard County Health Department and the Maryland Department of the Environment would then be unrefuted.

Copies of following documents sent to Mr. Carlton Colburn:

10.17.02 Sewage Disposal and Certain Water Systems for Homes and
Other Establishments in the Counties of Maryland Where
a Public Sewage System is not Available

Septic Tank - Sand Mound Sewage Disposal System

Draft - Agreement and Easement for Installation of an Innovative
and Alternative On-Site Sewage Disposal System

Sand Lined Trench On-Site Sewage Disposal System Status Report

Status Report to the Governor and General Assembly on the State of
Maryland Innovative and Alternative On-Site Sewage Disposal Program

Appendix A - Innovative and Alternative On-Site Sewage Disposal
Grant Program

Copy of above documents made for Craig Williams

Originals filed in Innovative and Alternative Systems file

Lot 25
sect 4
Evergreen

GREEN HEDGE SECT 4

91
94
5

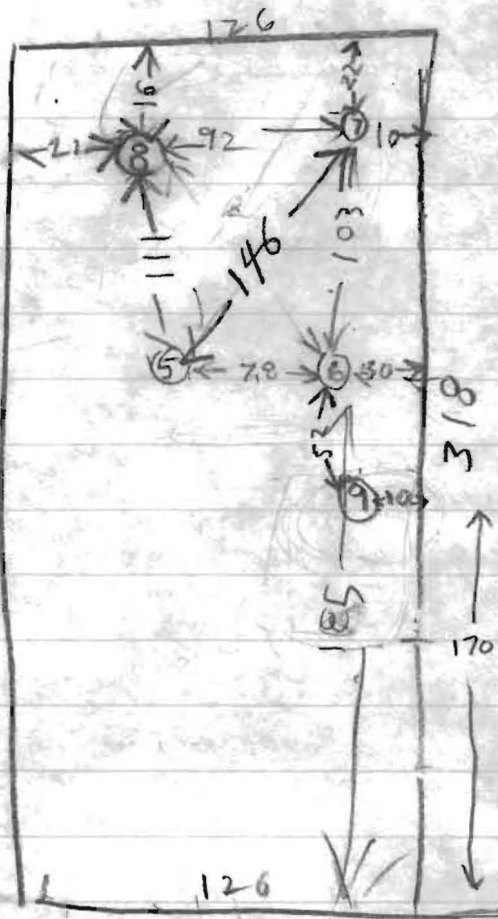

HOLE ELEVATION
 (8) = HIGHEST
 (TOO HIGH TO USE)
 (9) = LOWEST
 SAME PLACE AS
 (1) (2) of 1966
 (5) (7) = NEXT HIGHEST
 (6) = NEXT LOWEST

OWNER

CAROL MCKINLEY
 10 STRAWBERRY HILL RD
 SOUTH BORO MASS

01772
 617 491 2524

SEND COPY OF LETTER TO
 COLBURN ENGINEERING
 454 MAIN ST
 HUDSON MASS

01749
 ALSO COPY OF REGULATIONS
 ON PERCHES